



Operator's Manual

user manual, maintenance instructions and spare parts

26L/U, 33L/U, 43U, 53U Brushcutter



Read this manual carefully before operating the machine

Original Instructions Version June 16

26LU-33LU-43U-53U_210616

PRODUCT DESCRIPTION

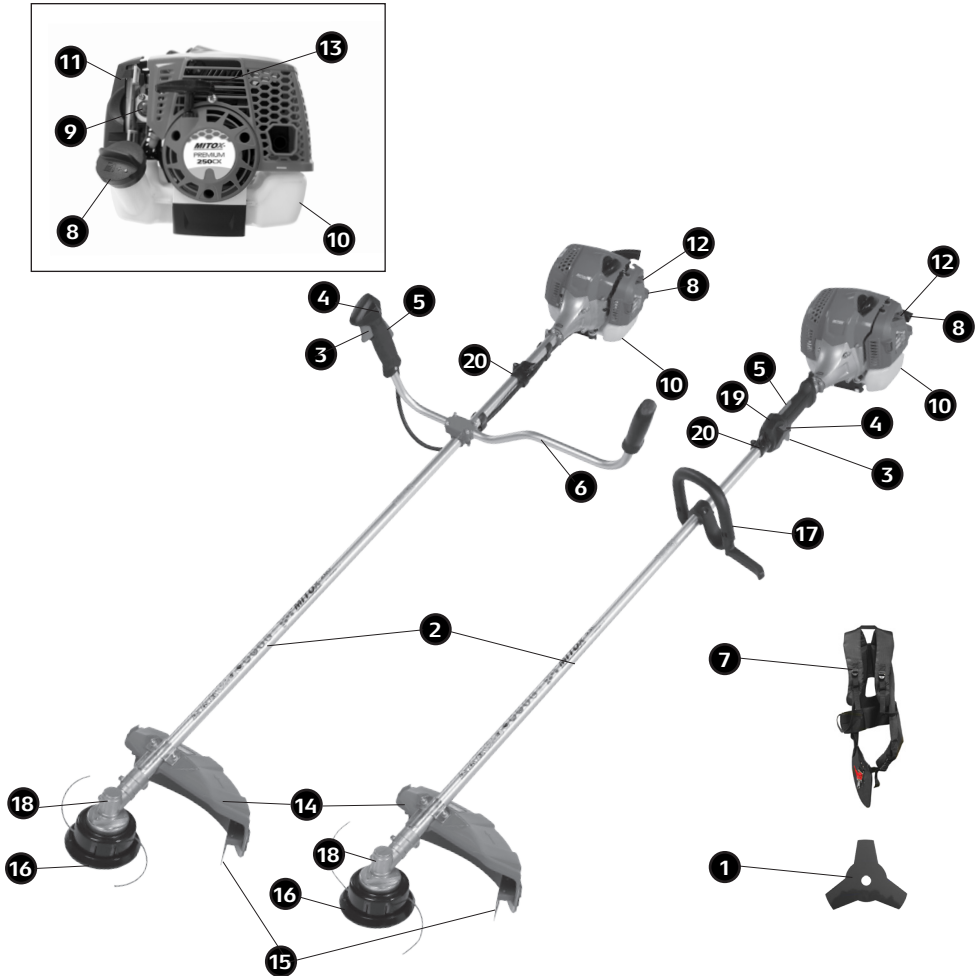

This Brushcutter is a 2 stroke fast running power tool and is designed to be used in a domestic application for trimming grass and light brush.

Component Location

1	BLADE	3 Point blade for grass, weed or brush cutting applications.
2	DRIVE SHAFT	Contains the drive shaft.
3	THROTTLE TRIGGER	Spring loaded to return to idle when released.
4	IGNITION SWITCH	Slide switch, forward to run, back to stop.
5	SAFETY LEVER	Prevents accidental operation of the throttle.
6	HANDLE	This handle can be adjusted for maximum comfort
7	HARNESS ASSEMBLY	Fully adjustable for maximum comfort
8	PETROL CAP	
9	PURGE BULB	Push the purge bulb to remove the air from the fuel system.
10	FUEL TANK	Contains fuel and fuel filter
11	AIR CLEANER	Contains replaceable filter
12	CHOKE	To help in cold starting
13	STARTER HANDLE	Pull to start the engine
14	DEBRIS SHIELD	Helps protect the operator from debris
15	CUT-OFF KNIFE	Cuts the nylon line to the correct length
16	NYLON CUTTER HEAD	Contains replaceable nylon trimming line
17	FRONT HANDLE	This handle can be adjusted for maximum comfort
18	GEARBOX	For attaching a blade or nylon head to
19	REAR HANDLE	Incorporating throttle trigger, switch, and safety lever
20	HARNESS FIXING POINT	Fixing point to attach the harness

Warnings in the Manual



This mark indicates instructions which must be followed in order to prevent accidents which could lead to serious bodily injury or death.













This mark indicates instructions which must be followed or it leads to mechanical failure, breakdown, or damage.



This mark indicates hints or useful directions in the use of the product.

Safety Symbols

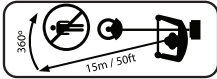
<p>Warning: Danger, Caution</p>	
<p>Read the documentation and safety instructions which are provided in this user manual.</p>	
<p>When operating this machine, use protective equipment such as goggles, helmet and ear defenders.</p>	
<p>Wear security shoes and gloves.</p>	
<p>Check the condition of working area to avoid any accident by hitting hidden obstacles such as stumps, stones, cans, or broken glass.</p>	
<p>Hot surface: Risk of burn.</p>	
<p>Danger: Risk of intoxication.</p>	
<p>Danger: Risk of fire or explosion</p>	
<p>Directive 2000-14/CE. Guaranteed noise levels</p>	
<p>Beware of objects being thrown from the operating zone</p>	
<p>Warning: Keep all people, animals and vulnerable objects at least 15 metres from the working area.</p>	

<p>Never modify the cutter in any way. Improper use of any cutter can cause serious or fatal injury.</p>	
<p>Beware of blade thrust</p>	

Taking Care of Warning Labels

Always keep warning labels clean and free of scratches, which might make them illegible or difficult to read. If the warning labels provided with your Brushcutter become damaged, peel off, or otherwise become illegible or difficult to read, order new labels from the authorised servicing dealer and replace the damaged labels. When applying new labels, first wipe away any dirt and dry the surface before applying the new label in the same place as the original label.

Explanation of Symbols on the Machine

For safe operation and maintenance, symbols are carved in relief on the machine:



FUEL TANK

Fuel tank 2 stroke mix
Position: Fuel cap



CHOKE OPERATION

<RUN>

Starting mode when the engine is hot (choke off).
Position: Air cleaner cover.



<START>

Starting mode when the engine is cold (choke on).
Position: Air cleaner cover.

Safety Precautions

Introduction

Read this Owner/Operator Manual carefully. Be sure you understand how to operate this Brushcutter properly before you use it. Failure to do so could result in serious injury.

Keep this manual handy so that you may refer to it later whenever any questions arise. Also note that you are able to contact the dealer from whom you purchased the product for assistance.

Always include this manual when selling, lending, or otherwise transferring the ownership of this product.

This product has been designed to be used as a Brushcutter power tool as described previously and it should never be used for any other purpose; doing so could result in unforeseen accidents and injuries occurring. Only approved Mitox accessories should be used with this product.

This Brushcutter is equipped with extremely sharp blades, always wear sturdy gloves when handling the blades and fit the safety guards when not in use.

When using this Brushcutter for the first time, take the Brushcutter to a wide, clear, open space, start the engine, and practice handling the Brushcutter until you are sure that you will be able to handle it properly in actual operation.

You should never use this Brushcutter when under the influence of alcohol, suffering from exhaustion or lack of sleep, suffering from drowsiness as a result of having taken medicine, or at any other time when your judgement might be impaired or that you might not be able to operate the Brushcutter properly and in a safe manner.

Never allow children or anyone unable to fully understand the directions given in this manual to use this Brushcutter

When planning your work schedule, allow plenty of time to perform the work and allow plenty of time for rest. Limit the amount of time you continuously use the Brushcutter to 30~40 minutes per session and take 10~20 minutes of rest between work sessions. Also, try to keep the total amount of work performed in a single day to 2 hours.

Never run the engine indoors as the exhaust gases contain harmful carbon monoxide.

Never use the Brushcutter in conditions as described below:

When the ground is slippery or when other conditions exist which might make it difficult to maintain a steady posture while using the Brushcutter.

At night, at times of heavy fog, or at any other times when your field of vision is limited and it would be difficult to gain a clear view of the area where the Brushcutter is to be used. In heavy rain, during lightning storms, at times of strong or gale-force winds, or at any other times when weather conditions might make it unsafe to use this product.

Lack of sleep, tiredness, or physical exhaustion results in lower attention spans, and this in turn can lead to accidents and injury.

Work Clothing and Safety Equipment

When using the product, you should wear proper clothing and protective equipment.

- Helmet
- Protection goggles or face protector
- Ear protectors
- Thick work gloves
- Non-slip sole work boots
- When using your Brushcutter, always wear strong, durable, work clothing; shirts should be long-sleeved and trousers should be full-length.

Safety and Operation



This Brushcutter is equipped with a very sharp blade, and when used incorrectly the blade can be extremely dangerous.

Improper handling can cause accidents which may in turn lead to serious injury or death. For

this reason, you should always be careful to adhere to the following instructions when using your Brushcutter.

Never hold the Brushcutter in a way in which the cutting head is pointing towards someone else.

Never allow the blade to come into contact with your body.

Always turn off the engine before adjusting the Brushcutter, or at any time when coming into close proximity with the cutting head.

Always wear thick work gloves when adjusting the Brushcutter.

Safe Handling of Fuel



The engine of the Brushcutter is designed to run on a two stroke oil/fuel mixture.

This fuel is highly flammable, never store cans of fuel or refill the fuel tank in any place where there is a source of heat or fire, which might ignite the fuel.

Do not smoke whilst operating the Brushcutter or refilling, keep lit cigarettes away from the Brushcutter at all times.

When refilling the fuel tank always stop the engine first and carefully make sure that there are no sparks or naked flames anywhere nearby before refuelling.

If any fuel spillage occurs during refuelling, use a dry rag to wipe any fuel which has been spilled onto the Brushcutter before starting the engine.

After refuelling, screw the fuel cap back tightly onto the fuel tank and carry the Brushcutter to a spot 5 metres or more away from where it was refuelled before starting the engine.

Before Operating the Brushcutter

Before beginning work, carefully check the work area and remove any obstacles. Within a perimeter of 15 metres of the work area should be considered a hazardous area into which no one should enter while the Brushcutter is being used, and when necessary this area should be marked with a warning rope, warning signs, or other forms of warning.

When work is to be performed simultaneously by two or more operators, care should also be taken to constantly look around to check the presence and locations of other operators within the work area to maintain a safe distance between each operator.

Before beginning work, each component of the Brushcutter should be checked to make sure that it is in proper working order, make sure that there are no loose screws or bolts, fuel leaks, ruptures, dents, broken guards or any other problems which might interfere with safe operation.

Keep all parts of your body away from the cutting head when the engine is running.

Before Starting the Engine

Carefully check the work area to make sure that no obstacles exist within a perimeter of 15 metres around the Brushcutter before starting the engine.

To start the engine, place the Brushcutter onto the ground in a flat clear area and hold it firmly in place to ensure that neither the cutting head nor the throttle come into contact with any obstacles when the engine starts.

After starting the engine, make sure that the cutting head stops moving when the throttle trigger is released (idle). If the cutting head continues to move when the engine is at idle, adjust the idle screw on the carburettor to a point where the cutting head stops moving, if this cannot be achieved, take the Brushcutter to your authorised service dealer for adjustment.

Avoid Noise Problems

Check and follow the local regulations for sound levels and hours of operation for garden machinery.

In general, operate Brushcutters between 8 am and 5 pm on weekdays and 9 am to 5 pm at weekends.

Avoid using the Brushcutter late at night and/or early in the morning.

Safety when using the Brushcutter

When using the Brushcutter, grip the handles firmly with both hands, place your feet slightly apart so your weight is distributed evenly across both legs, and always maintain a steady even posture while working.

- Maintain full engine speed when cutting.
- Never allow other persons to come within the work area as doing so might expose them to danger.
- Keep work area clear of all persons, particularly small children and pets. Injury may result from flying debris.
- If grass or other objects get caught in the Brushcutter during operation, always stop the engine before removing the object.
- Never touch the spark plug or plug HT cable while the engine is in operation, doing so may result in an electrical shock.
- Never touch the exhaust, spark plug, or any metallic parts while the engine is in operation or immediately after shutting down the engine. These parts reach high temperatures during operation and doing so could result in serious burns.
- When you finish cutting in one location and wish to continue work in another area, stop the engine.
- Always remove fuel from the fuel tank before transportation to prevent fuel spillage.
- Never leave the Brushcutter exposed to direct sunlight as this can heat the fuel tank and may cause a discharge of fuel, and flood the engine.
- Be careful not to hit the nylon cutting head against stones or the ground.



Two-Stroke Fuel



Fuel is very flammable. Do not smoke or bring any flame or sparks near fuel.

Always stop the engine and allow it to cool before refuelling.

Refuel outdoors on bare ground, restart engine at least 5m away from the refuelling stop.

The engine is lubricated by oil mixed into petrol. Prepare a mixture of unleaded petrol and semi-synthetic two-stroke oil that meets the specifications of: API TC, ISO-L-EGC, JASO FC (Low Smoke) oil.

Recommended mixing ratio is **40:1**

FUEL WITH NO OIL (RAW PETROL) will cause severe damage to the engine which is not covered by manufacturer's warranty.

Use fresh, unleaded petrol (95 RON) and semi-synthetic oil specially made for high performance two-stroke engines. Mix in a ratio of 40 parts petrol to 1 part of oil.

By using two-stroke oil specially made for two-stroke engines you will reduce the formation of ash and carbon deposits on the spark plug, piston, exhaust muffler and cylinder as well as reducing emissions of harmful exhaust gases.

Oil FOR 4-CYCLE ENGINES should not be used as two-stroke lubrication oil as it can cause fouling of the spark plug, exhaust port blocking, piston ring sticking and other internal engine damage.

NOTE

Due to increased Ethanol content in petrol we recommend the use of B3C Ethanol Shield 2-Stroke Oil, and Ethanol Shield Fuel Stabiliser to protect your MITOX® engine against the harmful effects of Ethanol.

www.b3cfuel.co.uk



Fuel Storage (Without Ethanol Shield)

Mixed two-stroke fuel which has been left unused for a period of one month or more may damage the carburettor and result in the engine failing to start or operate correctly.

When storing the Hedgetrimmer for a period of more than one month, empty the fuel tank, and run the engine to empty the carburettor of fuel.

Two stroke fuel can cause deterioration of rubber and/or plastic components during prolonged storage.

It is important to only use good quality, fresh fuel mix.

Fuelling

Shake the fuel container to thoroughly mix the two-stroke oil and petrol.

Clean dirt from around the fuel cap before removing.

Pour two-stroke fuel into the fuel tank with a filtered funnel, up to 80% of the fuel tank's capacity.

Replace the fuel cap and tighten securely. Spilled fuel must be wiped away from the Hedgetrimmer before starting the engine.

Move at least 5m away from the refuelling area before restarting the engine.



When refilling the tank, always turn off the engine and allow it to cool down. Take a careful look around to make sure that there are no sparks or open flames anywhere nearby before refuelling.

Assembly of the Brushcutter



The blade fitted to the guard is sharp and can cause injury, always wear gloves.

Installing the Guard

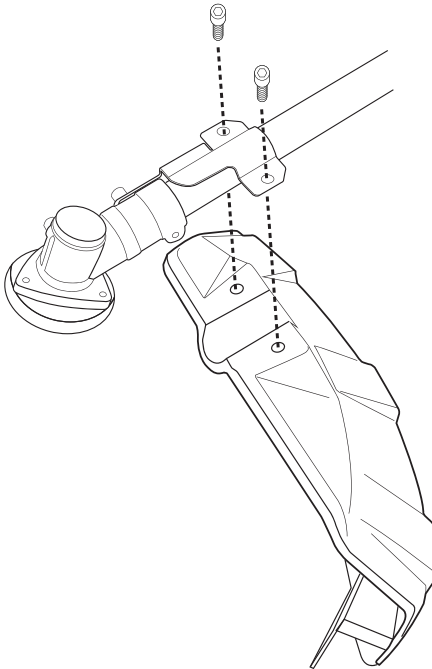

- Place the Brushcutter with the head facing down.
- Fit the shield using the bracket and 2 X M5x16 screws

Installing the Nylon Head

- Lay the Brushcutter on its back with the gearbox shaft facing up.

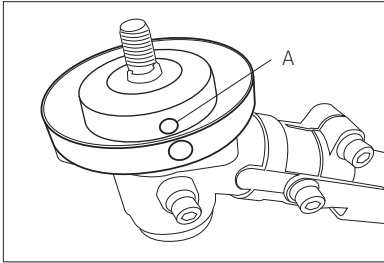

Rotate the gear box shaft until the hole in the holder A lines up with the slot in the metal guard.

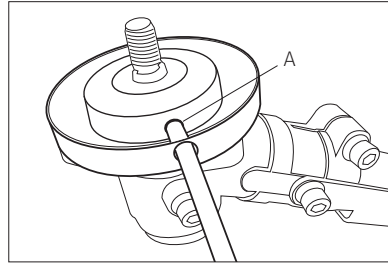

Insert an Allen key or screwdriver into the hole in the gearbox cover and into holder A.

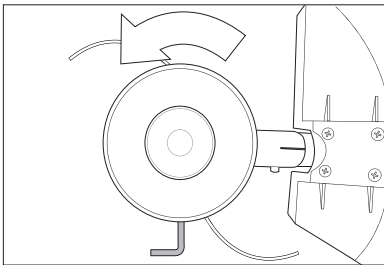

Screw the nylon head anti-clockwise (turn left) onto the threaded shaft on the end of the gearbox.

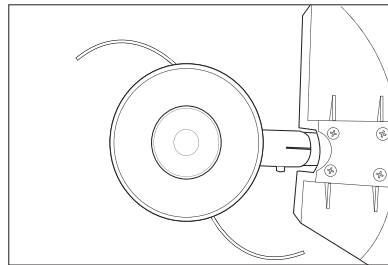

Make sure that the nylon head is securely locked in position and remove the Allen key.

Installing the 3 Tooth Blade

- Lay the Brushcutter on its back with the gearbox shaft facing up.

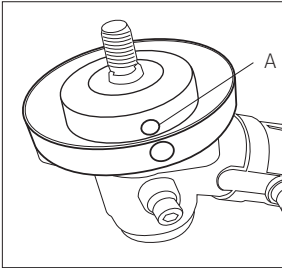

Rotate the gear box shaft until the hole in the holder A lines up with the slot in the metal guard.

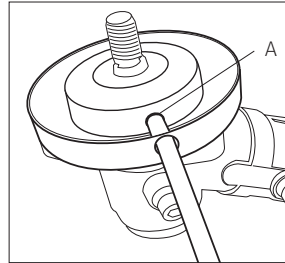

Insert an Allen key or screwdriver into the hole in the gearbox cover and into holder A.

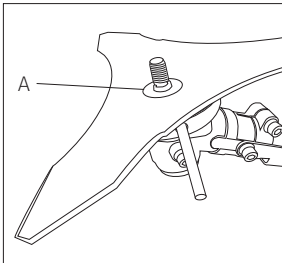

Place the 3 tooth blade on the holder A, centring the blade on the raised centre.

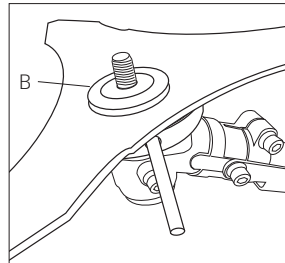

Fit the holder B over the blade.

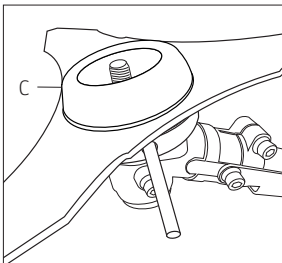

Fit the domed nut protector C over holder B and the blade.

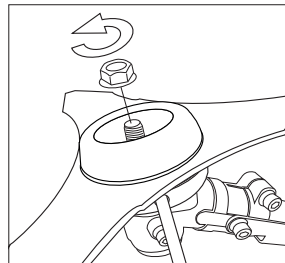

Fit the nut anti-clockwise (turn left) and tighten using the spanner provided. Remove the Allen key / screwdriver.



THE BLADE MUST BE CORRECTLY POSITIONED ON THE UPPER BLADE CLAMP OTHERWISE SERIOUS DAMAGE AND INJURY TO PERSONS AND PROPERTY COULD RESULT.

Using the Brushcutter

Choosing the cutting device

Choose the most suitable cutting device for the job to be done, according to these general indications:

- The cutting line head can eliminate tall grass and non-woody vegetation
- The 3-point blade is suitable for cutting brushwood and small shrubs up to 2 cm in diameter.

Nylon Head

- Cut the grass in 1.5 metre widths, keeping the machine well balanced.
- Avoid engaging stones, piles of earth, small pieces of wood or anything that could be hidden or difficult to see in the grass. If a large object is accidentally struck, if the cutting head gets blocked, overloaded or stringy material gets wrapped in the cutting head, reduce the engine speed so the engine idles. Make sure that the cutting head has stopped rotating switch off the engine and remove the material.
- Put the Brushcutter on the ground and check that the cutting head has not been damaged. If necessary, change the cutting head. If the head is only wrapped by vegetation, remove by hand and clean the cutting head.
- Always wear safety gloves for this operation and ensure the engine is switched off and the head is stationary.
- When the 2 nylon cords become too short, accelerate the engine and bump the nylon head on the ground. Automatically the 2 nylon cords will feed out and be cut to the correct length. Repeat the operation if necessary.

3-Point Blade

- Start cutting above the undergrowth and then move down with the blade so as to cut the brush into small pieces.
- Avoid hitting stones, piles of earth, small pieces of wood or anything that could be hidden or difficult to see in the grass.

Installing the Loop Handle Assembly (L Models)

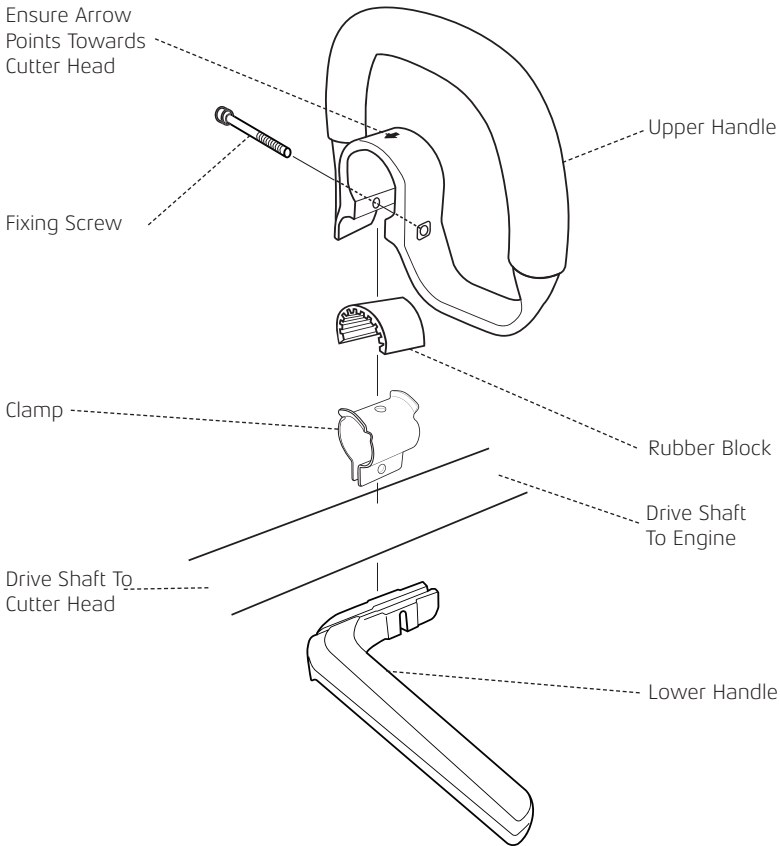

- Fix the Clamp to the Drive Shaft, then pinch the flat lugs together on the underside of the Clamp and slide them into the slot in the Lower Handle.
- Fit the Rubber Block and Upper Handle over the Clamp, ensuring the arrow on the Upper Handle points towards the Cutter Head.
- Insert the Fixing Screw through the Upper Handle, Lower Handle and Clamp, do not tighten.
- Adjust the handle to a comfortable working position then tighten the Fixing Screw.

Installing the U Handle Assembly (U Models)

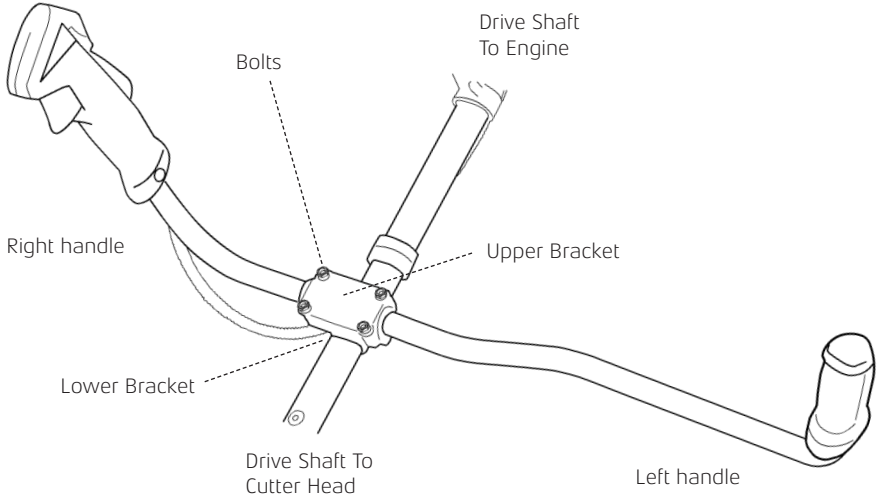

- Remove the upper bracket from the assembly by undoing the 4 bolts.
- Install the U handle assembly, reassemble the bracket assembly and secure using the 4 bolts .
- Ensure that the controls are located on the right and adjust the handle for maximum comfort before securing.

Operation



Keep clear of the cutter head as it may start moving when the engine starts.

Starting the Engine

CAUTION do not pull the starter cord all the way out and do not let go of the starter handle when the cord is extended, this can damage the starter mechanism.

Cold Engine Starting

Rest the unit on a flat, firm surface. Keep the cutting head off the ground and clear of surrounding objects as it may start moving when starting the engine.

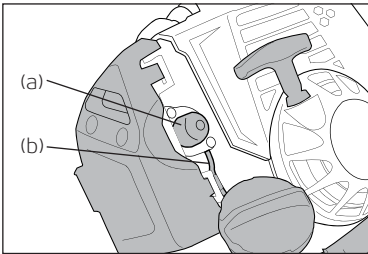

Fig 1 - Push the air purge bulb (a) until fuel is visible in the clear return fuel line (b)

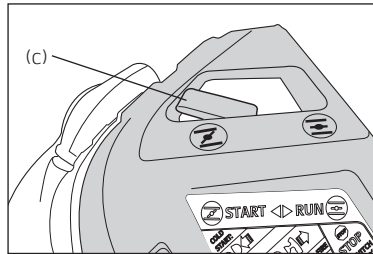

Fig 2 - Move the choke lever (c) to the START (N) position.

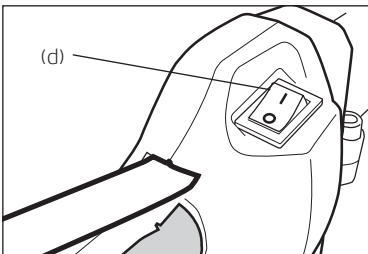

Fig 3 - Set the ignition switch (d) to the START (I) position.

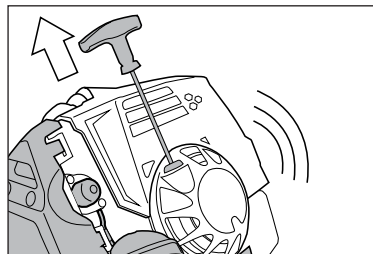

Fig 4 - While holding the unit, pull out the starter rope firmly until engine fires (indicated by a 'cough' from the engine).

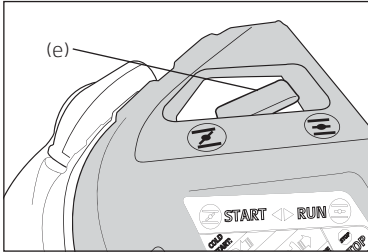

Fig 5 - Move the choke lever (e) to the RUN (|||) position.

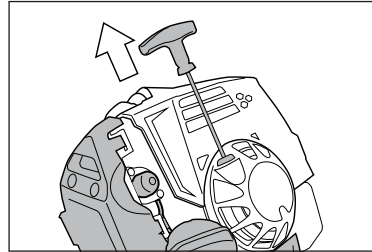

Fig 6 - Pull the starter rope until the engine starts, then squeeze the throttle briefly to release the fast idle control and return the engine to idle.

Allow the engine to warm up before use. When cutting, always use the Brushcutter on full throttle.

Hot Engine Starting

- Set the ignition switch to the START (I) position.
- Check the clear return fuel line. If the line is empty, push the air purge bulb until fuel is visible in the clear return fuel line.
- Move the choke lever to the START (| |) position, then back to the RUN (|||) position. This will set the throttle to the hot start position.
- Pull the starter rope until the engine starts, then squeeze the throttle briefly to release the fast idle control and return the engine to idle.
- If the engine does not start after 5 pulls, use the Cold Start procedure.

Overchoking

Should the engine become flooded due to overchoking, turn the ignition switch off, unscrew the spark plug, wipe it dry or replace.

Stopping the Engine



Set the engine to idling by releasing the throttle lever.

Set the ignition switch to the off position "O" (STOP).

If the engine fails to stop, set the choke lever to the closed position to stall the engine; do not use the machine until the ignition switch is repaired.

Running In

During the first ten hours of work, avoid running the engine at maximum speed for a prolonged period until all the components have bedded in, after the engine has been run in, it will reach its maximum power.

Transportation

Never transport the Brushcutter with the engine running. An engine that is running could be accidentally accelerated causing the blade to engage.

Make sure the blade safety guards are in place when transporting the Brushcutter.

When carrying by hand, the cutting head should be pointing backwards.

Ensure the Brushcutter is secure when transporting in a vehicle and the tank is drained of fuel.

Maintenance

IMPORTANT

After every use, check that all nuts, bolts and screws are securely fastened and tighten if necessary.

In the event of an accident, breakdown or blockage, ensure the engine is turned off before any work is carried out to rectify this.

Make sure the engine has stopped and is cool before performing any service to the machine.

Contact with moving cutting head or hot muffler may result in a personal injury.

Fuel Filter

Every 15 hours of operation, using a wire hook, take the fuel filter from the fuel tank and clean or replace with a new fuel filter.

Spark Plug

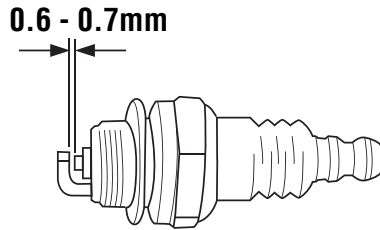

Poor starting or misfiring is often caused by a fouled or defective spark plug, clean and reset the gap to 0.65 mm, or replace the spark plug with RCJ7Y (Champion) as necessary.

Air Filter

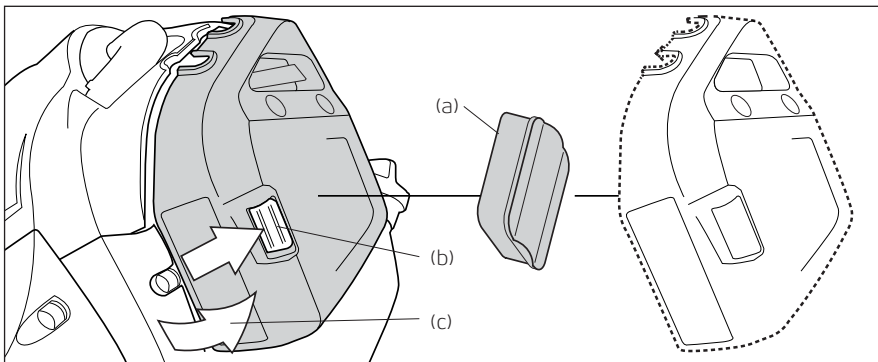

Before using the Brushcutter, check the air filter (a). Being clogged, will reduce the engine performance.

Remove the air filter cover by pressing on the filter cover release (b) and opening the filter cover (c). Clean the filter element in warm, soapy water, dry completely before installing. If the element is broken or shrunk, replace with a new one.

Carburettor

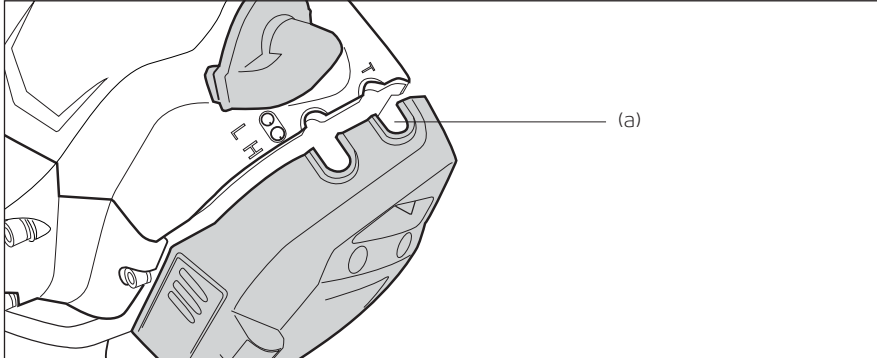

The carburettor mixture setting has been set at the factory and will not need adjusting.

Adjusting the idle speed: If adjustment is necessary turn the T screw (a) clockwise until the cutting head starts to move, then turn the screw T anticlockwise until the cutting head stops.

If the idle speed cannot be adjusted to stop the cutting head moving at idle, contact your dealer for repair before use.

Safety Lock

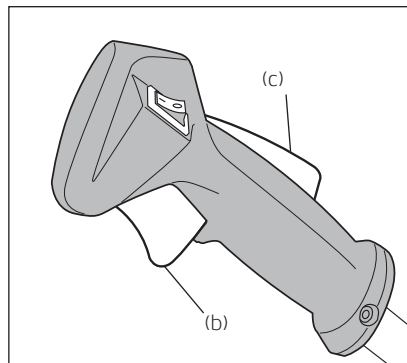
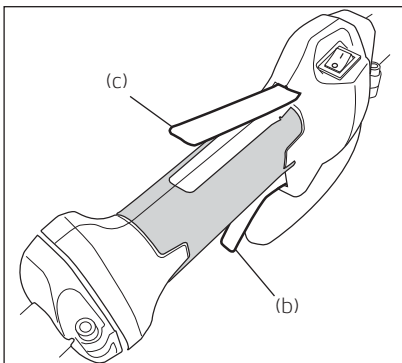

The safety lock is to prevent the throttle lever from accidentally being engaged. The throttle lever (b) can only be pressed in if the safety lock (c) is held down. Check if the safety lock and throttle lever returns to its original position and the engine returns to idling when you release your hand from the handle.

Any defects contact your nearest service agent for repairs before using the machine.

Storage

- Remove the spark plug; pour a small amount of oil into the cylinder. Rotate the crankshaft several times using the starting rope in order to distribute the oil. Put the spark plug back in.
- Remove the fuel from the machine.

Gear Case

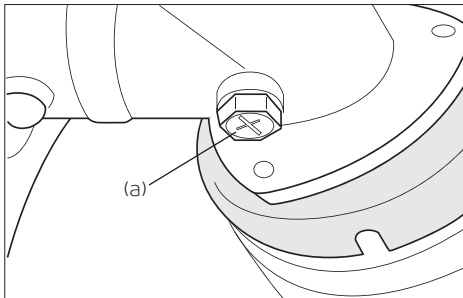

- Remove the bolt (a) on the gear case, top up the gearbox using Lithium grease and refit the bolt, every 15 hours use.

Replacing the Nylon Cord

Check to see if the nylon head is damaged before replacing the cord. If you can see serious traces of wear or damage, you must replace the complete nylon head.

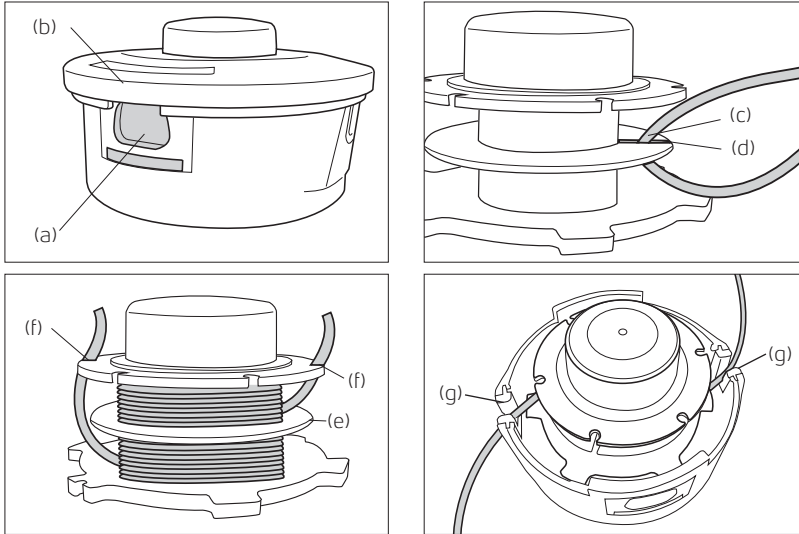

1. Stop the engine.
2. Open the nylon head by pushing on the catch, (a), and lifting the cover (b).
3. Pull the bobbin out of the nylon head and take out the rest of the nylon cords.
4. Cut a new length of cord, 2.4mm Ø and 5 metres long.
5. Fold the new cord in half and place the centre of the fold (c) into the clip (d) in the empty bobbin.
6. Wind the line in the direction of the arrows on the bobbin, with half of the line above and half below the divider (e). Maintain an even and firm tension onto the bobbin, being careful not to twist the line.
6. After winding the cord, insert both ends into the notches on the bobbin, (f).
7. Put the filled bobbin back into the carrier. Release the cords from the notches in the bobbin and thread them into the eyelets in the carrier (g). The cords should stick out approx 15 cm either side.
8. Refit the spool cover (b), ensuring it is securely clicked into place.

****NOTE** To watch a video on fitting the nylon cutting line visit www.mitox.co.uk**

Never use a cutting device other than those supplied by the manufacturer. (Steel cord is never allowed) Always use original spare parts in order to benefit from continuous warranty.

Troubleshooting

Engine will not start, power loss:

- Check that the fuel tank is not empty. Fill with mixed fuel.
- The fuel does not reach the carburettor. Change the fuel filter in the fuel tank.
- There is water in the fuel. Drain and clean the fuel system.
- The air filter is dirty. Clean or replace the air filter.
- There are carbon deposits in the exhaust muffler restricting the engine. Clean or change the muffler.
- Spark plug is worn. Replace spark plug.

Service Schedule

Component	Procedure	Before use	Every 15 Hours	Every 25 Hours	Every 50 Hours	Note
Fuel leaks / spillage	Wipe up	X				
Fuel tank, filter	Inspect / clean		X			Replace if necessary
Idle adjust screw	See p.24	X		X		Adjust carburettor if necessary
Spark plug RCJ7Y	Clean and readjust plug gap		X			GAP .025" (0.6-0.7mm) Replace, if necessary
Cylinder fins, Intake air cooling vent	Clean		X			
Muffler, Spark arrestor, cylinder exhaust port	Clean				X	
Throttle lever, ignition switch	Check operation	X				
Air filter	Clean	X				
Screws, nuts, bolts	Tighten / replace	X				Not adjustment screws
Grease the gear box	Check		X			

Specifications

Model	26L SELECT	26U SELECT
Engine type	1E34F-4 (air cooled 2-stroke petrol engine)	
Power (max.)	0.75Kw	
Engine displacement	25.4cc	
Idling speed	3100 ± 300	
Engine maximum speed no load	Grass Trimmer 9000 rpm	
Cutting diameter	Nylon Head 430mm - 3 Tooth Blade 255mm	
Cutting Line Diameter	2.4mm	
Blade Centre Hole	25.4mm	
Fuel	Mixture (Petrol 40: Oil 1)	
Fuel tank Volumes	0.9L	
Net weight (without fuel/harness)	6.3	6.3
Noise LWA dB(A)	110.4	
Spark plug	RCJ7Y (Champion)	
Carburetor	Diaphragm Type	

Model	33L SELECT	33U SELECT
Engine type	1E36F-2 (air cooled 2-stroke petrol engine)	
Power (max.)	1.0Kw	
Engine displacement	32.6cc	
Idling speed	3100 ± 300	
Engine maximum speed no load	Grass Trimmer 9000 rpm	
Cutting diameter	Nylon Head 430mm - 3 Tooth Blade 255mm	
Cutting Line Diameter	2.4mm	
Blade Centre Hole	25.4mm	
Fuel	Mixture (Petrol 40: Oil 1)	
Fuel tank Volumes	0.9L	
Net weight (without fuel/harness)	7.1	7.1
Noise LWA dB(A)	109.7	
Spark plug	RCJ7Y (Champion)	
Carburetor	Diaphragm Type	

Specifications

Model	43U SELECT
Engine type	1E40F-5 (air cooled 2-stroke petrol engine)
Power (max.)	1.25Kw
Engine displacement	42.7cc
Idling speed	3100 ± 300
Engine maximum speed no load	Grass Trimmer 8500 rpm
Cutting diameter	Nylon Head 430mm - 3 Tooth Blade 255mm
Cutting Line Diameter	2.4mm
Blade Centre Hole	25.4mm
Fuel	Mixture (Petrol 40: Oil 1)
Fuel tank Volumes	1.0L
Net weight (without fuel/harness)	7.9
Noise LWA dB(A)	110.0
Spark plug	RCJ7Y (Champion)
Carburetor	Diaphragm Type

Specifications

Model	53U SELECT
Engine type	1E44F-6 (air cooled 2-stroke petrol engine)
Power (max.)	1.5Kw
Engine displacement	51.7cc
Idling speed	3100 ± 300
Engine maximum speed no load	Grass Trimmer 8500 rpm
Cutting diameter	Nylon Head 430mm - 3 Tooth Blade 255mm
Cutting Line Diameter	2.4mm
Blade Centre Hole	25.4mm
Fuel	Mixture (Petrol 40: Oil 1)
Fuel tank Volumes	1.0L
Net weight (without fuel/harness)	8.0
Noise LWA dB(A)	110.4
Spark plug	RCJ7Y (Champion)
Carburetor	Diaphragm Type

26L/U, 33L/U, 43U, 53U



Notes

Engine Parts Drawing: 26L

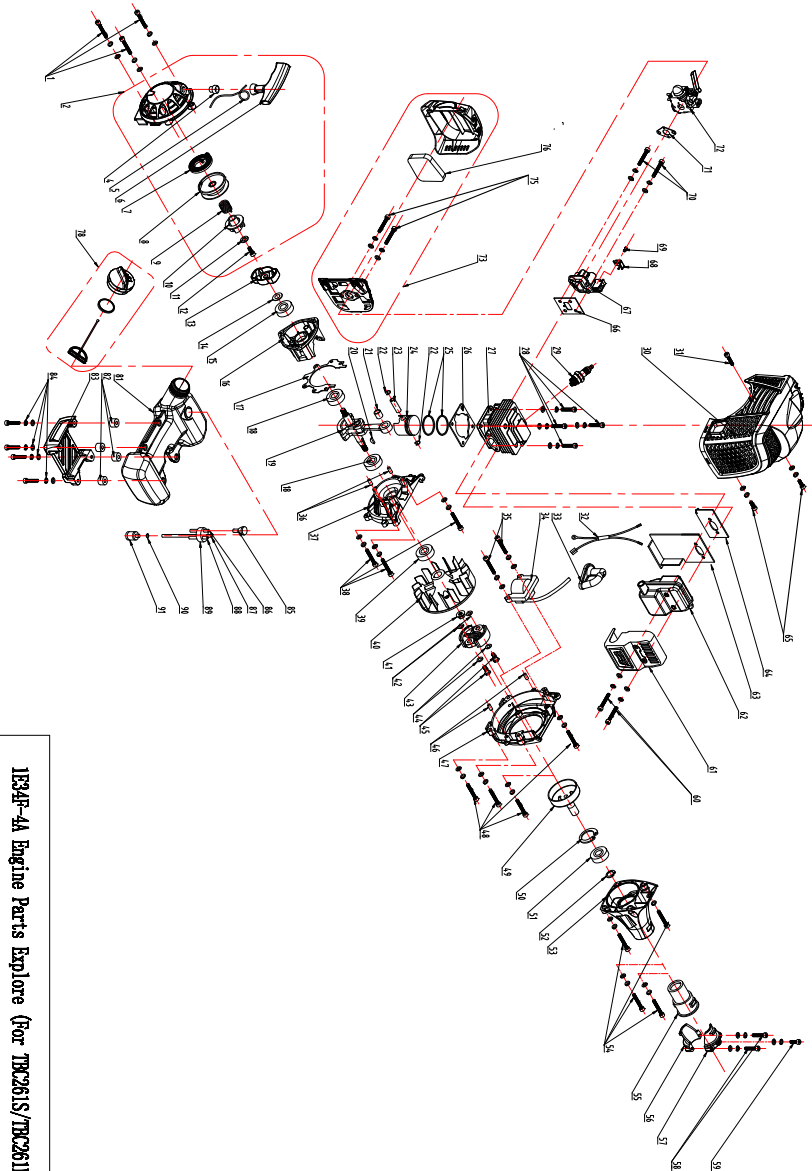

11334F-4A Engine Parts Explode (for TRC261S/TRC261U)

Engine Parts List: 26L

ID	PART NUMBER	DESCRIPTION	QTY				
1	MIGB/T2671.2 MSX20	SCREW MSX20	2	48	MITBC330D.01.00.00-6	PLASTIC PLATE	1
2	MIGB/T2671.2 MSX25	SCREW MSX25	2	49	MIGB/T119.2.5X10	PIN 5X10	2
3	MIYD62.02.00-3	STARTER HANDLE	1	50	MITBC331D.01.01.00-4	FAN COVER	1
4	MIYD25.02.01-2	ROPE GUIDE	1	51	MIGB/T2671.2 MSX20	SCREW MSX20	4
6	MITBC431D.01.12.00-00	STARTER ASSEMBLY	1	52	MITBC430D.01.14.01-00	CLUTCH DRUM	1
7	MITBC430D.01.12.00-2	STARTER ROPE	1	53	MIGB/T893.1 35	CIRCLIP (SIZE 35)	1
8	MITBC430D.01.12.00-4	RECOIL SPRING	1	54	MIGB/T276 6202-2Z	BEARING 6202	1
9	MITBC431D.01.12.00-3	STARTER PULLEY	1	55	MIGB/T894.1 15	STOP RING (SIZE 15)	1
10	MITBC430D.01.12.00-5	SPRING - STARTER	1	56	MITBC331D.01.14.00-1	CLUTCH DRUM HOUSING	1
11	MITBC431D.01.12.00-6	RATCHET WHEEL	1	57	MIGB/T2671.2 M6X20	SCREW M6X20	4
12	MIGB/T9074.19 ST4.8X19	ST SCREW 4.8X19	1	58	MITBC430D.01.14.00-2	ANTIVIBE RUBBER	1
13	MIGB/T9074.19 5X16X1	PLATE WASHER 5X16X1	1	59	MITBC430D.01.14.00-4	CLAMP RH	1
14	MITBC430D.01.00.00-6	STARTER GASKET	1	60	MITBC430D.01.14.00-3	CLAMP LH	1
15	MIGB/T6175 M8	NUT M8	1	61	MIGB/T2671.2 MSX25	SCREW MSX25	2
16	MITBC430D.01.00.02-00	STARTER RATCHET ASSY	1	62	MIGB/T2671.2 MSX12	SCREW MSX12	1
17	MIGB/T97.1 M8	FLAT WASHER M8	1	63	MIGB/T2671.2 MSX60	SCREW MSX60-10	2
18	MIYD38-3.01.01.02-00	OIL SEAL 12X22X7	1	64	MIGB/T2671.2 MSX12	SCREW MSX12	1
19	MITBC330D.01.01.00-2	CRANKCASE RH	1	65	MITBC331D.01.00.00-7	MUFFLER COVER	1
20	MITBC330D.01.01.00-3	GASKET - CRANKCASE	1	66	MITBC330D.01.09.00-00	MUFFLER	1
21	MIGB/T276 6201	BALL BEARING 6201	2	67	MITBC331D.01.00.00-10	GASKET - MUFFLER	1
22	MITBC331D.01.03.01-00	CRANK SHAFT ASSY	1	68	MITBC330D.01.00.00-5	GASKET - MUFFLER	1
23	MIGB/T1099 3X5X13	KEY 3X5X13	1	69	MIGB/T2671.2 MSX12	SCREW MSX12	1
24	MITBC330D.01.03.03-00	BEARING	1	70	MIGB/T2671.2 M4X12	SCREW M4X12	1
25	MITBC330D.01.03.00-3	CIRCLIP \ PISTON PIN	2	71	MITBC330D.01.00.00-3	GASKET	1
26	MITBC330D.01.03.00-2	PISTON PIN	1	72	MITBC331D.01.00.01-00	MANIFOLD	1
27	MITBC330D.01.03.02-00	PISTON	1	73	MITBC431D.01.00.00-12	STRAP	1
28	MITBC330D.01.03.00-1	PISTON RING	2	74	MIGB/T845 ST3.5X9.5	ST SCREW 3.5X9.5	1
29	MITBC330D.01.00.00-2	GASKET - CYLINDER	1	75	MIGB/T2671.2 MSX22	SCREW MSX22	2
30	MITBC331D.01.00.00-1	CYLINDER	1	76	MIYD38-3.01.00-8	CARBURETOR GASKET	1
31	MIGB/T2671.2 MSX20	SCREW MSX20	4	77	MITBC331D.01.06.00-00	CARBURETOR	1
32	SPBPMR7A	SPARK PLUG (BPMR7A NGK)	1	78	MITBC331D.01.08.00-00	AIR FILTER ASSEMBLY	1
33	MITBC331D.01.00.00-9	ENGINE COVER	1	79	MITBC431D.01.08.00-1	AIR BOX BASE	1
34	MITBC330D.01.11.02-00	WIRE	1	80	MIGB/T2671.2 MSX45	SCREW MSX45	2
35	MITBC431D.01.11.00-1	PLUG CAP	1	81	MITBC431D.01.08.00-3	AIR FILTER	1
36	MIGB/T2671.2 MSX25	SCREW MSX25	2	82	MITBC331D.01.08.00-2	AIR BOX COVER	1
37	MITBC330D.01.11.01-00	IGNITION COIL	1	83	MITBC431D.01.13.01	FUEL CAP ASSY	1
38	MIGB/T119.2.5X10	PIN 5X10	2	86	MITBC331D.01.13.00-1	TANK	1
39	MITBC330D.01.01.00-1	CRANKCASE LH	1	87	MITBC431D.01.13.00-2	FUEL TANK RUBBER	4
40	MIGB/T2671.2 MSX30	SCREW MSX30	4	88	MITBC331D.01.00.00-8	FUEL TANK BRACKET	1
41	MIYD38-3.01.01.02-00	OIL SEAL 12X22X7	1	89	MIGB/T2671.2 MSX25	SCREW MSX25	4
42	MITBC330D.01.10.00-00	FLYWHEEL	1	90	MIA45.0111.0200	VENT VALVE	1
43	MIGB/T6187 M8	FLANGE NUT M8	1	91	MITBC431D.01.13.00-6	BREATHER PIPE	1
44	MITBC430D.01.00.00-9	FLAT WASHER 8X16X1.5	2	92	MITBC430D.01.13.00-4	FUEL PIPE	1
45	MITBC431D.01.00.04-00	CLUTCH ASSEMBLY	1	93	MITBC430D.01.13.00-5	RETURN PIPE	1
46	MIGB/T755 M10	SPRING WASHER 10	2	94	MIC43.1107.0003	FUEL GROMMET	1
47	MITBC430D.01.00.00-8	BOLT - CLUTCH	2	95	MIA45.0102.0103	CIRCLIP	1
				96	MIA38.0311.0500	FUEL FILTER	1

Appliance Parts Drawing: 26L

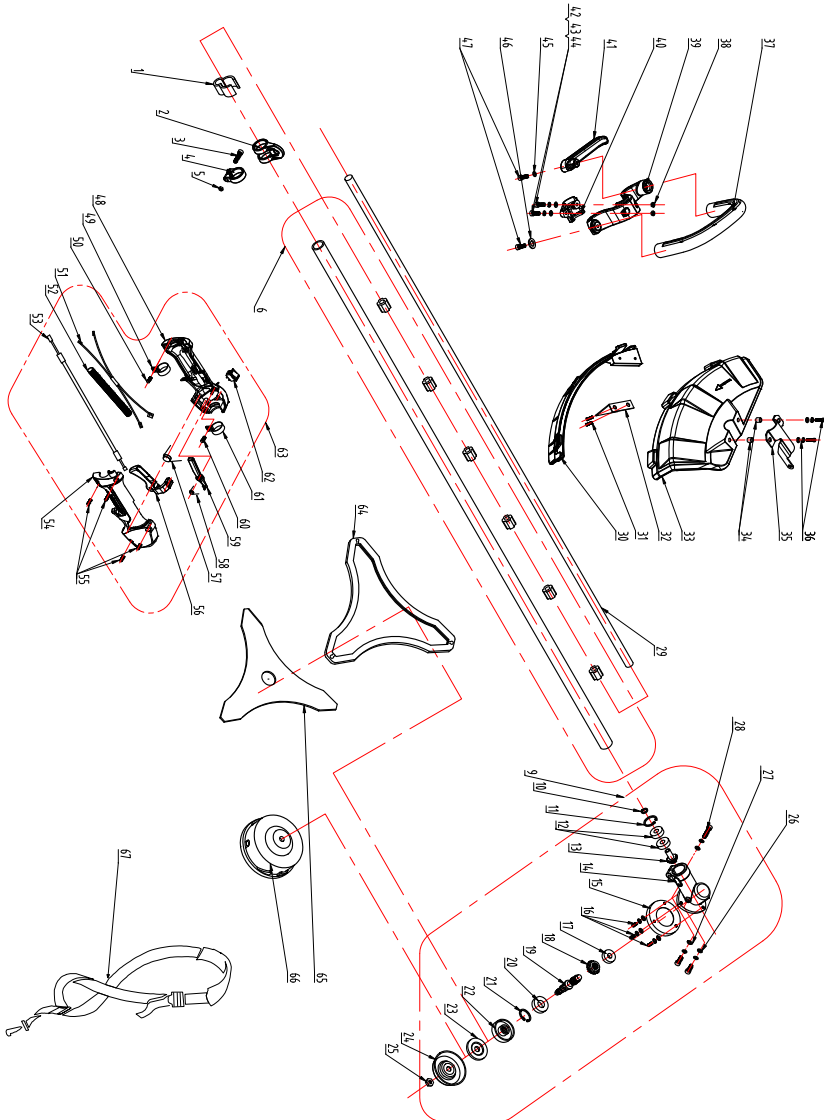

Appliance Parts List: 26L

ID.	PART No	DESCRIPTION	
1	MITBC431D.02.00-3	CLAMP	1
2	MITBC430D.03.02-00	HARNESS CLAMP LOOP	1
3	MIGB/T2671.2 M5X20	SCREW M5X20	1
4	MITBC430D.03.00-2	CLAMP	1
5	MIGB/T6170 M5	NUT M5	1
6	MITBC431S.03.01-00	OUTER SHAFT ASSEMBLY	1
9	MITBC431D.04.00-00	GEAR BOX ASSEMBLY	1
10	MIGB/T894.1 10	CIRCLIP (SIZE 10)	1
11	MIGB/T893.1 26	CIRCLIP (SIZE 26)	1
12	MIGB/T276 6000-2Z	BALL BEARING 6000-2Z	2
13	MIC43.0116.0002	PINION	1
14	MITBC431D.04.00-1	GEARBOX	1
15	MIC43.0116.0007	TOP GUARD	1
16	MIGB/T70.1 M5X8	SCREW M5X8	3
17	MIGB/T276 6000-2Z	BALL BEARING 6000-2Z	1
18	MIC43.0116.0004	GEAR	1
19	MITBC431D.04.00-3	GEAR SHAFT	1
20	MIGB/T276 6002-2Z	BALL BEARING 6002-2Z	1
21	MIGB/T893.1 26	CIRCLIP (SIZE 26)	1
22	MITBC431D.04.00-6	BLADE CLAMP - LOWER	1
23	MITBC431D.04.00-5	BLADE CLAMP - UPPER	1
24	MITBC431D.04.00-8	NUT PROTECTOR	1
25	MIGB/T6177.2 M10X1.25	FLANGE NUT M10X1.25 LH	1
26	MIGB/T70.1 M6X12	SCREW M6X12	1
27	MIGB/T2671.2 M6X12	SCREW M6X12	1
28	MIGB/T2671.2 M6X25	SCREW M6X25	1
29	MITBC430D.03.00-1	DRIVE SHAFT	1
30	MITBC431D.06.01-1	SKIRT	1
31	MIGB/T845 ST4.8X13	TAPPING SCREW ST4.8X13	2
32	MITBC431D.06.00-2	LINE CUTTER	1
33	MITBC431D.06.02-00	DEBRIS GUARD	1
34	MIC43.1113.0102	SPACER	2
35	MITBC430D.06.00-1	CLAMP 26MM	1
36	MIGB/T2671.2 M6X20	SCREW M6X20	2
37	MITBC431S.05.01-1	FRONT HANDLE	1
38	MIGB/T6170 M5	NUT M5	2
39	MITBC431S.05.01-2	HANDLE BASE	1

ID.	PART No	DESCRIPTION	
40	MITBC431S.05.01-3	HANDLE CLAMP	1
41	MITBC431S.05.01-4	HANDLE BAR	1
42	MIGB/T2671.2 M5X28	SCREW M5X28	2
43	MIGB/T93 M5	SPRING WASHER M5	2
44	MIGB/T97.1 5X11X2	PLATE WASHER	2
45	MIGB/T97.1 5X11X2	PLATE WASHER 1.5X11X2	1
46	MIGB/T97.1 5X11X2	PLATE WASHER	1
47	MIGB/T845 ST4.8X19	TAPPING SCREW ST4.8X19	2
48	MITBC0225.2.1	THROTTLE HANDLE LH	1
49	MITBC0225.2-7A	FIXING CLAMP	1
50	MIGB/T70.1 M5X14	CAP HEAD SCREW M5X14	1
51	MITBC1435.05.02-12A/13A	SWITCH WIRES	1
52	MITBC1435.05.02-11A	CABLE SLEEVE	1
53	MITBC1435.05.02-10A	THROTTLE CABLE ASSEMBLY	1
54	MITBC0225.2.2	THROTTLE HANDLE RH	1
55	MIGB/T845 ST4X10	SCREW ST4X10	4
56	MITBC0225.2-1	TRIGGER	1
57	MITBC0225.2-4	SPRING	1
58	MITBC0225.2-6	SPRING	1
59	MITBC0225.2-2	LOCK TRIGGER	1
60	MIGB/T70.1 M5X14	CAP HEAD SCREW M5X14	1
61	MITBC0225.2-7A	FIXING CLAMP	1
62	MIYD38-3.01.11.04-00	ON/OFF SWITCH	1
63	MIC43.1311.0500	THROTTLE ASSEMBLY	1
64	MITBC431D.02.00-2	BLADE COVER	1
65	MITBC430D.02.01-00	NYLON HEAD ASSEMBLY	1
66	MIC43.1100.0001	BLADE	1
67	M100.07.06.0007	HARNESS - SINGLE STRAP	1

Engine Parts Drawing: 26U

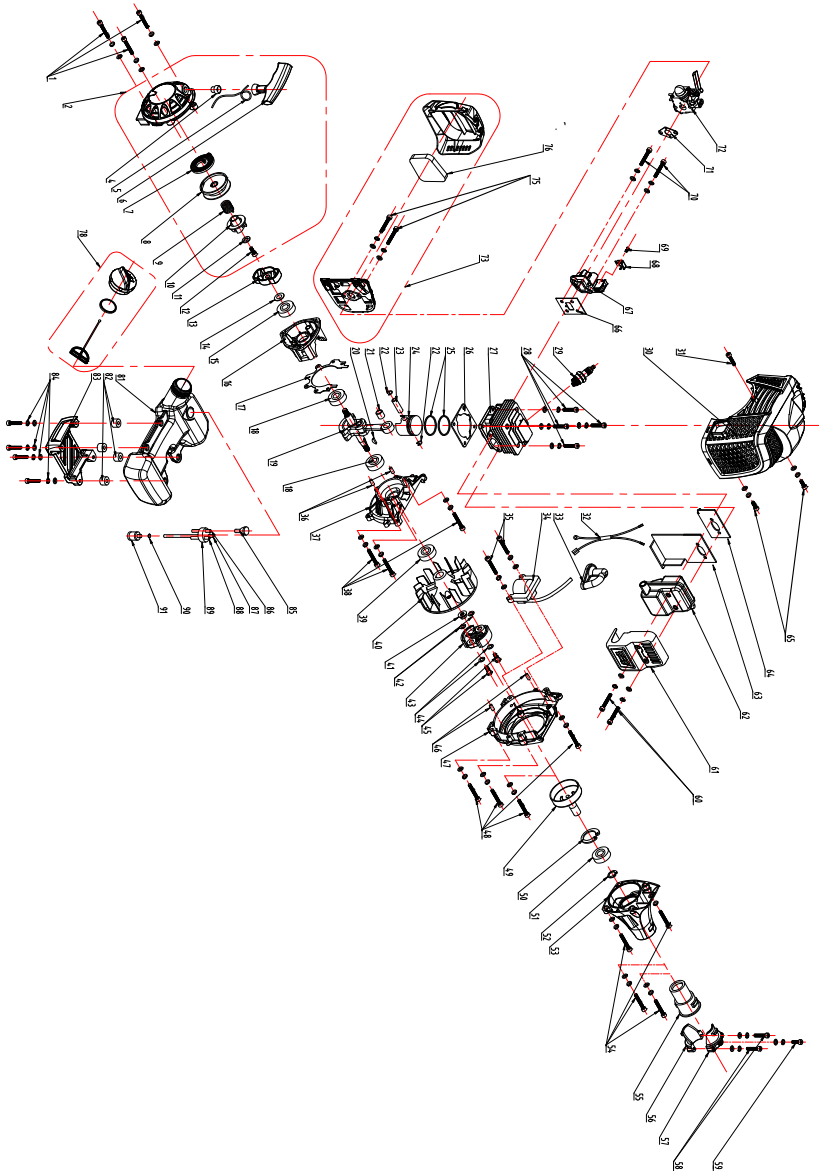

Engine Parts List: 26U

ID	PART NUMBER	DESCRIPTION	QTY
1	MIGB/T2671.2 M5X20	SCREW M5X20	2
2	MIGB/T2671.2 M5X25	SCREW M5X25	2
3	MIYD25.02.00-3	STARTER HANDLE	1
4	MIYD25.02.01-2	ROPE GUIDE	1
6	MITBC431D.01.12.00-00	STARTER ASSEMBLY	1
7	MITBC430D.01.12.00-2	STARTER ROPE	1
8	MITBC430D.01.12.00-4	RECOIL SPRING	1
9	MITBC431D.01.12.00-3	STARTER PULLEY	1
10	MITBC430D.01.12.00-5	SPRING - STARTER	1
11	MITBC431D.01.12.00-6	RATCHET WHEEL	1
12	MIGB/T9074.19 ST4.8X19	ST SCREW 4.8X19	1
13	MIGB/T9074.19 5X16X1	PLATE WASHER 5X16X1	1
14	MITBC430D.01.00.00-6	STARTER GASKET	1
15	MIGB/T6175 M8	NUT M8	1
16	MITBC430D.01.00.02-00	STARTER RATCHET ASSY	1
17	MIGB/T971.1 M8	FLAT WASHER M8	1
18	MIYD38-3.01.01.02-00	OIL SEAL 12X22X7	1
19	MITBC330D.01.01.00-2	CRANKCASE RH	1
20	MITBC330D.01.01.00-3	GASKET - CRANKCASE	1
21	MIGB/T276 6201	BALL BEARING 6201	2
22	MITBC331D.01.03.01-00	CRANK SHAFT ASSY	1
23	MIGB/T1099 3X5X13	KEY 3X5X13	1
24	MITBC330D.01.03.03-00	BEARING	1
25	MITBC330D.01.03.00-3	CIRCLIP \ PISTON PIN	2
26	MITBC330D.01.03.00-2	PISTON PIN	1
27	MITBC330D.01.03.02-00	PISTON	1
28	MITBC330D.01.03.00-1	PISTON RING	2
29	MITBC330D.01.00.00-2	GASKET - CYLINDER	1
30	MITBC331D.01.00.00-1	CYLINDER	1
31	MIGB/T2671.2 M5X20	SCREW M5X20	4
32	SPBPMR7A	SPARK PLUG (BPMR7A NGK)	1
33	MITBC331D.01.00.00-9	ENGINE COVER	1
34	MITBC330D.01.1.02-00	WIRE	1
35	MITBC431D.01.11.00-1	PLUG CAP	1
36	MIGB/T2671.2 M5X25	SCREW M5X25	2
37	MITBC330D.01.11.01-00	IGNITION COIL	1
38	MIGB/T119.2 5X10	PIN 5X10	2
39	MITBC330D.01.01.00-1	CRANKCASE LH	1
40	MIGB/T2671.2 M5X30	SCREW M5X30	4
41	MIYD38-3.01.01.02-00	OIL SEAL 12X22X7	1
42	MITBC330D.01.10.00-00	FLYWHEEL	1
43	MIGB/T6187 M8	FLANGE NUT M8	1
44	MITBC430D.01.00.00-9	FLAT WASHER 8X16X1.5	2
45	MITBC431D.01.00.04-00	CLUTCH ASSEMBLY	1
46	MIGB/T755 M10	SPRING WASHER 10	2
47	MITBC430D.01.00.00-8	BOLT - CLUTCH	2
48	MITBC330D.01.00.00-6	PLASTIC PLATE	1
49	MIGB/T119.2 5X10	PIN 5X10	2
50	MITBC331D.01.01.00-4	FAN COVER	1
51	MIGB/T2671.2 M5X20	SCREW M5X20	4
52	MITBC430D.01.14.01-00	CLUTCH DRUM	1
53	MIGB/T893.1 35	CIRCLIP (SIZE 35)	1
54	MIGB/T276 6202-ZZ	BEARING 6202	1
55	MIGB/T894.1 15	STOP RING (SIZE 15)	1
56	MITBC331D.01.14.00-1	CLUTCH DRUM HOUSING	1
57	MIGB/T2671.2 M6X20	SCREW M6X20	4
58	MITBC430D.01.14.00-2	ANTIVIBE RUBBER	1
59	MITBC430D.01.14.00-4	CLAMP RH	1
60	MITBC430D.01.14.00-3	CLAMP LH	1
61	MIGB/T2671.2 M5X25	SCREW M5X25	2
62	MIGB/T2671.2 M5X12	SCREW M5X12	1
63	MIGB/T2671.2 M5X60	SCREW M5X60-10	2
64	MIGB/T2671.2 M5X12	SCREW M5X12	1
65	MITBC331D.01.00.00-7	MUFFLER COVER	1
66	MITBC330D.01.09.00-00	MUFFLER	1
67	MITBC331D.01.00.00-10	GASKET - MUFFLER	1
68	MITBC330D.01.00.00-5	GASKET - MUFFLER	1
69	MIGB/T2671.2 M5X12	SCREW M5X12	1
70	MIGB/T2671.2 M4X12	SCREW M4X12	1
71	MITBC330D.01.00.00-3	GASKET	1
72	MITBC331D.01.00.01-00	MANIFOLD	1
73	MITBC431D.01.00.00-12	STRAP	1
74	MIGB/T845 ST3.5X9.5	ST SCREW 3.5X9.5	1
75	MIGB/T2671.2 M5X22	SCREW M5X22	2
76	MIYD38-3.01.00-8	CARBURETOR GASKET	1
77	MITBC331D.01.06.00-00	CARBURETOR	1
78	MITBC331D.01.08.00-00	AIR FILTER ASSEMBLY	1
79	MITBC431D.01.08.00-1	AIR BOX BASE	1
80	MIGB/T2671.2 M5X45	SCREW M5X45	2
81	MITBC431D.01.08.00-3	AIR FILTER	1
82	MITBC331D.01.08.00-2	AIR BOX COVER	1
83	MITBC431D.01.13.01	FUEL CAP ASSY	1
86	MITBC331D.01.13.00-1	TANK	1
87	MITBC431D.01.13.00-2	FUEL TANK RUBBER	4
88	MITBC331D.01.00.00-8	FUEL TANK BRACKET	1
89	MIGB/T2671.2 M5X25	SCREW M5X25	4
90	MIA45.011.1.0200	VENT VALVE	1
91	MITBC431D.01.13.00-6	BREATHER PIPE	1
92	MITBC430D.01.13.00-4	FUEL PIPE	1
93	MITBC430D.01.13.00-5	RETURN PIPE	1
94	MIC43.1107.0003	FUEL GROMMET	1
95	MIA45.0102.0103	CIRCLIP	1
96	MIA38.0311.0500	FUEL FILTER	1

Appliance Parts Drawing: 26U

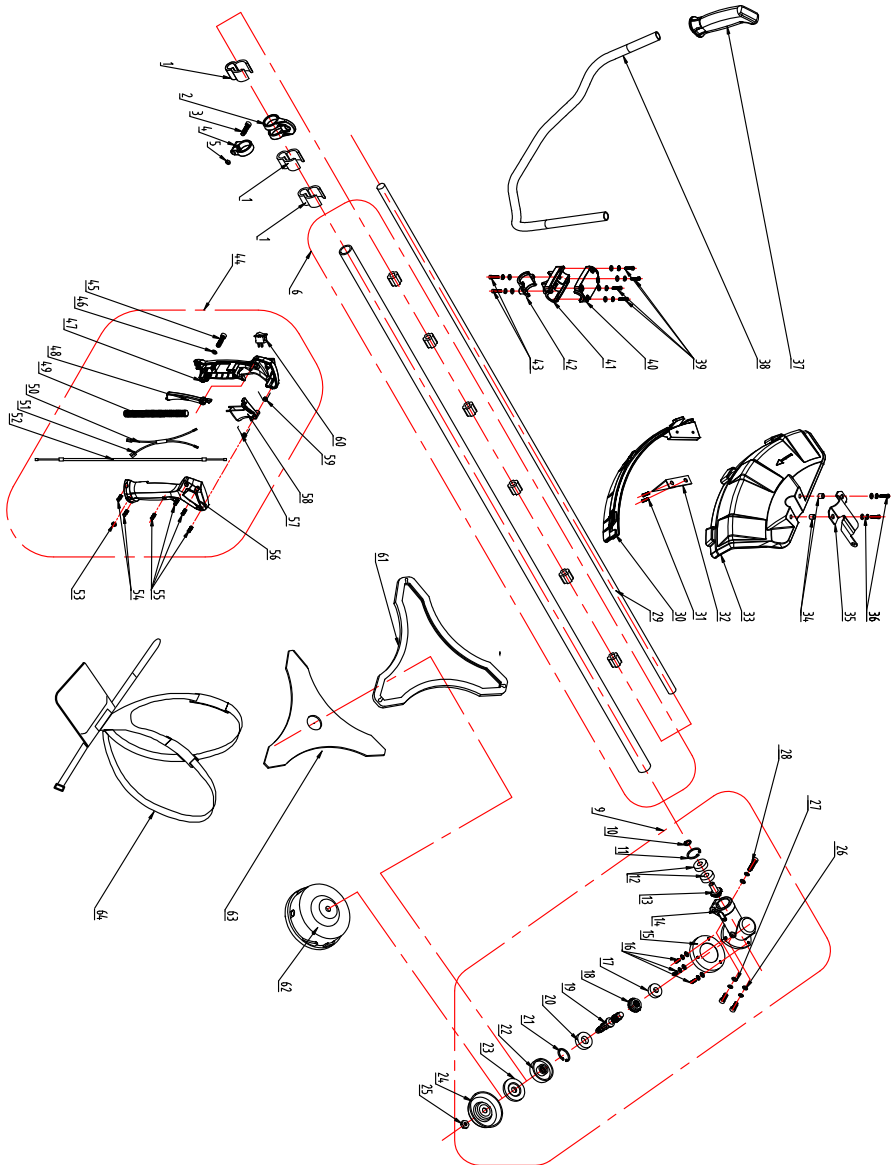

Appliance Parts List: 26U

ID	PART NUMBER	DESCRIPTION	QTY	ID	PART NUMBER	DESCRIPTION	QTY
1	MITBC431D.02.00-3	CLAMP	3	34	MIC43.1113.0102	SPACER	2
2	MITBC430D.03.02-00	HARNES CLAMP LOOP	1	35	MITBC430D.06.00-1	CLAMP 26MM	1
3	MIGB/T2671.2 M5X20	SCREW M5X20	1	36	MIGB/T2671.2 M6X20	SCREW M6X20	2
4	MITBC430D.03.00-2	CLAMP	1	37	MITBC431D.05.00-2	RUBBER HANDLE	1
5	MIGB/T6170 M5	NUT M5	1	38	MITBC431D.05.00-1	AL TUBING	1
6	MITBC4315.03.01-00	OUTER SHAFT	1	39	MIGB/T2671.2 M5X25	SCREW M5X25	4
9	MITBC431D.04.00-00	GEAR BOX ASSEMBLY	1	40	MITBC431D.05.03-3	UPPER CLAMP	1
10	MIGB/T894.1 10	CIRCLIP (SIZE 10)	1	41	MITBC431D.05.03-1	MIDDLE CLAMP	1
11	MIGB/T893.1 26	E CLIP (SIZE 26)	1	42	MITBC431D.05.03-2	LOWER HANDLE CLAMP	1
12	MIGB/T276 6000-2Z	BALL BEARING 6000-2Z	2	43	MIGB/T2671.2 M5X25	SCREW M5X25	2
13	MIC43.0116.0002	PINION	1	44	MITBC431D.05.01-00	CONTROL HANDLE ASSEMBLY	1
14	MITBC431D.04.00-1	GEAR BOX	1	45	MIGB/T2671.2 M5X30	SCREW M5X30	1
15	MIC43.0116.0007	TOP GUARD	1	46	MIGB/T97.1 M5	WASHER M5	1
16	MIGB/T70.1 M5X8	SCREW M5X8	3	47	MITBC431D.05.01-2	THROTTLE HOUSING LH	1
17	MIGB/T276 6000-2Z	BALL BEARING 6000-2Z	1	48	MITBC431D.05.01-5	LOCK TRIGGER	1
18	MIC43.0116.0004	GEAR	1	49	MITBC431D.05.01-7	CONDUIT	1
19	MITBC431D.04.00-3	GEAR SHAFT	1	50	MITBC431D.05.07-00	WIRE CABLE A	1
20	MIGB/T276 6002-2Z	BALL BEARING 6002-2Z	1	51	MITBC431D.05.08-00	WIRE CABLE B	1
21	MIGB/T893.1 26	E CLIP (SIZE 26)	1	52	MITBC431D.05.05-00	THROTTLE CABLE ASSEMBLY	1
22	MITBC431D.04.00-6	BLADE CLAMP - LOWER	1	53	MIGB/T6170 M5	NUT M5	1
23	MITBC431D.04.00-5	BLADE CLAMP - UPPER	1	54	MIGB/T845 ST3.5X9.5	ST SCREW 3.5X9.5	2
24	MITBC431D.04.00-8	NUT PROTECTOR	1	55	MIGB/T845 ST4.2X10	ST SCREW 4.2X10	4
25	GB/T6177.2 M10X1.25	NUT M10X1.25	1	56	MITBC431D.05.01-1	THROTTLE HOUSING RH	1
26	MIGB/T70.1 M6X12	SCREW M6X12	1	57	MITBC431D.05.01-4	SPRING - TRIGGER	1
27	MIGB/T2671.2 M6X12	SCREW M6X12	1	58	MITBC431D.05.01-3	TRIGGER	1
28	MIGB/T2671.2 M6X25	SCREW M6X25	1	59	MITBC431D.05.01-6	SPRING - TRIGGER	1
29	MITBC430D.03.00-1	DRIVER SHAFT	1	60	MIYD38-3.01.11.04-00	ON/OFF SWITCH	1
30	MITBC431D.06.01-1	SKIRT	1	61	MITBC431D.02.00-2	BLADE COVER	1
31	MIGB/T845 ST4.8X13	TAPPING SCREW ST4.8X13	2	62	MITBC430D.02.01-00	NYLON HEAD ASSY	1
32	MITBC431D.06.00-2	LINE CUTTER	1	63	MIC43.1100.0001	BLADE	1
33	MITBC431D.06.02-00	DEBRIS GUARD	1	64	MI00.07.06.0008	HARNES	1

Engine Parts Drawing: 33L

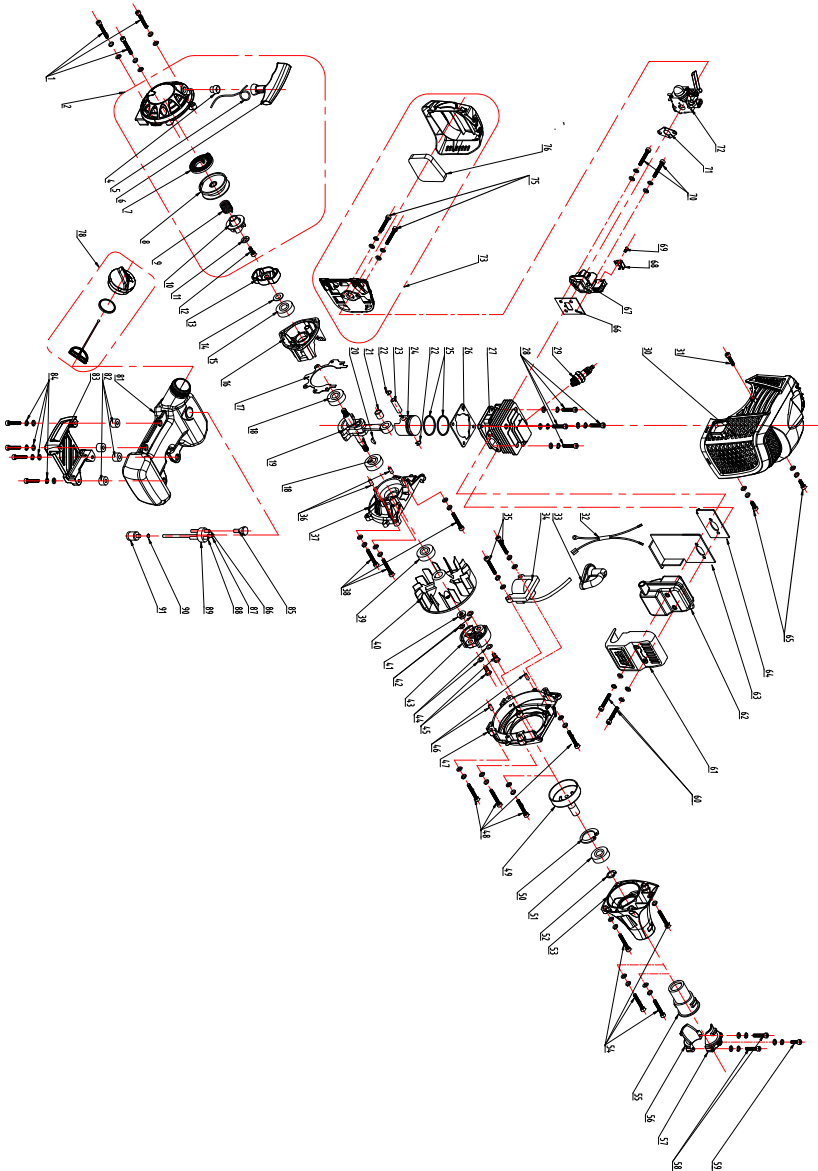

Engine Parts List: 33L

ID	PART NUMBER	DESCRIPTION	QTY
1	MIGB/T2671.2 M5X20	SCREW M5X20	2
2	MIGB/T2671.2 M5X25	SCREW M5X25	2
3	MIYD25.02.00-3	STARTER HANDLE	1
4	MIYD25.02.01-2	ROPE GUIDE	1
6	MITBC431D.01.12.00-00	STARTER ASSEMBLY	1
7	MITBC430D.01.12.00-2	STARTER ROPE	1
8	MITBC430D.01.12.00-4	RECOIL SPRING	1
9	MITBC431D.01.12.00-3	STARTER PULLEY	1
10	MITBC430D.01.12.00-5	SPRING - STARTER	1
11	MITBC431D.01.12.00-6	RATCHET WHEEL	1
12	MIGB/T9074.19 ST4.8X19	ST SCREW 4.8X19	1
13	MIGB/T9074.19 5X16X1	PLATE WASHER 5X16X1	1
14	MITBC430D.01.00.00-6	STARTER GASKET	1
15	MIGB/T6175 M8	NUT M8	1
16	MITBC430D.01.00.02-00	STARTER RATCHET ASSY	1
17	MIGB/T971 M8	FLAT WASHER M8	1
18	MIYD38-3.01.01.02-00	OIL SEAL 12X22X7	1
19	MITBC330D.01.01.00-2	CRANKCASE RH	1
20	MITBC330D.01.01.00-3	GASKET - CRANKCASE	1
21	MIGB/T276 6201	BALL BEARING 6201	2
22	MITBC331D.01.03.01-00	CRANK SHAFT ASSY	1
23	MIGB/T1099 3X5X13	KEY 3X5X13	1
24	MITBC330D.01.03.03-00	BEARING	1
25	MITBC330D.01.03.00-3	CIRCLIP \ PISTON PIN	2
26	MITBC330D.01.03.00-2	PISTON PIN	1
27	MITBC330D.01.03.02-00	PISTON	1
28	MITBC330D.01.03.00-1	PISTON RING	2
29	MITBC330D.01.00.00-2	GASKET - CYLINDER	1
30	MITBC331D.01.00.00-1	CYLINDER	1
31	MIGB/T2671.2 M5X20	SCREW M5X20	4
32	SPBPMR7A	SPARK PLUG (BPMR7A NGK)	1
33	MITBC331D.01.00.00-9	ENGINE COVER	1
34	MITBC330D.01.11.02-00	WIRE	1
35	MITBC431D.01.11.00-1	PLUG CAP	1
36	MIGB/T2671.2 M5X25	SCREW M5X25	2
37	MITBC330D.01.11.01-00	IGNITION COIL	1
38	MIGB/T119.2 5X10	PIN 5X10	2
39	MITBC330D.01.01.00-1	CRANKCASE LH	1
40	MIGB/T2671.2 M5X30	SCREW M5X30	4
41	MIYD38-3.01.01.02-00	OIL SEAL 12X22X7	1
42	MITBC330D.01.10.00-00	FLYWHEEL	1
43	MIGB/T6187 M8	FLANGE NUT M8	1
44	MITBC430D.01.00.00-9	FLAT WASHER 8X16X1.5	2
45	MITBC431D.01.00.04-00	CLUTCH ASSEMBLY	1
46	MIGB/T755 M10	SPRING WASHER 10	2
47	MITBC430D.01.00.00-8	BOLT - CLUTCH	2
48	MITBC330D.01.00.00-6	PLASTIC PLATE	1
49	MIGB/T119.2 5X10	PIN 5X10	2
50	MITBC331D.01.01.00-4	FAN COVER	1
51	MIGB/T2671.2 M5X20	SCREW M5X20	4
52	MITBC430D.01.14.01-00	CLUTCH DRUM	1
53	MIGB/T893.1 35	CIRCLIP (SIZE 35)	1
54	MIGB/T276 6202-2Z	BEARING 6202	1
55	MIGB/T894.1 15	STOP RING (SIZE 15)	1
56	MITBC331D.01.14.00-1	CLUTCH DRUM HOUSING	1
57	MIGB/T2671.2 M6X20	SCREW M6X20	4
58	MITBC430D.01.14.00-2	ANTIVIBE RUBBER	1
59	MITBC430D.01.14.00-4	CLAMP RH	1
60	MITBC430D.01.14.00-3	CLAMP LH	1
61	MIGB/T2671.2 M5X25	SCREW M5X25	2
62	MIGB/T2671.2 M5X12	SCREW M5X12	1
63	MIGB/T2671.2 M5X60	SCREW M5X60-10	2
64	MIGB/T2671.2 M5X12	SCREW M5X12	1
65	MITBC331D.01.00.00-7	MUFFLER COVER	1
66	MITBC330D.01.09.00-00	MUFFLER	1
67	MITBC331D.01.00.00-10	GASKET - MUFFLER	1
68	MITBC330D.01.00.00-5	GASKET - MUFFLER	1
69	MIGB/T2671.2 M5X12	SCREW M5X12	1
70	MIGB/T2671.2 M4X12	SCREW M4X12	1
71	MITBC330D.01.00.00-3	GASKET	1
72	MITBC331D.01.00.01-00	MANIFOLD	1
73	MITBC431D.01.00.00-12	STRAP	1
74	MIGB/T845 ST3.5X9.5	ST SCREW 3.5X9.5	1
75	MIGB/T2671.2 M5X22	SCREW M5X22	2
76	MIYD38-3.01.00-8	CARBURETOR GASKET	1
77	MITBC331D.01.06.00-00	CARBURETOR	1
78	MITBC331D.01.08.00-00	AIR FILTER ASSEMBLY	1
79	MITBC431D.01.08.00-1	AIR BOX BASE	1
80	MIGB/T2671.2 M5X45	SCREW M5X45	2
81	MITBC431D.01.08.00-3	AIR FILTER	1
82	MITBC331D.01.08.00-2	AIR BOX COVER	1
83	MITBC431D.01.13.01	FUEL CAP ASSY	1
86	MITBC331D.01.13.00-1	TANK	1
87	MITBC431D.01.13.00-2	FUEL TANK RUBBER	4
88	MITBC331D.01.00.00-8	FUEL TANK BRACKET	1
89	MIGB/T2671.2 M5X25	SCREW M5X25	4
90	MIA45.0111.0200	VENT VALVE	1
91	MITBC431D.01.13.00-6	BREATHER PIPE	1
92	MITBC430D.01.13.00-4	FUEL PIPE	1
93	MITBC430D.01.13.00-5	RETURN PIPE	1
94	MIC43.1107.0003	FUEL GROMMET	1
95	MIA45.0102.0103	CIRCLIP	1
96	MIA38.0311.0500	FUEL FILTER	1

Appliance Parts Drawing: 33L

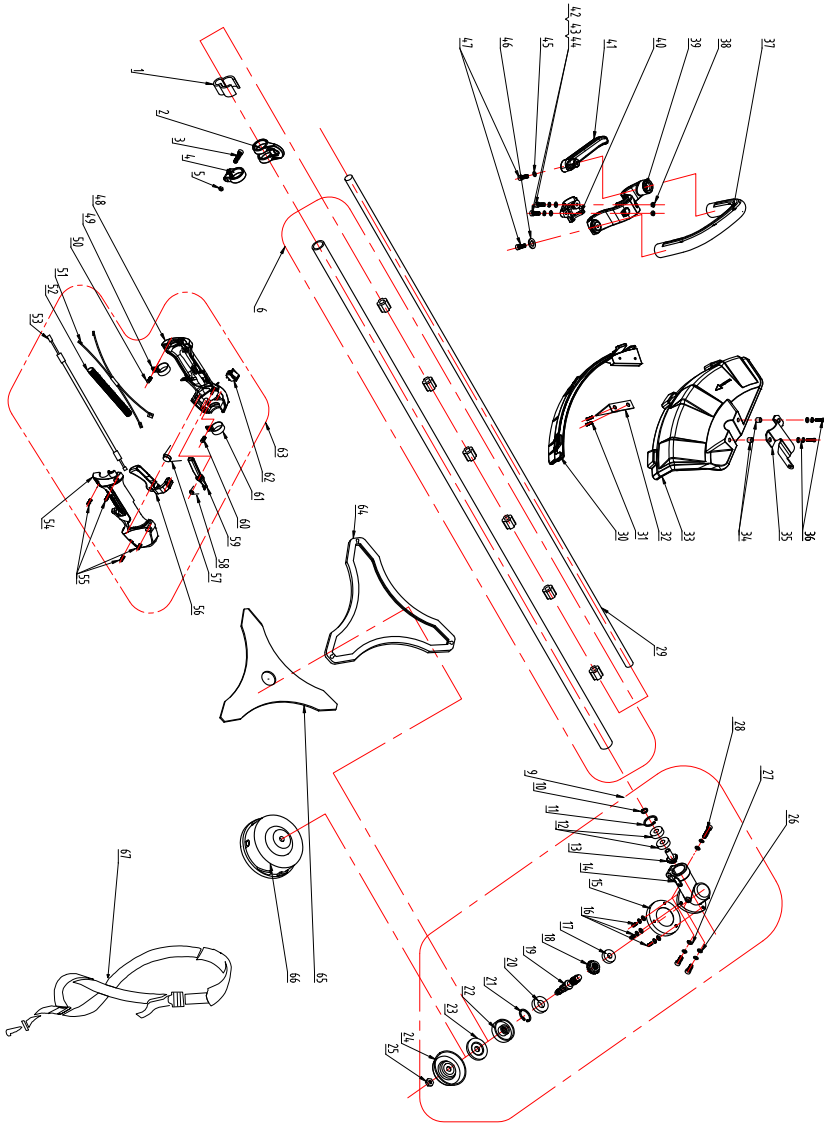

Appliance Parts List: 33L

ID.	PART No	DESCRIPTION	
1	MITBC431D.02.00-3	CLAMP	1
2	MITBC430D.03.02-00	HARNES CLAMP LOOP	1
3	MIGB/T2671.2 M5X20	SCREW M5X20	1
4	MITBC430D.03.00-2	CLAMP	1
5	MIGB/T6170 M5	NUT M5	1
6	MITBC431S.03.01-00	OUTER SHAFT ASSEMBLY	1
9	MITBC431D.04.00-00	GEAR BOX ASSEMBLY	1
10	MIGB/T894.1 10	CIRCLIP (SIZE 10)	1
11	MIGB/T893.1 26	CIRCLIP (SIZE 26)	1
12	MIGB/T276 6000-2Z	BALL BEARING 6000-2Z	2
13	MIC43.0116.0002	PINION	1
14	MITBC431D.04.00-1	GEARBOX	1
15	MIC43.0116.0007	TOP GUARD	1
16	MIGB/T70.1 M5X8	SCREW M5X8	3
17	MIGB/T276 6000-2Z	BALL BEARING 6000-2Z	1
18	MIC43.0116.0004	GEAR	1
19	MITBC431D.04.00-3	GEAR SHAFT	1
20	MIGB/T276 6002-2Z	BALL BEARING 6002-2Z	1
21	MIGB/T893.1 26	CIRCLIP (SIZE 26)	1
22	MITBC431D.04.00-6	BLADE CLAMP - LOWER	1
23	MITBC431D.04.00-5	BLADE CLAMP - UPPER	1
24	MITBC431D.04.00-8	NUT PROTECTOR	1
25	MIGB/T6177.2 M10X1.25	FLANGE NUT M10X1.25 LH	1
26	MIGB/T70.1 M6X12	SCREW M6X12	1
27	MIGB/T2671.2 M6X12	SCREW M6X12	1
28	MIGB/T2671.2 M6X25	SCREW M6X25	1
29	MITBC430D.03.00-1	DRIVE SHAFT	1
30	MITBC431D.06.01-1	SKIRT	1
31	MIGB/T845 ST4.8X13	TAPPING SCREW ST4.8X13	2
32	MITBC431D.06.00-2	LINE CUTTER	1
33	MITBC431D.06.02-00	DEBRIS GUARD	1
34	MIC43.1113.0102	SPACER	2
35	MITBC430D.06.00-1	CLAMP 26MM	1
36	MIGB/T2671.2 M6X20	SCREW M6X20	2
37	MITBC431S.05.01-1	FRONT HANDLE	1
38	MIGB/T6170 M5	NUT M5	2
39	MITBC431S.05.01-2	HANDLE BASE	1

ID.	PART No	DESCRIPTION	
40	MITBC431S.05.01-3	HANDLE CLAMP	1
41	MITBC431S.05.01-4	HANDLE BAR	1
42	MIGB/T2671.2 M5X28	SCREW M5X28	2
43	MIGB/T93 M5	SPRING WASHER M5	2
44	MIGB/T97.1 5X12X1.5	PLATE WASHER	2
45	MIGB/T97.1 5X11X2	PLATE WASHER 1.5X11X2	1
46	MIGB/T97.1 5X12X1.5	PLATE WASHER	1
47	MIGB/T845 ST4.8X19	TAPPING SCREW ST4.8X19	2
48	MITBC0225.2.1	THROTTLE HANDLE LH	1
49	MITBC0225.2-7A	FIXING CLAMP	1
50	MIGB/T70.1 M5X14	CAP HEAD SCREW M5X14	1
51	MITBC1435.05.02-12A/13A	SWITCH WIRES	1
52	MITBC1435.05.02-11A	CABLE SLEEVE	1
53	MITBC1435.05.02-10A	THROTTLE CABLE ASSEMBLY	1
54	MITBC0225.2.2	THROTTLE HANDLE RH	1
55	MIGB/T845 ST4X10	SCREW ST4X10	4
56	MITBC0225.2-1	TRIGGER	1
57	MITBC0225.2-4	SPRING	1
58	MITBC0225.2-6	SPRING	1
59	MITBC0225.2-2	LOCK TRIGGER	1
60	MIGB/T70.1 M5X14	CAP HEAD SCREW M5X14	1
61	MITBC0225.2-7A	FIXING CLAMP	1
62	MIYD38-3.01.11.04-00	ON/OFF SWITCH	1
63	MIC43.1311.0500	THROTTLE ASSEMBLY	1
64	MITBC431D.02.00-2	BLADE COVER	1
65	MITBC430D.02.01-00	NYLON HEAD ASSEMBLY	1
66	MIC43.1100.0001	BLADE	1
67	MI00.07.06.0007	HARNES - SINGLE STRAP	1

Engine Parts Drawing: 33U

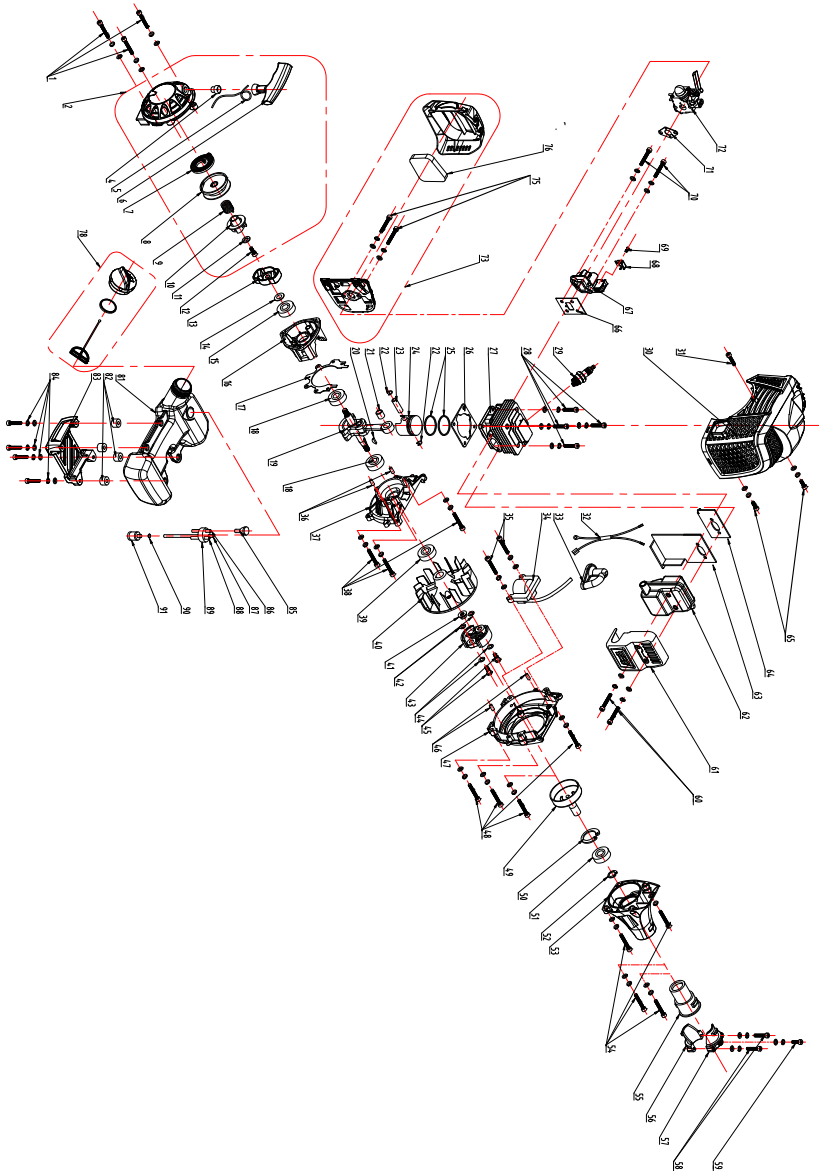



Engine Parts List: 33U

ID	PART NUMBER	DESCRIPTION	QTY
1	MIGB/T2671.2 M5X20	SCREW M5X20	2
2	MIGB/T2671.2 M5X25	SCREW M5X25	2
3	MIYD25.02.00-3	STARTER HANDLE	1
4	MIYD25.02.01-2	ROPE GUIDE	1
6	MITBC431D.01.12.00-00	STARTER ASSEMBLY	1
7	MITBC430D.01.12.00-2	STARTER ROPE	1
8	MITBC430D.01.12.00-4	RECOIL SPRING	1
9	MITBC431D.01.12.00-3	STARTER PULLEY	1
10	MITBC430D.01.12.00-5	SPRING - STARTER	1
11	MITBC431D.01.12.00-6	RATCHET WHEEL	1
12	MIGB/T9074.19 ST4.8X19	ST SCREW 4.8X19	1
13	MIGB/T9074.19 5X16X1	PLATE WASHER 5X16X1	1
14	MITBC430D.01.00.00-6	STARTER GASKET	1
15	MIGB/T6175 M8	NUT M8	1
16	MITBC430D.01.00.02-00	STARTER RATCHET ASSY	1
17	MIGB/T971 M8	FLAT WASHER M8	1
18	MIYD38-3.01.01.02-00	OIL SEAL 12X22X7	1
19	MITBC330D.01.01.00-2	CRANKCASE RH	1
20	MITBC330D.01.01.00-3	GASKET - CRANKCASE	1
21	MIGB/T276 6201	BALL BEARING 6201	2
22	MITBC331D.01.03.01-00	CRANK SHAFT ASSY	1
23	MIGB/T1099 3X5X13	KEY 3X5X13	1
24	MITBC330D.01.03.03-00	BEARING	1
25	MITBC330D.01.03.00-3	CIRCLIP \ PISTON PIN	2
26	MITBC330D.01.03.00-2	PISTON PIN	1
27	MITBC330D.01.03.02-00	PISTON	1
28	MITBC330D.01.03.00-1	PISTON RING	2
29	MITBC330D.01.00.00-2	GASKET - CYLINDER	1
30	MITBC331D.01.00.00-1	CYLINDER	1
31	MIGB/T2671.2 M5X20	SCREW M5X20	4
32	SPBPMR7A	SPARK PLUG (BPMR7A NGK)	1
33	MITBC331D.01.00.00-9	ENGINE COVER	1
34	MITBC330D.01.11.02-00	WIRE	1
35	MITBC431D.01.11.00-1	PLUG CAP	1
36	MIGB/T2671.2 M5X25	SCREW M5X25	2
37	MITBC330D.01.11.01-00	IGNITION COIL	1
38	MIGB/T119.2 5X10	PIN 5X10	2
39	MITBC330D.01.01.00-1	CRANKCASE LH	1
40	MIGB/T2671.2 M5X30	SCREW M5X30	4
41	MIYD38-3.01.01.02-00	OIL SEAL 12X22X7	1
42	MITBC330D.01.10.00-00	FLYWHEEL	1
43	MIGB/T6187 M8	FLANGE NUT M8	1
44	MITBC430D.01.00.00-9	FLAT WASHER 8X16X1.5	2
45	MITBC431D.01.00.04-00	CLUTCH ASSEMBLY	1
46	MIGB/T755 M10	SPRING WASHER 10	2
47	MITBC430D.01.00.00-8	BOLT - CLUTCH	2
48	MITBC330D.01.00.00-6	PLASTIC PLATE	1
49	MIGB/T119.2 5X10	PIN 5X10	2
50	MITBC331D.01.01.00-4	FAN COVER	1
51	MIGB/T2671.2 M5X20	SCREW M5X20	4
52	MITBC430D.01.14.01-00	CLUTCH DRUM	1
53	MIGB/T893.1 35	CIRCLIP (SIZE 35)	1
54	MIGB/T276 6202-2Z	BEARING 6202	1
55	MIGB/T894.1 15	STOP RING (SIZE 15)	1
56	MITBC331D.01.14.00-1	CLUTCH DRUM HOUSING	1
57	MIGB/T2671.2 M6X20	SCREW M6X20	4
58	MITBC430D.01.14.00-2	ANTIVIBE RUBBER	1
59	MITBC430D.01.14.00-4	CLAMP RH	1
60	MITBC430D.01.14.00-3	CLAMP LH	1
61	MIGB/T2671.2 M5X25	SCREW M5X25	2
62	MIGB/T2671.2 M5X12	SCREW M5X12	1
63	MIGB/T2671.2 M5X60	SCREW M5X60-10	2
64	MIGB/T2671.2 M5X12	SCREW M5X12	1
65	MITBC331D.01.00.00-7	MUFFLER COVER	1
66	MITBC330D.01.09.00-00	MUFFLER	1
67	MITBC331D.01.00.00-10	GASKET - MUFFLER	1
68	MITBC330D.01.00.00-5	GASKET - MUFFLER	1
69	MIGB/T2671.2 M5X12	SCREW M5X12	1
70	MIGB/T2671.2 M4X12	SCREW M4X12	1
71	MITBC330D.01.00.00-3	GASKET	1
72	MITBC331D.01.00.01-00	MANIFOLD	1
73	MITBC431D.01.00.00-12	STRAP	1
74	MIGB/T845 ST3.5X9.5	ST SCREW 3.5X9.5	1
75	MIGB/T2671.2 M5X22	SCREW M5X22	2
76	MIYD38-3.01.00-8	CARBURETOR GASKET	1
77	MITBC331D.01.06.00-00	CARBURETOR	1
78	MITBC331D.01.08.00-00	AIR FILTER ASSEMBLY	1
79	MITBC431D.01.08.00-1	AIR BOX BASE	1
80	MIGB/T2671.2 M5X45	SCREW M5X45	2
81	MITBC431D.01.08.00-3	AIR FILTER	1
82	MITBC331D.01.08.00-2	AIR BOX COVER	1
83	MITBC431D.01.13.01	FUEL CAP ASSY	1
86	MITBC331D.01.13.00-1	TANK	1
87	MITBC431D.01.13.00-2	FUEL TANK RUBBER	4
88	MITBC331D.01.00.00-8	FUEL TANK BRACKET	1
89	MIGB/T2671.2 M5X25	SCREW M5X25	4
90	MIA45.0111.0200	VENT VALVE	1
91	MITBC431D.01.13.00-6	BREATHER PIPE	1
92	MITBC430D.01.13.00-4	FUEL PIPE	1
93	MITBC430D.01.13.00-5	RETURN PIPE	1
94	MIC43.1107.0003	FUEL GROMMET	1
95	MIA45.0102.0103	CIRCLIP	1
96	MIA38.0311.0500	FUEL FILTER	1

Appliance Parts Drawing: 33U

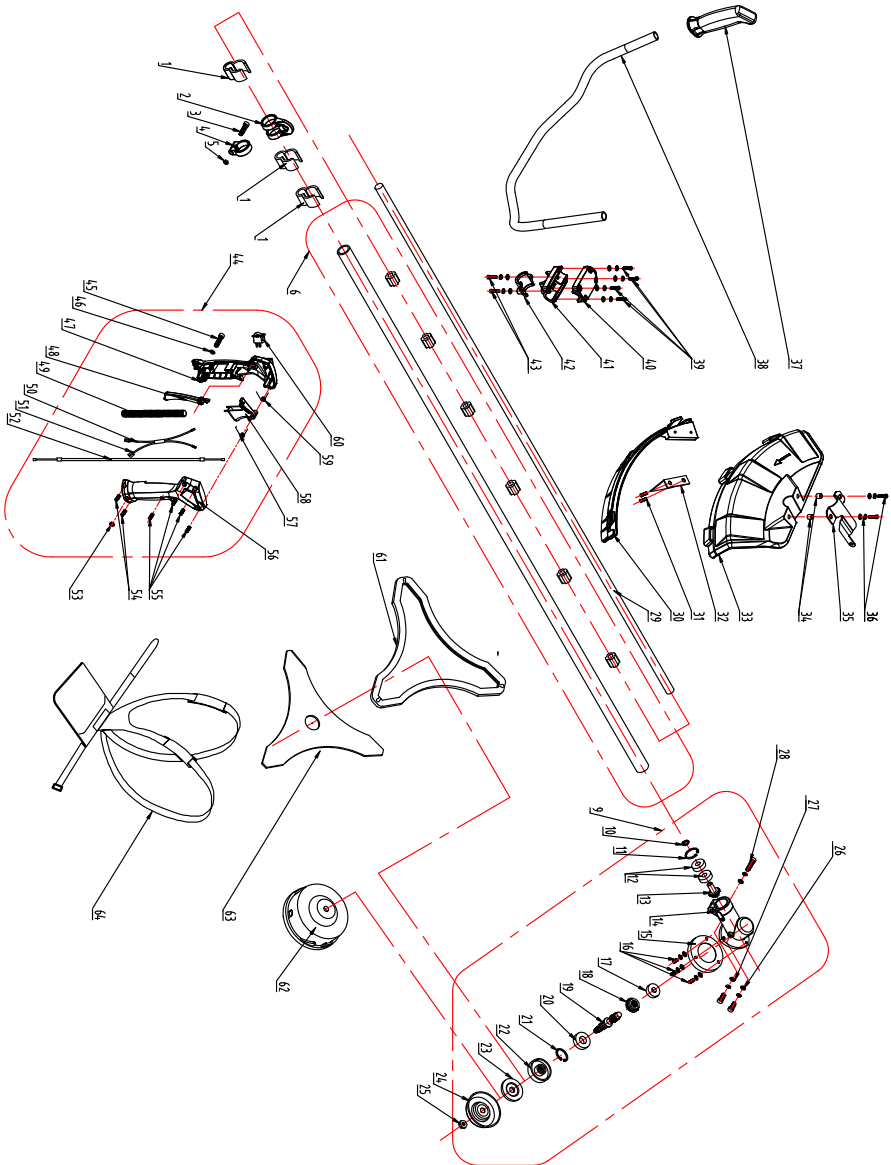

Appliance Parts List: 33U

ID	PART NUMBER	DESCRIPTION	QTY	ID	PART NUMBER	DESCRIPTION	QTY
1	MITBC431D.02.00-3	CLAMP	3	34	MIC43.1113.0102	SPACER	2
2	MITBC430D.03.02-00	HARNES CLAMP LOOP	1	35	MITBC430D.06.00-1	CLAMP 26MM	1
3	MIGB/T2671.2 M5X20	SCREW M5X20	1	36	MIGB/T2671.2 M6X20	SCREW M6X20	2
4	MITBC430D.03.00-2	CLAMP	1	37	MITBC431D.05.00-2	RUBBER HANDLE	1
5	MIGB/T6170 M5	NUT M5	1	38	MITBC431D.05.00-1	AL TUBING	1
6	MITBC4315.03.01-00	OUTER SHAFT	1	39	MIGB/T2671.2 M5X25	SCREW M5X25	4
9	MITBC431D.04.00-00	GEAR BOX ASSEMBLY	1	40	MITBC431D.05.03-3	UPPER CLAMP	1
10	MIGB/T894.1 10	CIRCLIP (SIZE 10)	1	41	MITBC431D.05.03-1	MIDDLE CLAMP	1
11	MIGB/T893.1 26	E CLIP (SIZE 26)	1	42	MITBC431D.05.03-2	LOWER HANDLE CLAMP	1
12	MIGB/T276 6000-2Z	BALL BEARING 6000-2Z	2	43	MIGB/T2671.2 M5X25	SCREW M5X25	2
13	MIC43.0116.0002	PINION	1	44	MITBC431D.05.01-00	CONTROL HANDLE ASSEMBLY	1
14	MITBC431D.04.00-1	GEAR BOX	1	45	MIGB/T2671.2 M5X30	SCREW M5X30	1
15	MIC43.0116.0007	TOP GUARD	1	46	MIGB/T97.1 M5	WASHER M5	1
16	MIGB/T70.1 M5X8	SCREW M5X8	3	47	MITBC431D.05.01-2	THROTTLE HOUSING LH	1
17	MIGB/T276 6000-2Z	BALL BEARING 6000-2Z	1	48	MITBC431D.05.01-5	LOCK TRIGGER	1
18	MIC43.0116.0004	GEAR	1	49	MITBC431D.05.01-7	CONDUIT	1
19	MITBC431D.04.00-3	GEAR SHAFT	1	50	MITBC431D.05.07-00	WIRE CABLE A	1
20	MIGB/T276 6002-2Z	BALL BEARING 6002-2Z	1	51	MITBC431D.05.08-00	WIRE CABLE B	1
21	MIGB/T893.1 26	E CLIP (SIZE 26)	1	52	MITBC431D.05.05-00	THROTTLE CABLE ASSEMBLY	1
22	MITBC431D.04.00-6	BLADE CLAMP - LOWER	1	53	MIGB/T6170 M5	NUT M5	1
23	MITBC431D.04.00-5	BLADE CLAMP - UPPER	1	54	MIGB/T845 ST3.5X9.5	ST SCREW 3.5X9.5	2
24	MITBC431D.04.00-8	NUT PROTECTOR	1	55	MIGB/T845 ST4.2X10	ST SCREW 4.2X10	4
25	GB/T6177.2 M10X1.25	NUT M10X1.25	1	56	MITBC431D.05.01-1	THROTTLE HOUSING RH	1
26	MIGB/T70.1 M6X12	SCREW M6X12	1	57	MITBC431D.05.01-4	SPRING - TRIGGER	1
27	MIGB/T2671.2 M6X12	SCREW M6X12	1	58	MITBC431D.05.01-3	TRIGGER	1
28	MIGB/T2671.2 M6X25	SCREW M6X25	1	59	MITBC431D.05.01-6	SPRING - TRIGGER	1
29	MITBC430D.03.00-1	DRIVER SHAFT	1	60	MIYD38-3.01.11.04-00	ON/OFF SWITCH	1
30	MITBC431D.06.01-1	SKIRT	1	61	MITBC431D.02.00-2	BLADE COVER	1
31	MIGB/T845 ST4.8X13	TAPPING SCREW ST4.8X13	2	62	MITBC430D.02.01-00	NYLON HEAD ASSY	1
32	MITBC431D.06.00-2	LINE CUTTER	1	63	MIC43.1100.0001	BLADE	1
33	MITBC431D.06.02-00	DEBRIS GUARD	1	64	MI00.07.06.0008	HARNES	1

Engine Parts Drawing: 43U

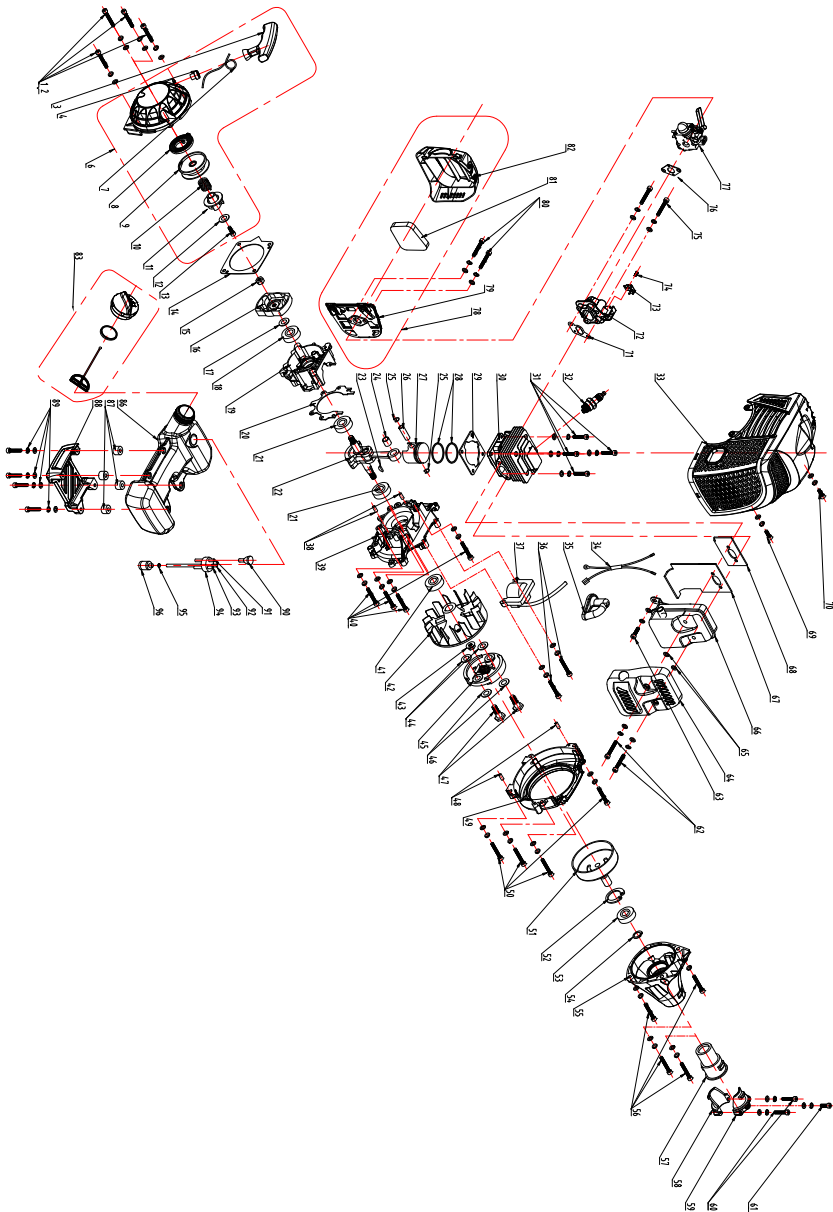

Engine Parts List: 43U

ID	PART NUMBER	DESCRIPTION	QTY
1	MIGB/T2671.2 M5X20	SCREW M5X20	2
2	MIGB/T2671.2 M5X25	SCREW M5X25	2
3	MIA62.0110.0002	STARTER HANDLE	1
4	MIYD25.02.01-2	ROPE GUIDE	1
6	MITBC431D.01.12.00-00	STARTER ASSEMBLY	1
7	MITBC430D.01.12.00-2	STARTER ROPE	1
8	MITBC430D.01.12.00-4	RECOIL SPRING	1
9	MITBC431D.01.12.00-3	STARTER PULLEY	1
10	MITBC430D.01.12.00-5	SPRING - STARTER	1
11	MITBC431D.01.12.00-6	RATCHET WHEEL	1
12	MIGB/T9074.19 5X16X19	ST SCREW 4.8X19	1
13	MIGB/T9074.19 5X16X1	PLATE WASHER 5X16X1	1
14	MITBC430D.01.00.00-6	STARTER GASKET	1
15	MIGB/T6175 M8	NUT M8	1
16	MITBC430D.01.00.02-00	STARTER RATCHET ASSY	1
17	MIGB/T97.1 M8	FLAT WASHER M8	1
18	MIYD38-3.01.01.02-00	OIL SEAL 12X22X7	1
19	MITBC430D.01.01.00-2	CRANKCASE RH	1
20	MITBC430D.01.01.00-3	GASKET - CRANKCASE	1
21	MIGB/T276 6202	BALL BEARING 6202-2Z	2
22	MITBC430D.01.03.01-00	CRANKSHAFT	1
23	MIGB/T1099 3X5X13	KEY 3X5X13	1
24	MITBC430D.01.03.03-00	BEARING ?10X1 3X16	1
25	MIYD38-3.01.03.00-4	PISTON PIN CIRCLIP	2
26	MITBC430D.01.03.00-2	PISTON PIN	1
27	MITBC430D.01.03.02-00	PISTON	1
28	MITBC430D.01.03.00-1	PISTON RING	2
29	MITBC430D.01.00.00-2	GASKET - CYLINDER	1
30	MITBC431D.01.00.00-1	CYLINDER	1
31	MIGB/T2671.2 M5X20	SCREW M5X20	4
32	SPBPMR7A	SPARK PLUG (BPMR7A NGK)	1
33	MITBC431D.01.00.00-11	ENGINE COVER	1
34	MITBC430D.01.11.02-00	WIRE	1
35	MITBC431D.01.11.00-1	PLUG CAP	1
36	MIGB/T2671.2 M5X25	SCREW M5X25	2
37	MITBC430D.01.11.01-00	IGNITION	1
38	MIGB/T119.2 5X10	PIN 5X10	2
39	MITBC430D.01.01.00-1	CRANKCASE LH	1
40	MIGB/T2671.2 M5X30	SCREW M5X30	4
41	MITBC430D.01.00.03-00	OIL-SEAL 15X30X7	1
42	MITBC430D.01.10.00-00	FLYWHEEL	1
43	MIGB/T6187 M8	FLANGE NUT M8	1
44	MITBC430D.01.00.00-9	FLAT WASHER 8X16X1.5	2
45	MITBC430D.01.00.04-00	CLUTCH ASSEMBLY	1
46	MIGB/T755 M10	SPRING WASHER 10	2
47	MITBC430D.01.00.00-8	BOLT - CLUTCH	2
48	MIGB/T119.2 5X10	PIN 5X10	2
49	MITBC431D.01.01.00-4	FAN COVER	1
50	MIGB/T2671.2 M5X25	SCREW M5X25	4
51	MITBC430D.01.14.01-00	CLUTCH DRUM	1
52	MIGB/T893.1 35	CIRCLIP (SIZE 35)	1
53	MIGB/T276 6202-2Z	BEARING 6202	1
54	MIGB/T894.1 15	STOP RING (SIZE 15)	1
55	MITBC431D.01.14.00-1B	CLUTCH HOUSING	1
56	MIGB/T2671.2 M6X20	SCREW M6X20	4
57	MITBC521D.01.14.00-2	ANTIVIBE RUBBER	1
58	MITBC521D.01.14.00-4	CLAMP RH	1
59	MITBC521D.01.14.00-3	CLAMP LH	1
60	MIGB/T2671.2 M5X25	SCREW M5X25	2
61	MIGB/T2671.2 M5X12	SCREW M5X12	1
62	MIGB/T2671.2 M6X55	SCREW M6X55	2
63	MIGB/T2671.2 M5X12	SCREW M5X12	1
64	MITBC431D.01.00.00-7	MUFFLER COVER	1
65	MIGB/T97.1 M6	FLAT WASHER M6	2
66	MITBC430D.01.09.00-00	MUFFLER	1
67	MITBC431D.01.00.00-13	GASKET - MUFFLER	1
68	MITBC430D.01.00.00-5	GASKET - MUFFLER	1
69	MIGB/T2671.2 M5X12	SCREW M5X12	1
70	MIGB/T2671.2 M4X12	SCREW M4X12	1
71	MITBC430D.01.00.00-3	GASKET	1
72	MITBC431D.01.00.01-00	MANIFOLD	1
73	MIGB/T845 S73.5X9.5	ST SCREW 3.5X9.5	1
74	MITBC431D.01.00.00-12	STRAP	1
75	MIGB/T2671.2 M5X25	SCREW M5X25	2
76	MIYD38-3.01.00-8	CARBURETOR GASKET	1
77	MITBC431D.01.06.00-00	CARBURETOR	1
78	MITBC431D.01.08.00-00	AIR FILTER ASSEMBLY	1
79	MITBC431D.01.08.00-1	AIR BOX BASE	1
80	MIGB/T2671.2 M5X45	SCREW M5X45	2
81	MITBC431D.01.08.00-3	AIR FILTER	1
82	MITBC431D.01.08.00-2	AIR BOX COVER	1
83	MITBC431D.01.13.01	FUEL CAP ASSY	1
86	MITBC431D.01.13.00-1	FUEL TANK	1
87	MITBC431D.01.13.00-2	FUEL TANK RUBBER	4
88	MITBC431D.01.00.00-10	FUEL TANK BRACKET	1
89	MIGB/T2671.2 M5X25	SCREW M5X25	4
90	MIYD45.03.04-00	BREATHER ASSY	1
91	MITBC431D.01.13.00-6	BREATHER PIPE	1
92	MITBC431D.01.13.00-4	FUEL PIPE	1
93	MITBC431D.01.13.00-5	FUEL PIPE	1
94	MITBC431D.01.13.00-3	GROMMET	1
95	MIYD45.01.01-1-3	CIRCLIP	1
96	MIYD38-3.03.04-00	FUEL FILTER	1

Appliance Parts Drawing: 43U

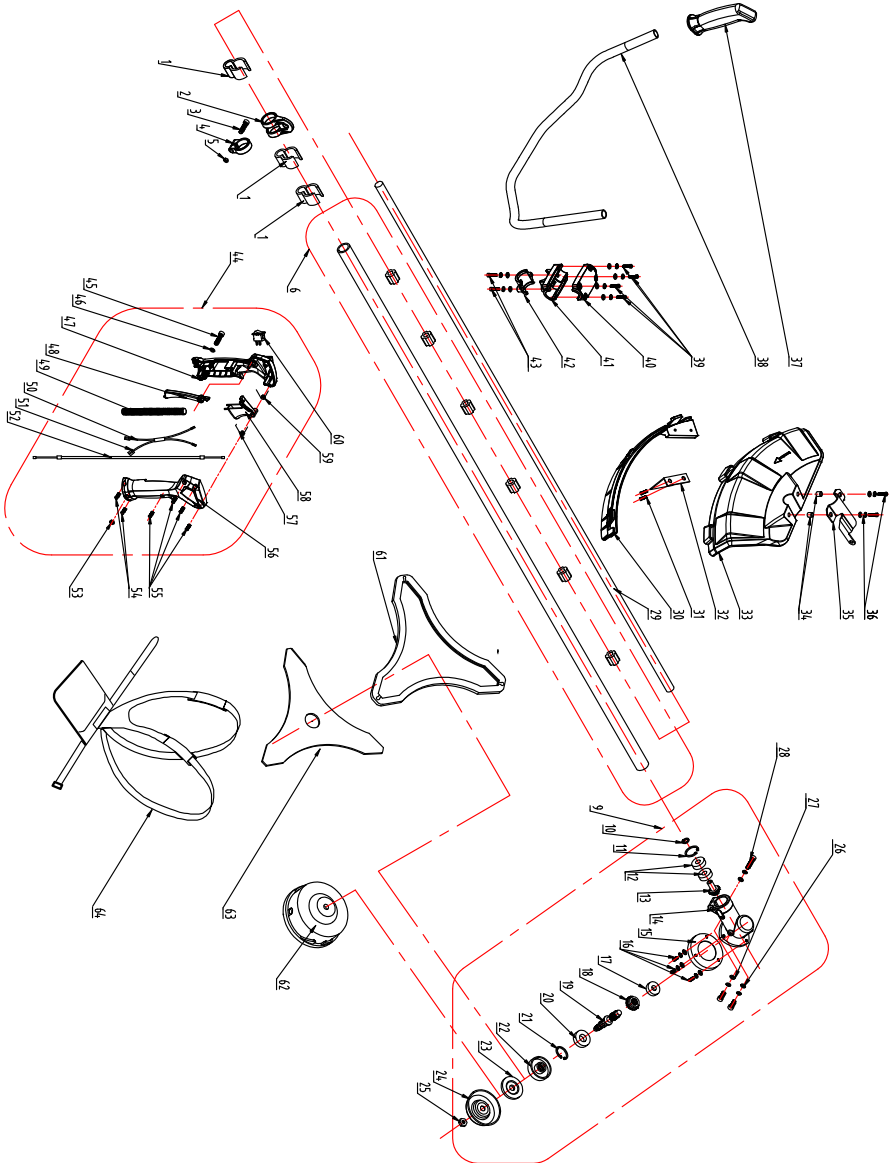

Appliance Parts List: 43U

ID	PART NUMBER	DESCRIPTION	QTY
1	MITBC431D.02.00-3	CLAMP	3
2	MITBC430D.03.02-00A	HARNESS CLAMP	1
3	MIGB/T2671.2 M5X20	SCREW M5X20	1
4	MITBC430D.03.00-2A	RETAINER CLIP	1
5	MIGB/T6170 M5	NUT M5	1
6	MITBC431D.03.01-00A	OUTER SHAFT ASSEMBLY	1
9	MITBC431D.04.00-00A	GEAR BOX ASSEMBLY	1
10	MIGB/T894.1 10	CIRCLIP (SIZE 10)	1
11	MIGB/T893.1 26	E CLIP (SIZE 26)	1
12	MIGB/T276 6000-2Z	BALL BEARING 6000-2Z	2
13	MIC43.0116.0002	PINION	1
14	MITBC431D.04.00-1A	GEAR BOX	1
15	MIC43.0116.0007	TOP GUARD	1
16	MIGB/T70.1 M5X8	SCREW M5X8	3
17	MIGB/T276 6000-2Z	BALL BEARING 6000-2Z	1
18	MIC43.0116.0004	GEAR	1
19	MITBC431D.04.00-3	GEAR SHAFT	1
20	MIGB/T276 6002-2Z	BALL BEARING 6002-2Z	1
21	MIGB/T893.1 26	E CLIP (SIZE 26)	1
22	MITBC431D.04.00-6	BLADE CLAMP - LOWER	1
23	MITBC431D.04.00-5	BLADE CLAMP - UPPER	1
24	MITBC431D.04.00-8	NUT PROTECTOR	1
25	MIGB/T6177.2 M10X1.25	FLANGE NUT M10X1.25	1
26	MIGB/T70.1 M6X12	SCREW M6X12	1
27	MIGB/T2671.2 M6X12	SCREW M6X12	1
28	MIGB/T2671.2 M6X25	SCREW M6X25	1
29	MITBC430D.03.00-1	DRIVER SHAFT	1
30	MITBC431D.06.01-1	SKIRT	1
31	MIGB/T845 ST4.8X13	TAPPING SCREW ST4.8X13	2
32	MITBC431D.06.00-2	LINE CUTTER	1
33	MITBC431D.06.02-00	DEBRIS GUARD	1

ID	PART NUMBER	DESCRIPTION	QTY
34	MIC43.1113.0102	SPACER	2
35	MITBC431D.06.00-1A	GUARD CLAMP	1
36	MIGB/T2671.2 M6X20	SCREW M6X20	2
37	MITBC431D.05.00-2A	RUBBER HANDLE	1
38	MITBC431D.05.00-1A	AL TUBING	1
39	MIGB/T2671.2 M5X25	SCREW M5X25	4
40	MITBC431D.05.03-3A	UPPER CLAMP	1
41	MITBC431D.05.03-1A	MIDDLE CLAMP	1
42	MITBC431D.05.03-2A	LOWER CLAMP	1
43	MIGB/T2671.2 M5X25	SCREW M5X25	2
44	MITBC431D.05.01-00A	CONTROL HANDLE ASSEMBLY	1
45	MIGB/T2671.2 M5X30	SCREW M5X30	1
46	MIGB/T97.1 M5	WASHER M5	1
47	MITBC431D.05.01-2A	THROTTLE HOUSING LH	1
48	MITBC431D.05.01-5	LOCK TRIGGER	1
49	MITBC431D.05.01-7	CONDUIT	1
50	MITBC431D.05.07-00	WIRE CABLE A	1
51	MITBC431D.05.08-00	WIRE CABLE B	1
52	MITBC431D.05.05-00	THROTTLE CABLE ASSEMBLY	1
53	MIGB/T6170 M5	NUT M5	1
54	MIGB/T845 ST3.5X9.5	ST SCREW 3.5X9.5	2
55	MIGB/T845 ST4.2X10	ST SCREW 4.2X10	4
56	MITBC431D.05.01-1A	THROTTLE HOUSING RH	1
57	MITBC431D.05.01-4	SPRING - TRIGGER	1
58	MITBC431D.05.01-3	TRIGGER	1
59	MITBC431D.05.01-6	SPRING - TRIGGER	1
60	MIYD38-3.01.11.04-00	ON/OFF SWITCH	1
61	MITBC431D.02.00-2	BLADE COVER	1
62	MITBC430D.02.01-00	NYLON HEAD ASSY	1
63	MIC43.1100.0001	BLADE	1
64	MI00.07.06.0008	HARNESS	1

Engine Parts Drawing: 53U

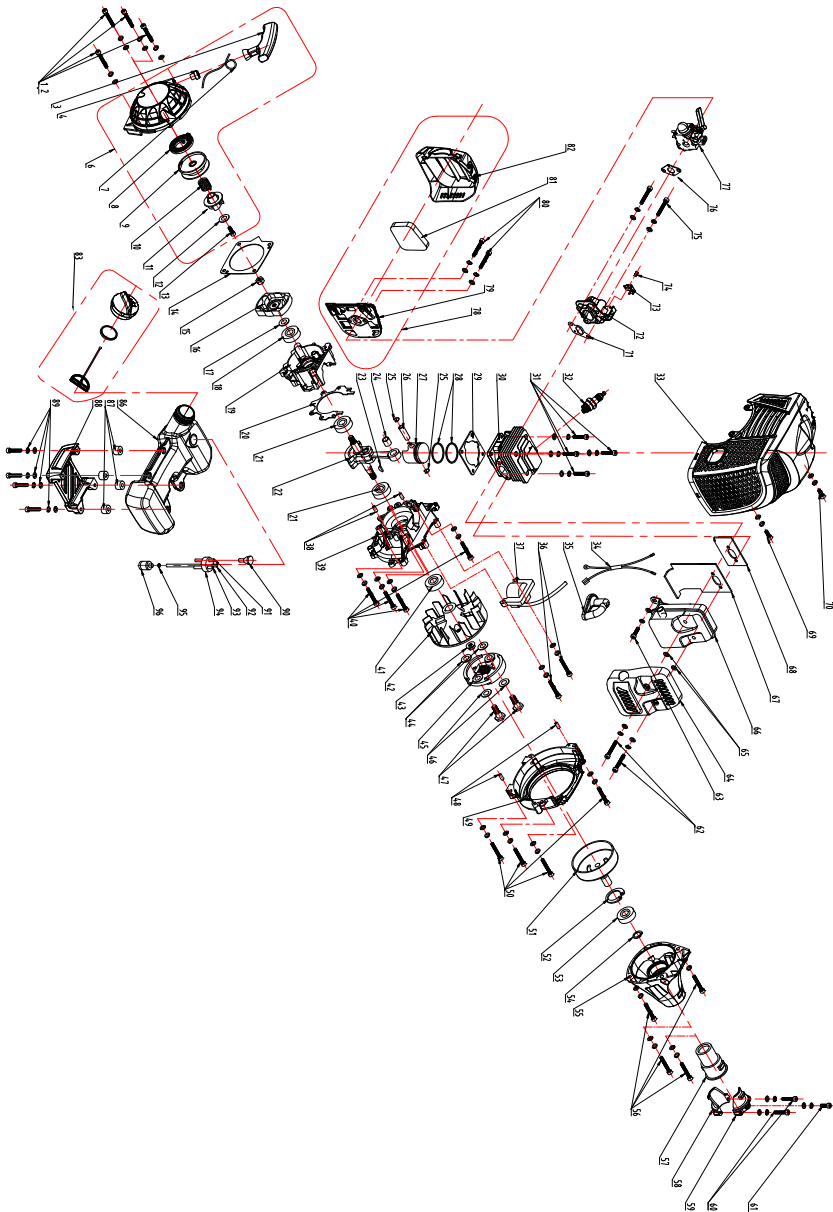

Engine Parts List: 53U

ID	PART NUMBER	DESCRIPTION	QTY
1	MIGB/T2671.2 M5X20	SCREW M5X20	2
2	MIGB/T2671.2 M5X25	SCREW M5X25	2
3	MIA62.0110.0002	STARTER HANDLE	1
4	MIYD25.02.01-2	ROPE GUIDE	1
6	MITBC431D.01.12.00-00	STARTER ASSEMBLY	1
7	MITBC430D.01.12.00-2	STARTER ROPE	1
8	MITBC430D.01.12.00-4	RECOIL SPRING	1
9	MITBC431D.01.12.00-3	STARTER PULLEY	1
10	MITBC430D.01.12.00-5	SPRING - STARTER	1
11	MITBC431D.01.12.00-6	RATCHET WHEEL	1
12	MIGB/T9074.19 5X16X19	ST SCREW 4.8X19	1
13	MIGB/T9074.19 5X16X1	PLATE WASHER 5X16X1	1
14	MITBC430D.01.00.00-6	STARTER GASKET	1
15	MIGB/T6175 M8	NUT M8	1
16	MITBC430D.01.00.02-00	STARTER RATCHET ASSY	1
17	MIGB/T97.1 M8	FLAT WASHER M8	1
18	MIYD38-3.01.01.02-00	OIL SEAL 12X22X7	1
19	MITBC430D.01.01.00-2	CRANKCASE RH	1
20	MITBC430D.01.01.00-3	GASKET - CRANKCASE	1
21	MIGB/T276 6202	BALL BEARING 6202-2Z	2
22	MITBC430D.01.03.01-00	CRANKSHAFT	1
23	MIGB/T1099 3X5X13	KEY 3X5X13	1
24	MITBC430D.01.03.03-00	BEARING ?10X1 3X16	1
25	MIYD38-3.01.03.00-4	PISTON PIN CIRCLIP	2
26	MITBC430D.01.03.00-2	PISTON PIN	1
27	MITBC430D.01.03.02-00	PISTON	1
28	MITBC430D.01.03.00-1	PISTON RING	2
29	MITBC430D.01.00.00-2	GASKET - CYLINDER	1
30	MITBC431D.01.00.00-1	CYLINDER	1
31	MIGB/T2671.2 M5X20	SCREW M5X20	4
32	SPBPMR7A	SPARK PLUG (BPMR7A NGK)	1
33	MITBC431D.01.00.00-11	ENGINE COVER	1
34	MITBC430D.01.11.02-00	WIRE	1
35	MITBC431D.01.11.00-1	PLUG CAP	1
36	MIGB/T2671.2 M5X25	SCREW M5X25	2
37	MITBC430D.01.11.01-00	IGNITION	1
38	MIGB/T119.2 5X10	PIN 5X10	2
39	MITBC430D.01.01.00-1	CRANKCASE LH	1
40	MIGB/T2671.2 M5X30	SCREW M5X30	4
41	MITBC430D.01.00.03-00	OIL-SEAL 15X30X7	1
42	MITBC430D.01.10.00-00	FLYWHEEL	1
43	MIGB/T6187 M8	FLANGE NUT M8	1
44	MITBC430D.01.00.00-9	FLAT WASHER 8X16X1.5	2
45	MITBC430D.01.00.04-00	CLUTCH ASSEMBLY	1
46	MIGB/T755 M10	SPRING WASHER 10	2
47	MITBC430D.01.00.00-8	BOLT - CLUTCH	2
48	MIGB/T119.2 5X10	PIN 5X10	2
49	MITBC431D.01.01.00-4	FAN COVER	1
50	MIGB/T2671.2 M5X25	SCREW M5X25	4
51	MITBC430D.01.14.01-00	CLUTCH DRUM	1
52	MIGB/T893.1 35	CIRCLIP (SIZE 35)	1
53	MIGB/T276 6202-2Z	BEARING 6202	1
54	MIGB/T894.1 15	STOP RING (SIZE 15)	1
55	MITBC431D.01.14.00-1B	CLUTCH HOUSING	1
56	MIGB/T2671.2 M6X20	SCREW M6X20	4
57	MITBC521D.01.14.00-2	ANTIVIBE RUBBER	1
58	MITBC521D.01.14.00-4	CLAMP RH	1
59	MITBC521D.01.14.00-3	CLAMP LH	1
60	MIGB/T2671.2 M5X25	SCREW M5X25	2
61	MIGB/T2671.2 M5X12	SCREW M5X12	1
62	MIGB/T2671.2 M6X55	SCREW M6X55	2
63	MIGB/T2671.2 M5X12	SCREW M5X12	1
64	MITBC431D.01.00.00-7	MUFFLER COVER	1
65	MIGB/T97.1 M6	FLAT WASHER M6	2
66	MITBC430D.01.09.00-00	MUFFLER	1
67	MITBC431D.01.00.00-13	GASKET - MUFFLER	1
68	MITBC430D.01.00.00-5	GASKET - MUFFLER	1
69	MIGB/T2671.2 M5X12	SCREW M5X12	1
70	MIGB/T2671.2 M4X12	SCREW M4X12	1
71	MITBC430D.01.00.00-3	GASKET	1
72	MITBC431D.01.00.01-00	MANIFOLD	1
73	MIGB/T845 5T3.5X9.5	ST SCREW 3.5X9.5	1
74	MITBC431D.01.00.00-12	STRAP	1
75	MIGB/T2671.2 M5X25	SCREW M5X25	2
76	MIYD38-3.01.00-8	CARBURETOR GASKET	1
77	MITBC431D.01.06.00-00	CARBURETOR	1
78	MITBC431D.01.08.00-00	AIR FILTER ASSEMBLY	1
79	MITBC431D.01.08.00-1	AIR BOX BASE	1
80	MIGB/T2671.2 M5X45	SCREW M5X45	2
81	MITBC431D.01.08.00-3	AIR FILTER	1
82	MITBC431D.01.08.00-2	AIR BOX COVER	1
83	MITBC431D.01.13.01	FUEL CAP ASSY	1
86	MITBC431D.01.13.00-1	FUEL TANK	1
87	MITBC431D.01.13.00-2	FUEL TANK RUBBER	4
88	MITBC431D.01.00.00-10	FUEL TANK BRACKET	1
89	MIGB/T2671.2 M5X25	SCREW M5X25	4
90	MIYD45.03.04-00	BREATHER ASSY	1
91	MITBC431D.01.13.00-6	BREATHER PIPE	1
92	MITBC431D.01.13.00-4	FUEL PIPE	1
93	MITBC431D.01.13.00-5	FUEL PIPE	1
94	MITBC431D.01.13.00-3	GROMMET	1
95	MIYD45.01.01-1-3	CIRCLIP	1
96	MIYD38-3.03.04-00	FUEL FILTER	1

Appliance Parts Drawing: 53U

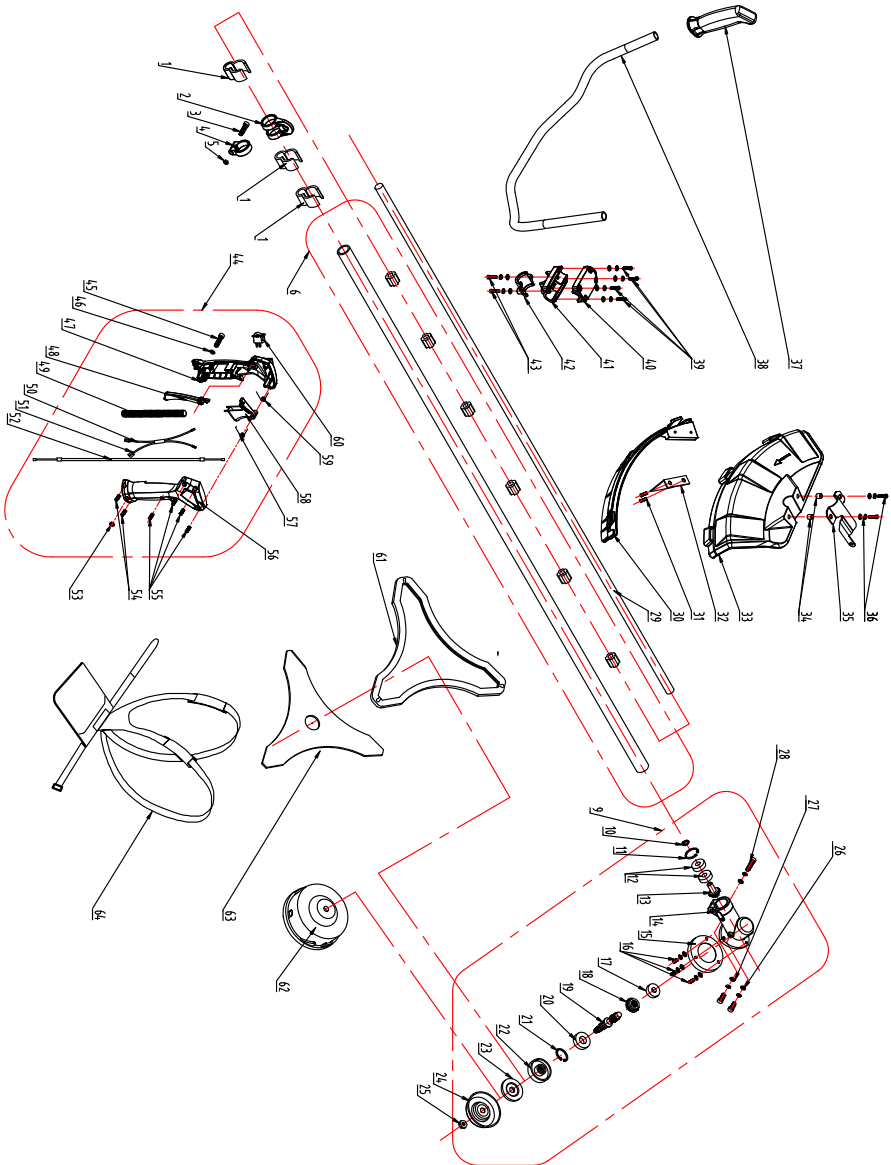

Appliance Parts List: 53U

ID	PART NUMBER	DESCRIPTION	QTY	ID	PART NUMBER	DESCRIPTION	QTY
1	MITBC431D.02.00-3	CLAMP	3	34	MIC43.1113.0102	SPACER	2
2	MITBC430D.03.02-00A	HARNESS CLAMP	1	35	MITBC431D.06.00-1A	GUARD CLAMP	1
3	MIGB/T2671.2 M5X20	SCREW M5X20	1	36	MIGB/T2671.2 M6X20	SCREW M6X20	2
4	MITBC430D.03.00-2A	RETAINER CLIP	1	37	MITBC431D.05.00-2A	RUBBER HANDLE	1
5	MIGB/T6170 M5	NUT M5	1	38	MITBC431D.05.00-1A	AL TUBING	1
6	MITBC431D.03.01-00A	OUTER SHAFT ASSEMBLY	1	39	MIGB/T2671.2 M5X25	SCREW M5X25	4
9	MITBC431D.04.00-00A	GEAR BOX ASSEMBLY	1	40	MITBC431D.05.03-3A	UPPER CLAMP	1
10	MIGB/T894.1 10	CIRCLIP (SIZE 10)	1	41	MITBC431D.05.03-1A	MIDDLE CLAMP	1
11	MIGB/T893.1 26	E CLIP (SIZE 26)	1	42	MITBC431D.05.03-2A	LOWER CLAMP	1
12	MIGB/T276 6000-2Z	BALL BEARING 6000-2Z	2	43	MIGB/T2671.2 M5X25	SCREW M5X25	2
13	MIC43.0116.0002	PINION	1	44	MITBC431D.05.01-00A	CONTROL HANDLE ASSEMBLY	1
14	MITBC431D.04.00-1A	GEAR BOX	1	45	MIGB/T2671.2 M5X30	SCREW M5X30	1
15	MIC43.0116.0007	TOP GUARD	1	46	MIGB/T97.1 M5	WASHER M5	1
16	MIGB/T70.1 M5X8	SCREW M5X8	3	47	MITBC431D.05.01-2A	THROTTLE HOUSING LH	1
17	MIGB/T276 6000-2Z	BALL BEARING 6000-2Z	1	48	MITBC431D.05.01-5	LOCK TRIGGER	1
18	MIC43.0116.0004	GEAR	1	49	MITBC431D.05.01-7	CONDUIT	1
19	MITBC431D.04.00-3	GEAR SHAFT	1	50	MITBC431D.05.07-00	WIRE CABLE A	1
20	MIGB/T276 6002-2Z	BALL BEARING 6002-2Z	1	51	MITBC431D.05.08-00	WIRE CABLE B	1
21	MIGB/T893.1 26	E CLIP (SIZE 26)	1	52	MITBC431D.05.05-00	THROTTLE CABLE ASSEMBLY	1
22	MITBC431D.04.00-6	BLADE CLAMP - LOWER	1	53	MIGB/T6170 M5	NUT M5	1
23	MITBC431D.04.00-5	BLADE CLAMP - UPPER	1	54	MIGB/T845 ST3.5X9.5	ST SCREW 3.5X9.5	2
24	MITBC431D.04.00-8	NUT PROTECTOR	1	55	MIGB/T845 ST4.2X10	ST SCREW 4.2X10	4
25	MIGB/T6177.2 M10X1.25	FLANGE NUT M10X1.25	1	56	MITBC431D.05.01-1A	THROTTLE HOUSING RH	1
26	MIGB/T70.1 M6X12	SCREW M6X12	1	57	MITBC431D.05.01-4	SPRING - TRIGGER	1
27	MIGB/T2671.2 M6X12	SCREW M6X12	1	58	MITBC431D.05.01-3	TRIGGER	1
28	MIGB/T2671.2 M6X25	SCREW M6X25	1	59	MITBC431D.05.01-6	SPRING - TRIGGER	1
29	MITBC430D.03.00-1	DRIVER SHAFT	1	60	MIYD38-3.011.1.04-00	ON/OFF SWITCH	1
30	MITBC431D.06.01-1	SKIRT	1	61	MITBC431D.02.00-2	BLADE COVER	1
31	MIGB/T845 ST4.8X13	TAPPING SCREW ST4.8X13	2	62	MITBC430D.02.01-00	NYLON HEAD ASSY	1
32	MITBC431D.06.00-2	LINE CUTTER	1	63	MIC43.1100.0001	BLADE	1
33	MITBC431D.06.02-00	DEBRIS GUARD	1	64	MI00.07.06.0008	HARNESS	1

EC Declaration of Conformity

We Mitox (Rochford Garden Machinery Ltd) - BA9 9RS (importer) declare that the product(s):

Designation: BRUSHCUTTER
Model(s): 26L SELECT
Type/Serial No: As per rating label on machine

Complies with the following directive(s):

Machinery Directive 2006/42/EC
EMC Directive 2014/30/EU
NRMM Directive 97/68/EC (Amended 2012/46/EU)
Noise Directive 2000/14/EC and 2005/88/EC

The conformity assessment procedure followed was in accordance with:

EN ISO 11806-1:2011
EN ISO 14982
EN ISO 22868

Notified Body:

Intertek Testing Services

Address:

Building No. 86, 1198 Qinzhou Road (North) Shanghai 200233, China

Measured Sound Power Level: 111.2 dB (A)
Guaranteed Sound Power Level: 113 dB (A)

Authorised Signatory and Technical File Holder

Date: 16/05/2016

Signature:



Name: Stewart Anderson
Position: Managing Director
Company: Mitox (Rochford Garden Machinery Ltd)
Address: Wincanton Business Park
Wincanton
Somerset
BA9 9RS



EC Declaration of Conformity

We Mitox (Rochford Garden Machinery Ltd) - BA9 9RS (importer) declare that the product(s):

Designation: BRUSHCUTTER
Model(s): 26U SELECT
Type/Serial No: As per rating label on machine

Complies with the following directive(s):

Machinery Directive 2006/42/EC
EMC Directive 2014/30/EU
NRMM Directive 97/68/EC (Amended 2012/46/EU)
Noise Directive 2000/14/EC and 2005/88/EC

The conformity assessment procedure followed was in accordance with:

EN ISO 11806-1:2011
EN ISO 14982
EN ISO 22868

Notified Body:

Intertek Testing Services

Address:

Building No. 86, 1198 Qinzhou Road (North) Shanghai 200233, China

Measured Sound Power Level: 111.2 dB (A)
Guaranteed Sound Power Level: 113 dB (A)

Authorised Signatory and Technical File Holder

Date: 16/05/2016

Signature:



Name: Stewart Anderson
Position: Managing Director
Company: Mitox (Rochford Garden Machinery Ltd)
Address: Wincanton Business Park
Wincanton
Somerset
BA9 9RS



EC Declaration of Conformity

We Mitox (Rochford Garden Machinery Ltd) - BA9 9RS (importer) declare that the product(s):

Designation: BRUSHCUTTER
Model(s): 33L SELECT
Type/Serial No: As per rating label on machine

Complies with the following directive(s):

Machinery Directive 2006/42/EC
EMC Directive 2014/30/EU
NRMM Directive 97/68/EC (Amended 2012/46/EU)
Noise Directive 2000/14/EC and 2005/88/EC

The conformity assessment procedure followed was in accordance with:

EN ISO 11806-1:2011
EN ISO 14982
EN ISO 22868

Notified Body:

Intertek Testing Services

Address:

Building No. 86, 1198 Qinzhou Road (North) Shanghai 200233, China

Measured Sound Power Level: 111.2 dB (A)
Guaranteed Sound Power Level: 113 dB (A)

Authorised Signatory and Technical File Holder

Date: 16/05/2016

Signature:



Name: Stewart Anderson
Position: Managing Director
Company: Mitox (Rochford Garden Machinery Ltd)
Address: Wincanton Business Park
Wincanton
Somerset
BA9 9RS



EC Declaration of Conformity

We Mitox (Rochford Garden Machinery Ltd) - BA9 9RS (importer) declare that the product(s):

Designation: BRUSHCUTTER
Model(s): 33U SELECT
Type/Serial No: As per rating label on machine

Complies with the following directive(s):

Machinery Directive 2006/42/EC
EMC Directive 2014/30/EU
NRMM Directive 97/68/EC (Amended 2012/46/EU)
Noise Directive 2000/14/EC and 2005/88/EC

The conformity assessment procedure followed was in accordance with:

EN ISO 11806-1:2011
EN ISO 14982
EN ISO 22868

Notified Body:

Intertek Testing Services

Address:

Building No. 86, 1198 Qinzhou Road (North) Shanghai 200233, China

Measured Sound Power Level: 111.2 dB (A)
Guaranteed Sound Power Level: 113 dB (A)

Authorised Signatory and Technical File Holder

Date: 16/05/2016

Signature:



Name: Stewart Anderson
Position: Managing Director
Company: Mitox (Rochford Garden Machinery Ltd)
Address: Wincanton Business Park
Wincanton
Somerset
BA9 9RS



EC Declaration of Conformity

We Mitox (Rochford Garden Machinery Ltd) - BA9 9RS (importer) declare that the product(s):

Designation: BRUSHCUTTER
Model(s): 43U SELECT
Type/Serial No: As per rating label on machine

Complies with the following directive(s):

Machinery Directive 2006/42/EC
EMC Directive 2014/30/EU
NRMM Directive 97/68/EC (Amended 2012/46/EU)
Noise Directive 2000/14/EC and 2005/88/EC

The conformity assessment procedure followed was in accordance with:

EN ISO 11806-1:2011
EN ISO 14982
EN ISO 22868

Notified Body:

Intertek Testing Services

Address:

Building No. 86, 1198 Qinzhou Road (North) Shanghai 200233, China

Measured Sound Power Level: 111.2 dB (A)
Guaranteed Sound Power Level: 113 dB (A)

Authorised Signatory and Technical File Holder

Date: 16/05/2016

Signature:



Name: Stewart Anderson
Position: Managing Director
Company: Mitox (Rochford Garden Machinery Ltd)
Address: Wincanton Business Park
Wincanton
Somerset
BA9 9RS



EC Declaration of Conformity

We Mitox (Rochford Garden Machinery Ltd) - BA9 9RS (importer) declare that the product(s):

Designation: BRUSHCUTTER
Model(s): 53U SELECT
Type/Serial No: As per rating label on machine

Complies with the following directive(s):

Machinery Directive 2006/42/EC
EMC Directive 2014/30/EU
NRMM Directive 97/68/EC (Amended 2012/46/EU)
Noise Directive 2000/14/EC and 2005/88/EC

The conformity assessment procedure followed was in accordance with:

EN ISO 11806-1:2011
EN ISO 14982
EN ISO 22868

Notified Body:

Intertek Testing Services

Address:

Building No. 86, 1198 Qinzhou Road (North) Shanghai 200233, China

Measured Sound Power Level: 111.2 dB (A)
Guaranteed Sound Power Level: 113 dB (A)

Authorised Signatory and Technical File Holder

Date: 16/05/2016

Signature:



Name: Stewart Anderson
Position: Managing Director
Company: Mitox (Rochford Garden Machinery Ltd)
Address: Wincanton Business Park
Wincanton
Somerset
BA9 9RS



26L/U, 33L/U, 43U, 53U



Notes

26L/U, 33L/U, 43U, 53U



Notes

CONDITIONS OF WARRANTY

The manufacturer warrants the product against faulty materials and workmanship for a standard 1 year period and thereafter for the set period specific to each range from the date of purchase. Warranty does not extend to failure due to fair wear and tear.

- SP** - 1 Year
 - SELECT** - 3 Years (Subject to yearly servicing)
 - PREMIUM** - 5 Years (Subject to yearly servicing)
 - PRO** - 5 Years Domestic / 3 Years Commercial (Subject to yearly servicing)
- (Extended warranty is subject to online registration and yearly servicing)*

SP, SELECT and PREMIUM ranges used for commercial purposes have a warranty period of 3 months from the date of purchase.

The manufacturer undertakes to replace any spare parts that are classified as defective by an appointed Mitox service dealer. The manufacturer will not accept liability for the replacement of the machine, either partially or wholly, and /or consequential damages and /or interest charges either directly or indirectly.

Warranty does not cover failure due to:

- Insufficient maintenance.
- Incorrect fuel mixture and stale fuel.
- Abnormal use or accidental damage.
- Incorrect assembly, adjustment or operation of the product.
- Spare parts that are subject to wear e.g. bag, blades, bearings, cables, guards, deflectors, spark plugs, air filters etc.

Neither does warranty extend to:

- Freight and packing costs.
- Use of non-genuine spare parts i.e. those from another manufacturer.
- Use of the machine for any other purpose than that for which it was designed.
- Use and maintenance of the machine in a manner not described in the owner’s manual.

As part of our policy of continuous product improvement, we reserve the right to alter or amend this specification without notice. As a result, the product may differ from the information contained herein but any alteration will only be implemented without notice if it is classified as an improvement to the above specification.

READ THE MANUAL CAREFULLY BEFORE OPERATING THE MACHINE

When ordering spare parts, please quote the part number, this can be found in the parts list included in this manual.

Retain your proof of purchase, without which no warranty can be offered.

Mitox Garden Machinery, Wincanton Business Park, Wincanton, Somerset, BA9 9RS