

EasiCut Reach 480

PNC 9705465-01

en Operator's manual
Telescopic Electric Hedge Trimmer

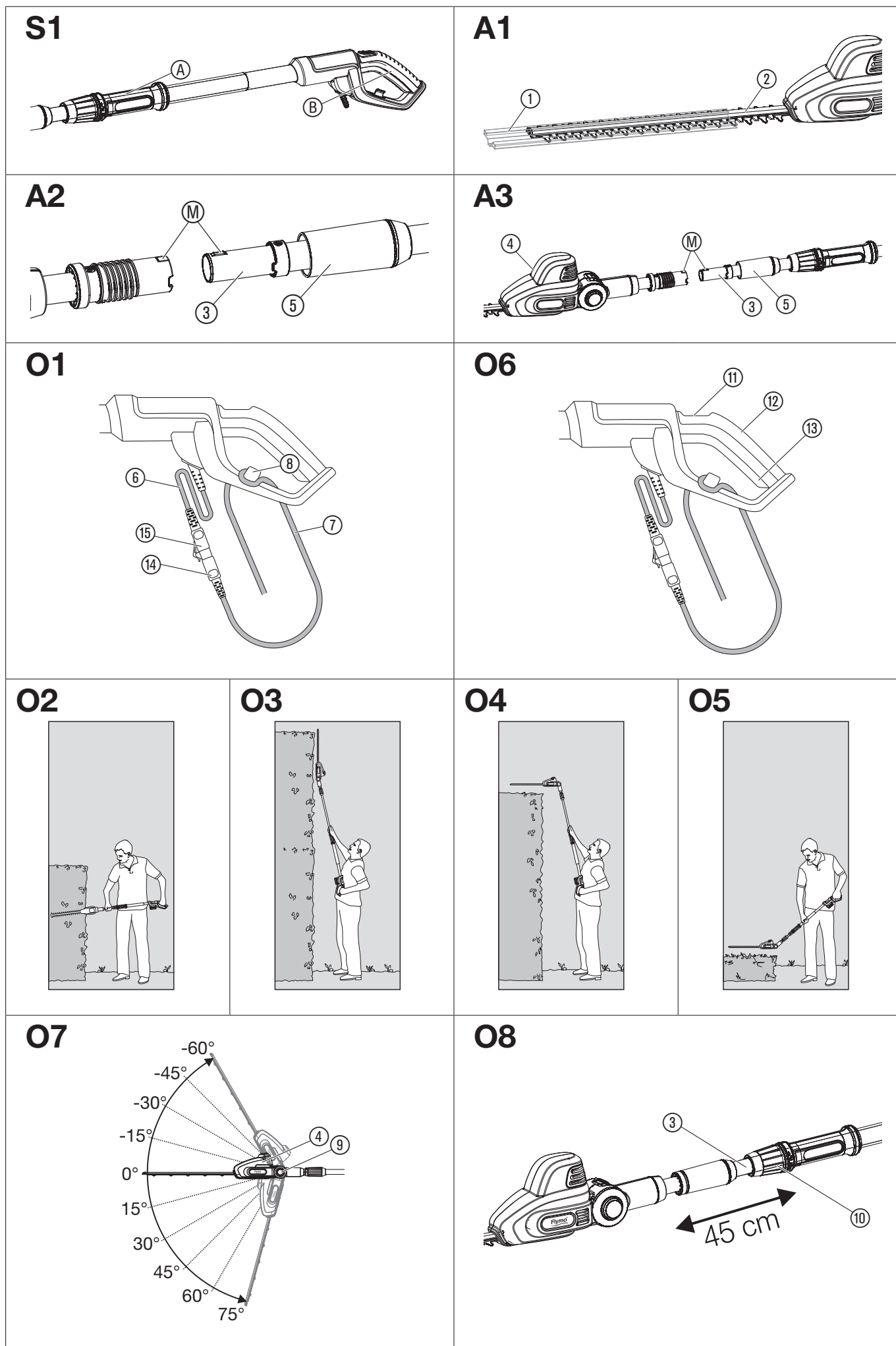

en Telescopic Electric Hedge Trimmer

1. SAFETY WARNINGS	4
2. ASSEMBLY	6
3. OPERATION	6
4. MAINTENANCE	6
5. STORAGE	7
6. TROUBLESHOOTING	7
7. TECHNICAL DATA	7
8. WARRANTY / SERVICE	7

Original instructions.



This product is not intended for use by persons (including children) with reduced physical, sensory or mental capabilities, or lack of experience and knowledge, unless they have been given supervision or instruction concerning use of the product by a person responsible for their safety. Children should be supervised to ensure that they do not play with the product. The use of this product by young people under the age of 16 is not recommended.

Intended use:

This **FLYMO Telescopic Hedge Trimmer** is used to cut hedges, shrubs and grass coverings in private domestic gardens and allotments.

The product is not intended for long term use.



DANGER! Risk of injury!

→ Do not use the product to cut lawns/lawn edges, to chop up material or to make compost.

1. SAFETY WARNINGS

IMPORTANT!

Read the operator's manual carefully before use and keep for future reference.



If not used properly this product can be dangerous. The warnings and safety instructions must be followed to ensure reasonable safety and efficiency in using this product. The operator is responsible for following the warnings and instructions in this manual and on the product. Never use the product unless the guards provided by the manufacturer are in the correct position.

1.1 Explanation of the symbols:



Read operator's manual.



Wear eye and ear protection.



Danger – Keep hands away from blade.



Do not expose to rain.



Disconnect the mains cable if the cable becomes damaged or cut.

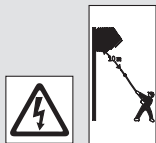

Risk of fatal injury due to electric shock!
Keep at least 10 m away from electricity lines.



Always wear a hard hat.

1.2 General safety warnings

1.2.1 General machine safety warnings



WARNING!

Read all safety warnings, instructions, illustrations and specifications provided with this machine. Failure to follow all instructions listed below may result in electric shock, fire and/or serious injury.

Save all warnings and instructions for future reference.

The term "machine" in the warnings refers to your mains operated (corded) machine or battery operated (cordless) machine.

1) Work area safety

- Keep work area clean and well lit. Cluttered or dark areas invite accidents.
- Do not operate machines in explosive atmospheres, such as in the presence of flammable liquids, gases or dust. Machines create sparks which may ignite the dust or fumes.
- Keep children and bystanders away while operating a machine. Distractions can cause you to lose control.

2) Electrical safety

- Machine plugs must match the outlet. Never modify the plug in any way. Do not use any adapter plugs with earthed (grounded) machines. Unmodified plugs and matching outlets will reduce risk of electric shock.
- Avoid body contact with earthed or grounded surfaces, such as pipes, radiators, ranges and refrigerators. There is an increased risk of electric shock if your body is earthed or grounded.
- Do not expose machines to rain or wet conditions. Water entering a machine will increase the risk of electric shock.
- Do not abuse the cord. Never use the cord for carrying, pulling or unplugging the machine. Keep cord away from heat, oil, sharp edges or moving parts. Damaged or entangled cords increase the risk of electric shock.
- When operating a machine outdoors, use an extension cord suitable for outdoor use. Use of a cord suitable for outdoor use reduces the risk of electric shock.
- If operating a machine in a damp location is unavoidable, use a residual current device (RCD) protected supply. Use of an RCD reduces the risk of electric shock.

3) Personal safety

- Stay alert, watch what you are doing and use common sense when operating a machine. Do not use a machine while you are tired or under the influence of drugs, alcohol or medication. A moment of inattention while operating machines may result in serious personal injury.
- Use personal protective equipment. Always wear eye protection. Protective equipment such as a dust mask, non-skid safety shoes, hard hat, or hearing protection used for appropriate conditions will reduce personal injuries.
- Prevent unintentional starting. Ensure the switch is in the OFF-position before connecting to power source and/or battery pack, picking up or carrying the machine. Carrying machines with your finger on the switch or energising machines that have the switch on invites accidents.
- Remove any adjusting key or wrench before turning the machine on. A wrench or a key left attached to a rotating part of the machines may result in personal injury.
- Do not overreach. Keep proper footing and balance at all times. This enables better control of the machine in unexpected situations.
- Dress properly. Do not wear loose clothing or jewellery. Keep your hair and clothing away from moving parts. Loose clothes, jewellery or long hair can be caught in moving parts.
- If devices are provided for the connection of dust extraction and collection facilities, ensure these are connected and properly used. Use of dust collection can reduce dust-related hazards.
- Do not let familiarity gained from frequent use of machines allow you to become complacent and ignore machine safety principles. A careless action can cause severe injury within a fraction of a second.

4) Machine use and care

- Do not force the machine. Use the correct machine for your application. The correct machine will do the job better and safer at the rate for which it was designed.
- Do not use the machine if the switch does not turn it on and off. Any machine that cannot be controlled with the switch is dangerous and must be repaired.
- Disconnect the plug from the power source and/or the battery pack from the machine before making any adjustments, changing accessories, or storing machines. Such preventive safety measures reduce the risk of starting the machine accidentally.
- Store idle machines out of the reach of children and do not allow persons unfamiliar with the machine or these instructions to operate the machine. Machines are dangerous in the hands of untrained users.
- Maintain machines. Check for misalignment or binding of moving parts, breakage of parts and any other condition that may affect the machine's operation. If damaged, have the machine repaired before use. Many accidents are caused by poorly maintained machines.
- Keep cutting tools sharp and clean. Properly maintained cutting tools with sharp cutting edges are less likely to bind and are easier to control.

g) Use the machine, accessories and tool bits etc. in accordance with these instructions, taking into account the working conditions and the work to be performed.

Use of the machine for operations different from those intended could result in a hazardous situation.

h) Keep handles and grasping surfaces dry, clean and free from oil and grease. Slippery handles and grasping surfaces do not allow for safe handling and control of the machine in unexpected situations.

5) Service

Have your machine serviced by a qualified repair person using only identical replacement parts.

This will ensure that the safety of the machine is maintained.

1.2.2 Hedge trimmer safety warnings

a) Keep all parts of the body away from the blade. Do not remove cut material or hold material to be cut when blades are moving. Blades continue to move after the switch is turned off.

A moment of inattention while operating the hedge trimmer may result in serious personal injury.

b) Carry the hedge trimmer by the handle with the blade stopped and taking care not to operate any power switch.

Proper carrying of the hedge trimmer will decrease the risk of inadvertent starting and resultant personal injury from the blades.

c) When transporting or storing the hedge trimmer, always fit the blade cover.

Proper handling of the hedge trimmer will decrease the risk of personal injury from the blades.

d) When clearing jammed material or servicing the machine, make sure all power switches are off and the power cord is disconnected.

Unexpected actuation of the hedge trimmer while clearing jammed material or servicing may result in serious personal injury.

e) Hold the hedge trimmer by insulated gripping surfaces only, because the blade may contact hidden wiring or its own cord.

Blades contacting a "live" wire may make exposed metal parts of the hedge trimmer "live" and could give the operator an electric shock.

f) Keep all power cords and cables away from cutting area.

Power cords or cables may be hidden in hedges or bushes and can be accidentally cut by the blade.

g) Do not use the hedge trimmer in bad weather conditions, especially when there is a risk of lightning.

This decreases the risk of being struck by lightning.

1.2.3 Extended-reach hedge trimmer safety warnings

a) To reduce the risk of electrocution, never use the extended-reach hedge trimmer near any electrical power lines.

Contact with or use near power lines may cause serious injury or electric shock resulting in death.

b) Always use two hands when operating the extended-reach hedge trimmer.

Hold the extended-reach hedge trimmer with both hands to avoid loss of control.

c) Always use head protection when operating the extended-reach hedge trimmer overhead.

Falling debris can result in serious personal injury.

Search hedges and bushes for hidden objects (e.g. wire fences and hidden wires).

The use of a residual current device (RCD) with a trip current of 30 mA or less is recommended.

Hold the hedge trimmer with both hands on both handles.

The hedge trimmer is intended for use when the user is standing on the ground and not on a ladder or other unstable surface.

Before using the hedge trimmer, make sure that the locking devices of all moving parts (e.g. the extended shaft and the pivot element) are in the locked position.

1.3 Additional safety warnings



DANGER! Risk of suffocation!

Small parts can be easily swallowed. There is also a risk that the polybag can suffocate toddlers.

→ Keep toddlers away when you assemble the product.

1.3.1 Work area safety

Only use the product in the manner and for the functions described in these instructions.

The operator or user is responsible for accidents or hazards occurring to other people or their property.

During operation and transport pay special attention to the hazard for other people.

Risk of stumbling. While operation pay attention to the cable.



WARNING!

When wearing hearing protection, and due to the noise produced by the product, the operator may not notice persons approaching.

→ Do not use the product when a thunderstorm is approaching.

→ Do not use the product nearby a water.

1.3.2 Electrical safety



DANGER! Cardiac arrest!

This product makes an electromagnetic field while it operates. This field may under some conditions interfere with active or passive medical implants. To decrease the risk of conditions that can possibly injure or kill, we recommend persons with medical implants to speak with their physician and the medical implant manufacturer before you operate the product.

The product must be supplied through a residual current device (RCD) having a rated residual operating current not exceeding 30 mA. Check your R. C. D. every time you use it.

Before use, examine cable for damage, replace it if there are signs of damage or ageing.

If the replacement of the supply cord is necessary, this has to be done by the manufacturer or his agent in order to avoid a safety hazard.

Do not use the product if the electric cables are damaged or worn.

Immediately disconnect from the mains electricity supply if the cable is cut, or the insulation is damaged. Do not touch the electric cable until the electrical supply has been disconnected.

Your electric cable must be untangled, tangled cables can overheat and reduce the efficiency of your product.

Always disconnect the mains cable before disconnecting any plug, cable connector or extension cable.

Switch off, remove plug from mains and examine electric supply cable for damage or ageing before winding cable for storage. Do not repair a damaged cable, send the product to the next FLYMO Customer Service Center or dealer authorised by FLYMO.

Always wind cable carefully, avoiding kinking.

Use only on AC mains supply voltage shown on the product rating label.

Do not connect an earth to any part of the product.

If the product starts unintentionally when the mains plug is connected, disconnect the mains at once. Contact FLYMO Customer Service to check the product.

1.3.3 Cables

Use only permitted extension cables as per HD 516.

→ Ask your electrical specialist.

1.3.4 Connectors

IMPORTANT!

→ Connectors are suitable for use with 2 core cables only.

Under no circumstances should these connectors be used for earthed products.

→ All connectors and cables are of splashproof construction.

They are not waterproof and must not be left outside permanently nor should they be submerged or immersed in water. Do not let cable lay or trail through pools of water or splashed with water from hose pipes.

1.3.5 Personal safety

Always wear suitable clothing, protective gloves, and stout shoes.

Avoid contact to the oil of the blade in particular when you react allergic with it.

Thoroughly inspect the area where the product is to be used and remove all wires and other foreign objects.

All adjustments (inclining the blade head, altering the length of the telescopic tube) have to be made with the sheath in place, and the product must not rest on the blade in the process.

Always hold the product properly with both hands on both handles **A** and **B** [Fig. S1].

Before using the product and after any impact, check for signs of wear or damage and repair as necessary.

Never attempt to use an incomplete product or one with an unauthorised modification.

1.3.6 Power tool use and care

Know how to stop the product quickly in an emergency.

Never hold the product by the guard.

Do not use the product if the protection equipments (protection cover, quick blade-stop) are damaged.

Do not use ladders whilst operating the product.

Disconnect the mains cable:

- before leaving the product unattended for any period.
- before clearing a blockage.
- before checking, cleaning or working on the product.
- if you hit an object. Do not use your product until you are sure that the entire product is in a safe operating condition.
- if the product starts to vibrate abnormally. Check immediately. Excessive vibration can cause injury.
- before passing to another person.

Only use the product between 0 and 40 °C.

1.3.7 Maintenance and storage



RISK OF INJURY!

Do not touch blades.

→ When finishing or interrupting work push up protection cover.

Keep all nuts, bolts and screws secure to be sure the product is in safe working condition.

If the product got hot during operation, let it cool down before storage.

2. ASSEMBLY

The hedger, blade, protective cover and the operation instructions are included in the scope of delivery.



DANGER! Risk of injury!

Cut injury when the product starts accidentally.

→ Before you assemble the product, make sure that the mains cable is disconnected and the protective cover ① is slid over the blade ② [Fig. A1]

To assemble the telescopic handle [Fig. A2/A3]:

1. Slide the telescopic pipe ③ into the motor unit ④ until you reach the stop position. Ensure that the two markings ⑩ face each other.
2. Tighten the grey nut ⑤.

3. OPERATION



DANGER! Risk of suffocation!

Small parts can be easily swallowed. There is also a risk that the polybag can suffocate toddlers. Keep toddlers away when you assemble the product.

Always wear suitable clothing, protective gloves, and stout shoes.

Avoid contact to the oil of the blade in particular when you react allergic with it.

Thoroughly inspect the area where the product is to be used and remove all wires and other foreign objects.

Always hold the product properly with both hands and both handles.

Before using the product and after any impact, check for signs of wear or damage and repair as necessary.

Never attempt to use an incomplete product or one with an unauthorised modification.



DANGER! Risk of injury!

Cut injury when the product starts accidentally.

→ Before you connect, adjust or transport the product, disconnect the mains cable and slide the protective cover ① is slid over the blade ② [Fig. A1].

→ The FLYMO Hedge Trimmer is delivered with an 10 m extension cable.

3.1 To connect the hedge trimmer to the extension cable [Fig. O1]:



DANGER! Electric shock!

To avoid damage to the mains cable ⑥ the extension cable ⑦ must be inserted into the cable lock ⑧.

→ Before you operate the product insert the extension cable ⑦ into the cable lock ⑧.

→ Never take hold of the protective cover ① when connecting the product.

1. Loop the extension cable ⑦, insert the loop into the cable lock ⑧ and pull tight.
2. Connect the plug ⑭ of the product into the socket ⑮ of the extension cable ⑦.
3. Connect the extension cable ⑦ into a 230 V mains socket.

Work positions:

The product can be operated in 4 positions (illustration similar).

- [Fig. O2]: Side trimming: Telescopic pipe retracted.
- [Fig. O3]: Vertical trimming at high level: Telescopic tube extended.
- [Fig. O4]: Horizontal trimming at high level: Motor unit tilted by 75°, telescopic pipe extended.
- [Fig. O5]: Trimming at low level: Motor unit tilted by –60°, telescopic pipe extended.

3.2 To start the hedge trimmer [Fig. O1/O6]:



DANGER! Risk of injury!

Risk of injury if the product does not stop when you release the start button.

→ Do not bypass the safety devices or switches. For example do not attach the starting lock-out ⑪ or start button ⑬ to the handle.

To start:

The product is fitted with a starting lock-out ⑪ to prevent the product from being turned on by accident.

1. Remove the protective cover ① from the blade ②.
2. Hold the telescopic pipe of the product with one hand and the handle ⑭ with the other hand.
3. Push the starting lock-out ⑪ forwards and push the start button ⑬. The product will start.
4. Release the starting lock-out ⑪.

To stop:

1. Release the start button ⑬.
2. Slide the protective cover ① over the blade ②.

3.3 To tilt the motor unit [Fig. O7]:

For cutting at high and low level, the motor unit ④ can be tilted at an angle of 75° to –60° in 15° increments.

1. Keep the light grey button ⑨ pressed.
2. Tilt the motor unit ④ in the required direction.
3. Release the light grey button ⑨ and allow the motor unit ④ to engage.

3.4 To extend the telescopic pipe [Fig. O8]:

For cutting at high and low heights, the telescopic pipe ③ can be continuously extended by up to 45 cm.

1. Loosen the light grey nut ⑩.
2. Extend the telescopic pipe ③ to the required length.
3. Tighten the light grey nut ⑩ again.

4. MAINTENANCE

[Fig. A1]:



DANGER! Risk of injury!

Cut injury when the product starts accidentally.

→ Before you maintain the product, make sure that the mains cable is disconnected and the protective cover ① is slid over the blade ②.

To clean the hedge trimmer:



DANGER! Risk of injury!

Risk of injury and risk of damage to the product.

- Do not clean the product with water or with a water jet (in particular high-pressure water jet).
- Do not clean with chemicals including petrol or solvents. Some can destroy critical plastic parts.
- The airflow slots must always be clean.

- Clean the product with a damp cloth.
- Clean the airflow slots with a soft brush (do not use a screwdriver).
- Lubricate the blade ② with a low viscosity oil. Avoid contact with the plastic parts.

5. STORAGE



RISK OF INJURY!

Don't touch the blades.

- When finishing or interrupting work push up the protection cover.
- Keep all nuts, bolts and screws secure to be sure the product is in safe working condition.
- If the product got hot during operation, let it cool down before storage.

5.1 At the end of the cutting season:

- Clean your hedge trimmer thoroughly.
- Check that all nuts and bolts are secure.
- Visually inspect the hedge trimmer for any worn or damaged parts, contact your local Service Centre if any parts require replacement.

5.2 To put into storage:

The product must be stored away from children.

- Disconnect the mains cable.
- Clean the product (see 4. MAINTENANCE) and slide the protective cover ① over the blade ②.
- Store the product in a dry area where it has protection from frost.

5.3 Disposal:

(in accordance with Directive 2012/19/EU/S.I. 2013 No. 3113)



The product must not be disposed of to normal household waste. It must be disposed of in line with local environmental regulations.

IMPORTANT!

- Dispose of the product through or via your municipal recycling collection centre.

6. TROUBLESHOOTING



DANGER! Risk of injury!

Cut injury when the product starts accidentally.

- Before you troubleshoot the product, make sure that the mains cable is disconnected and the protective cover ① is slid over the blade ② [Fig. A1].

6.1 Troubleshooting table:

Problem	Possible Cause	Remedy
Product does not start	Extension cable is not connected or damaged.	→ Connect the extension cable or if necessary replace it.
	Blade blocked.	→ Remove obstacle.
Product can no longer be stopped	Start button is stuck.	→ Disconnect the mains cable and loosen start button.
Hedge is not cleanly cut	Blade blunt or damaged.	→ Have blade replaced by FLYMO Customer Service.

NOTE:

Repairs must only be done by the FLYMO customer service departments or specialist dealers approved by FLYMO.

- For any other malfunctions please contact the FLYMO customer service department.

7. TECHNICAL DATA

Telescopic Electric Hedge Trimmer	Unit	Value (PNC 9705465-01)
Motor power consumption	W	500
Mains voltage/ Mains frequency	V / Hz	230 / 50
Strokes	1/min	1.600
Blade length	cm	48
Tooth gap of blade	mm	25
Range of extension of telescopic tube	cm	0 – 45
Weight (approx.)	kg	4.1
Sound pressure level L_{pA} ¹⁾ Uncertainty k_{pA}	dB	84 3.0
Sound power level L_{WA} ²⁾ ; measured / guaranteed Uncertainty k_{WA}	dB	96 / 98 1.5
Hand/arm vibration a_{vhw} ¹⁾ Uncertainty k_{vhw}	m/s ²	2.7 ±1.5

Measuring process complying with: ¹⁾ 62841-4-2 ²⁾ RL 2000/14/EC / S.I. 2001 No.1701



NOTE: The stated vibration emission value has been measured according to a standardised test procedure and can be used for comparison of one electric power tool with another. It can also be used for preliminary evaluation of exposure. The vibration emission value can vary during actual use of the electric power tool depending on the ways in which the machine is used. As a safety measure, you should work with the machine for a maximum of 1 hour without interruption.

Extension Cable	Unit	Value (PNC 5361906-01)
Cable length	m	10

8. WARRANTY/SERVICE

8.1 Warranty:

In order to extend the standard 1-year warranty, please register your product at www.flymo.com/uk/c/support/warranty.



8.2 Service:

Please find the current contact information of our customer service team on the back page and online:

- www.flymo.com/uk/c/support/contact-us



EC DECLARATION OF CONFORMITY

The undersigned hereby certifies as the authorized representative of the manufacturer, Husqvarna AB, SE 561 82 Huskvarna, Sweden, that, when leaving our factory, the unit(s) indicated below is/are in accordance with the harmonised EU guidelines, EU standards of safety and product specific standards. This certificate becomes void if the unit(s) is/are modified without our approval.

Description of the product:	Hedge Trimmer
Product type:	EasiCut Reach 480
Article number:	9705465
CE-Directives:	2006/42/EC 2014/30/EU 2011/65/EU 2000/14/EC
Harmonised EN:	EN ISO 12100 EN 62841-1 EN 62841-4-2
Deposited Documentation:	GARDENA Technical Documentation, M. Jäger, Hans-Lorensenstr. 40, D-89079 Ulm
Conformity Assessment according to:	2000/14/EC Procedure: art. 14 Annex V
Noise level: measured / guaranteed	96 dB/98 dB
Year of CE marking:	2023
Ulm, 06.02.2023 Authorised representative:	 Reinhard Pompe Vice President Products
	 Wolfgang Engelhardt Vice President Supply Chain

UKCA DECLARATION OF CONFORMITY

The manufacturer: Husqvarna AB SE 561 82 Huskvarna, Sweden hereby certifies, when leaving our factory, the unit(s) indicated below is/are in accordance with the UK Regulations, designated standards of safety and product specific designated standards. This certificate becomes void if the units are modified without our approval.

Description of the product:	Hedge Trimmer
Product type:	EasiCut Reach 480
Article number:	9705465
UK regulations:	S.I. 2008/1597 S.I. 2016/1091 S.I. 2012/3032 S.I. 2001/1701
Designated Standards:	EN ISO 12100 EN 62841-1 EN 62841-4-2
Importer to UK:	Husqvarna UK Limited Preston Road, Aycliffe, County Durham, UK, DL5 6UP
Deposited documentation:	GARDENA Technical Documentation, M. Jäger, Hans-Lorensenstr. 40, D-89079 Ulm
Noise level: measured / guaranteed	96 dB/98 dB
Conformity assessment:	According to S.I. 2001/1701 Art. 11 Schedule 8
Ulm, 06.02.2023 Authorised representative:	 Reinhard Pompe Vice President Products
	 Wolfgang Engelhardt Vice President Supply Chain

**Service Address and
Importer to Great Britain**

Husqvarna UK Ltd
Preston Road
Aycliffe Industrial Park
Newton Aycliffe
County Durham
DL5 6UP
customer.services@husqvarna.co.uk



31480-85.960.02/0824
Husqvarna AB
Drottninggatan 2
SE-561 82 Huskvarna
Sweden

Our policy of continuous improvement means that the specification of products may be altered from time to time without prior notice.
Copyright © 2024 Flymo S.A. All rights reserved.
Flymo® and other product and feature names are registered or unregistered trademarks of Flymo S.A.