



Designed to **Perform**

WEPW2200

**2200W (165 BAR) PRESSURE
WASHER**

Product Number: 1938377001

en - ORIGINAL INSTRUCTIONS

ASSEMBLY REQUIRED
MINIMUM TWO PERSONS

Service & Support: 01793 333212

Before use please read & understand this manual; paying particular attention to the safety instructions before use.
Incorrect use of the product could put the operator or machine in danger.

Whilst every effort has been made to ensure the accuracy of information contained in this manual, our policy of continuous improvement determines the right to make modifications without prior warning.
Images are used for illustration purposes only.



INSTRUCTION MANUAL

Copyright Notice

Copyright © Handy.

Permission is granted to reproduce this publication for personal & educational use only.

Commercial copying, redistribution, hiring, or lending is prohibited.

No part of this publication may be stored in a retrieval system or transmitted in any other form or means without written permission from Handy.

In all cases this copyright notice must remain intact.

CONTENTS

SPECIFICATION
IMPORTANT INFORMATION
GENERAL SAFETY INSTRUCTIONS
KNOW YOUR MACHINE
ASSEMBLY
POWER CONNECTION
OPERATION
MAINTENANCE & STORAGE
ELECTRICAL DIAGRAM
TROUBLE SHOOTING
PARTS DIAGRAM & LIST
DECLARATION OF CONFORMITY
GUARANTEE

INTENDED USE

The basic version of the equipment is a portable pressure washing machine, intended for private use, i.e. for use in home and gardening environments. It is designed to be used to wash and clean machines, vehicles, buildings, tools, facades, patio's, gardening tools etc.

The pressure washer is for private use, whose annual operating time generally does not exceed 50 hours. Public facilities, sports fields and agricultural/forestry applications are excluded.

Please read this entire manual prior to operating the equipment. It instructs you how to safely and easily set up, operate and maintain your machine. Please be sure that you, and any other persons who will operate the machine, carefully follow the recommended safety practices, at all times. Failure to do so could result in personal injury or property damage.

TO THE OWNER

All information in this manual is relative to the most recent product information available at the time of printing. Review this manual frequently to familiarise yourself with the machine, its features and operation. Please be aware that this Instruction Manual may cover a range of product specifications for various models. Characteristics and features discussed and/or illustrated in this manual may not be applicable or exact to all models.

We reserve the right to change product specifications, designs, and equipment without notice and without incurring obligation. If you have any problems or questions concerning the machine, phone your local authorised service dealer or Webb Garden Power. Throughout this manual, all references to *right* and *left* side of the machine are observed from the operating position.



WARNING

For safety reasons, the pressure washer may not be used as a drive unit for other equipment or toolkits of any kind, unless specifically advised to do so by the manufacturer. The equipment is to be used only for its prescribed purpose. Any other use is deemed to be a case of misuse. The user/operator and not the manufacturer will be liable for any damage or injuries of any kind caused as a result of this.

Please note that our equipment has NOT been designed for use in commercial, trade or industrial applications. Our warranty will be 90 days from the original date of sale for commercial, trade or industrial businesses or for equivalent purposes.



INSTRUCTION MANUAL

SPECIFICATION

Model	WEPW2200
Product Number	1938377001
Motor Capacity	2200W
Rated Voltage	220-240V~50/60 Hz
Working Pressure	110 bar (11.0 MPa)
Allowable Pressure	165 bar (16.5 MPa)
Working Flow Rate	6.3 l/min
Max. Flow Rate	8.2 l/min
Max. Pressure Water Supply	4 bar (0.4 MPa)
Max. Water Feed Temperature	50°C
Power Cable Length	6 m
Protection Rating	IPX5
Protective Class	II
Sound Power Level	L _{WA} 95 dB(A)
Weight (Tool Only)	N.W 11.3kg - G.W 14.3kg

The manufacturer reserves the right to change the product specification and livery according to continued product improvements.

Consistent with our policy of continuous improvement, The Handy reserves the right to change the design and configuration of any of its products without notice or obligation. Therefore, please treat the text and images in this manual for illustrative purposes only. They may in no case serve as a basis for any legal claim.

If you require any assistance with regards to the contents or operation of your machine, please contact us:

Tel: 01793 333212

Email: cs@webbgardenpower.co.uk

Opening Hours Weekdays: 8:00am - 5:00pm (CLOSED WEEKENDS & BANK HOLIDAYS)

IMPORTANT INFORMATION



WARNING

Read this instruction manual carefully before operating this machine. Make sure that you are familiar with the controls and properly operate the machine. Following these instructions to reduce the risk of fire, electric shock and personal injury.

IF NOT USED PROPERLY THIS MACHINE CAN BE DANGEROUS!

This machine can cause serious injury to the operator and others; the warning and safety instructions must be followed to ensure reasonable safety and efficiency in using this product. The operator is responsible for following the warning and safety instructions in this manual and on the machine. Never use the product unless the fixing screws or guards are correctly positioned.

DESIGNED FOR DOMESTIC USE ONLY.

For use outside of private homes and gardens, whose annual use will not generally exceed 50 hours and that are primarily used for cleaning machines, vehicles, tools, facades, patio's, gardening tools etc. by means of a high-pressure water jet. Potential risk may occur if not for such use. DOMESTIC USE ONLY but not in public facilities, parks or sports grounds and not for agricultural or forestry use.

Compliance with the operating manual supplied by the manufacturer is a prerequisite for the proper usage of the pressure washer. The operating manual contains servicing and maintenance instructions as well as directions for use.

TRAINING

Read the instructions carefully: Be familiar with the controls and the proper use of the equipment.

Never allow children or people unfamiliar with these instructions to use the product. Local regulations can restrict the age of the operator.

Never operate while people, especially children, or pets are nearby.













Keep in mind that the operator or user is responsible for accidents or hazards involving the machine that occur to other people or their property.



INSTRUCTION MANUAL

GENERAL SAFETY INSTRUCTIONS

It is important that you read and understand the owner's manual and labels affixed to the machine. Learn its application and limitations as well as the specific potential hazards. Retain these instructions for future reference. The operator is responsible for following the warnings & instructions in this manual and on the product. To help recognize this information, observe the following symbols.

	<p>Read & understand the instruction manual before using the machine. Failure to follow instructions could result in death or serious injury.</p>		<p>Check your machine before turning it on. Keep guards in place and in working order. Frequently check to see that foreign objects are removed from the tool area before turning it on. Replace damaged, missing or failed parts before using it.</p>
	<p>WARNING! High pressure jets can be dangerous if they are used incorrectly. The jet must not be directed towards persons, animals, electrical equipment connected to the mains or the appliance itself.</p>		<p>Double Insulated</p>
	<p>WARNING! To avoid a hazard due to inadvertent resetting of the thermal cut-out, this appliance must not be supplied through an external switching device, such as a timer, or connected to a circuit that is regularly switched on and off by the utility. Warning symbol: Machine not suitable for connection to the portable water mains.</p>		<p>Always disconnect your machine from the electrical supply before clearing, inspecting, or adjusting any part of it, or if the electrical supply cable has become damaged or entangled.</p>
	<p>Safety alert symbol. Used to alert you to potential personal injury hazards. Obey all safety messages that follow this symbol to avoid possible injury.</p>		<p>Indicates an imminently hazardous situation which, if not avoided, will result in serious injury.</p>
	<p>Indicates a potentially hazardous situation which, if not avoided, could result in serious injury.</p>		<p>Indicates a potentially hazardous situation which, if not avoided, may result in minor or moderate injury.</p>
<p>CAUTION</p>	<p>Used without the safety alert symbol, indicates a potentially hazardous situation which, if not avoided, may result in property damage.</p>		<p>Noise Level Image used for illustration purposes only, check machine and Declaration of Conformity for actual levels.</p>
	<p>Waste electrical products should not be disposed of with household waste. Please recycle where facilities exist. Check with your local authority for recycling advice.</p>		<p>CE Marking - the product meets demand and regulations set by the EU</p>

SAFETY & WARNING INFORMATION

Safety Guidelines

This manual contains information that is very important to know and understand. This information is provided for SAFETY and to PREVENT EQUIPMENT PROBLEMS

Automatic ON/OFF:

The motor on this pressure washer does not run continuously. It only runs when the gun trigger is squeezed. After following the start-up procedures in this manual, turn the pressure washer ON and squeeze the trigger for activation. See "Operating Instruction" section in this manual for further details.



WARNING

The electrical supply connection shall be made by a qualified person and comply with IEC 60364-1. The electric supply to this machine should include either a residual current device (RCD) that will interrupt the supply if the leakage current to earth exceeds 30 mA for 30ms or a device that will prove the earth circuit. The operating method to be followed in the event of accident (e.g. contact with detergents: rinse with an abundance of clean water) or breakdown to prevent unsafe situations. The motor of this pressure washer will NOT run unless the trigger is squeezed.

SAVE THESE INSTRUCTIONS



WARNING

When the machine is used, the following precautions should always be considered:

1. Read all instructions before using the machine.
2. To reduce the risk of injury, close supervision is necessary when a machine is used near children.
3. ALWAYS disconnect power before disassembling or repairing the unit of the machine.
4. Follow all safety codes as well as the Occupational Safety and Health Act (OSHA).
5. Ensure safety devices are operating properly before using the machine. DO NOT remove or modify any part of the gun or unit of the machine.
6. Know how to stop this machine and bleed pressure quickly. Be thoroughly familiar with the controls.
7. Stay alert – watch what you are doing.
8. Do not operate the machine when fatigued or under the influence of alcohol or drugs.
9. Keep operation area clear of all persons.
10. Do not overreach or stand on unstable support. Keep good footing and balance at all times.
11. Follow the maintenance instructions specified in the manual.
12. Use cleaning agent supplied or recommended by the manufacturer.
13. Only put the machine on stable place when using, transportation, assembly, dismantling. Do not rough handling the machine when transportation.
14. In any event of accident (e.g. contact with detergents, rinse with an abundance of clean water), please always switch off the machine and pull out the plug from socket outlet and Disconnect the connection with water.
15. The machine is not intended to be connected to the potable water mains. If necessary, please use only inlet hose-set approved by IEC 61770.

Risk of injection or severe injury. Keep clear of nozzle. Do not discharge streams at persons. This machine is to be used only by trained operators. Always remove lance from gun before cleaning debris from tip.

- Keep clear of nozzle. NEVER direct high-pressure spray at any person, animal or self.
- Always wear safety glasses or goggles and protective clothing when operating or performing maintenance.
- Never put hand or fingers over the spray tip while operating the unit.
- Never try to stop or deflect leaks with any body part.
- Always engage the trigger safety latch in the safe position even when spraying is stopped for a moment.
- Always follow detergent manufacturer's label recommendations for proper use of detergents. Always protect eyes, skin, and respiratory system from detergent use.



INSTRUCTION MANUAL



WARNING

SERVICING OF A DOUBLE INSULATED MACHINE

In a double insulated machine, two systems of insulation are provided instead of grounding. No grounding means are provided for a double-insulated machine, nor should grounding means be added to the machine.

Servicing a double-insulated machine requires extreme care and knowledge of the system and should be done only by qualified service personnel.

Replacement parts for a double-insulated machine must be identical to the original parts. A double insulated machine is marked with the words "Double Insulation" or "Double Insulated." Machine may also be marked with symbol shown below.



WARNING

Do not use pressure that exceeds the operating pressure of any of the parts (hoses, fittings, etc.) in the pressurised system. Ensure all equipment and accessories are rated to withstand the maximum working pressure of the unit.



WARNING

Explosion hazard.

Never spray flammable liquids or use pressure washer in areas containing combustible dust, liquids or vapors. Never operate the machine in a closed building or in or near an explosive environment.



WARNING

Do not spray electrical apparatus and wiring.

Never disconnect the high-pressure discharge hose from the machine while the system is pressurised. To depressurise machine, turn power and water supply off, then press gun trigger 2~3 times.

Never permanently engage the trigger mechanism on the gun.

Never operate the machine without all components properly connected to the machine (handle, gun/wand assembly, nozzle, etc.).



WARNING

Equipment damage.

ALWAYS turn water supply "ON" before turning pressure washer "ON." Running pump dry causes serious damage.

Do not operate the pressure washer with the inlet water screen removed. Keep screen clear of debris and sediment.

NEVER operate the pressure washer with broken or missing parts. Check equipment regularly and repair or replace worn or damaged parts immediately. Use only the nozzle supplied with this machine.

Never leave the wand unattended while the machine is running.

Never attempt to alter factory settings. Altering factory settings could damage the unit & void the warranty.

Always hold gun and wand firmly when starting and operating the machine.

NEVER allow the unit to run with the trigger released (off) for more than one (1) minute. Resulting heat buildup will damage pump.

Pressure washer is not supposed to pump hot water. NEVER connect it to a hot water supply as it will significantly reduce the life of the pump.

NEVER store the pressure washer outdoors or where it could freeze. The pump will be seriously damaged.

Release trigger when changing from high to low pressure modes. Failure to do so could result in damage.

Be aware of the recoil caused by the water jet when the machine is switched on.



CAUTION

Keep hose away from sharp objects. Bursting hoses may cause injury. Examine hose regularly and replace it if damaged. Do not attempt to mend a damaged hose.

EXTENSION CABLE

The use of an extension cable is not recommended. Use only extension cords intended for outdoor use. These are identified by the mark "Acceptable for use with outdoor machines; store indoors while not in use." Use only extension cords having an electrical rating equal to or more than the rating of the machine. Do not use damaged extension cords. Examine extension cord before using it and replace it if damaged. Do not abuse extension cord. Do not pull on the cord to disconnect. Keep cord away from heat and sharp edges. Always disconnect cord from receptacle before disconnecting machine from extension cord.



DANGER

Failure to follow these instructions can result in serious injury, including death.



WARNING

To reduce the risk of electrocution, keep all connections dry and off the ground. Do not touch plug with wet hands.



Machines shall not be used by children. Children should be supervised to ensure that they do not play with the machine. This machine is not intended for use by persons (including children) with reduced physical, sensory or mental capabilities, or lack of experience and knowledge.



WARNING

This machine has been designed for use with the cleaning agent supplied or recommended by the manufacturer. The use of other cleaning agents or chemicals may adversely affect the safety of the machine.

High pressure jets can be dangerous if subject to misuse. The jet must not be directed at persons, live electrical equipment or the machine itself.

It is recommended that the operator wears ear protectors.

Do not use the machine within range of persons unless they wear protective clothing.

Do not direct the jet against yourself or others, in order to clean clothes or footwear.

Risk of explosion - Do not spray flammable liquids.

High pressure cleaners should not be used by children or untrained persons.

High pressure hoses, fittings and couplings are important for the safety of the machine. Use only hoses, fittings and couplings recommended by the manufacturer.

To ensure machine safety, use only original spare parts from the manufacturer or approved by the manufacturer.



INSTRUCTION MANUAL



WARNING

Water that has flown through backflow preventers is considered to be non-portable. The machine should be disconnected from its power source by removing the plug from the socket outlet during cleaning or maintenance and when changing machine function. Do not use the machine if a power cable or important parts of the machine are damaged, e.g. safety devices, high pressure hoses, trigger gun. If an extension cable is used, the plug and socket must be of watertight construction. Inadequate extension cables can be dangerous. If an extension cable is used, it shall be suitable for outdoor use, and the connection has to be kept dry and off the ground. It is recommended that this is accomplished by means of a cable reel which keeps the socket at least 60mm above the ground. In order to avoid a hazard due to inadvertent resetting of the thermal cut-out, this appliance must not be supplied through an external switching device, such as a timer, or connected to a circuit that is regularly switched on and off by the utility.

Machine not suitable for connection to the potable water mains.



The machine is intended to be used at a temperature above zero degrees. (Only for machine with power cable of H05VV-F).

To ensure machine safety, please only use original spare parts (including nozzles) from the manufacturer or approved by the manufacturer. Do not use the machine before you change them if they are damaged. Be careful, danger of kickback force on the spray assembly when opening the trigger gun. Grasp the trigger gun firmly with both hands.

When the machine is being moved or installed, the machine must be on flat ground. When moving the machine, pull using the handle to move it.

Connect to the water supply. The machines are not suitable for connection to portable water mains. Connect the machine to the water supply. (It can be a water container). Make sure the inlet water pressure keeps between 0.01MPa and 0.4MPa. The inlet pipe should be at least 5m long. Do not use the pipe if the pipe is damaged. If you want to connect this machine to portable water mains, you must install a backflow preventer in the water pipe, to prevent dirty water flowing back to the drinking water system. The backflow preventer shall comply with EN 60335-2-79 ANNEX AA.

Disconnect from the electrical power supply before carrying out user maintenance. If the mains cable is damaged it must be replaced by the manufacturer, or its service agent or similarly qualified person to avoid a hazard.

KNOW YOUR MACHINE

A. Pressure Washer with High Pressure Hose	B. Water Inlet with Filter
C. Turbo Nozzle	D. Large Patio Cleaner
E. Detergent Bottle & Foam Sprayer	F. High Pressure Spray Gun, Lance & Vario Nozzle
G. User Manual	H. Cleaning Needle
I. Brush	

NOTE: Water inlet hose and HPC connector are not included.

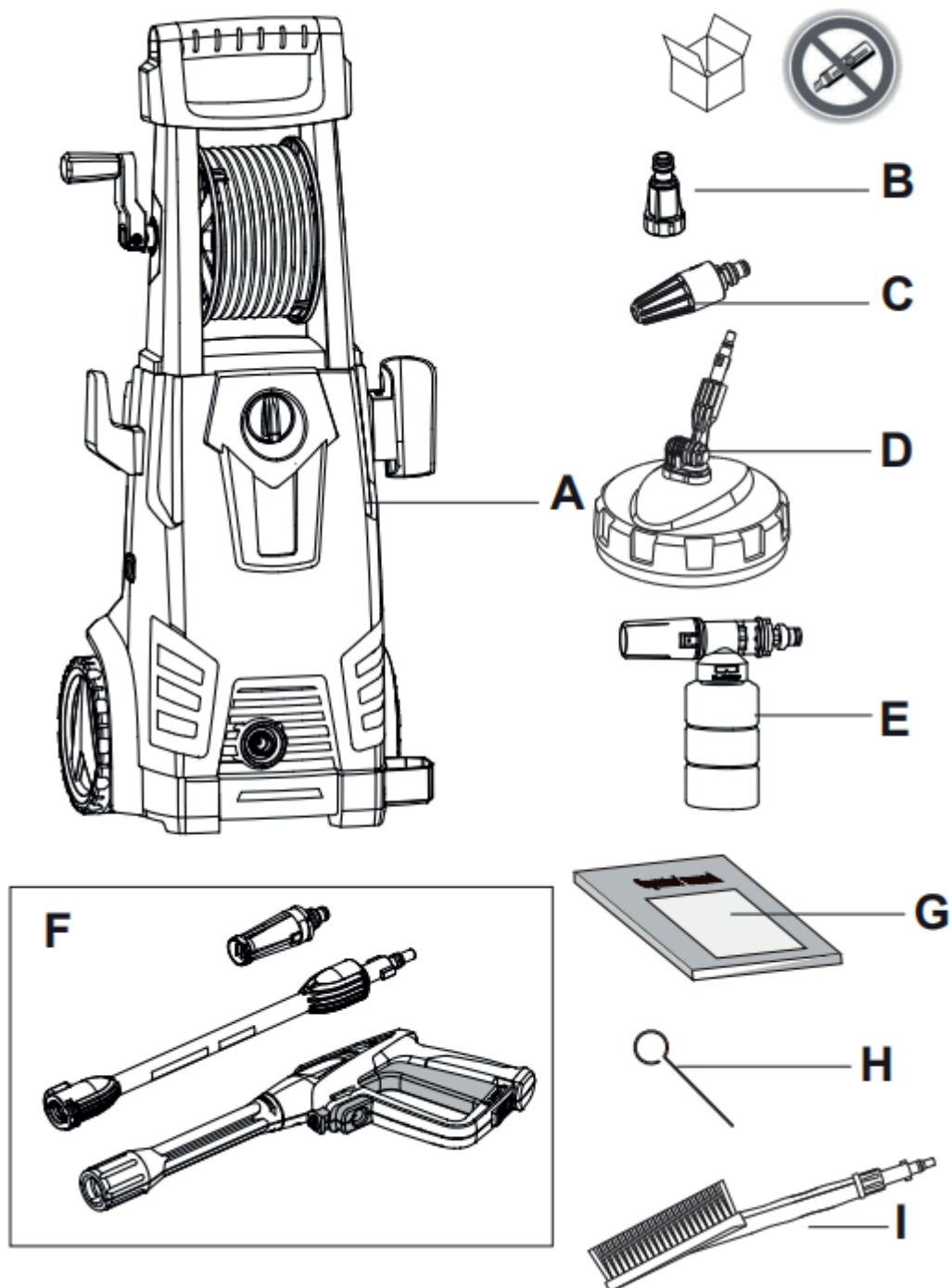



INSTRUCTION MANUAL

ASSEMBLY

Remove the machine and contents from the carton. Be sure the carton is empty before discarding.

If you require any assistance with regards to the contents or operation of your machine, please contact us:

Tel: 01793 333212

Email: cs@webbgardenpower.co.uk

Opening Hours Weekdays: 8:00am - 5:00pm (CLOSED WEEKENDS & BANK HOLIDAYS)

WATER CONNECTION

Connecting the water supply pipe. Follow your water supplier's instructions. For connection information, see the data plate/technical specifications. Use a reinforced hose (not supplied) with a standard connection (ext. diameter: 16mm/int. 12mm, maximum length: 25m).

IMPORTANT! Only use water without any impurities. If there is a risk of sand particles in the inlet water (i.e. from your own well), an additional filter should be mounted.

Let the water run through the water hose before connecting it to the machine to prevent sand and dirt from penetrating the machine. **NOTE:** Check that the filter is fitted in the water inlet pipe and that it is not clogged up. Connect the water hose to the water supply by means of the quick connector (inlet water, max. pressure: 10 bar, max. temperature: 60°C).

ATTACHMENTS

- Slide the gun holster and cable hook on to the body of the machine.
- Secure the high-pressure hose reel and top handle assembly to the pressure washer body, sliding from the front. Secure with the two self-tapping screws, from the rear.

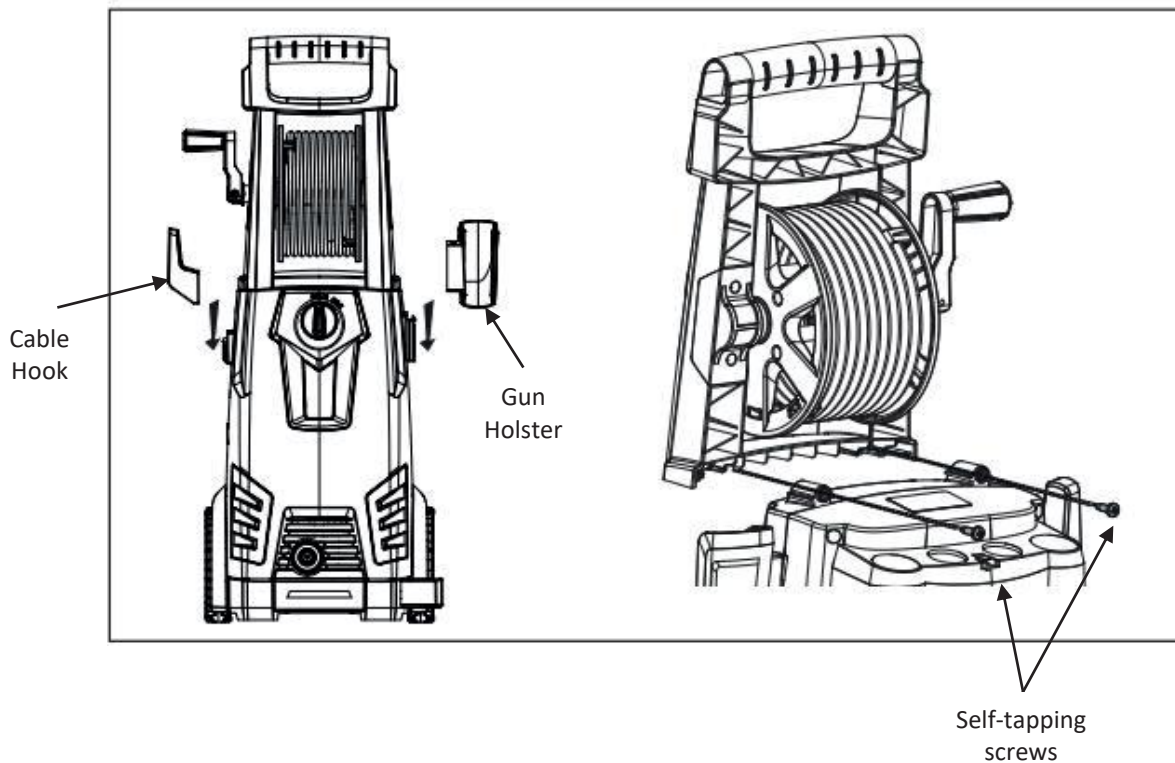

WATER INLET & GARDEN HOSE

CAUTION

Failure to fit the filter will invalidate the manufacturer's warranty.

- Connect the water inlet connector to the front of the pressure washer water inlet.



- Connect your garden hose (not supplied) to the pressure washer water inlet, using a standard quick release coupling (not supplied).

HIGH PRESSURE HOSE

- Attach the trigger hose to the pressure washer water outlet located at the rear of the machine.
- Align the hose with the pressure washer and push the hose neck collar into the machine fitting.





INSTRUCTION MANUAL

- Once seated, fit the threaded housing onto the thread of the machine. Be careful not to cross-thread and ensure it is securely tightened. (DO NOT OVER-TIGHTEN!)



- Attach the high-pressure hose to the trigger gun. Press the hose lock button (1) on the trigger gun and insert the hose (2). Release the hose lock button when the hose is locked into place, as imaged.

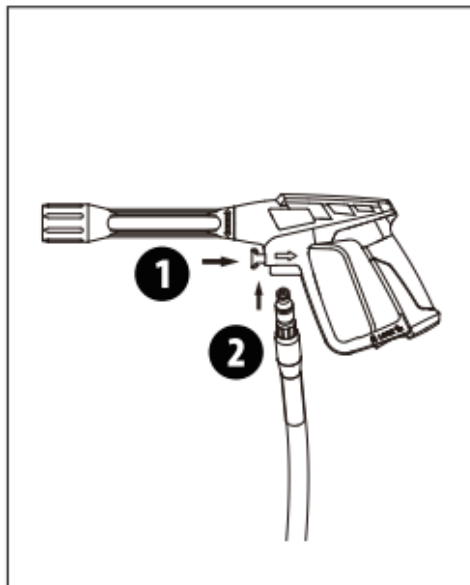

LANCE & NOZZLE

- Attach the lance onto the trigger gun (1).
- When inserted, push and turn it clockwise (2). **CAUTION:** Make sure the lance is properly fixed to the gun.
- Attach the adjustable spray nozzle, with a firm push. **CAUTION:** Check before activating the trigger that the nozzle is correctly attached.

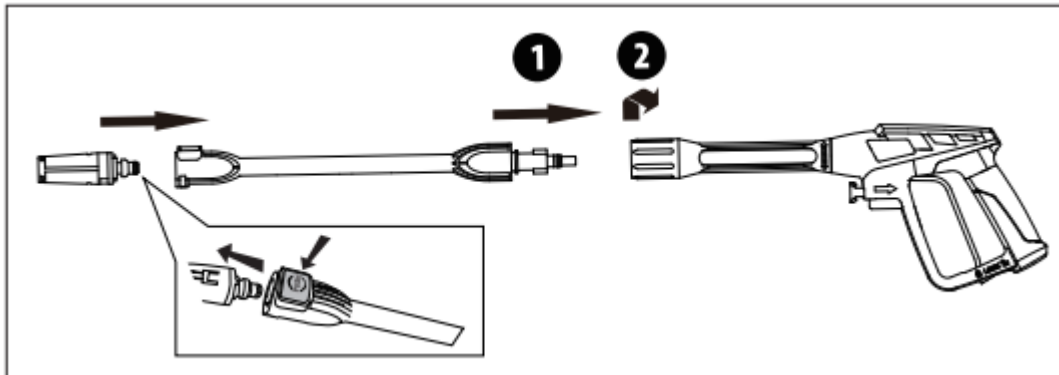

POWER CONNECTION



WARNING

To reduce the risk of injuries, always switch off the motor and pull out the mains plug before working on the machine.

The product can be connected to any socket (with 220-240V alternating current). We recommend to always use the appliance via a Residual Current Device (RCD) with a tripping current of max. 30mA.

1. Mains lead on electrical garden equipment are particularly susceptible to insulation damage. The causes of this include the following:
 - Damage through crashing, if the mains lead becomes stuck under obstructions.
 - Cracks caused by ageing of the insulation sheath.
 - Kinks caused by incorrect fastening of the mains lead.
2. Damaged mains lead should not be used under any circumstances as they may cause fatal injuries due to a damaged insulation sheath.
3. Always check the plug and cable and make sure they are in good condition before operation.
4. If an extension cable is used, the plug and socket must be waterproof and intended for outdoor use. These are identified by the mark "Acceptable for use with outdoor machines; store indoors while not in use." Use only extension cables having an electrical rating equal to or more than the rating of the machine. Do not use damaged extension cables. Examine the extension cable before using it and replace it if damaged. Do not abuse extension cable. Do not pull on the cable to disconnect from the electrical power supply. Keep cable away from heat and sharp edges. Always disconnect cable from receptacle before disconnecting machine from extension cable.



DANGER

Failure to follow these instructions can result in serious injury, including death.



INSTRUCTION MANUAL

OPERATION



WARNING

**If the machine vibrates unusually during operation, it may indicate that it is damaged!
The product should be inspected and repaired immediately!**

- Check the product, its power cable and plug, as well as accessories for damage before each use. Do not use the product if it is damaged or shows wear.
- Double check that accessories are properly connected.
- Ensure that the air vents are always unobstructed and clear. Clean them, if necessary, with a soft brush. Blocked air vents may lead to overheating and damage the product.
- Switch the product off immediately if you are disturbed while working by people or animals entering the work area. Always let the product come to a complete stop before releasing the trigger gun.
- Do not overwork yourself or the machine. Take regular breaks to ensure you can concentrate on the work and have full control over the product.
- Adjust the variable power of the nozzle. Operate the product at an appropriate power. Do not operate it too fast on delicate surfaces.
- Pay special attention when changing direction.

START THE MACHINE

NOTE: The trigger gun and lance are affected by a thrust during operation - therefore always hold it firmly with both hands when switching the machine on.

Check that the machine is in an upright position and switched off. **NOTE: Do not place the machine in tall grass!**

- Attach your garden hose to the water inlet of the machine.
- Attach your garden hose to the water supply.
- Plug the pressure washer into the electrical supply or waterproof extension lead, with the BS 3-pin plug ideally using a via a Residual Current Device (RCD).
- Turn on water supply.
- Turn the On/Off switch on the pressure washer to the ON position.
- Activate the trigger button of the trigger gun by pulling upwards with your fingers on the trigger.

IMPORTANT: Point the nozzle at the ground away from feet.

- Always adjust the distance and the pressure of the nozzle to the surface, which is to be cleaned.
- Do not cover the pressure washer during operation or use it in a room without adequate ventilation!

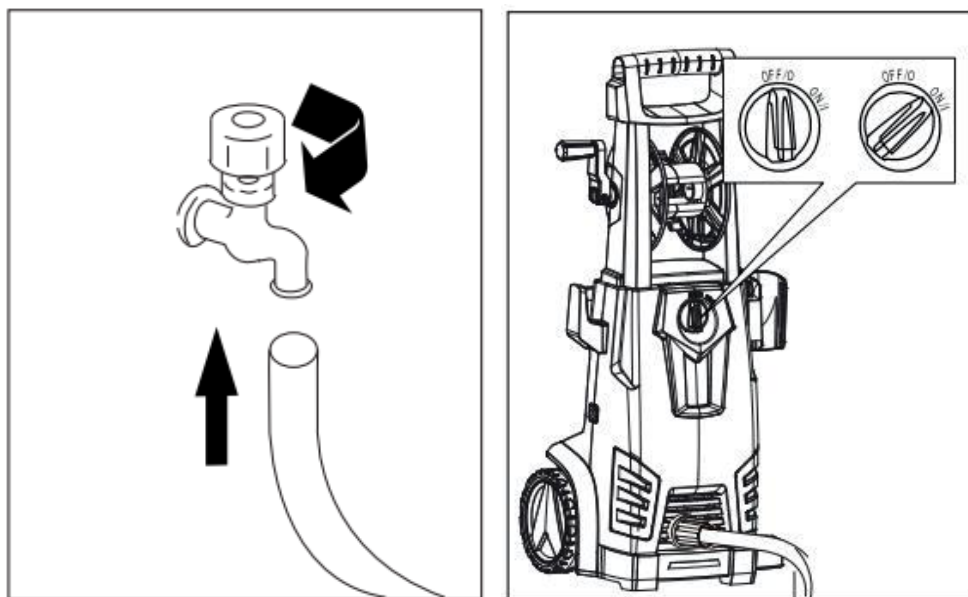

STOP THE MACHINE

NOTE: If the machine is left or not used for 5 minutes, it must be switched off:

- Release the trigger on the trigger gun. When releasing the trigger of the trigger gun, the machine automatically stops. The machine will start again when you re-activate the trigger gun.
- Turn the On/Off switch on the pressure washer to the OFF position.
- Disconnect the electrical plug from the electrical power supply.
- Shut off the water supply and activate the trigger of the trigger gun to relieve the machine of pressure and expel any remaining water.

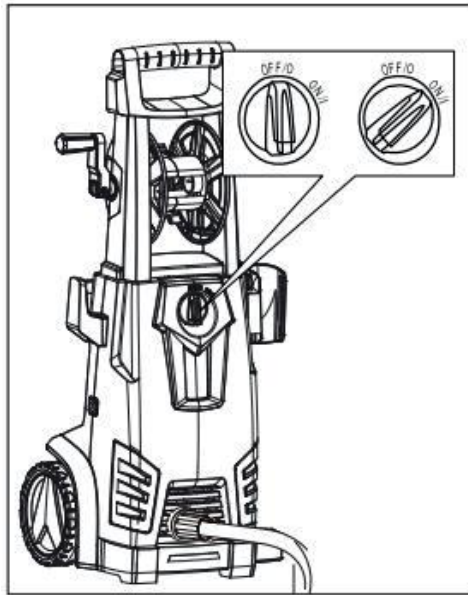

TRIGGER LOCK

To prevent accidental starting of the machine, the spray gun is fitted with a trigger lock. When the machine is not in use, press the trigger lock to the locked position. To unlock, press the trigger lock to the unlocked position.

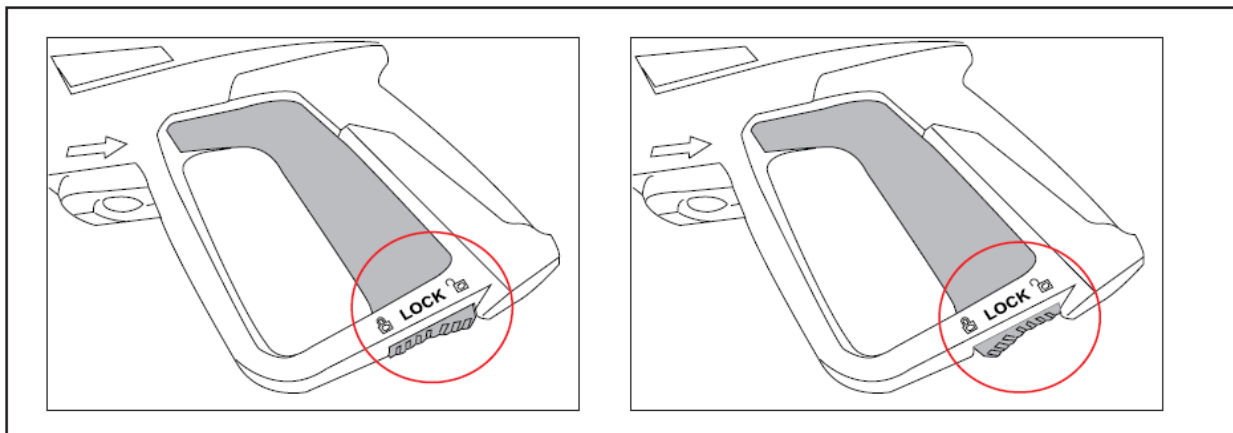



INSTRUCTION MANUAL

ADJUSTABLE SPRAY NOZZLE

The pressure from the multi-nozzle can be adjusted by turning it. The angle of spray coming out of the lance may be adjusted on some lances by rotating the nozzle. This will vary the spray pattern from approximately a 0° narrow high-power stream to a 60° wide low power fan spray.

WARNING: Do not do this under operation to avoid hands hitting the jet.

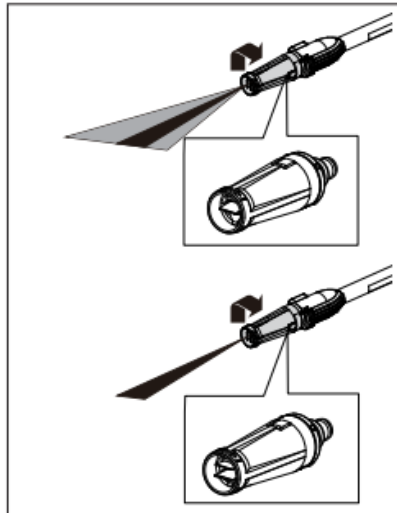

High Power Narrow Stream

A narrow stream has high impact force on the cleaning surface and results in maximum deep cleaning in a concentrated area. However, this narrow high impact spray must be used cautiously, as it may damage some surfaces. Only use on hard unpainted surfaces, such as stone, tarmac, concrete. **Do not use** on wood, motor vehicles or sensitive surfaces such as water, as there is a risk of damage.

Low Power Fan Spray

A wide fan pattern will distribute the impact of the water over a larger area, resulting in excellent cleaning action with a reduced risk of surface damage, large surface areas can be cleaned more quickly using a wide fan pattern.

TURBO NOZZLE

This nozzle circulates a powerful spray into a circular pattern to provide greater cleaning efficiency over large areas.

NOTE: This nozzle should not be used on any sensitive surface or painted area

Surfaces can be damaged when the jet is too close to the surface, or an unsuitable spray lance is used. Maintain a minimum spray distance of 30 cm when cleaning painted surfaces. Do not clean car tyres, paint or sensitive surfaces such as wood with the turbo nozzle.

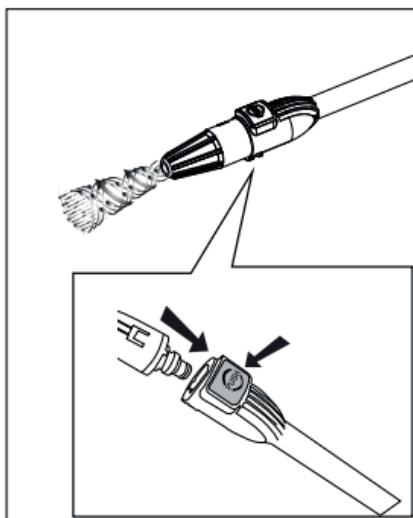

ANGLE OF OPERATION

When spraying water against a surface, maximum impact is generated when the water strikes the surface “head on.” However, this type of impact tends to cause dirt particles to imbed in the surface, preventing the desired cleaning action. The optimum angle for spraying water against a cleaning surface of 45 degrees and at least 60cm away from the target area. The closer you are to the target area; the impact force of the water is increased. Spraying water against the surface at this angle and distance provides the most beneficial impact force, combined with efficient removal of debris from the surface.

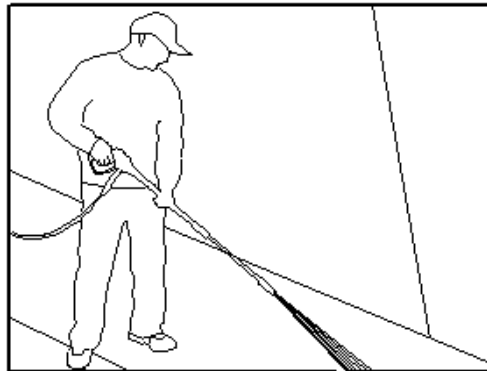

HOW TO AVOID DAMAGING SURFACES

Damage to surfaces occurs because the impact force of the water exceeds the durability of the surface. The impact force can be varied by controlling the three previously noted items. Never use a narrow high impact stream on a surface that is susceptible to damage. Avoid spraying window with a narrow high impact stream as this may cause breakage.

The best way to avoid damaging surfaces is to follow these steps:

1. Before triggering the gun, adjust the nozzle to a wide fan pattern.
2. Place the nozzle approximately 4-5 feet away and 45 degrees of the cleaning surface and trigger the gun.
3. Adjust the fan pattern spray angle and the distance to the cleaning surface until optimum cleaning efficiency is achieved without damaging the surface.

DETERGENTS

The use of detergents can dramatically reduce cleaning time and assist in the removal of difficult stains. Some detergents have been customized for pressure washer use on specific cleaning tasks. These detergents are approximately as thick as water. The use of thicker detergents, such as washing up liquid, will clog the chemical injection system and prevent the application of the detergent.

The cleaning power of detergents comes from applying them to the surface and giving the chemicals time to break down the dirt and grime. Detergents work best when applied at low pressure.

The combination of chemical action and high-pressure rinsing is very effective. On vertical surfaces, apply the detergent starting at the bottom and work your way upward. This will prevent the detergent from sliding down and causing streaks. High pressure rinsing should also progress from the bottom to top. On particularly tough stains, it may be necessary to use a brush in combination with detergents and high-pressure rinsing.

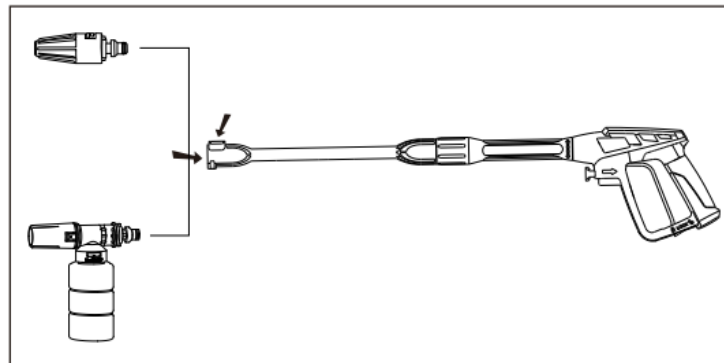



INSTRUCTION MANUAL

The following cleaning procedure will help you to organise your cleaning task and ensure that you achieve the most beneficial results in the shortest amount of time. Remember to use the spraying/cleaning techniques previously listed.

Surface Preparation

Before starting a pressure wash cleaning job, it is important to prepare the surface that is to be cleaned. This is done by clearing the area of furniture and other obstacles, making sure that all windows and doors are closed tight.

Initial High-Pressure Rinse

The next step is to spray the cleaning surface with water to clear off any dirt or grime that may have collected on the surface. This will allow your detergent to attack the deep-down dirt that has worked its way into the cleaning surface. Before triggering the gun, adjust the nozzle to a wide fan pattern and slowly adjust to the desired spray pattern. This will help you avoid applying too much concentrated spray to the surface which could cause damage.

Final Rinse

Start the final rinse at the bottom and work upward. Make sure you thoroughly rinse the surface and that all detergent has been removed

Shut Down

- Be sure all detergent is flushed from system.
- Turn off motor.
- Turn off water supply.
- After motor and water supply are turned off, trigger gun to depressurise system.

CAUTION

NEVER turn water supply off before turning motor off. Serious damage could occur to the pump and/or motor.



WARNING

NEVER disconnect high pressure discharge hose from machine while system is pressurised. To depressurise, turn motor off, turn water supply off and squeeze gun trigger 2-3 times.

- After each use, wipe all surfaces of the pressure washer with a clean, damp cloth.

WASH BRUSH

A wash brush is supplied with soft bristles and can be used in conjunction with the detergent dispenser to apply detergent to the surface you are cleaning. These are ideal for cleaning car bodywork, windows etc. This is a low-pressure setting accessory. **NOTE:** The brush can be fitted into the trigger gun directly.

Paint damage: Damage to surfaces through a dirty brush. Ensure that the wash brush is free from dirt or other particles before using it.

- To fit the wash brush to the trigger gun, slide the wash brush into the trigger gun & whilst applying downward pressure, turn clockwise. **CAUTION:** Check before activating the trigger that the nozzle is correctly attached.

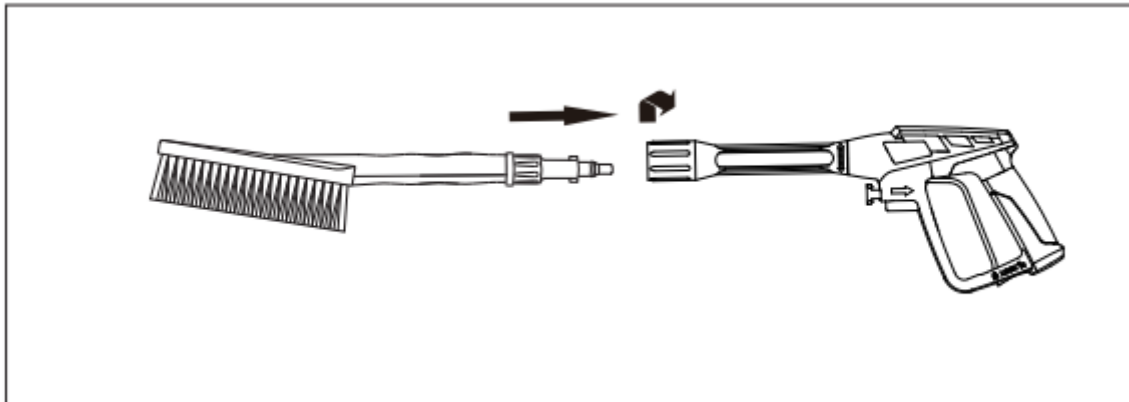

PATIO CLEANER

A patio cleaner is supplied with firm bristles and can be used on floor and wall surfaces made of different materials such as plastic, wood, concrete, natural stone and tiles. Click patio cleaner into the lance extension and then connect it to the spray gun.

The twin high pressure nozzles are located on the end of the rotating bar, which apply water to the surface whilst rotating within the patio cleaner body.

Note: All these fittings are bayonet fittings which push in then twist to lock.

Note: Prior to using the patio cleaner always check that you will not damage the surface area on a test area first.

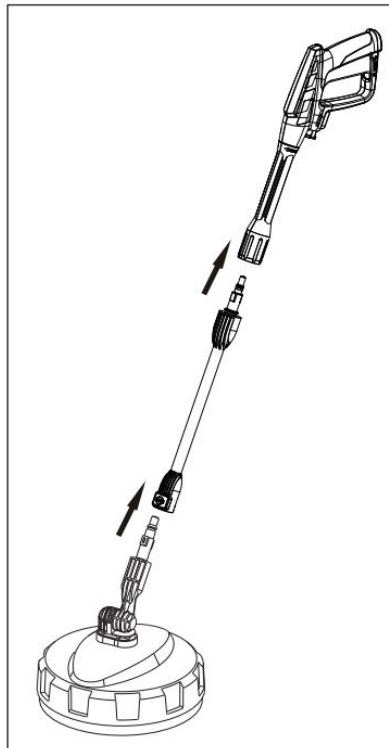

The Patio Cleaner is not suited for scouring or scrubbing. All outdoor surfaces should be swept to remove debris before the Patio Cleaner is used to avoid damaging the high-pressure nozzles. Glide the Patio Cleaner over the surface without effort.

AFTER USE

The machine and accessories should be stored in a frost-free room and out of direct sunlight!

Pump, hose and accessories should always be emptied of water prior to storing as follows:

- Stop the machine by turning the On/Off switch to OFF.
- Turn off water supply. (Never turn off the water supply before turning off the machine)
- Restart the machine by turning the On/Off switch to ON and activate the trigger of the trigger gun. Let the machine run until no more water runs through the trigger gun.
- Stop the machine by turning the On/Off switch to OFF and remove the electrical plug from the power source.
- Wind up hose and electrical cable.
- Place trigger gun, lance, nozzles, and other accessories into any relevant holder on the machine.
- Wipe all surfaces of the machine with a clean damp cloth.



INSTRUCTION MANUAL



WARNING

NEVER start up a frozen machine. Frost damages are not covered by the Webb Garden Power warranty. NEVER disconnect high pressure discharge hose from machine while system is pressurised. To depressurise, turn motor off, turn water supply off and squeeze gun trigger 2-3 times.

CAUTION

NEVER turn water supply off before turning motor off. Serious damage could occur to the pump and or motor not covered by the Webb Garden Power warranty.

TIPS TO EXTEND LIFE OF PRODUCT

- Never operate unit without water.
- Pressure washer is not meant to pump hot water. Never connect to hot water supply – this will significantly reduce life of the pump.
- Using detergent other than specific pressure washer detergents may cause damage to pump components (O-rings etc.). This also applies to chemicals such as bleach, dish soap, etc.
- Never operate unit for more than a minute without spraying water. Resulting heat buildup will damage pump.
- Before adjusting nozzle pressure (high-to-low or low-to-high) release trigger. Failure to do so will reduce life of O-rings in lance.

MAINTENANCE & STORAGE

To ensure a long and problem free life of your machine, please take the following advice:

- Wash the water hose, high pressure hose, spray lance and accessories before mounting.
- Clean the connectors of dust and sand.
- Rinse the detergent spraying attachment after use (if supplied).
- Clean the nozzles.
- Any repair should always be made in an authorised workshop with original spare parts.
- Prior to cleaning or any maintenance, always ensure the power plug has been removed from the electric power supply.
- When you have finished using the machine, always check to make sure the product is clean and free of dirt and debris.
- Do not use solvents to clean the machine.
- Store the machine in a dry place, and out of reach of children.
- Regularly check for obvious defects, such as loose, dislodged or damaged fixings and worn or damaged components.
- Check that covers and guards are undamaged and correctly fitted. Carry out necessary maintenance or repairs before using the product.
- If the device fails despite the care taken in manufacturing and testing, the product should be returned to your retailer or an approved service dealer.
- Do not clean the product while it is running.
- Ensure that all the fastening elements (screws, nuts, etc.) are always tight, so that you can safely work with the product.
- Check the product frequently for signs of wear. Replace worn or damaged parts.
- Do not store the pressure washer outdoors.
- Do not store the pressure washer where it might freeze.
- Clean the product with a brush or damp cloth. Do not use any solvents or water to remove dirt.

POWER CABLE MAINTENANCE

If the power cable needs replacing, the repair must be carried out by the manufacturer's approved service dealer within warranty, or an authorised electrical specialist outside of warranty to avoid a safety hazard.

CLEANING OF AIR VENTS

The machine should be kept clean to let the cooling air pass through the machine vents freely.

GREASING OF COUPLINGS

To ensure the O-rings do not dry up and hence an easy connection; the couplings should be greased regularly with multi-purpose grease.

FILTER CLEANING

The transparent filter fitted to the water inlet connector will require cleaning from time to time. Remove any garden hose fitted to the machine and unscrew the water inlet connector. Once removed, remove the transparent filter from the water inlet connector and clean by holding under a running tap.

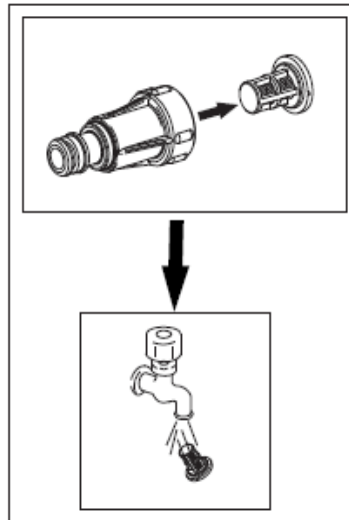

SPRAY NOZZLE CLEANING

A clogged or partially clogged nozzle can cause a significant reduction of water coming out of the nozzle and cause the unit to pulsate while spraying. To clean out the nozzle:

- Turn off and unplug unit.
- Turn off water supply. Relieve any pressure trapped in the hose by squeezing trigger 2-3 times.
- Separate lance from gun.
- Rotate nozzle to the narrow stream setting. This opens the fan blades.
- Using included tip cleaner, or an unfolded paper clip, insert wire into the nozzle hole and move back and forth until debris is dislodged.

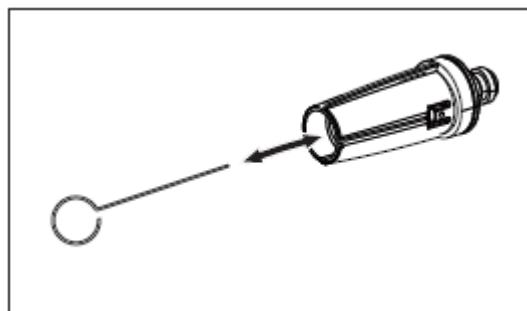



INSTRUCTION MANUAL

TIPS TO EXTEND YOUR PRESSURE WASHER LIFE

- Never operate unit without water.
- The pressure washer is not designed to pump hot water. Never connect to the hot water supply – this will significantly reduce life of the pump.
- Using detergents which are not designed for pressure washers, may cause damage to pump components (O-rings, etc.). This also applies to chemicals such as bleach, dish soap, etc.
- Never operate the unit for more than one (1) minute without spraying water. Resulting heat buildup will damage the pump.
- Before adjusting nozzle pressure (high-to-low or low-to-high) release the trigger. Failure to do so will reduce the life of O-rings in the pump.

ELECTRICAL DIAGRAM

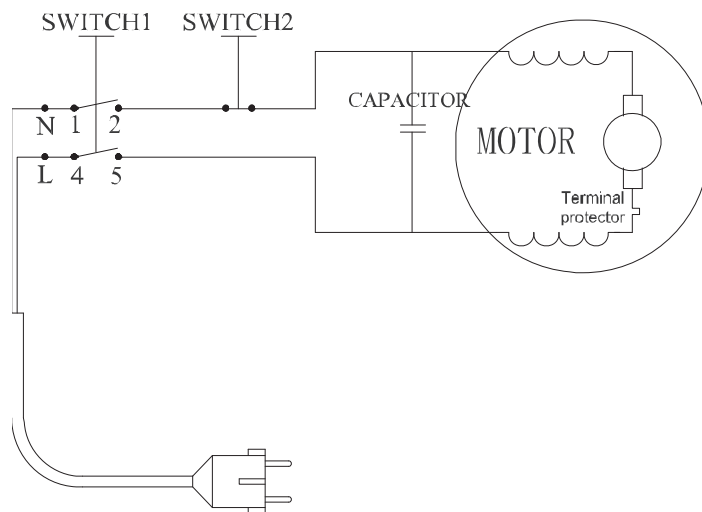

TROUBLE SHOOTING



WARNING

Only perform the steps described in these instructions!

All further inspection, maintenance & repair work must be performed by an authorised service specialist, if financially viable.

If the product does not perform properly, makes unusual sounds, the motor does not start or stop as described, or any other irregularity or malfunction occurs, do not attempt to repair the product by yourself. Please contact customer services or your local authorised service dealer.

Before attempting any of the below actions, ensure the machine is removed from the electrical supply.

PROBLEM	POSSIBLE CAUSE	FAULT CORRECTION
Will not start.	Not connected to power supply	Connect to power supply
	Power cord or plug is defective	Check by a specialist electrician.
	Fuse in plug failed	Replace with new fuse
	Motor or switch defect	Return machine to retailer.
Fluctuating pressure	The pump is drawing in air	Check that hoses and connections are airtight
	Valves dirty, worn or sticking	Contact your service centre
	The water supply is insufficient.	Increase water pressure, check for blockages and/or change the large pipe.
	Pump seals worn	Contact your nearest service centre
The machine stops	The fuse has blown	Replace the fuse
	Incorrect mains voltage	Unplug other appliances. Check that the mains voltage corresponds to the specifications on the nameplate
	Thermal sensor activated	Leave the machine to cool for 5 mins
	Partially blocked jet	Clean the jet with a needle and by spraying water rearwardly through the jet
Fuse blown	Fuse too small	Replace it with a fuse with higher amp consumption than the washer.
	Increase in the amperage	Try without the extension cable
Pulsing machine	Air in inlet hose / pump	Allow machine to run with open trigger until regular working pressure resumes.
	Inadequate supply of water generated	Increase water pressure, check for blockages and/or change the large pipe.
	Partially blocked jet	Clean the jet with a needle and by spraying water rearwardly through the jet
	Water filter blocked	Clean the filter
	Folded pipe	Unfold the pipe
The machine turns on and off by itself	Pump fuse and/or trigger out of order	Contact your nearest service centre
	No water supply	Connect the inflow water
The machine is on but water is not coming out	Water filter blocked	Clean the filter
	Blocked jet	Clean the jet with a needle and by spraying water rearwardly through the jet

If you can't fix the fault yourself, contact your retailer. Please be aware that any improper repairs will also invalidate the warranty and additional costs may be incurred.



INSTRUCTION MANUAL

PARTS DIAGRAM

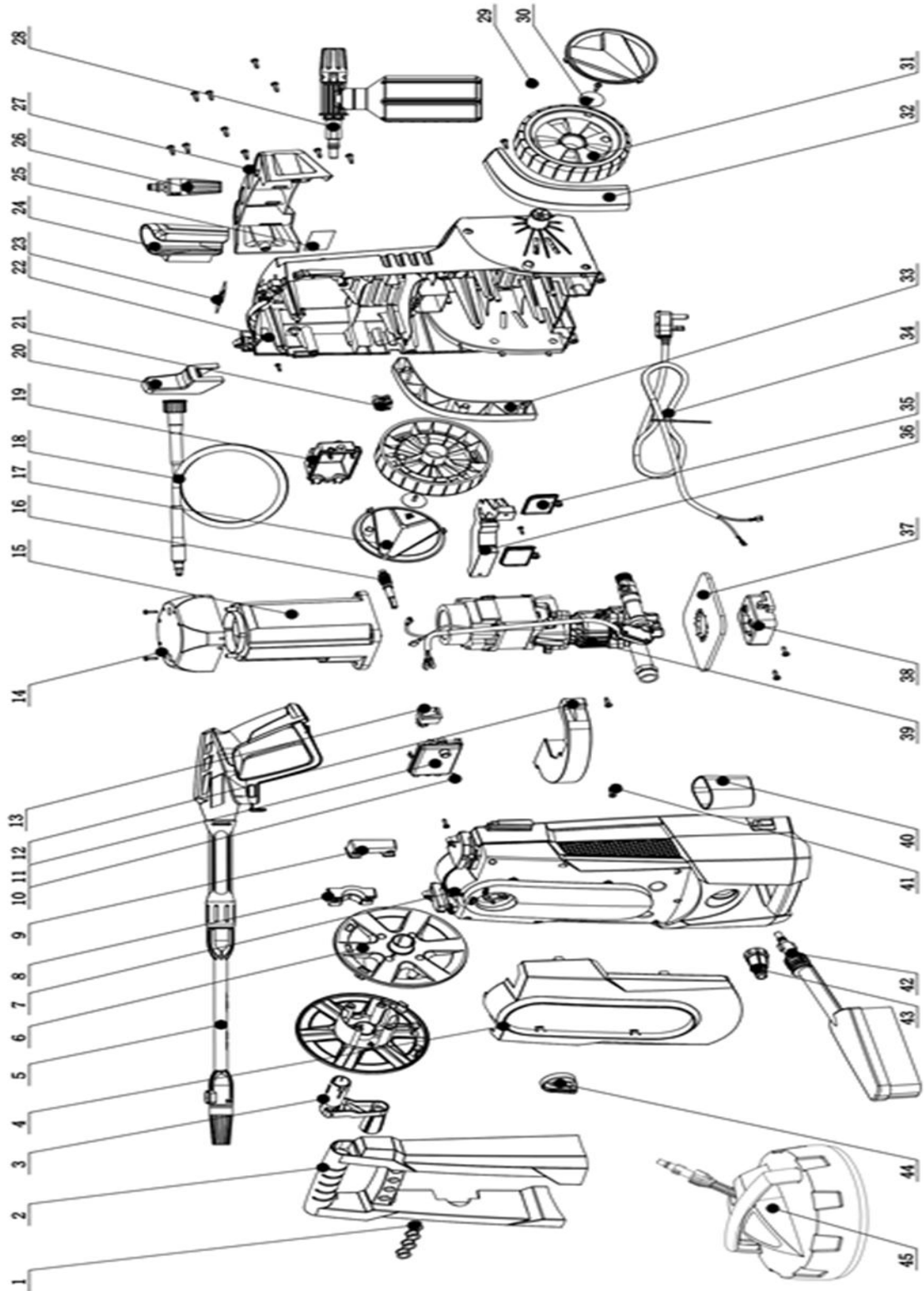

PARTS LIST

Item No.	Webb Part No.	Webb Description	QTY
2	WE255-2200-2	Top Long Handle	1
3	WE255-2200-3	Reel Handle Assembly	1
4	WE255-2200-4	Front Housing	1
5	WE255-2200-5	Spray Gun & Lance	1
6	WE255-2200-6	Hose Reel Assembly	1
7	WE255-2200-7	Front Housing Exterior	1
8	WE255-2200-8	Left Press Plate	1
9	WE255-2200-9	Right Press Plate	1
10	WE255-2200-10	Screw ST4x16	4
11	WE255-2200-11	Switch Box	1
12	WE255-2200-12	Pressing Plate Upper	1
13	WE255-2200-13	Switch	1
14	WE255-2200-14	Motor Cover Upper	1
15	WE255-2200-15	Motor Cover Body	1
16	WE255-2200-16	Switch Rod	1
17	WE255-2200-17	Wheel Trim	2
18	WE255-2200-18	High Pressure Hose	1
19	WE255-2200-19	Switch Box	1
20	WE255-2200-20	Cable Hook	1
21	WE255-2200-21	Cable Sheath	1
22	WE255-2200-22	Lower Housing	1
23	N/A		1
24	WE255-2200-24	Trigger Gun Hook	1
25	N/A		1
26	WE255-2200-26	Turbo Nozzle	1
27	WE255-2200-27	Accessory Holder	1
28	WE255-2200-28	Foam Bottle & Dispenser	1
29	WE255-2200-29	Screw ST4.8x16	22
30	WE255-2200-30	Wheel Gasket	2
31	WE255-2200-31	Wheel	2
32	WE255-2200-32	Right Arch	1
33	WE255-2200-33	Left Arch	1
34	WE255-2200-34	BS Plug & Cable	1
35	WE255-2200-35	Water Retaining Plate	2
36	WE255-2200-36	Pressing Plate Lower	1
37	WE255-2200-37	Motor Screen	1
38	WE255-2200-38	Pump Fixing Seat	1
39	WE255-2200-39	Motor & Pump Assembly	1
40	WE255-2200-40	Trigger Gun Holder	1
41	WE255-2200-41	Screw ST3.5x13F	7
42	WE255-2200-42	Wash Brush	1
43	WE255-2200-43	Turbo Nozzle	1
44	WE255-2200-44	On/Off Switch	1
45	WE255-2200-45	Patio Cleaner Large	1



INSTRUCTION MANUAL



DECLARATION OF CONFORMITY

We Handy - SN3 5HY (Importer) declare that the product:

Designation: Webb 2200w Electric Pressure Washer

Model(s): WEPW2200

Product No.: 1938377001

Type/Serial No. As per rating label on machine

Rated Voltage: 220-240V~

Rated Frequency: 50/60Hz

Rated Input: 2200w

Protection Rating - Class: IPX5 - II

Complies with the following directives:

Machinery Directive 2006/42/EC

The conformity assessment procedure followed was in accordance with:

EN 60335-2-79:2012, EN 60335-1:2012+A11+A13+A14+A2+A15, EN 62233:2008

Electromagnetic Compatibility Directive 2014/30/EU

The conformity assessment procedure followed was in accordance with:

EN IEC 55014-1:2021, EN IEC 55014-2:2021, EN IEC 61000-3-2:2019+A1, EN IEC 61000-3-11:2019

BS EN IEC 55014-1:2021, BS EN IEC 55014-2:2021, BS EN IEC 61000-3-2:2019+A1, BS EN IEC 61000-3-11:2019

BS EN 55014-1:2017+A11, BS EN 55014-2:1997+A2, BS EN 61000-3-2:2014, BS EN 61000-3-11:2001

RoHS Directive 2011/65/EU Annex II & 2015/863/EU

The conformity assessment procedure followed was in accordance with EN IEC 63000:2018, IEC62321-XX series (as per latest requirement by some professional EU retailers).

Outdoor Noise Directive 2000/14/EC

The conformity assessment procedure followed was in accordance with:

IEC 60335-2-79:2012:02

Sound Pressure Level LPA: 79 dB(A) Uncertainty K = 3 dB(A)

Sound Power Level LWA: 95 dB(A)

According to 2000/14/EC Hand-arm Vibration: <2.5m/s²

Notified Body:

TÜV Rheinland LGA Products GmbH

Authorised signatory and technical file holder:

Date: 31/07/2025

Signature:

Name: Mr Simon Belcher

Position: Chairman

Company: Handy - **Address:** Murdock Rd, Swindon, Wiltshire, SN3 5HY.

This Service Book is provided with your Webb, to help you look after your purchase to our recommendations and enable you to take advantage of the conditional manufacturer domestic warranty*.

Present this service book to your authorised Webb repair dealer, whenever a service or a warranty appraisal is required.

The booklet is applicable to the following products, in the UK only:

- Ride On Lawn Tractors
- Cylinder Lawnmowers
- Petrol Rotary Lawnmowers
- Petrol Hand Held Range

Please register your machine using the following pages or at www.webbgardenpower.co.uk. By registering your machine, you agree to maintain the machine in accordance with the service schedules specified in this manual and services duly recorded. (Not applicable for Webb electric handheld machines). You may be asked to produce this booklet as proof of servicing in the event of a claim. Proof of purchase should also be kept as a reference.

Ensure you have the following information available from your machine product label. The two examples below can be found on your machine:



1. Model Number

2. Serial & Product Number

Please complete using BLOCK CAPITALS.
Sections marked* must be completed to validate Warranty.



INSTRUCTION MANUAL

Users Statement of Warranty

Each new machine is warranted against defective material or assembly of material under normal usage. The warranty applies to the original purchaser and covers faulty parts and the labour involved in replacing and repairing those parts, which are of original manufacture.

All claims must be accompanied by evidence of the date of purchase, such as a Sales Receipt showing that the product has been purchased from an approved retailer, it was brand new at time of purchase, which is within the warranty time period.

Period of Warranty

Webb (Green Products)

- a) 3 years from the original date of sale to the first domestic user. (2 years batteries & chargers)
- b) 90 days from the original date of sale to the professional/commercial user.
- c) 90 days from the original date of sale when used for hire.
- d) A reduced warranty period of 90 days applies to those items which are subject to normal wear and tear (e.g. but not limited to wheels, tyres, cutter bars, cylinders, cutting blades, blade boss, belts, cables, nylon line & spool, collection bags, engine spark plugs, electric plug fuses).
- e) Engines are supplied with a separate warranty to the machine. The engine manufacturers warranty statement which will be supplied within the engine instruction manual. All enquiries and warranty repairs should be discussed with the engine manufacturer or approved warranty repair dealer.
- f) 90 days from the original date of purchase for Replacement Spare Parts (unless normal wear & tear component, which are covered for 30 days).
- g) All machines' must be serviced within the first 12 & 24 months from the original date of purchase to comply with the warranty (if applicable), failure to do so will invalidate the 2nd & 3rd years of the warranty.

All warranty repairs must be undertaken by an authorised service dealer. These dealers have been accredited by GJ Handy (Trading) Ltd and agree to only use genuine parts and follow our repair procedures.

Not covered by this warranty

- a) Error in assembly by user in accordance with manufacturers instructions.
- b) Incorrect operation of product in accordance with manufacturers instructions.
- c) The defect is due to accident, misuse, unauthorised modification or inexpert repair.
- d) The warranty policy does not cover any depreciation or damages caused by ordinary wear, rusting or corrosion, lack of correct maintenance or operation, misuse, abuse, lack of transportation or accident.
- e) The warranty policy does not cover any costs necessary for the standard periodic maintenance services instructed by the operator's manual, or service parts replacement which would include oil, filters, tyres, belts, brake linings, fuses, blades, seals and other service parts unless it can be proven that the item has evidence of faulty manufacture.
- f) The warranty policy will not cover failure or damage caused as a result of parts or accessories being modified without the written approval of GJ Handy (Trading) Ltd.
- g) The warranty policy will not cover the unit if non-genuine parts have been fitted and as a result damage has occurred to the unit.

- h) The warranty policy is non-transferable and is only applicable to the original purchaser.

Disclaimer

- a) This warranty is only a remedy for defect of products. GJ Handy (Trading) Ltd will never warranty in terms of the merchantability or the fitness for a particular purpose.
- b) No person is authorised to make any warranties, representations or promises, expressed or implied, on behalf of GJ Handy (Trading) Ltd, or to modify the terms conditions or limitation of this warranty policy in any way.
- c) Neither GJ Handy (Trading) Ltd nor any company affiliated with GJ Handy (Trading) Ltd shall be liable in any event or manner whatsoever for incidental or consequential damages or injuries, including, but not limited to, loss of crops, loss of profit, out of pocket expenses or profits, rental of substitute equipment or other commercial losses.

General

- a) Most warrantable failures show up within the first few weeks of use. These failures are usually straightforward and warranty assessment is relatively easy.
- b) Failures relating to cutter decks and belts need careful investigation, as the cause may not always be straightforward. Look for damage to blades and pulleys especially when the cutter belt or blade boss have snapped or cracked as this could be due to impact damage.
- c) Customers should always refer to the operator/instruction manual when any disputed problem arises, you will find most areas covered within the manual.

Protecting your machine

Maintenance

Regular maintenance of your Webb machine is essential to ensure it operates, safely, efficiently and therefore reducing the environmental impact.

It is the owner's responsibility to ensure that their Webb machine is maintained at specific intervals. Any approved Webb service dealer can undertake a service, which are specialised in our products and will be aware of your particular machine and any technical updates which will save valuable time & money.

If you are using your machine in dry, dusty or high temperatures, you will need to service the machine more regularly.

Fuel (if applicable)

Due to ongoing efforts by fuel companies to reduce emissions, unleaded petrol will oxidize & deteriorate in storage overtime, leaving residue from detergent components.

Fuel deterioration problems may occur when petrol is stored for over 30 days. If you are planning to store fuel for over 30 days, we recommend you add Handy Parts Sure-Start fuel stabilizer to fresh fuel after purchasing. Sure-Start cannot reconstitute stale fuel.

Storage

When storing your machine for an extended period, we do recommend that you follow the instructions of engine instruction manual.

Always store the fuel in a clean, approved and sealed container. If the container is steel, ensure it is not corroded. If the container is not filled to its recommended capacity, air can accelerate fuel deterioration.

Always store fuel away from direct sunlight, in a dark, cool environment.



INSTRUCTION MANUAL

Your servicing Webb approved dealer will stamp & date the below relevant sections, when the correct service actions have been completed.

PLEASE ENSURE THE SERVICE BOOK IS AVAILABLE FOR THE DEALER, DURING SERVICE WORK.

1st Service

This must be stamped by an approved service dealer to qualify for a free second year warranty.
(Excluding the Webb Electric Handheld machines)

12 Months

A large, light gray rectangular area intended for a service stamp. The word "Date" is printed in a small, dark font at the bottom center of this area.

24 Months

A large, light gray rectangular area intended for a service stamp. The word "Date" is printed in a small, dark font at the bottom center of this area.

36 Months

A large, light gray rectangular area intended for a service stamp. The word "Date" is printed in a small, dark font at the bottom center of this area.



48 Months

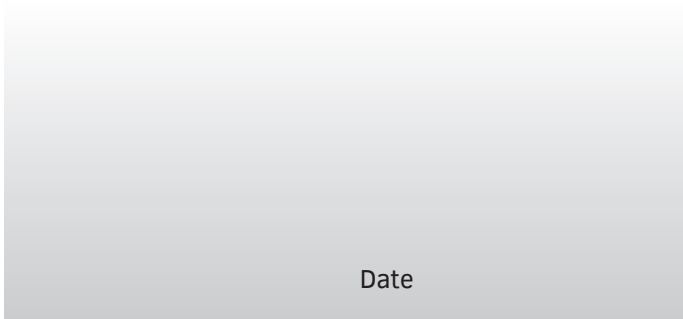

60 Months

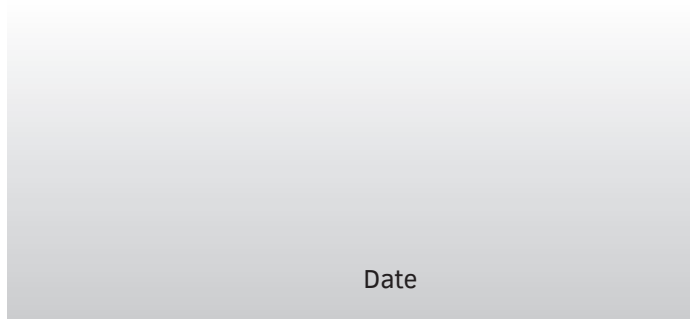

72 Months

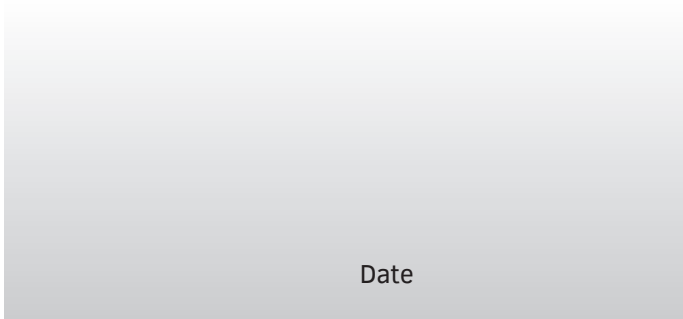

84 Months

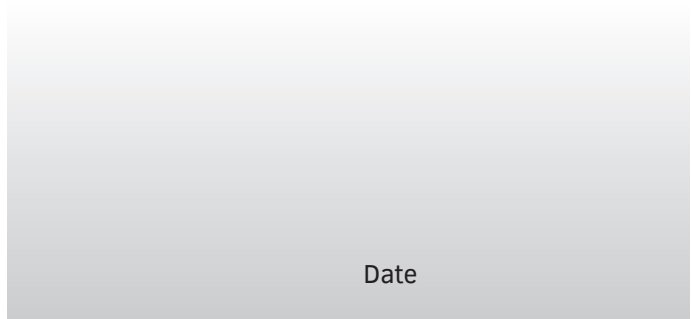

96 Months

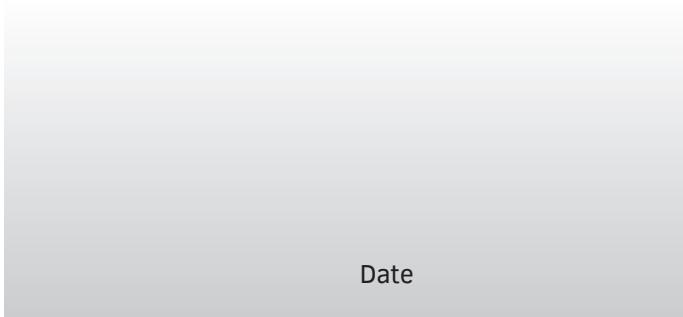

108 Months

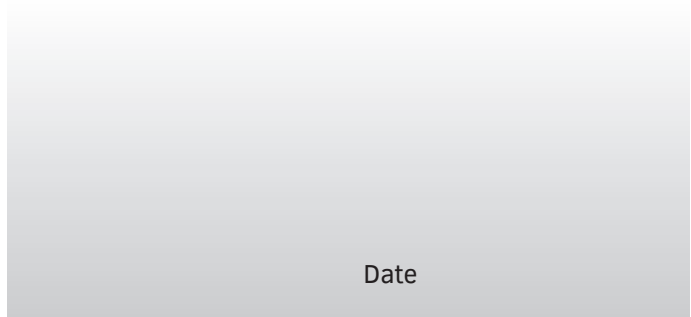

120 Months

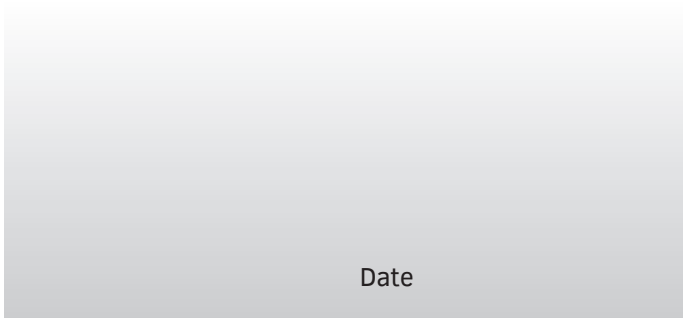

132 Months

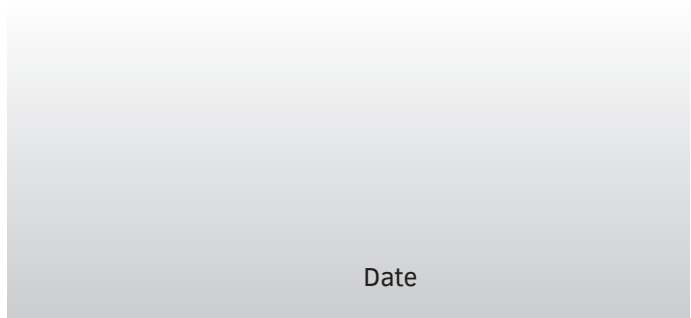



INSTRUCTION MANUAL

If you have registered online, this form is not necessary.
PLEASE POST THIS COPY TO THE ADDRESS OVERLEAF

Product Information (* Compulsory)

*Model No:	
*Product No:	
*Serial No:	
*Date of Purchase:	

Personal Information (* Compulsory)

*Title		*Forename		*Surname	
*House Number		*House Name			
*Address 1					
*Address 2					
*Town					
*County					
*Postcode					
Home Tel				Mobile Tel	
Email					

Age	18 to 25	26 to 35	36 to 45	46 to 60	61 to 80	81 & over
*Usage	Domestic Use		Commercial/Professional/Hire Use			

*Dealer Stamp (if available)

*Selling Retailer (If dealer stamp not available)

*Dealer Name	
*Dealer Address	
*Date of Purchase	

Webb Lawnmowers privacy commitment to machine owners.

The information supplied, helps us to improve the products & services we provide, including information that we believe is relevant to your and/or your machine. We value your trust by giving us this information about yourself and we are committed to protecting your privacy.

Webb, its associated companies, authorised dealers or third parties working on our behalf may wish to contact you regarding **PRODUCT RECALLS** specific to your machine. Please advise how you wish to be contacted for this specific reason only:

Post Telephone Email

From time to time Webb, its associated companies, authorised dealers or third parties working on our behalf may wish to contact you regarding our products, services, offers or just opinions, which may be used for marketing, research or analysis purposes.

If you wish to be contacted by any of the following methods, please tick the relevant boxes:

Post Telephone Email

You may give Webb Lawnmowers notice in writing at any time that you no longer wish to receive direct marketing communications



Service & Support: cs@webbgardenpower.co.uk

**Webb, Murdock Road, Dorcan
Swindon, Wiltshire SN3 5HY**

