



# INSTRUCTION MANUAL

## **295kgs (650lb) TOWED POLY DUMP CART**

Model No: THTPDC -- Product No: 193845002

ASSEMBLY REQUIRED  
SAVE THESE INSTRUCTIONS  
SPARES & SUPPORT: 01793 333212

Please read & understand this manual, paying particular attention to the safety instructions, before use.

The manufacturer reserves the right to change the product specification and livery according to continued product improvements.

Images used, may differ slightly from the product.



# **CONTENTS**

**SPECIFICATIONS**

**IMPORTANT INFORMATION**

**GENERAL SAFETY INSTRUCTIONS**

**ASSEMBLY**

**OPERATING INSTRUCTION**

**MAINTENANCE & STORAGE**

**PARTS DIAGRAM & LIST**

**NOTES**

**USER WARRANTY**

## **ASSEMBLY IS REQUIRED – TWO PERSON**

This product requires assembly before use. See the “Assembly” section for instructions. Because of the weight and size of the Trailer, it is recommended that a **minimum of TWO** adults be present to assist with the assembly.

**If you require any assistance with regards to the contents or operation of your machine, please contact us:**

**TEL: 01793 333212**

**(MON – FRI 8.00AM TO 5.30PM EXCL. BANK HOLIDAYS)**

**EMAIL: [customerservice@handydistribution.co.uk](mailto:customerservice@handydistribution.co.uk)**

# SPECIFICATIONS

The manufacturer reserves the right to change the product specification and livery according to continued product improvements.

Model	THTPDC
Product Number	193845001
Load Capacity	650lb (295kg)
Bed Dimensions (mm)	(L)1025 x (W)765 x (H)275
Overall Dimensions (mm)	(L)1550 x (W)870 x (H)690
Tyre Size	407mm (16")
Tyre Type	Pneumatic (Not for Highways)
Tyre PSI (Recommended/Maximum)	20 PSI/25 PSI (Do not exceed)
Weight	25kg

# IMPORTANT INFORMATION

## INTENDED USE

The product is intended for transporting material for domestic gardens. This product is not intended for commercial use. Generally acknowledged accident prevention regulations and enclosed safety instructions must be observed.

Only perform work described in these instructions for use, any other use is incorrect. The manufacturer will not assume responsibility for damage resulting from such use.

## SAFETY SYMBOLS



Safety alert symbol. Used to alert you to potential personal injury hazards. Obey all safety messages that follow this symbol to avoid possible injury.



### DANGER

Indicates an imminently hazardous situation which, if not avoided, will result in serious injury.



### WARNING

Indicates a potentially hazardous situation which, if not avoided, could result in serious injury



### CAUTION

Indicates a potentially hazardous situation which, if not avoided, may result in minor or moderate injury.

## CAUTION

Used without the safety alert symbol indicates a potentially hazardous situation which, if not avoided, may result in property damage.

# GENERAL SAFETY INSTRUCTIONS

Read and understand the owner's manual and labels affixed to the product. Learn its application and limitations as well as the specific potential hazards. Retain these instructions for future reference. The operator is responsible for following the warnings & instructions in this manual and on the product.



## STAY ALERT

Do not operate the machine while under the influence of drugs, alcohol, or any medication that could affect your ability to use it properly. Do not use this machine when you are tired or distracted from the job at hand. Be aware of what you are doing at all times. Use common sense.

## AVOID DANGEROUS CONDITIONS

Make sure there is adequate surrounding workspace. Cluttered areas invite injuries.

Keep your work area clean with sufficient light. Keep the area around the machine clear of obstructions, grease, oil, rubbish & other debris which could cause persons to fall onto moving parts.

## INSPECT YOUR MACHINE

Check all bolts, nuts & screws for tightness before each use, especially those securing guards & drive mechanisms. Vibration during use, may cause these to loosen.

Replace damaged, missing or failed parts before using.

Warning labels carry important information. Replace any missing or damaged warning labels.

## CRUSH AND CUT HAZARDS

Always keep your hands and feet clear from moving parts while operating the equipment.

Always keep the work area clean and clear when operating.

## CONDITIONS

We recommend the machine is not used during winds. This may affect the spreading pattern.

## DRESS PROPERLY

Do not wear loose clothing, gloves, scarfs, neckties or jewellery (rings, wrist watches, bracelets etc), which can be caught in moving parts.

## DO NOT OVERREACH

Keep proper footing and balance at all times when using the machine. Never stand on the machine.

Serious injury could occur if the machine is tipped or if the moving parts are unintentionally contacted.

Do not store anything above or near the machine, where anyone might stand on the machine to reach them.

## AVOID INJURY FROM UNEXPECTED ACCIDENT

Keep hands & feet out of the way of all moving parts. Do not place any part of your body or any tool e.g. in moving parts of the machine during operation.

## DO NOT FORCE TOOL

Always work within the rated capacity. Do not operate for a purpose for which it was not intended.

## MAINTAIN YOUR MACHINE WITH CARE

Clean the machine immediately after use. Keep the machine clean to ensure it operates to its full & safest performance. When maintaining this machine, only the manufacturer's original replacement parts should be used. The use of non-original manufacturer parts may invalidate your warranty.

## PROTECT THE ENVIRONMENT

Take left over materials to an authorised collection point or follow the stipulations in the country where the machine is used. Do not discharge into drains, soil or water.

## STORE IDLE EQUIPMENT

When not in use, the machine should be stored in a dry location. Keep the machine away from children and others not qualified to use it.

# ASSEMBLY

Remove the machine and contents from the carton. Be sure the carton is empty before discarding.

If you require any assistance with regards to the contents of the lawnmower contact us:

Tel: 01793 333212 - Mon – Fri 8.00am – 5.30pm (excl. Bank Holidays)

Email: [customerservice@webblawnmowers.co.uk](mailto:customerservice@webblawnmowers.co.uk)

## STEP 1

- Insert the latch lock between the latch mount brackets and connect them using an M6x20 hex bolt and a M6 lock nut. Tighten so that the latch lock can still pivot. Attach the extension spring to the latch lock and the latch mount bracket as shown in figure 1.
- Insert the Ø13x28 clevis pin through the holes in the latch mount brackets and secure with an Ø3 R-pin.

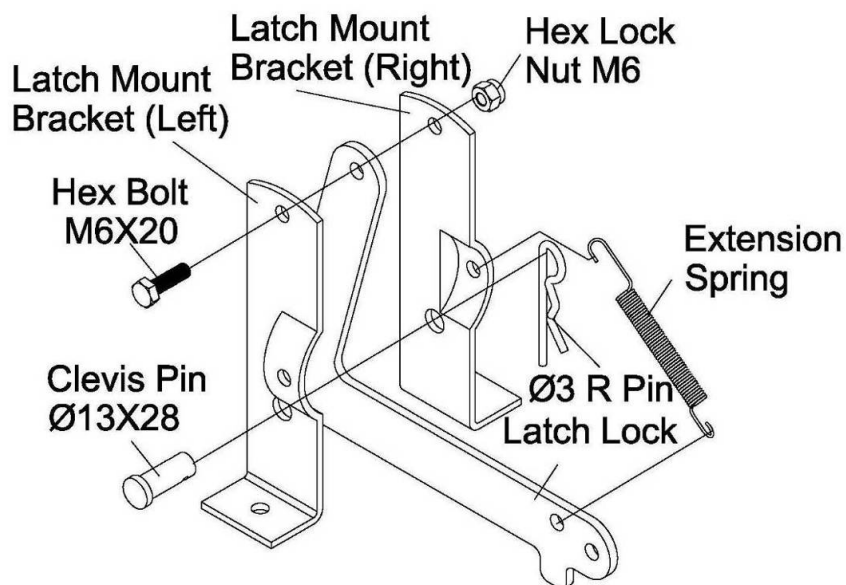

## STEP 2

- Attach the latch lock assembly to draw bar B using two M6x16 hex bolts and M6 lock nuts & tighten securely.

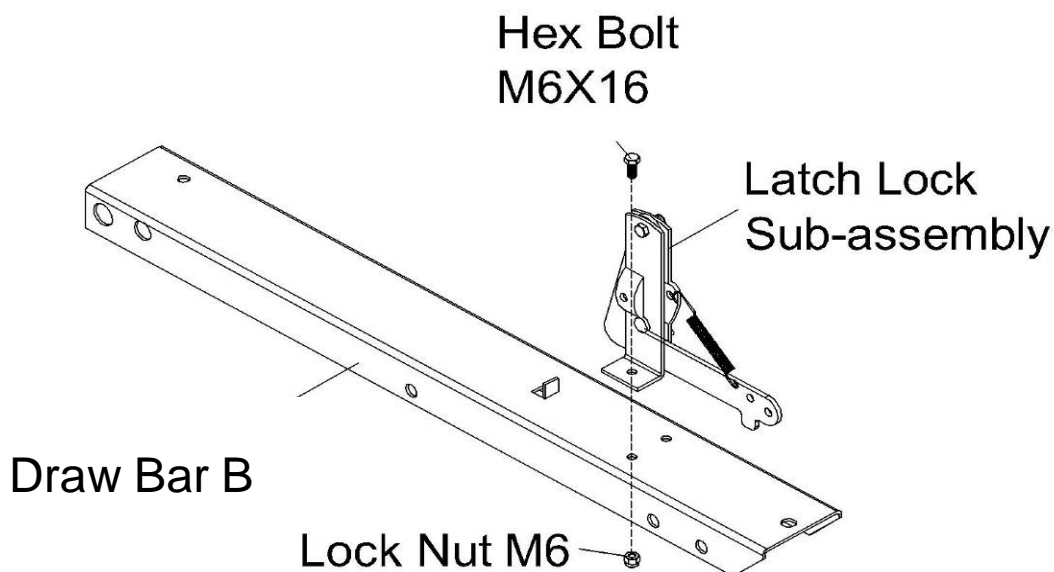

### STEP 3

- Lay draw bar B (open side facing up) onto the Wheel Support. Insert the axle through the wheel support and draw bar B.

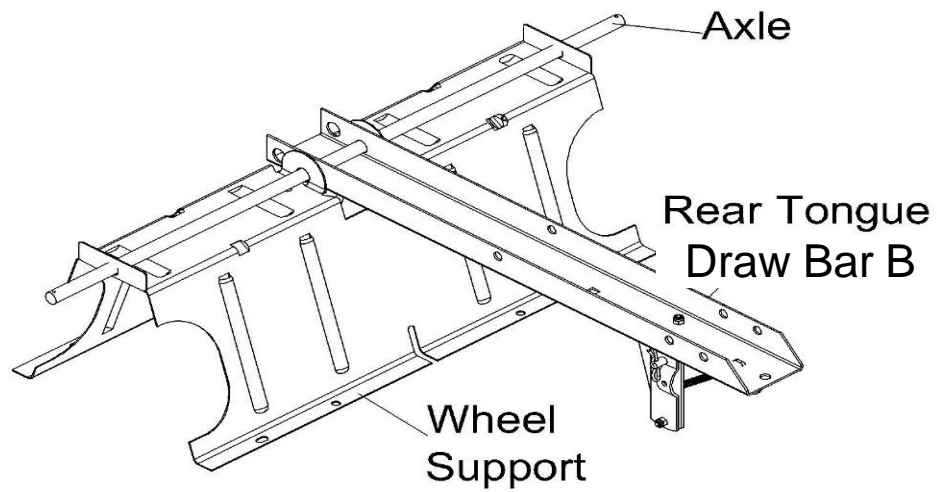

### STEP 4

- Connect the hitch bracket to draw bar A, using two M8x20 hex bolts and M8 lock nuts. Tighten.
- Attach the leg stand bracket to draw bar A, using a M8x20 hex bolt & M8 lock nut. Tighten.

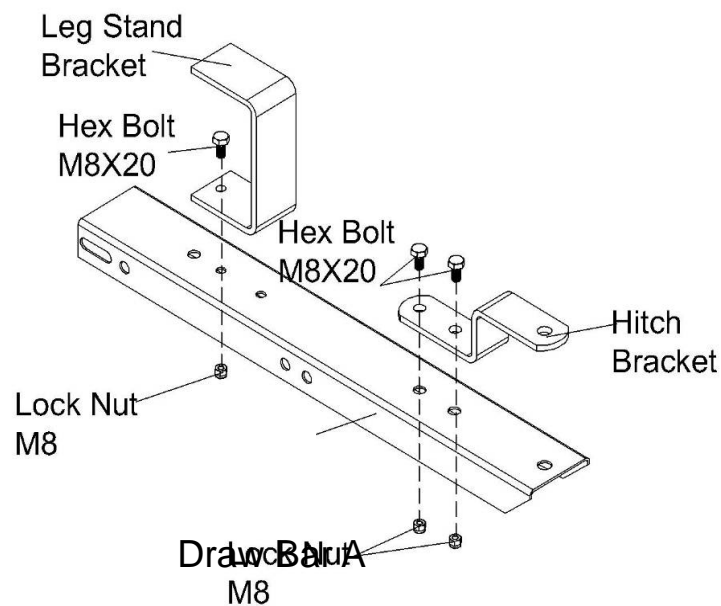

#### STEP 5

- Place draw bar A, inside draw bar B as shown below. Fasten the draw bar sections together using an M10x95 hex bolt and a M10 lock nut. Tighten, leaving the nut just loose enough that the sections of the draw bar can pivot freely.
- Insert clevis pin  $\varnothing 13 \times 98$  through both parts of the draw bar and secure with an R Pin  $\varnothing 3$ .

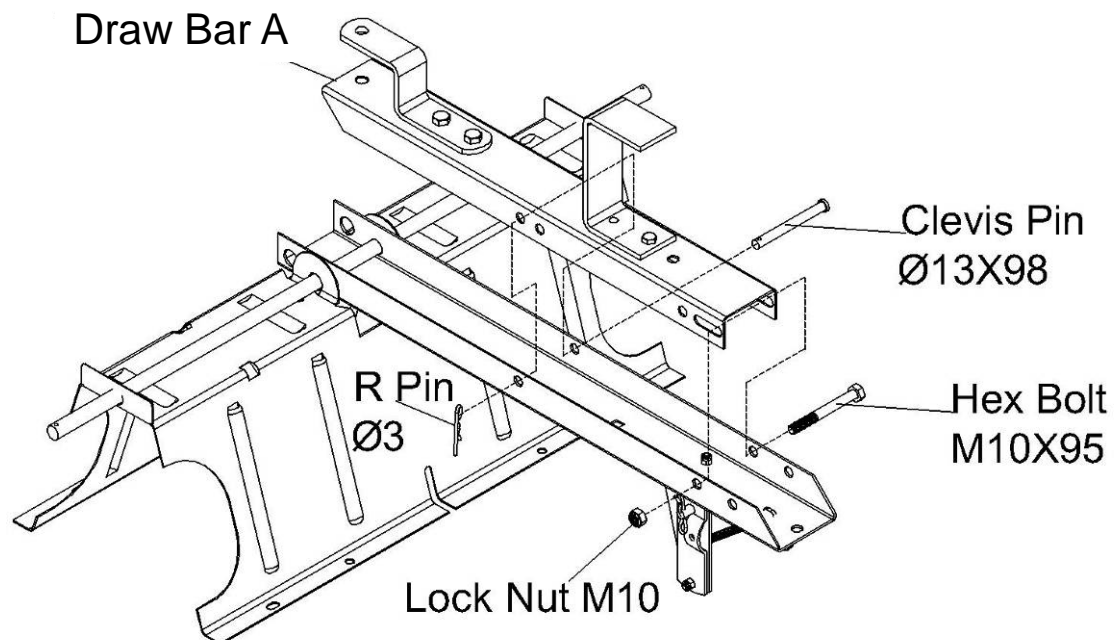

#### STEP 6

- Place Flat Washer  $\varnothing 16$  onto the Axle, followed by the wheel, ensuring the inflation valve is facing away from the assembly. Add a second Flat Washer  $\varnothing 16$  before inserting Cotter Pin  $\varnothing 3 \times 25$  through the axle.
- Repeat the same actions on the opposite side.

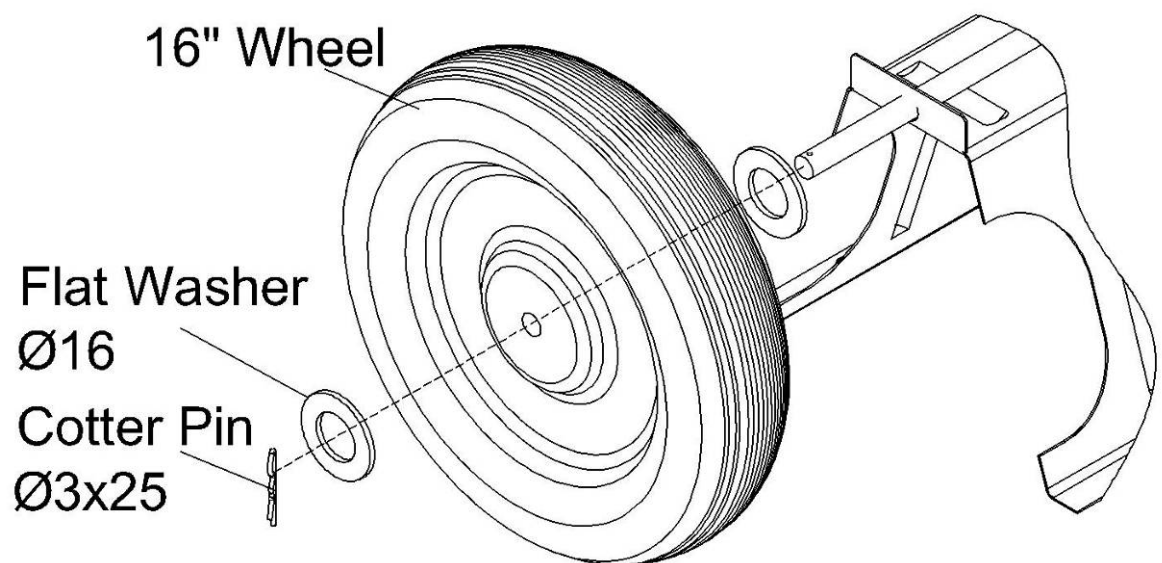



#### STEP 7

- Turn the wheel support over to rest on the wheels. Place the Latch Stand Bracket onto the draw bar, sliding it underneath the Latch Lock. Place the Latch Stand Plate on top of the latch stand bracket. The tabs at the ends of the channels must face the rear.

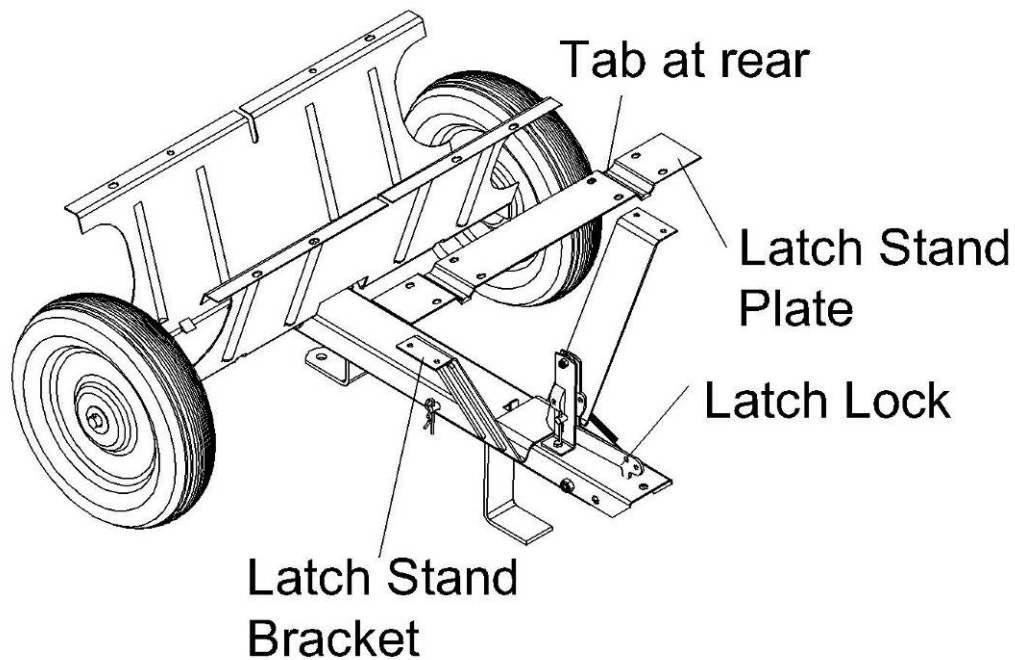

#### STEP 8

- Place the poly tray down onto the Wheel Support & the Latch Stand Plate. Fasten the tray to the wheel support using eight M8x16 flat head bolts and M8 lock nuts. Fasten the tray to the Latch Stand Plate & Latch Stand Bracket using four M6x16 Flat head bolts and M6 lock nuts. Ensure finger tight only.

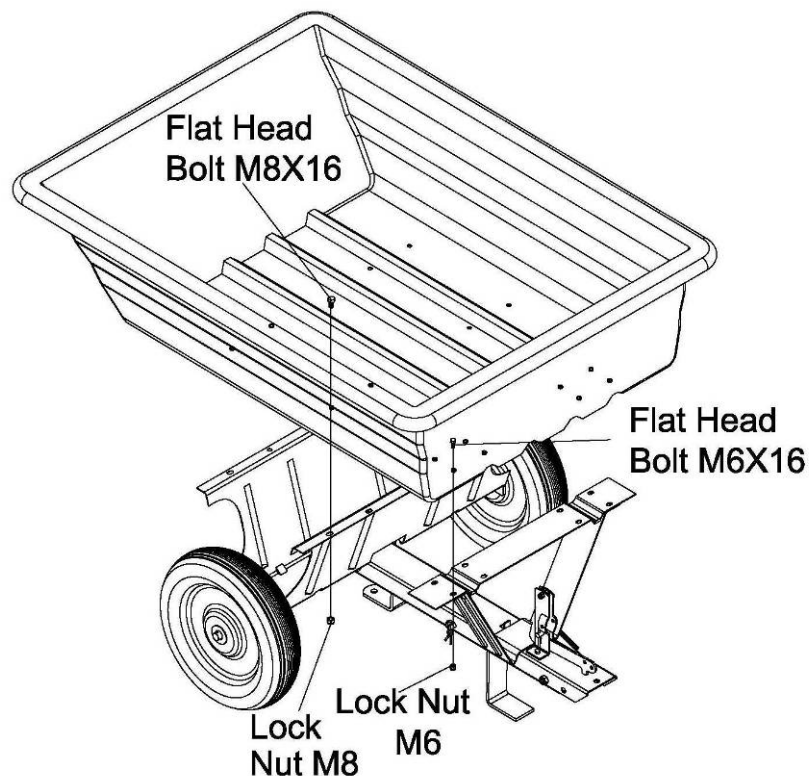

### STEP 9

- Insert four flat head bolts M6x16 down through the tray and the inner holes in the Latch Stand Plate. Secure the bolts with four Ø6 big flat washers and M6 lock nuts. Do not fully tighten.

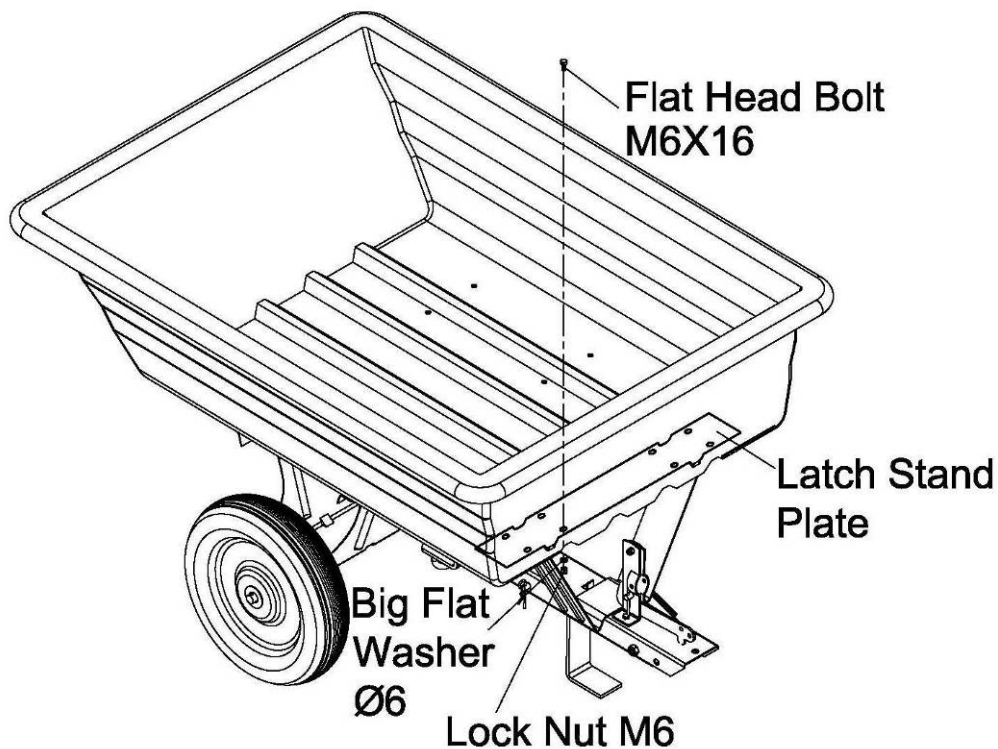

### STEP 10

- Slide the handle into the channels in the Latch Stand Plate. Push the handle in all the way against the front of the tray depressing buttons in the bottom of the handle.
- Place an Ø6 lock washer and a Ø6 flat washer onto each of the two ST6.3x13 flange screws. Insert the screws into the small holes at each end of the handle.



### STEP 11

- Rotate the Draw Bar A from underneath Draw Bar B, to the below extended Draw Bar image and secure with Clevis Pin's  $\varnothing 13 \times 28$  &  $\varnothing 13 \times 98$  and Hex Bolt M10x20.

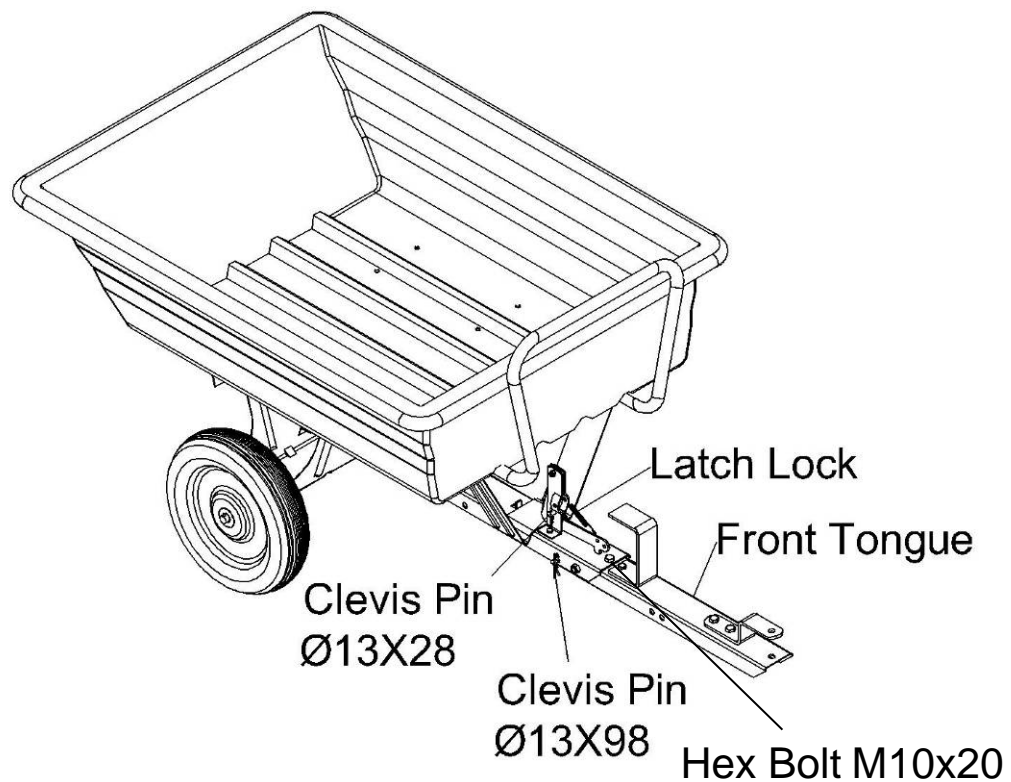

### STEP 12

Insert the hitch pin through the draw bar and hitch bracket and secure it with the  $\varnothing 3$  R Pin.

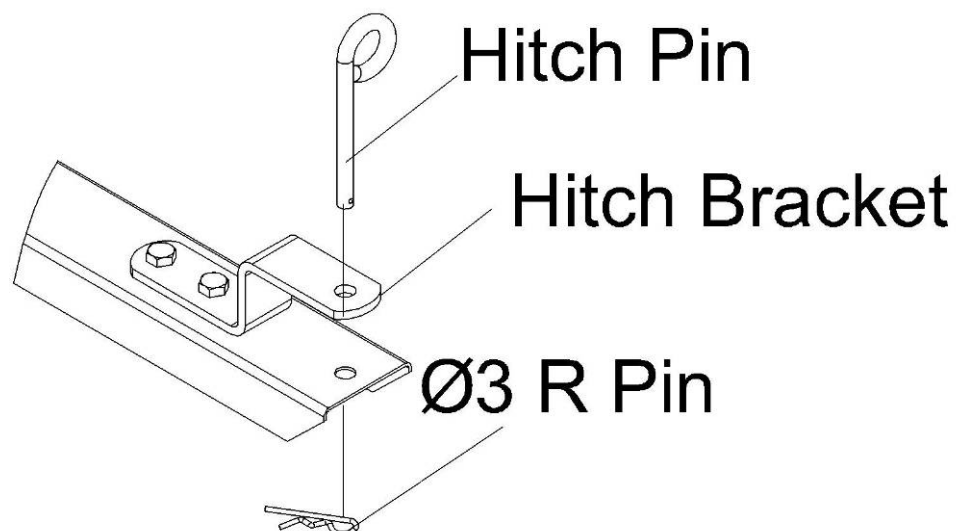

# OPERATING INSTRUCTIONS



## WARNING

Before using the Trailer, review the below instructions & safety information within the manual. Failure to follow these instructions may result in property damage or injury to the operator or bystanders.

1. **DO NOT** at any time carry passengers.
2. **DO NOT** exceed the rated capacity of 650lb (295kg).
3. **ALWAYS** secure and lock the Trailer to the vehicle hitch before operating.
4. **ONLY** use approved vehicles when towing the Trailer (Lawn/Garden Tractors and ATVs)
5. **NEVER** tow the Trailer with the box raised.
6. **DO NOT** over fill the Trailer. This could cause the Trailer and towing vehicle to lose traction and skid out of control.
7. **ONLY** fill the Trailer to a manageable dumping load. Extremely heavy loads will be difficult to operate the tipping mechanism.
8. **ONLY** use the Trailer for its intended purpose.
9. **ALWAYS** make sure that the combined weight of the tow vehicle and the operator is greater than the load of the Trailer. If the Trailer is heavier it may be difficult to control.
10. **DO NOT** use the Trailer on public roads.
11. **NEVER** exceed 10mph when towing the Trailer.
12. **DO NOT** make sharp turns as this may cause the Lawn/Garden Tractor or ATV tyres to rub against the Towed Trailer.
13. **ALWAYS** slow down before turning.
14. **ALWAYS** use caution when reversing the Trailer. To avoid the Trailer “jack-knifing” always reverse in a straight line.



## CAUTION

To avoid possible injury, be sure that no bystander is near the cart before releasing the latch.

## TOW CART

- To convert the cart for towing, remove the plastic cap from the draw bar. Remove the Ø13x98 clevis pin and R Pin which secure draw bar A in the storage position underneath draw bar B. Pivot draw bar A outward and secure it in the towing position using the same clevis pin and hairpin cotter. Push the handle in all the way against the front of the tray depressing the buttons in the bottom of the handle.
- Always test to make sure your tractor has adequate towing and braking capabilities whenever hauling a substantial amount of weight in your cart. Use extra caution when operating on slopes.



**Do Not Exceed the 650 LB. (295kg) weight capacity of the cart.**



## CAUTION

Vehicle braking & stability may be affected by the cart. Be aware of changing conditions on slopes

- Distribute the weight of the load evenly in the cart to improve handling and traction.
- To dump material from the cart, remove the clevis pin Ø13x28 from the latch on the draw bar and release the latch. The cart bed will then tilt backwards to empty its contents. After emptying, pull the front of the bed down toward the cart draw bar until the latch snaps into place. Reinstall the clevis pin in the latch to prevent accidental release.
- The maximum towing speed for this cart is 10 m.p.h.

## PUSH CART

- **Important:** Leave the latch lock clevis pin in place at all times while using the cart as a push cart.
- To convert the cart for push operation, remove the Ø13x98 long clevis pin and R Pin Ø3 which secure the draw bar in the towing position. Pivot draw bar A into the storage position underneath draw bar B and secure it using the Ø13x98 long clevis pin and R Pin Ø3.
- Distribute the weight of the load evenly in the cart to improve handling and help prevent accidental tipping.
- Do not load more weight into the push cart than you can physically handle and control comfortably.
- To dump material from the push cart, lift up on the handle and tilt the cart backwards. Be sure that the latch mechanism on the draw bar is locked and secured with the clevis pin to prevent accidental release of the latch.

## MAINTENANCE & STORAGE



**WARNING - Improper maintenance & storage of the Trailer may void your warranty.**

### MAINTENANCE

- After each use clean any material out of the Trailer.
- Rinse/dry inside and outside of the Trailer after each use.
- Before operating make sure the tyres have the recommended tyre pressure of 20 PSI (Do not exceed 25PSI). We recommend the use of **FOOT or HAND** inflation devices only.
- Grease the axle and the wheel bearing area regularly with Multi-purpose grease.
- Periodically check all nuts & bolts for tightness.
- Annually clean and lightly lubricate parts including the latch, pivot bolt and the area of the axle where the draw bar pivots, with Maintenance spray.
- Use a glossy enamel spray paint to touch up scratched or worn painted metal surfaces.
- Never exceed the load capacity rating of 650lb (295kg) this will damage the Trailer.

### **IMPORTANT:**

Only use the manufacturer's original replacement parts. Non-original replacement parts will invalidate your warranty and may result in a safety hazard or poor operation. Parts are available by calling 01793 333212.

### STORAGE

- Never allow material to remain in the Trailer for extended periods of time.
- For years of trouble free service, make sure the Trailer is clean and dry before storing.
- Store indoors or in a protected area during severe weather and winter months.
- When storing outside always keep the draw bar a little higher than the back of the Trailer to allow any moisture to run out of the back and not to accumulate in the carry area.

# PARTS DIAGRAM – THTPDC (193845002)

**NOTE:** Parts Lists & Diagrams are supplied for information purposes only, not all parts are stocked individually & we recommend you contact our Spares Team on 01793 333212 for expert advice.

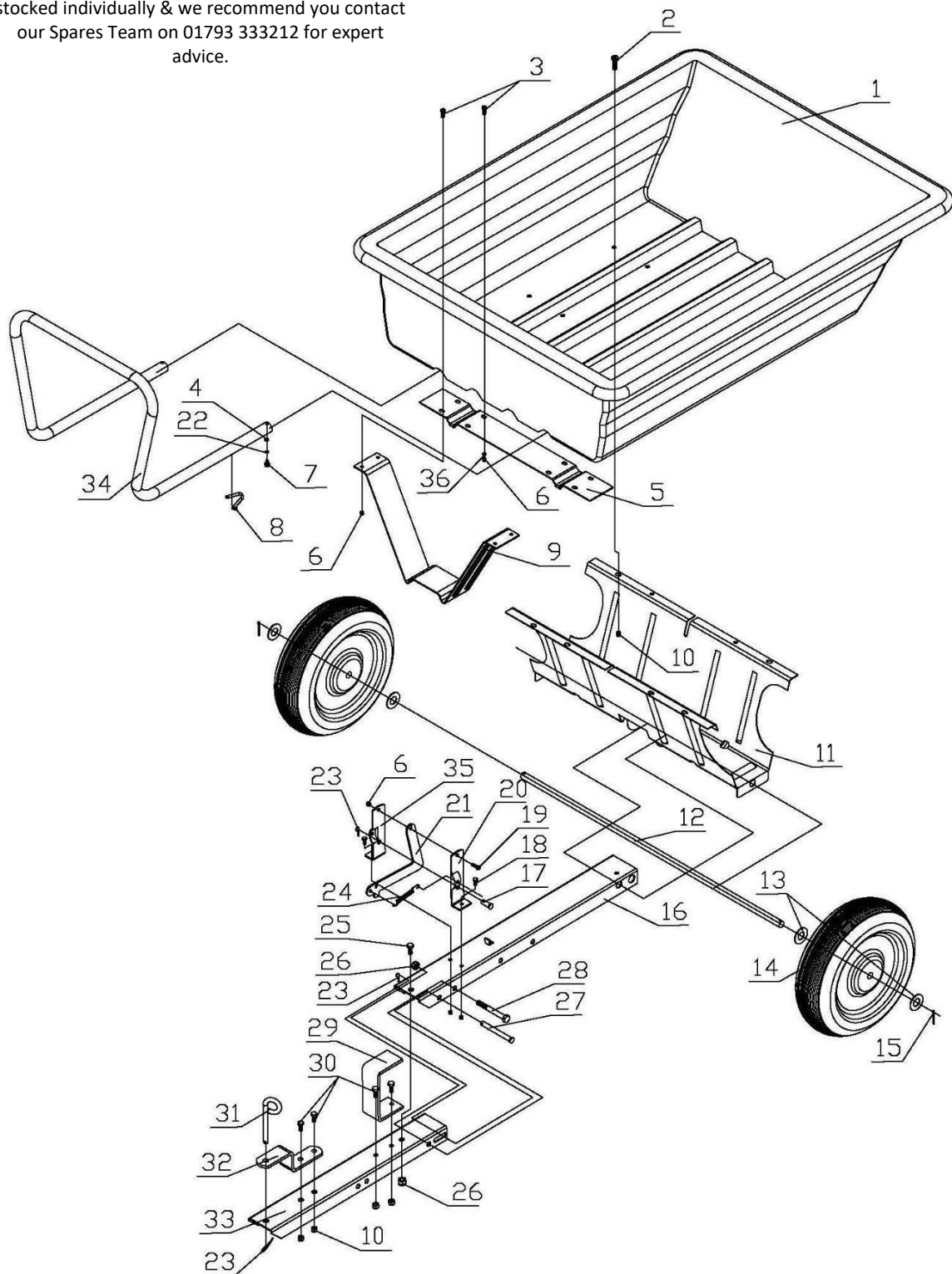

## PARTS LIST – THTPDC (193845002)

Item No	Part No	Description	Qty
1	TH180-1	Poly Tray	1
2	TH180-2	Flat Head Bolt M8x16	8
3	TH180-3	Flat Head Bolt M6x16	8
4	TH180-4	Flat Washer Ø6	2
5	TH180-5GM	Latch Stand Plate	1
6	TH180-6	Lock Nut M6	11
7	TH180-7	Flange Screw ST6.3x13	2
8	TH180-8	Pin	2
9	TH180-9GM	Latch Stand Bracket	1
10	TH180-10	Lock Nut M8	12
11	TH180-11GM	Wheel Support	1
12	TH180-12	Axle	1
13	TH180-13	Flat Washer Ø16	4
14	TH180-14	Wheel	2
15	TH180-15	Cotter Pin Ø3x25	2
16	TH180-16GM	Draw Bar B	1
17	TH180-17	Clevis Pin Ø13x28	1
18	TH180-18	Hex Bolt M6x16	2
19	TH180-19	Hex Bolt M6x20	1
20	TH180-20GM	Latch Mount Bracket (Right)	1
21	TH180-21GM	Latch Lock	1
22	TH180-22	Lock Washer Ø6	2
23	TH180-23	R Pin Ø3	3
24	TH180-24	Extension Spring	1
25	TH180-25	Hex Bolt M10x20	1
26	TH180-26	Lock Nut M10	2
27	TH180-27	Clevis Pin Ø13x98	1
28	TH180-28	Hex Bolt M10x95	1
29	TH180-29GM	Leg Stand Bracket	1
30	TH180-30	Hex Bolt M8x20	4
31	TH180-31	Hitch Pin	1
32	TH180-32GM	Hitch Bracket	1
33	TH180-33GM	Draw Bar A	1
34	TH180-34GM	Handle	1
35	TH180-35GM	Latch Mount Bracket (Left)	1
36	TH180-36	Big Flat Washer Ø6	4

# GJ HANDY & CO LTD USER WARRANTY POLICY

## **Users Statement of Warranty**

Each new machine is warranted against defective material or assembly of material under normal usage. The warranty applies to the original purchaser and covers faulty parts and the labour involved in replacing and repairing those parts, which are of original manufacture.

## **Period of Warranty**

### **All Webb & Webb Pro machines plus Sanli engines.**

- a) 2 years from the original date of sale to the first domestic user.
- b) 90 days from the original date of sale to the professional/commercial user.
- c) 90 days from the original date of sale when used for hire.
- d) A reduced warranty period of 90 days applies to those items which are subject to normal wear and tear (e.g. but not limited to wheels, tyres, cutter bars, cylinders, bottom blades, belts, cables, grass bags, spark plugs).
- e) Engines as per the manufacturer's warranty statement which will be supplied with the machine.
- f) 90 days from the original date of purchase for Replacement Spare Parts (unless normal wear & tear component, which are covered for 30 days).
- g) All machines' must be serviced within the first 12 months from the original date of purchase to comply with the warranty, failure to do so will invalidate the 2nd year of the warranty.

### **All Handy, Mowerland and Q-Garden products.**

- a) 1 year from the original date of sale to the first domestic user.
- b) 90 days from the original date of sale to the professional/commercial user.
- c) 90 days from the original date of sale when used for hire.
- d) A reduced warranty period of 90 days applies to those items which are subject to normal wear and tear (e.g. but not limited to wheels, tyres, cutter bars, cylinders, bottom blades, belts, cables, collection bags, spark plugs).
- e) Engines as per the manufacturer's warranty statement which will be supplied with the machine.
- f) 90 days from the original date of purchase for Replacement Spare Parts (unless normal wear & tear component, which are covered for 30 days).

All warranty repairs must be undertaken by an authorised service dealer. These dealers have been accredited by GJ Handy & Co Ltd and agree to only use genuine parts and follow our repair procedures.



# GJ HANDY & CO LTD USER WARRANTY POLICY

## **Not covered by this warranty**

- a) The warranty policy does not cover any depreciation or damages caused by ordinary wear, rusting or corrosion, lack of correct maintenance or operation, misuse, abuse, lack of transportation or accident.
- b) The warranty policy does not cover any costs necessary for the standard periodic maintenance services instructed by the operator's manual, or service parts replacement which would include oil, filters, tyres, belts, brake linings, fuses, blades, seals and other service parts unless it can be proven that the item has evidence of faulty manufacture.
- c) The warranty policy will not cover failure or damage caused as a result of parts or accessories being modified without the written approval of GJ Handy & Co Ltd.
- d) The warranty policy will not cover the unit if non-genuine parts have been fitted and as a result damage has occurred to the unit.
- e) The warranty policy is non-transferable and is only applicable to the original purchaser.

## **Disclaimer**

- a) This warranty is only a remedy for defect of products. GJ Handy & Co Ltd will never warranty in terms of the merchantability or the fitness for a particular purpose.
- b) No person is authorised to make any warranties, representations or promises, expressed or implied, on behalf of GJ Handy & Co Ltd, or to modify the terms conditions or limitation of this warranty policy in any way.
- c) Neither GJ Handy & Co Ltd nor any company affiliated with GJ Handy & Co Ltd shall be liable in any event or manner whatsoever for incidental or consequential damages or injuries, including, but not limited to, loss of crops, loss of profit, out of pocket expenses or profits, rental of substitute equipment or other commercial losses.

## **General**

- a) Most warrantable failures show up within the first few weeks of use. These failures are usually straightforward and warranty assessment is relatively easy.
- b) Failures relating to cutter decks and belts need careful investigation, as the cause may not always be straightforward. Look for damage to blades and pulleys especially when the cutter belt or blade boss have snapped or cracked as this could be due to impact damage.
- c) Customers should always refer to the operator/instruction manual when any disputed problem arises, you will find most areas covered within the manual.

## This image shows a single sheet of white paper with horizontal ruling lines. The lines are evenly spaced and run across the width of the page. There are no margins, text, or other markings on the paper.



For spares or support of your Handy product,  
please contact us:

Tel: 01793 333212

(Mon – Fri 8.00am to 5.30pm excl. Bank Holidays)

Email: [customerservice@handydistribution.co.uk](mailto:customerservice@handydistribution.co.uk)

**To see our range of garden machinery & equipment visit:**

**[www.thehandy.co.uk](http://www.thehandy.co.uk)**

**Making gardening easier & affordable since 1938**

Distributed by Handy Distribution, Murdock Road, Dorcan, Swindon, SN3 5HY