

# COBRA

**MODEL: GTT450**

## **GARDEN TRACTOR TRAILER OWNERS MANUAL**



### **CAUTION:**

Before using this product, please read this manual carefully to understand the proper use of your garden cart. Please keep this manual for future reference.

Product colours may vary.

**PLEASE NOTE: NEVER CARRY PASSENGERS IN THE GARDEN TRACTOR TRAILER**

## **Important Safety Instructions**

---

1. **Read this entire instruction manual carefully before attempting to use or assemble this trailer.**
2. Do not load the trailer with more than 660 lbs. (300 kg).
3. Do not allow children to play in or around the trailer.
4. Always distribute the load evenly over the surface of the trailer bed.
5. Do not load items on top of the side rails. Lower the side rails when loading large or heavy objects.
6. If any part becomes damaged, broken or misplaced, do not use the trailer until a replacement part has been obtained.
7. Do not operate on or roll over objects that could cause damage to the pneumatic tires or tubes.
8. Do not inflate tires to more than 28 psi.
9. Save these instructions for future reference.

## **Care and Maintenance**

---

Check tyre pressure regularly. Inflate if necessary. Do not over inflate.

Check bolts periodically to ensure they are secure. Do not over tighten bolts.

Cover or store indoors when not in use.

## **Preparation**

---

Estimated Assembly Time: Approximately 45 minutes

Tools required for assembly:

- Adjustable Wrench or 7/16 SAE. Socket
- Flat Head Screwdriver
- Pliers

# Parts & Hardware List

Part#	Description	Quantity
1	Bed	1
2	Left undercarriage support	1
3	Right undercarriage support	1
4	Screw M8x20	8
5	Small flat washer M8	14
6	Hex nut M8	14
7	Front leg	1
8	Axle	1
9	Tow bar	1
10	Wheel	2
11	Large flat washer	2
12	Hex nut M16	2
13	Side panel	2
14	Front /back panel	2
15	Left lock handle	2
16	Right lock handle	2
17	Quick release pin	12
18	Control lever	1
19	Spring	1
20	Yoke	1
21	Bolt	1
22	Screw M8x90	2
23	Quick release pin 4mm	1

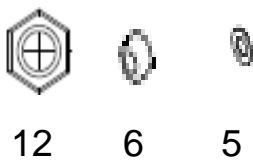
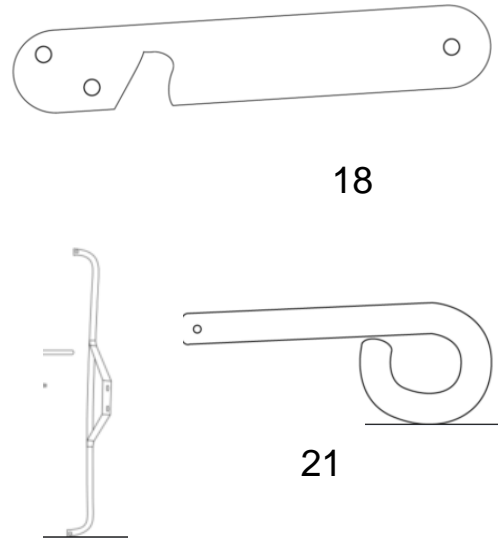
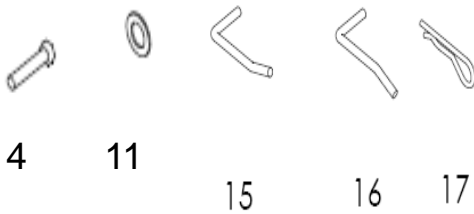
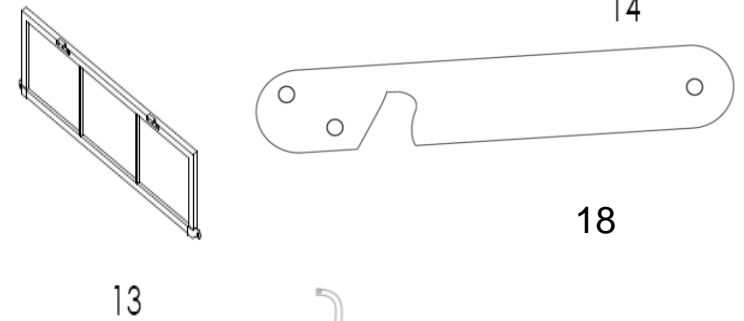
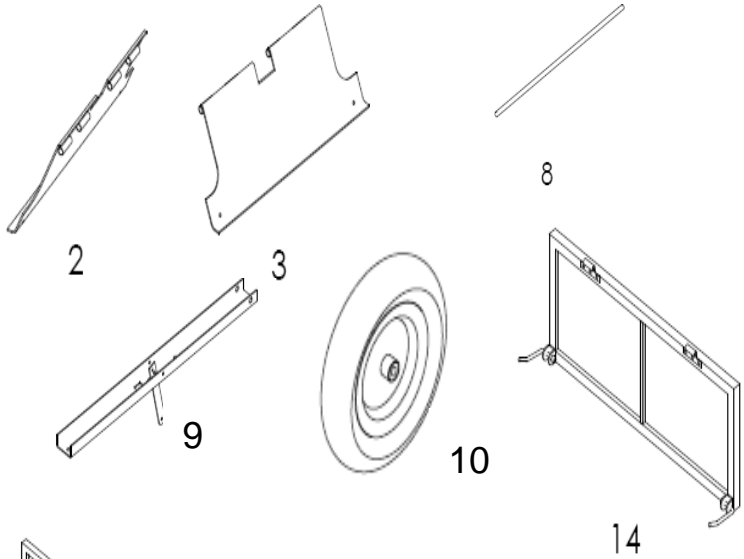
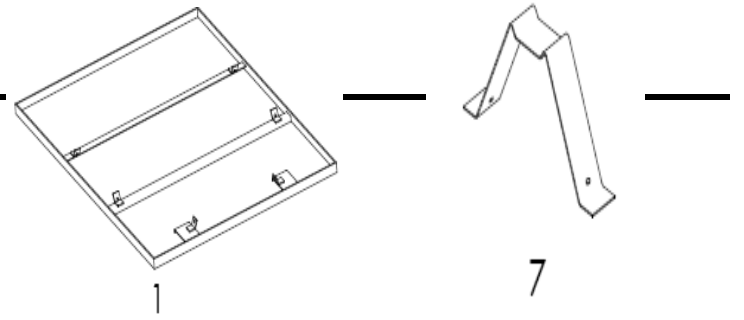

## STEP 1

Turn the trailer bed upside down. If necessary, use the cardboard from the carton to prevent scratching and damage to the finish.

## STEP 2 Undercarriage Support Assembly

Parts and Hardware Required:

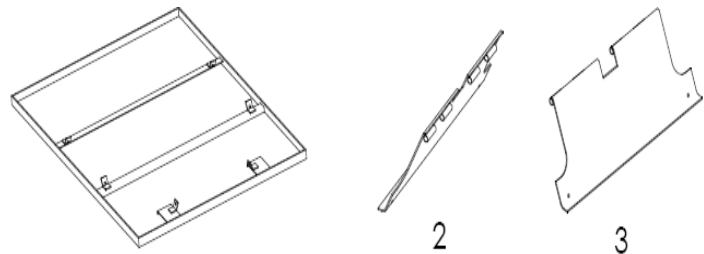

Part#	Description	Quantity
1	Bed	1
2	Left undercarriage support	1
3	Right undercarriage support	1
4	Screw M8x20	4
5	Small flat washer	4
6	Hex nut	6



4

5

6

Attach the Left Undercarriage Support (2) and Right Undercarriage Support (3) to the cart bed (1) with Screw M8x20 (4), Small Flat Washer (5) and Hex Nut (6) (Fig. 1).

**Fig. 1**

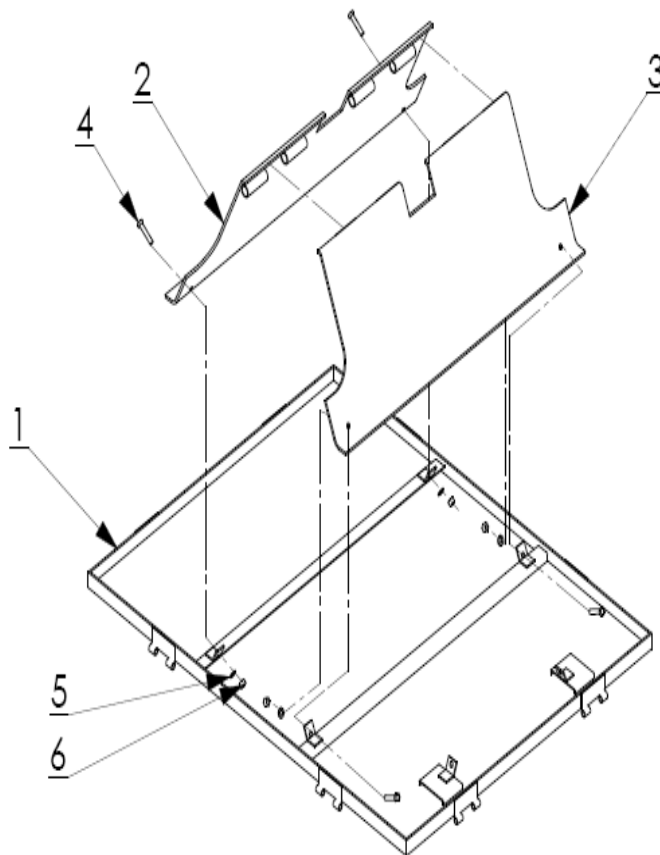

### STEP 3 - Front Leg Assembly

Parts and Hardware Required:

Part#	Description	Quantity
4	Screw M8x20	2
5	Small flat washer	2
6	Hex nut	2
7	Front leg	1

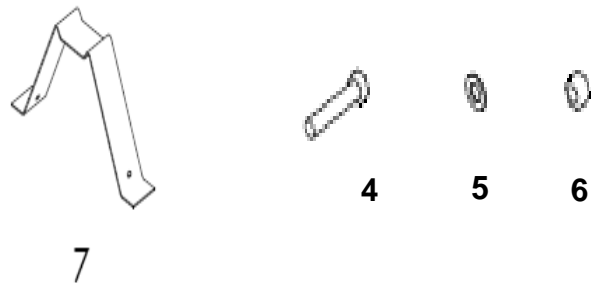

Align the front leg (7) with screw holes on the front of the bed (1) and attach using Screw M8x20 (4), small flat washer (5) and hex nut (6) (Fig. 2).

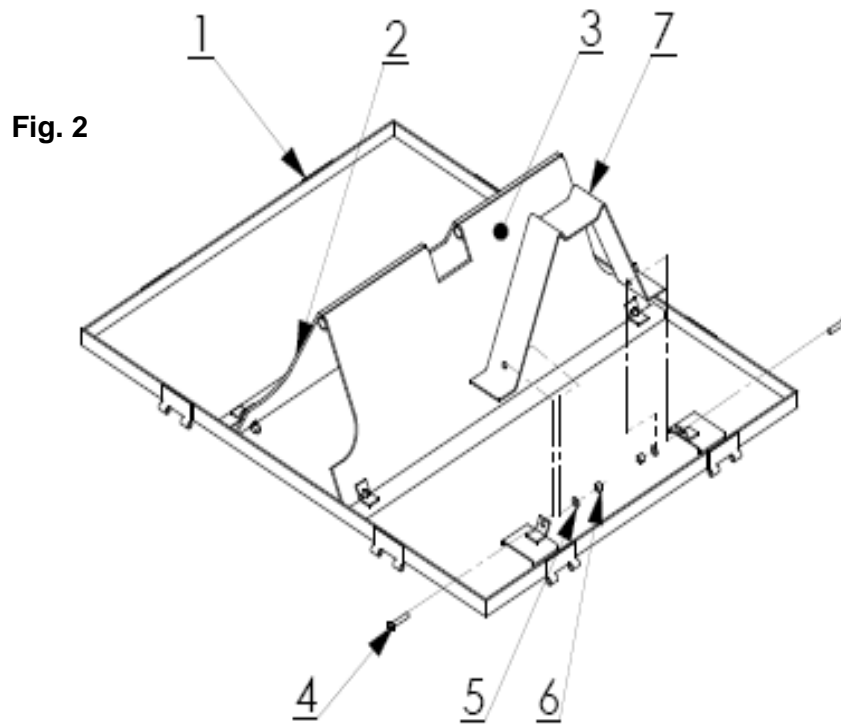

### STEP 4 Tow Bar and Axle Assembly

Parts and Hardware Required:

Part#	Description	Quantity
9	Tow bar	1
8	Axle	1

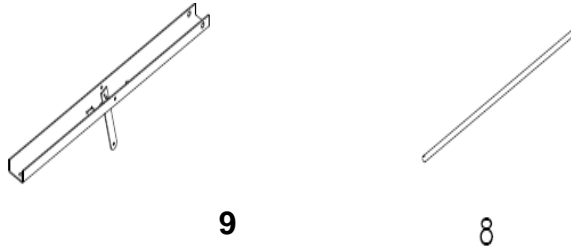

#### Note:

The yoke (20) has been attached to the tow bar (9) with two screws M8x20 (4), small flat washer (5) and hex nut (6). The control lever (18) has been attached to the tow bar using spring (19) and two screws M8x90 (22), flat washer M8 (5) and hex nut M8 (6). Bolt (21) has been attached to the tow bar using a quick release pin 4mm (23). Refer to parts list on page 3 for replacement of control lever (18), spring (19), yoke (20) and/or bolt (21).

Locate the tow bar (9) in the central notch of the undercarriage supports (2, 3) so the dump bed release lever is facing down and the axle, when installed, will pass through the pivot hole in the end of the tow bar. Slide the axle (8) through the undercarriage supports (2, 3) and the pivot hole in tow bar (9) (Fig. 3).

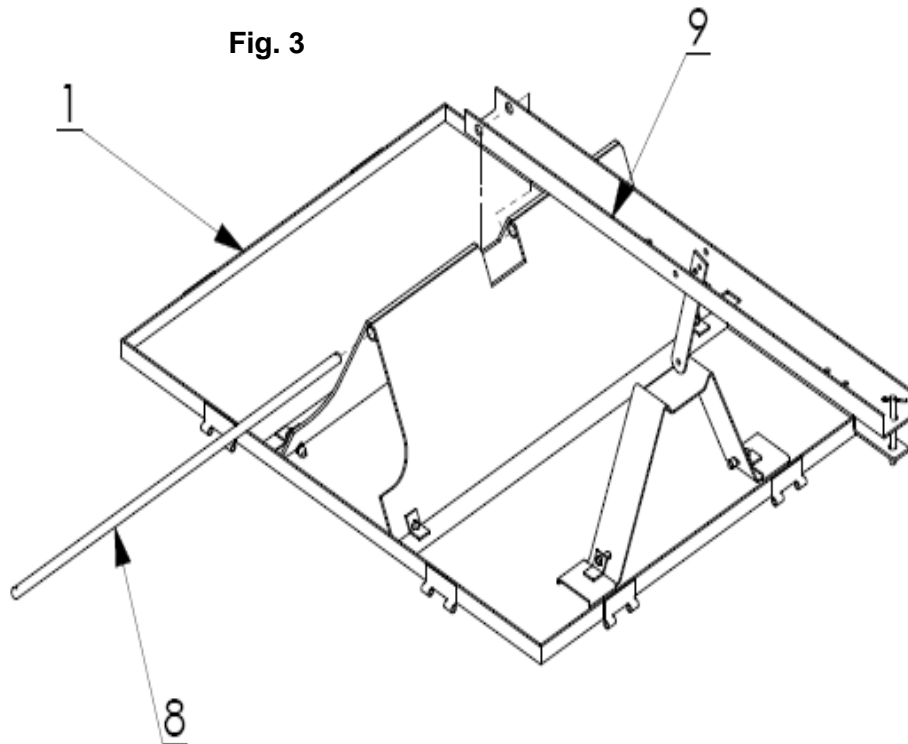

### STEP 5 Wheel Assembly

Parts and Hardware Required:

Part#	Description	Quantity
10	Wheel	2
11	Large flat washer	2
12	Hex nut M16	2

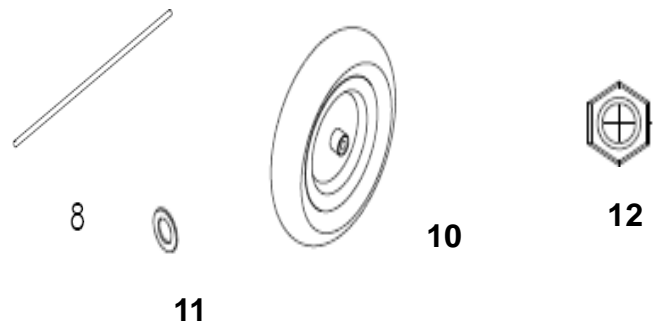

Place a wheel (10) on the end of the axle, followed by a large flat washer (11) and hex nut M16 (12).  
(**Note:** the wheel valve stem should be facing outward.) (Fig. 4)

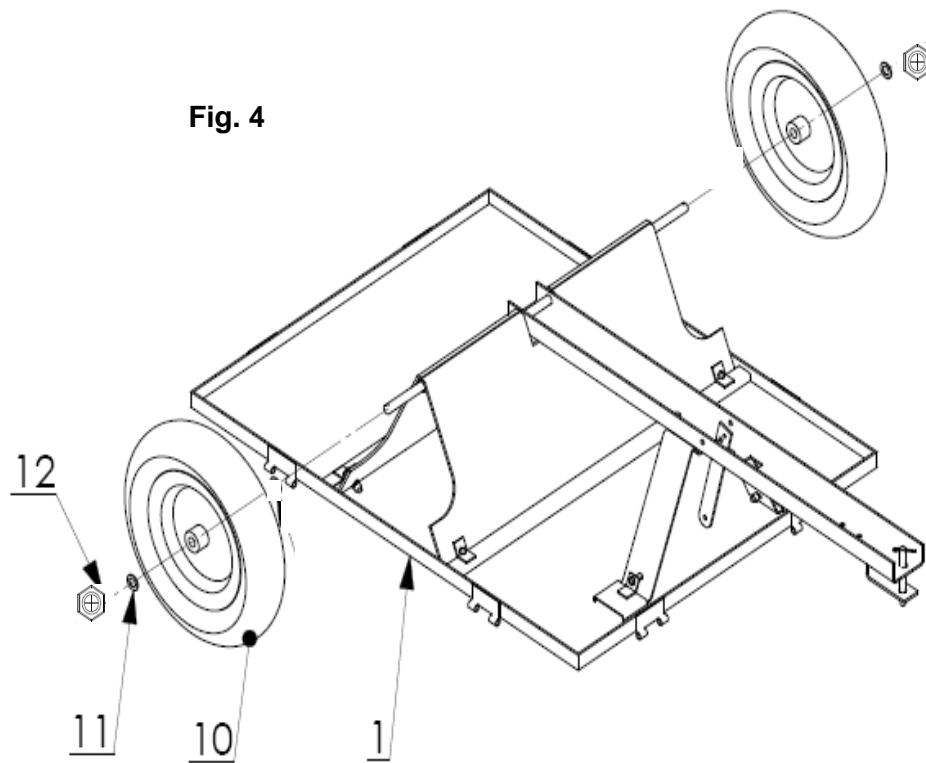

### STEP 6 Panel Assembly

Parts and Hardware Required:

Part#	Description	Quantity
13	Side panel	2
14	Front/back panel	2
15	Left lock handle	2
16	Right lock handle	2
17	Release pin	12

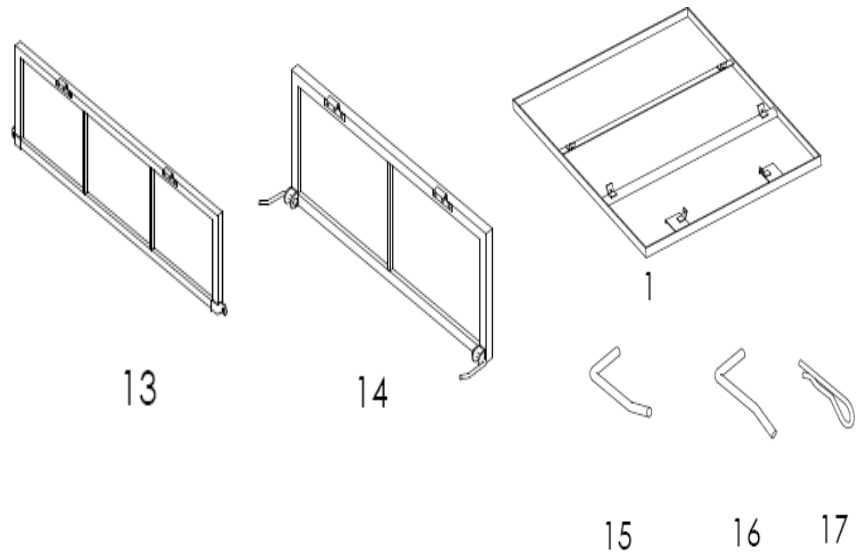

Attach the front panel (14) to the front of bed (1) using release pin (17). Attach the side panels (13) to the bed also with release pin (17). Then connect the side panels (13) to the front and back panels (14) with lock handles already attached (15,16). (Fig. 5).

