

COBRA

S36E 2 in 1 Scarifier and Raker

OPERATOR'S MANUAL



Before use please read & understand this manual, paying particular attention to the safety instructions.

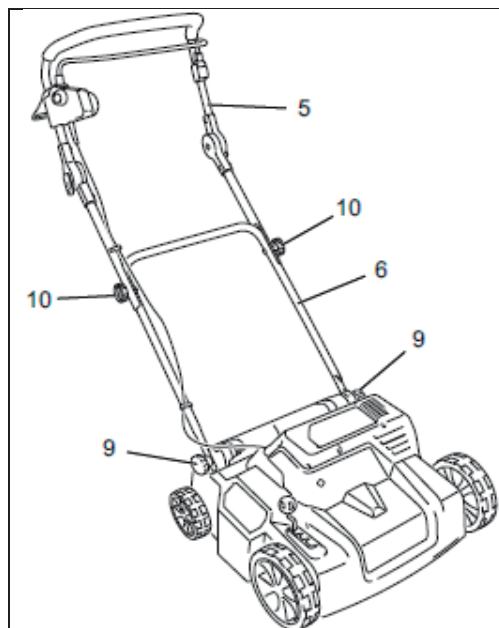

Fig 1

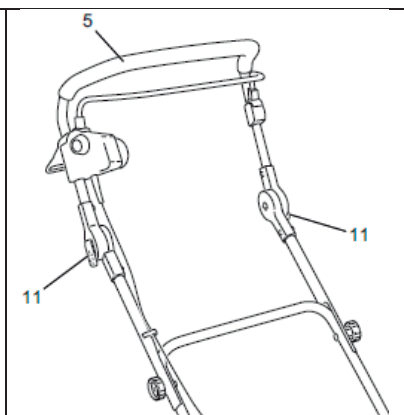

Fig 2

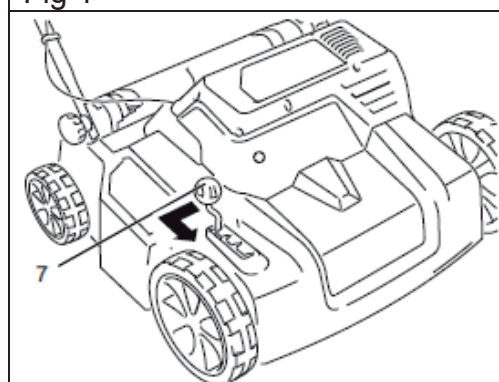

Fig 3

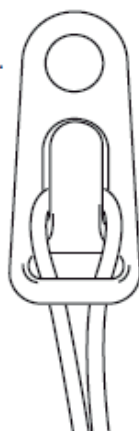
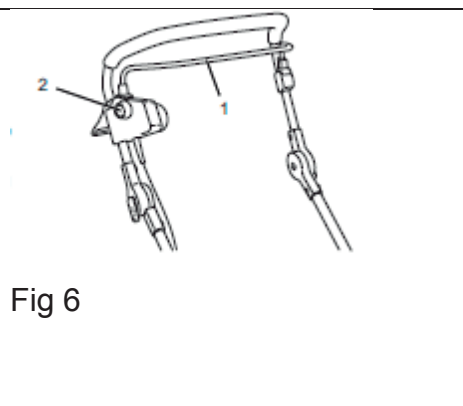
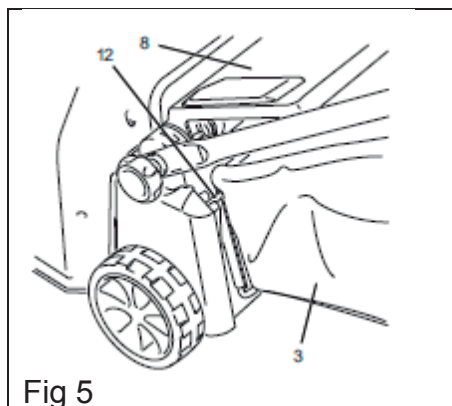

Fig 4



1	APPLICATION	3
2	DESCRIPTION (FIG A)	3
3	PACKAGE CONTENT LIST.....	3
4	SYMBOLS	3
5	GENERAL POWER TOOL SAFETY WARNINGS	4
5.1	<i>Working area</i>	<i>4</i>
5.2	<i>Electrical safety.....</i>	<i>4</i>
5.3	<i>Personal safety</i>	<i>5</i>
5.4	<i>Power tool use and care</i>	<i>5</i>
5.5	<i>Service.....</i>	<i>6</i>
6	SAFETY INFORMATION FOR SCARIFIERS.....	6
7	ASSEMBLY (FIG 1)	6
8	OPERATION.....	6
8.1	<i>Setting the steering height (Fig 2).....</i>	<i>6</i>
8.2	<i>Setting the working depth (scarifying/venting) (Fig 3)</i>	<i>7</i>
8.2.1	<i>5 mm to 0 mm (venting)</i>	<i>7</i>
8.2.2	<i>-5 mm to -10 mm (venting/scarifying)</i>	<i>7</i>
8.3	<i>Attaching the extension cable (Fig 4)</i>	<i>7</i>
8.4	<i>Attaching the collecting sack (Fig 5)</i>	<i>7</i>
9	SCARIFYING / AERATING (FIG 6)	7
9.1	<i>Important notes.....</i>	<i>7</i>
10	CLEANING AND MAINTENANCE	7
10.1	<i>Cleaning and maintenance at a glance.....</i>	<i>8</i>
10.2	<i>Cleaning the product</i>	<i>8</i>
11	TROUBLESHOOTING	8
12	TECHNICAL DATA	9
13	NOISE	9
14	SERVICE DEPARTMENT	9
15	STORAGE	9

16 **WARRANTY 9**

17 **ENVIRONMENT 10**

18 **DECLARATION OF CONFORMITY 11**

ELECTRIC LAWN SCARIFIER

S36E

1 APPLICATION

The product is intended to scarify (remove moss and uncontrolled growth of shallow roots) from grass areas in private and hobby gardens.

The product may not be used for commercial purposes.

The product must be operated according to the specifications in the instructions for use.

Any improper use or any activities on the product not described in these instructions for use are considered inadmissible misuse and outside of the manufacturer's legal liability.



WARNING! For your own safety, read this manual and the general safety instructions carefully before using the appliance. Your power tool should only be given to other users together with these instructions.

2 DESCRIPTION (FIG A)

- | | |
|--------------------|------------------------------|
| 1. Operating lever | 5. Steering bar |
| 2. Safety lock | 6. Lower steering bar |
| 3. Grass collector | 7. Lever (for working depth) |
| 4. Cable grip | 8. Safety flap |

3 PACKAGE CONTENT LIST

- ☒ Remove all packaging materials.
- ☒ Remove remaining packaging and packing inserts (if included).
- ☒ Check that the package contents are complete.
- ☒ Check the appliance, the power cord, the power plug and all accessories for transportation damage.
- ☒ Keep the packaging materials as far as possible until the end of the warranty period. Then take it to your local waste disposal system.



WARNING Packaging materials are not toys! Children must not play with plastic bags! There is a danger of suffocation!









- 1 x Electric lawn scarifier
- 1 x Steering bar
- 1 x Lower steering bar
- 1 x Grass collector
- 1 x Cable grip
- 1 x Manual



If any parts are missing or damaged, please contact your dealer.

4 SYMBOLS

The following symbols are used in this manual and/or on the machine:

	Read manual before usage		Risk of injury due to electrical power! Risk of damage to the power cable! Keep the power cable away from the tines.
	Denotes risk of personal injury or damage to the tool.		Caution, sharp tines. The tines continue to rotate after the motor is switched off –pull the plug out of the socket before carrying out any maintenance work or if the cable is damaged.
	Risk of injury due to flying parts! Other persons must maintain a safe distance.		Wearing of protection against noise advised
	Do not expose the product to a humid environment		Risk of injury! Before beginning work, check the terrain and remove all objects that may be flung out by the product.

5 GENERAL POWER TOOL SAFETY WARNINGS

Read all safety warnings and instructions. Failure to heed warnings and follow instructions may result in electric shock, fire and/or serious injury. Keep safety warnings and instructions for future reference. The term "power tool" in the safety warnings refers to your mains-operated (corded) power tool or battery-operated (cordless) power tool.

5.1 Working area

- ☒ Keep working area clean and well lit. Untidy and dark areas can lead to accidents.
- ☒ Do not operate power tools in potentially explosive surroundings, for example, in the presence of inflammable liquids, gases or dust. Power tools create sparks which may ignite the dust or fumes.
- ☒ Keep children and bystanders at a distance when operating a power tool. Distractions can cause you to lose control of it.

5.2 Electrical safety



Always check that the power supply corresponds to the voltage on the rating plate.

- ☒ Power tool plugs must match the outlet. Never modify the plug in any way. Do not use adapter plugs with earthed power tools. Unmodified plugs and matching outlets will reduce the risk of a lethal electric shock.
- ☒ Avoid body contact with earthed surfaces such as pipes, radiators, kitchen ranges and refrigerators. There is an increased risk of a lethal electric shock if your body is earthed.
- ☒ Do not expose power tools to rain or wet conditions. If water gets inside a power tool, it will increase the risk of a lethal electric shock.

- ☒ Do not damage the cord. Never use the cord for carrying, pulling or unplugging the power tool. Keep the cord away from heat, oil, sharp edges or moving parts. Damaged or entangled cords increase the risk of a lethal electric shock.
- ☒ When operating a power tool outdoors, use an extension cable suitable for outdoor use. Using a cord suitable for outdoor use reduces the risk of a lethal electric shock.
- ☒ If operating a power tool in a damp location is unavoidable, use a power supply protected by a residual current device (RCD). Using an RCD reduces the risk of a lethal electric shock.

5.3 *Personal safety*

- ☒ Stay alert, watch what you are doing and use common sense when operating a power tool. Do not use a power tool when you are tired or under the influence of drugs, alcohol or medication. A moment of inattention when operating a power tool may result in serious personal injury.
- ☒ Use safety equipment. Always wear eye protection. Using safety equipment such as a dust mask, non-skid safety shoes, a hard hat, or hearing protection whenever it is needed will reduce the risk of personal injury.
- ☒ Avoid accidental starts. Ensure the switch is in the off position before inserting the plug. Carrying power tools with your finger on the switch or plugging in power tools when the switch is in the on position makes accidents more likely.
- ☒ Remove any adjusting keys or spanners before turning on the power tool. A spanner or key left attached to a rotating part of the power tool may result in personal injury.
- ☒ Do not reach out too far. Keep your feet firmly on the ground at all times. This will enable you retain control over the power tool in unexpected situations.
- ☒ Dress properly. Do not wear loose clothing or jewellery. Keep your hair, clothing and gloves away from the power tool. Loose clothes, jewellery or long hair can become entangled in the moving parts.
- ☒ If there are devices for connecting dust extraction and collection facilities, please ensure that they are attached and used correctly. Using such devices can reduce dust-related hazards.

5.4 *Power tool use and care*

- ☒ Do not expect the power tool to do more than it can. Use the correct power tool for what you want to do. A power tool will achieve better results and be safer if used in the context for which it was designed.
- ☒ Do not use the power tool if the switch cannot turn it on and off. A power tool with a broken switch is dangerous and must be repaired.
- ☒ Disconnect the plug from the power source before making adjustments, changing accessories, or storing power tools. Such preventive safety measures reduce the risk of starting the power tool accidentally.
- ☒ Store power tools, when not in use, out of the reach of children and do not allow people who are not familiar with the power tool or these instructions to operate it. Power tools are potentially dangerous in the hands of untrained users.
- ☒ Maintenance. Check for misalignment or jammed moving parts, breakages or any other feature that might affect the operation of the power tool. If it is damaged, the power tool must be repaired. Many accidents are caused by using poorly maintained power tools.
- ☒ Keep cutting tools sharp and clean. Properly maintained cutting tools with sharp cutting edges are less likely to jam and are easier to control.
- ☒ Use the power tool, accessories and cutting tools, etc., in accordance with these instructions and in the manner intended for the particular type of power tool, taking into account the working conditions and the work which needs to be done. Using a power tool in ways for which it was not intended can lead to potentially hazardous situations.

5.5 Service

- ☒ Your power tool should be serviced by a qualified specialist using only standard spare parts. This will ensure that it meets the required safety standards.

6 SAFETY INFORMATION FOR SCARIFIERS

- ☒ Read the instructions carefully to ensure safe operation of the product.
- ☒ Before beginning work, check the area and remove all objects that may be caught up and flung by the product.
- ☒ Keep the power cable away from the tines. The tines can damage the cable and result in contact with activated parts.
- ☒ Press the operating lever with caution. Ensure you are standing at an adequate distance from the working tool.
- ☒ Do not start the motor when standing in front of the ejection channel.
- ☒ Never place your hands or feet on or under rotating parts. Always maintain a safe distance from the ejection opening.
- ☒ Remember that the product operator is responsible for accidents or risks to other persons or their property.
- ☒ Only operate the scarifier at walking speed.
- ☒ Work only when light and visibility are good.
- ☒ Avoid using the product on wet grass. Exercise extreme caution when using on wet grass so as to avoid slipping.
- ☒ Ensure that there are no other persons or animals close to the working area.
- ☒ Do not touch the tines until the product has been disconnected from the mains and the tines have come to a complete standstill.
- ☒ Always ensure stability on slopes.
- ☒ Always work across slopes, never upwards or downwards.
- ☒ Never work on extremely steep slopes.
- ☒ Be vigilant when reversing or pulling the product.
- ☒ Be especially vigilant when changing direction on slopes.
- ☒ Stop the working tools if you have to tilt the product for transportation. Stop working tools when crossing surfaces other than grass and transporting the product to and from surfaces to be worked.
- ☒ Never use the product if safety devices are damaged or missing, for example without the safety flap and/or catcher.
- ☒ Always pull the mains plug out of the socket:
 - ☒ when leaving the product unattended.
 - ☒ before freeing a blocked tool.
 - ☒ after hitting a foreign body.
 - ☒ when the product vibrates abnormally.

7 ASSEMBLY (FIG 1)

- ☒ Attach the bottom steering bar (6) to the product with the tommy screw (9).
- ☒ Screw the steering bar (5) with the screw and the tommy nut (10) to the bottom steering bar (6).

8 OPERATION

8.1 Setting the steering height (Fig 2)

- ☒ Loosen the steering clamps (11).
- ☒ Fold the steering bar (5) to the required height.
- ☒ Lock the steering clamps (11) again.

8.2 **Setting the working depth (scarifying/venting) (Fig 3)**

The device can be used to vent or scarify, depending on the roll setting.

- ☒ Pull the lever (7) from its current engaged position and allow it to engage in the position you want.

8.2.1 5 mm to 0 mm (venting)

In this setting, the springs impinge into the ground to vent.

8.2.2 -5 mm to -10 mm (venting/scarifying)

In this setting, the springs and the scarifiers impinge into the ground to vent and scarify.

8.3 **Attaching the extension cable (Fig 4)**

- ☒ Pull the extension cable through the cable grip (4) as illustrated.
- ☒ Insert the extension cable coupling into the plug on the switch-on safety lock (2).

8.4 **Attaching the collecting sack (Fig 5)**

- ☒ Fold up the safety flap (8).
- ☒ Hook the collecting sack (3) into the notches (12) as illustrated.

9 SCARIFYING / AERATING (FIG 6)



WARNING Risk of injury! Before beginning work, check the terrain and remove all objects that may be flung out by the product.

WARNING Risk of injury! Never let go of the steering while working.

- ☒ Position the product on a flat grass surface.
- ☒ Keep the operating safety lock (2) pressed.
- ☒ Pull and keep hold of the operating lever (1); release the operating safety lock (2).
- ☒ Wait until the motor has reached the maximum idle speed.
- ☒ Steer the product at an even, slow speed (walking pace) in the straightest lines possible.

9.1 **Important notes**



WARNING Risk of injury:

- ☒ Always keep the extension cable away from the product.
- ☒ Always work across slopes where possible.
- ☒ Never start the product on a consolidated surface.
- ☒ Release the operating lever (1) immediately if the scarifier roll (working roll) becomes blocked by a foreign body.
- ☒ If a foreign body gets trapped, check the product and have it repaired if necessary.
- ☒ To improve results and maximise the service life of the product, the grass should be cut as short as possible.
- ☒ Staying too long in one position can damage the grass swards.

10 CLEANING AND MAINTENANCE



WARNING Risk of injury! Before any maintenance and/or cleaning work:

- ☒ Switch off the product.

- ☒ Pull out the mains plug.



WARNING Risk of injury! Scarifier roll (working roll) runs on!

- ☒ Never tilt, lift or carry the product while the motor is running.
☒ Wait until the product has come to a standstill before commencing any maintenance and/or cleaning work.



WARNING Risk of injury! Perform only the maintenance work described here yourself.

Any other work, especially motor maintenance and repairs must be performed by a trained professional. Improper work can cause product damage and hence physical injury.

10.1 Cleaning and maintenance at a glance

Before each use	
What?	How?
Check the power cable and plug for damage.	Visual inspection, if necessary, have any damaged parts replaced by an electrician.
Check and, if necessary tighten, all screw connections.	Tighten using a suitable tool.
After each use	
What?	How?
Clean grass and moss from the product and the motor's ventilation slots.	Remove using a vacuum cleaner or brush.

10.2 Cleaning the product

Clean the product immediately after each use. Dried-on grass is extremely hard and difficult to remove.

- ☒ Empty the grass collector.
☒ Remove residual grass using a brush or plastic scraper (do not use any sharp implements).
☒ Remove deposits from the wheels.
☒ Wipe down the product with a slightly damp cloth.
☒ Never clean the product with water or high-pressure jet.

11 TROUBLESHOOTING

If something isn't working*



Warning Risk of injury! Improper repairs can result in the product functioning unsafely. This endangers yourself and your environment.

Malfunctions are often caused by minor faults. You can easily remedy most of these yourself. Please consult the following table before contracting the store. You will save yourself a lot of trouble and possibly money too.

Fault/ malfunction	Cause	Remedy
Motor not running.	No mains voltage?	Check cable, plug, socket and fuse.
	Cable faulty?	Contact your local store.

Fault/ malfunction	Cause	Remedy
Clacking sounds.	Foreign body in the scarifier roll (working roll)?	Switch-off the product; remove foreign bodies.
Whistle sounds.	Drive belt slipping?	Contact your local store.
Output too low.	Grass too high?	Mow the grass before scarifying.
	Drive belt faulty?	Contact your local store.
	Worn scarifying roll?	Contact your local store.

If you can't fix the fault yourself, please directly contact your nearest store. Please be aware that any improper repairs will also invalidate the warranty and additional costs may be incurred.

12 TECHNICAL DATA

	S36E
Voltage	230V-50Hz
Power consumption	1800 Watt
Idling speed	3500 min-1
Working Width	360 mm
Working Depth (venting)	5 to 0mm
Working Depth (scarifying)	-5 to -10mm
Volume collection bag	40l

13 NOISE

Noise values measured according to relevant standard. (K=3)

Acoustic pressure level LpA	81 dB(A)
Acoustic power level LwA	102 dB(A)



ATTENTION! The sound power level may exceed 85 dB(A), in this case individual hearing protection shall be worn.

aw (Vibration)	Max. 4.1 m/s ²	K = 1,5 m/s ²
----------------	---------------------------	--------------------------

14 SERVICE DEPARTMENT

- ☒ Damaged switches must be replaced by our after-sales service department.
- ☒ If the connecting cable (or mains plug) is damaged, it must be replaced by a particular connecting cable which is available from our service department. Replacement of the connecting cable must only be carried out by our service department (see last page) or by a qualified person (qualified electrician).

15 STORAGE

- ☒ Thoroughly clean the whole machine and its accessories.
- ☒ Store it out of the reach of children, in a stable and secure position, in a cool and dry place, avoid too high and too low temperatures.
- ☒ Protect from exposure to direct sunlight. Keep it in the dark, if possible.
- ☒ Don't keep in plastic bags to avoid humidity build-up.

16 WARRANTY

- ☒ This product is warranted for a 12-month period effective from the date of purchase by the first user.

- ☒ This warranty covers all material or production flaws excluding : batteries, chargers, defective parts subject to normal wear & tear such as bearings, brushes, cables, and plugs, or accessories such as drills, drill bits, saw blades, etc. ; damage or defects resulting from maltreatment, accidents or alterations; nor the cost of transportation.
- ☒ Damage and/or defects resulting from inappropriate use also do not fall under the warranty provisions.
- ☒ We also disclaim all liability for any bodily injury resulting from inappropriate use of the tool.
- ☒ Repairs may only be carried out by an authorised customer service centre for Cobra Garden tools.
- ☒ You can always obtain more information at the number 01159862161
- ☒ Any transportation costs shall always be borne by the customer, unless agreed otherwise in writing.
- ☒ At the same time, no claim can be made on the warranty if the damage of the device is the result of negligent maintenance or overload.
- ☒ Definitely excluded from the warranty is damage resulting from fluid permeation, excessive dust penetration, intentional damage (on purpose or by gross carelessness), inappropriate usage (use for purposes for which the device is not suitable), incompetent usage (e.g. not following the instructions given in the manual), inexperienced assembly, lightning strike, erroneous net voltage. This list is not exhaustive.
- ☒ Acceptance of claims under warranty can never lead to the prolongation of the warranty period nor commencement of a new warranty period in case of a device replacement.
- ☒ Devices or parts which are replaced under the warranty therefore remain the property of Henton and Chattell Ltd.
- ☒ We reserve the right to reject a claim whenever the purchase cannot be verified or when it is clear that the product has not been properly maintained. (Clean ventilation slots, carbon brushes serviced regularly, etc.).
- ☒ Your purchase receipt must be kept as proof of date of purchase.
- ☒ Your appliance must be returned undismantled to your dealer in an acceptably clean state, (in its original blow-moulded case if applicable to the unit), accompanied by proof of purchase.

17 ENVIRONMENT



Should your appliance need replacement after extended use, do not discard it with the household rubbish but dispose of it in an environmentally safe way. Waste produced by electrical machine items should not be handled like normal household rubbish. Please recycle where recycle facilities exist. Check with your Local Authority or retailer for recycling advice.



EC Declaration of Conformity

We, the importer

Henton and Chattell Ltd.

Declare that the product

Designation: 1800w 2 in 1 Scarifier and Raker

Model: S36E (6701)

Complies with the following directives:

2011/65/EU

2004/108/EC

2006/42/EC

2000/14/EC Annex V LwA 87dB(A) / 102dB(A)

The conformity assessment procedure followed was in accordance with

Directive 2006/42/EC Annex 1

Name of the Notified Body: TÜV Rheinland LGA Products GmbH, Tillystraße 2, 90431, Nürnberg

Standards and technical specifications referred to:

EN60335-1: 2002

EN60335-2-92: 2005

EN55014-1: 2006

EN55014-2: 1997

EN61000-3-2: 2006

EN61000-3-11: 2000

Authorised signatory and technical file holder

Date: 7th January 2014

Signature: 

Name / title: Mr Peter J. Chaloner / Managing Director

Henton and Chattell Ltd., London Road, Nottingham NG2 3HW UK