

18V SimpliMow 320

Art. 9707036 01

18V SimpliMow 320 KIT 4.0

Art. 9707037 01

Operator's manual

Battery lawnmower

en 18V SimpliMow 320

Original instructions

1. SAFETY WARNINGS	2
2. ASSEMBLY	4
3. OPERATION	5
4. MAINTENANCE	7
5. STORAGE AND TRANSPORT	7
6. TROUBLESHOOTING	7
7. TECHNICAL DATA	8
8. ACCESSORIES / SPARE PARTS	8
9. SERVICE / WARRANTY	8
10. DISPOSAL	8
11. ANNEX	9

1. SAFETY WARNINGS

1.1 Explanation of the symbols on the product



Read operator's manual.



WARNING – Beware of thrown objects – keep bystanders away.



WARNING – Keep the supply cord away from the blades.



WARNING – Remove plug from mains before maintenance or if cord is damaged. (Not applicable to this product!)



WARNING – Keep hands and feet away from the blades. Blades continue to rotate after the motor is switched off.



WARNING – Disconnect battery before maintenance.



WARNING – Remove the disabling device before maintenance.

1.2 General safety warnings

- We recommend to wear a hearing protection.
- **Maintain the mower at regular intervals.** This will extend the working life of the mower.
- **Only use spare parts recommended by FLYMO.** This is the only way to ensure safe use of the mower.
- Be careful during adjustment of the machine to prevent entrapment of the fingers between moving cutting means and fixed parts of the machine.
- After striking a foreign object, inspect the machine for damage and make repairs before restarting and operating the machine.
- If the machine starts to vibrate abnormally, immediately inspect for damage, replace or repair any damaged parts and check for and tighten any loose parts.
- Do not tilt the machine when switching on the motor, except if the machine has to be tilted for starting. In this case, do not tilt it more than absolutely necessary and lift only the part which is away from the operator.
- When servicing the cutting means be aware that, even though the power source is switched off, the cutting means can still be moved.
- Avoid excessive use of the product to avoid overheating the motor and battery.
- Stop the cutting means if the machine has to be tilted for transportation, when crossing surfaces other than grass and when transporting the machine to and from the area to be used.

1.2.1. Intended use



WARNING!

Risk of physical injury

- Do not use the product to cut bushes, hedges, shrubs, to cut of climbers or grass on roofs or balcony boxes, to chop up branches, twigs and to level irregularities in the soil.
- Do not use the product on a slope steeper than 20° maximum.

The **FLYMO Lawnmower** is intended to mow lawn in private domestic gardens and allotments. It is not suitable for continuous operation (professional operation).

1.2.2. General safety warnings for machines



WARNING!

Read all safety warnings, instructions, illustrations and specifications provided with this machine.

Failure to observe the safety warnings and instructions may result in electric shock, fire and/or serious injury.

Save all safety warnings and instructions for future reference.

The term "machine" used in the safety warnings refers to mains-powered (corded) machines and to battery-operated (cordless) machines.

1) Work area safety

- a) Keep work area clean and well lit.** Cluttered or dark areas invite accidents.
- b) Do not operate machines in explosive atmospheres, such as in the presence of flammable liquids, gases or dust.** Machines create sparks which may ignite the dust or fumes.
- c) Keep children and bystanders away while operating a machine.** Distractions can cause you to lose control.

2) Electrical safety

- a) Machine plugs must match the outlet. Never modify the plug in any way. Do not use any adaptor plugs with earthed (grounded) machines.** Unmodified plugs and matching outlets will reduce risk of electric shock.
- b) Avoid body contact with earthed or grounded surfaces, such as pipes, radiators, ranges and refrigerators.** There is an increased risk of electric shock if your body is earthed or grounded.
- c) Do not expose machines to rain or wet conditions.** Water entering a machine will increase the risk of electric shock.
- d) Do not abuse the cord. Never use the cord for carrying, pulling or unplugging the machine. Keep cord away from heat, oil, sharp edges or moving parts.** Damaged or entangled cords increase the risk of electric shock.
- e) When operating a machine outdoors, use an extension cord suitable for outdoor use.** Use of a cord suitable for outdoor use reduces the risk of electric shock.
- f) If operating a machine in a damp location is unavoidable, use a residual current device (RCD) protected supply.** Use of an RCD reduces the risk of electric shock.

3) Personal safety

- a) Stay alert, watch what you are doing and use common sense when operating a machine. Do not use a machine while you are tired or under the influence of drugs, alcohol or medication.** A moment of inattention while operating machines may result in serious personal injury.
- b) Use personal protective equipment. Always wear eye protection.** Protective equipment such as dust mask, non-skid safety shoes, hard hat, or hearing protection used for appropriate conditions will reduce personal injuries.
- c) Prevent unintentional starting. Ensure the switch is in the OFF-position before connecting to power source and / or battery pack, picking up or carrying the machine.** Carrying machines with your finger on the switch or energising machines that have the switch on invites accidents.
- d) Remove any adjusting key or wrench before turning the machine on.** A wrench or a key left attached to a rotating part of the machines may result in personal injury.
- e) Do not overreach. Keep proper footing and balance at all times.** This enables better control of the machine in unexpected situations.
- f) Dress properly. Do not wear loose clothing or jewellery. Keep your hair, clothing and gloves away from moving parts.** Loose clothes, jewellery or long hair can be caught in moving parts.
- g) If devices are provided for the connection of dust extraction and collection facilities, ensure these are connected and properly used.** Use of dust collection can reduce dust-related hazards.
- h) Do not let familiarity gained from frequent use of machines allow you to become complacent and ignore machine safety principles.** A careless action can cause severe injury within a fraction of a second.

4) Machine use and care

- a) Do not force the machine. Use the correct machine for your application.** The correct machine will do the job better and safer at the rate for which it was designed.
- b) Do not use the machine if the switch does not turn it on and off.** Any machine that cannot be controlled with the switch is dangerous and must be repaired.
- c) Disconnect the plug from the power source and / or the battery pack from the machine before making any adjustments, changing accessories, or storing machines.** Such preventive safety measures reduce the risk of starting the machine accidentally.
- d) Store idle machines out of the reach of children and do not allow persons unfamiliar with the machine or these instructions to operate the machine.** Machines are dangerous in the hands of untrained users.
- e) Maintain machines. Check for misalignment or binding of moving parts, breakage of parts and any other condition that may affect the machine's operation. If damaged, have the machine repaired before use.** Many accidents are caused by poorly maintained machines.
- f) Keep cutting tools sharp and clean.** Properly maintained cutting tools with sharp cutting edges are less likely to bind and are easier to control.
- g) Use the machine, accessories and tool bits etc. in accordance with these instructions, taking into account the working conditions and the work to be performed.** Use of the machine for operations different from those intended could result in a hazardous situation.

h) Keep handlebars and grasping surfaces dry, clean and free from oil and grease. Slippery handlebars and grasping surfaces do not allow for safe handling and control of the machine in unexpected situations.

5) Battery tool use and care

a) Recharge only with the charger specified by the manufacturer. A charger that is suitable for one type of battery pack may create a risk of fire when used with another battery pack.

b) Use machines only with specifically designated battery packs. Use of any other battery packs may create a risk of injury and fire.

c) When battery pack is not in use, keep it away from other metal objects, like paper clips, coins, keys, nails, screws or other small metal objects, that can make a connection from one terminal to another. Shorting the battery terminals together may cause burns or a fire.

d) Under abusive conditions, liquid may be ejected from the battery; avoid contact. If contact accidentally occurs, flush with water. If liquid contacts eyes, additionally seek medical help. Liquid ejected from the battery may cause irritation or burns.

e) Do not use a battery pack or tool that is damaged or modified. Damaged or modified batteries may exhibit unpredictable behavior resulting in fire, explosion or risk of injury.

f) Do not expose a battery pack or tool to fire or excessive temperature. Exposure to fire or temperature above 130 °C may cause explosion.

g) Follow all charging instructions and do not charge the battery pack or tool outside the temperature range specified in the instructions. Charging improperly or at temperatures outside the specified range may damage the battery and increase the risk of fire.

6) Service

a) Have your machine serviced by a qualified repair person using only identical replacement parts. This will ensure that the safety of the machine is maintained.

b) Never service damaged battery packs. Service of battery packs should only be performed by the manufacturer or authorised service providers.

1.2.3. Lawnmower safety warnings

a) Do not use the lawnmower in bad weather conditions, especially when there is a risk of lightning. This decreases the risk of being struck by lightning.

b) Thoroughly inspect the area for wildlife where the lawnmower is to be used. Wildlife may be injured by the lawnmower during operation.

c) Thoroughly inspect the area where the lawnmower is to be used and remove all stones, sticks, wires, bones, and other foreign objects. Thrown objects can cause personal injury.

d) Before using the lawnmower, always visually inspect to see that the blade and the blade assembly are not worn or damaged. Worn or damaged parts increase the risk of injury.

e) Check the grass catcher frequently for wear or deterioration. A worn or damaged grass catcher may increase the risk of personal injury.

f) Keep guards in place. Guards must be in working order and be properly mounted. A guard that is loose, damaged, or is not functioning correctly may result in personal injury.

g) Keep all cooling air inlets clear of debris. Blocked air inlets and debris may result in overheating or risk of fire.

h) While operating the lawnmower, always wear non-slip and protective footwear. Do not operate the lawnmower when barefoot or wearing open sandals. This reduces the chance of injury to the feet from contact with the moving blade.

i) While operating the lawnmower, always wear long trousers. Exposed skin increases the likelihood of injury from thrown objects.

j) Do not operate the lawnmower in wet grass. Walk, never run. This reduces the risk of slipping and falling which may result in personal injury.

k) Do not operate the lawnmower on excessively steep slopes. This reduces the risk of loss of control, slipping and falling which may result in personal injury.

l) When working on slopes, always be sure of your footing, always work across the face of slopes, never up or down and exercise extreme caution when changing direction. This reduces the risk of loss of control, slipping and falling which may result in personal injury.

m) Use extreme caution when reversing or pulling the lawnmower towards you. Always be aware of your surroundings. This reduces the risk of tripping during operation.

n) Do not touch blades and other hazardous moving parts while they are still in motion. This reduces the risk of injury from moving parts.

o) When clearing jammed material or cleaning the lawnmower, make sure all power switches are off and the battery pack is disconnected. Unexpected operation of the lawnmower may result in serious personal injury.

p) When clearing jammed material or cleaning the lawnmower, make sure all power switches are off and remove the safety key. Unexpected operation of the lawnmower may result in serious personal injury.

1.3 Safety warnings for batteries and battery chargers



Read all the safety warnings and instructions.

Failure to observe the safety warnings and instructions may result in electric shock, fire and/or serious injury.

Store these instructions in a safe place. Only use the battery charger if you are familiar with all of its functions and are able to perform these without limitation or have received appropriate instructions.

→ Do not use the product in explosive atmospheres.

→ Supervise children during use, cleaning and maintenance. This is to ensure that children do not play with the battery charger.

→ Only charge lithium-ion batteries of the POWER FOR ALL system type PBA 18V with a capacity of 1.5 Ah or more (5 battery cells or more). The battery voltage must match the battery charging voltage of the battery charger. Do not charge non-rechargeable batteries. Otherwise there is a risk of fire and explosion.

→  Do not expose the battery charger to rain or wet conditions. Water entering a machine will increase the risk of electric shock.

→ Keep the battery charger clean. Dirt poses a risk of electric shock.

→ Always check the battery charger, cable and plug before use. Do not use the battery charger if you notice any damage. Do not open the battery charger yourself, ensure that any repairs are performed only by qualified personnel using only original spare parts. Damaged battery chargers, cables and plugs increase the risk of electric shock.

→ Do not operate the battery charger on easily combustible surfaces (e.g. paper, textiles etc.) or in combustible environments. There is a risk of fire because the battery charger heats up during charging.

→ Do not cover the battery charger's ventilation slots. The battery charger may otherwise overheat and no longer function properly.

→ Use only battery chargers that are recommended by the manufacturer to charge the batteries. A battery charger that is suitable for one type of battery may cause a fire hazard if used with other batteries.

→ Vapours may also escape if the battery is damaged or used improperly. Ensure that the area is well ventilated and seek medical attention should you experience any adverse effects. The vapours may irritate the respiratory tract.

→ Liquid may leak from the battery if used incorrectly. Avoid contact with it. In the event of accidental contact, rinse with water. If the liquid gets in your eyes, seek additional medical attention. Leaking battery fluid may cause skin irritation or burns.

→ If the connecting cable needs replacing, this must be carried out by FLYMO or by an authorised after sales service centre for FLYMO machines in order to avoid safety hazards.

→ These safety warnings apply only to lithium-ion batteries of the POWER FOR ALL system PBA 18V.

→ Use the battery only with products from POWER FOR ALL system manufacturers. This is the only way to protect the battery against dangerous overload.

→ Use only battery chargers that are recommended by the manufacturer to charge the batteries. A battery charger that is suitable for one type of battery may cause a fire hazard if used with other batteries.

→ The battery is supplied partially charged. To ensure full performance of the battery, fully charge the battery in the battery charger before using it for the first time.

→ Keep batteries out of the reach of children.

→ Do not open the battery. There is a risk of a short circuit.

→ Vapours may escape if the battery is damaged or used improperly. The battery may burn or explode. Ensure that the area is well ventilated and seek medical attention should you experience any adverse effects. The vapours may irritate the respiratory tract.

→ If used incorrectly or if the battery is damaged, flammable liquid may escape from the battery. Avoid contact with it. In the event of accidental contact, rinse with water. If the liquid gets in your eyes, seek additional medical attention. Leaking battery fluid may cause skin irritation or burns.

→ If the battery is defective, liquid may leak out and wet adjacent objects. Check affected parts. Clean them or replace them if necessary.

→ Do not short-circuit the battery. When the battery is not in use, keep it away from paper clips, coins, keys, nails, screws or other small metal objects that could make a connection from one terminal to another. A short circuit between the battery contacts may result in burns or fire.

→ The battery contacts may be hot after use. Be careful of the hot contacts when removing the battery.

→ The battery can be damaged by sharp objects such as a nail or screwdriver or by external force. An internal short circuit may occur and the battery may burn, smoke, explode or overheat.

→ Never service damaged batteries. All maintenance of batteries should be carried out only by the manufacturer or authorised after sales service centres.



Protect the battery from heat, including prolonged exposure to sunlight, fire, dirt, water and moisture. There is a risk of explosion and short circuit.

→ Operate and store the battery only at an ambient temperature between -20°C and +50°C. Do not leave the battery in your car in the summer, for example. At temperatures < 0°C, performance may be reduced depending on the device.

→ Charge the battery only at an ambient temperature between 0°C and +35°C. Charging outside of the temperature range can damage the battery and increase the risk of fire.

→ After use, allow the battery to cool down for at least 30 minutes before charging or storing it.

1.3.1. Additional electrical safety warnings



DANGER!

Risk of cardiac arrest

This product generates an electromagnetic field while it operates. This electromagnetic field may affect the functionality of active or passive medical implants (e.g. pacemakers), which may result in serious injury or death.

→ Consult your doctor and the manufacturer of your implant before using this product.

→ Remove the battery when you are not using the product.

→ Do not expose the battery and battery charger to rain, water or wet conditions.

→ Remove the battery immediately in case of an emergency.

1.3.2. Additional personal safety warnings



WARNING!

Risk of suffocation

Small parts can easily be swallowed. There is a choking hazard for small children due to the polybag.
→ Keep small children away when you assemble the product.

- Do not cut grass by pulling the machine towards you.
- Keep the air inlets clean with a brush before storage.
- Do not reach through openings while using the mower.
- Disabled or weak persons should ask a second person for help with the transport (weight).
- Do not disassemble the product further than the delivery status.
- Use gloves, wear slip resistant shoes and wear eye protection.
- Only start the mower with an upright handled handlebar.
- Do not overload the mower.
- Never operate the product when you are tired, ill or under the influence of alcohol, drugs, or medicine.

2. ASSEMBLY



WARNING!

Cutting injury due to the blade

Risk of cut injury due to accidental starting.
→ Use gloves.
→ Wait for the blade to stop.
→ Remove the safety key.

2.1 To assemble the lower handlebars

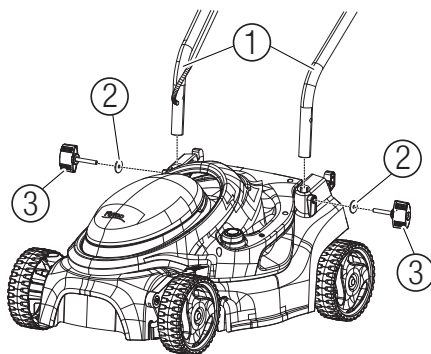

1. Insert both lower handlebars ① into the openings of the mower.
2. Make sure that the handlebars are completely in place and the holes of the handlebars are inline up with the holes of the openings in the mower.
3. Insert the wing screws ③ through the washers ② into the appropriate openings of the mower.
4. Tighten both wing screws ③.
5. Make sure that the wing screws ③ are completely tightened.

2.2 To assemble the upper handlebar

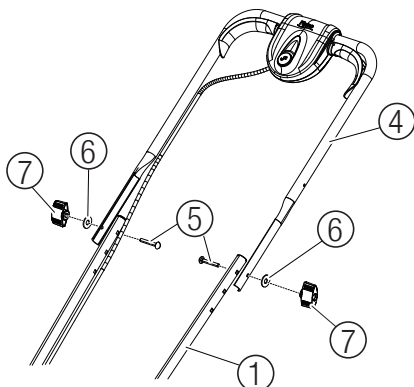

The upper handlebar ④ can be assembled to the lower handlebars ① in 3 positions according to the preferred height.

- Adjust the height of the handlebar so that you are in an upright position when using the mower.

Position	Height of the handlebar above the ground
Lower hole	91 cm
Middle hole	94 cm
Upper hole	97 cm

1. Put the upper handlebar ④ on the lower handlebars ①.
2. Ensure that the handlebars are fully aligned and the desired holes are properly aligned.
3. Insert both screws ⑤ into the designated holes.
4. Place both washers ⑥ and both wing nuts ⑦ onto the screws ⑤.
5. Tighten both wing nuts ⑦.

2.3 To attach the cable to the handlebar

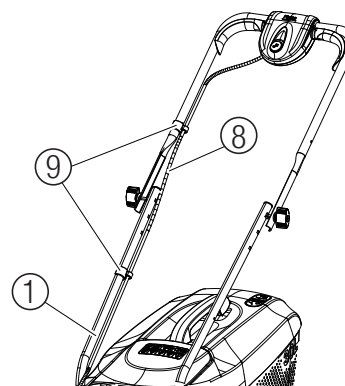

1. Attach the clamps ⑨ to the holes provided for them on the handlebar ①.
2. Attach the cable ⑧ to the clamps ⑨ on the handlebar ①.
3. Make sure that the cable is not trapped between the handlebar and the mower, otherwise the cable may be damaged.

2.4 To assemble the grass catcher box

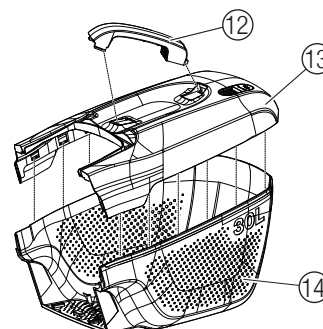

1. First, secure the side of the handle ⑫ with the hook into the appropriate slot on the cover ⑬.
2. Then, fasten the other side of the handle ⑫ to the appropriate slot on the cover in order to properly mount the handle onto the cover ⑬.
3. Attach the cover ⑬ to the container ⑭.
4. Make sure that all connectors are engaged.

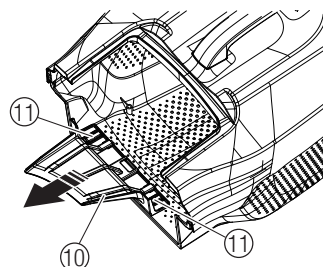

5. Attach the tongue ⑩ by sliding it into the appropriate connectors ⑪, until it audibly engages.
6. Make sure that all connectors are engaged.

2.5 To replace the blade

The FLYMO spare parts are available from your FLYMO dealer or from the FLYMO customer service.

- Only use the **original** FLYMO Replacement blade, **FLY109**.
- For safety reasons, the blade shall be replaced by an authorised FLYMO dealer only.

2.5.1 To remove the old blade

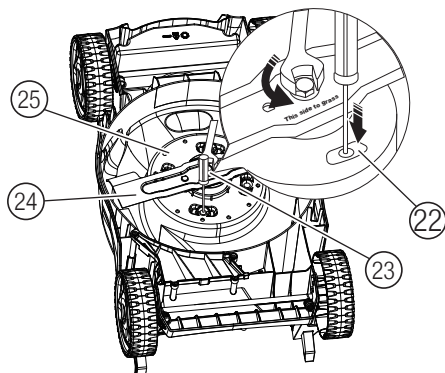

1. Insert a screwdriver into one of the provided holes 25 at the bottom of the housing.
The screwdriver thus serves as a stop for the blade.
2. Unscrew the blade bolt 26.
3. Make sure that the spacer 23 is not damaged when applying the force.
4. Remove the blade bolt 26.
5. Remove the blade 27.

2.5.2 To insert the new blade

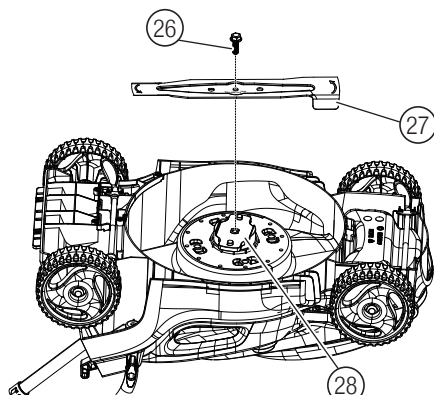

1. Attach the new blade 27 to the mower.
The inscription on the knife (this side to grass) must be visible.
2. Attach the blade bolt 26 to the mower.
3. Screw the new blade 27 tight with the blade bolt 26 (tightening torque is 15 – 20 Nm). Do not over-torque.
4. Make sure that the spacer 23 remains undamaged while exerting force
5. Pull the screwdriver out of the mower.
6. Make sure that the screwdriver is removed before restarting the mower.

3. OPERATION



WARNING!

Cutting injury due to the blade
Risk of cut injury due to accidental starting.
→ Use gloves.
→ Wait for the blade to stop.
→ Remove the safety key.

3.1 Hints to use the mower

- Pull the mower backwards about 1m to remove grass residue from the discharge opening.
- Cut the lawn once a week for a well-maintained lawn.
Cutting the lawn frequently helps make it denser.

- For long cutting intervals, cut in one direction with the highest cutting height, then in the crosswise direction with the required cutting height to prevent blade blockage.
- Ideally, cut the grass when it is dry to ensure an even cutting pattern.

3.2 Cutting performance and battery charge

- Determine the extent of the lawn area that can be mowed on each battery charge, considering factors like moisture, grass density, and cutting height.
- To maximize battery running time, avoid frequently turning the mower on and off.
- Increase the cutting height and perform frequent mowing to optimize the cutting performance for each battery charge.

3.3 To remove the battery from the mower

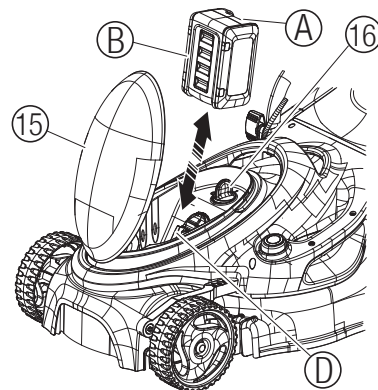

1. Open the cover 15 of the battery holder 14.
2. Turn the safety key 16 to position 0 and remove it from the mower.
3. Push the locking button A.
4. Remove the battery B from the battery holder 14

3.4 To insert the battery into the mower

→ See „3.3 To remove the battery from the mower“ on page 5.

1. Open the cover 15 of the battery holder 14.
2. Insert the battery B into the battery holder 14 until it audibly engages.
3. Insert the safety key 16 into the mower and turn it to position I.
4. Close the cover 15 of the battery holder 14.

3.5 To charge the battery



CAUTION!

Risk of property damage

The voltage of the power source must match the voltage specified on the rating plate of the charger.
→ Note the mains voltage.

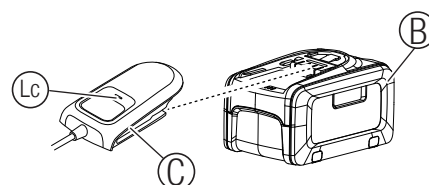

1. Connect the battery charger C into a mains socket.
2. Slide the battery charger C onto the battery B.
When the battery charge indicator Lc at the charger blinks green the battery is being charged.
When the battery charge indicator Lc at the charger lights permanently green the battery is completely charged
(Charging time, see „7. Technical Data“ on page 8).
3. Monitor the charging status frequently during the charging process.
4. Once the battery B is fully charged, disconnect it from the charger C.

Note: Thanks to the intelligent charging process, the charge condition of the battery is automatically detected and then charged up with the optimal charge current depending on battery temperature and voltage.
In this way, the battery is treated with care and remains permanently fully charged when it is stored in the charger.

Meaning of the indication elements on the charger:

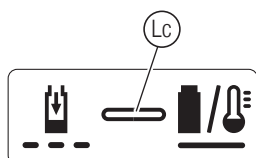

Flashing of the Battery Charge Indicator (Lc)



The charging procedure is indicated by flashing of the battery charge indicator (Lc).

Note: The charging procedure is only possible when the battery temperature is within the allowable charging temperature range, see „7. Technical Data“ on page 8.

Continuous Lighting of the Battery Charge Indicator (Lc)



Continuous lighting of the battery charge indicator (Lc) indicates that the battery is fully charged or that the temperature of the battery is not within the allowable charging temperature range and can therefore not be charged.

When the battery is not inserted, **continuous lighting** of the battery charge indicator (Lc) indicates that the mains plug is inserted in the socket outlet and that the battery charger is ready for operation.

3.6 To adjust the cutting height

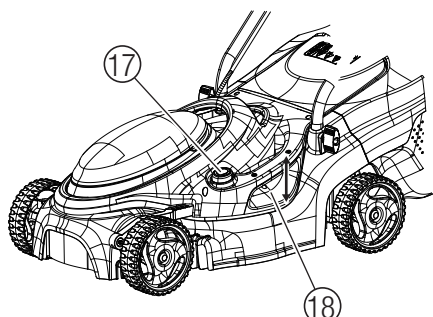

The cutting height can be adjusted from 30 – 60 mm in 4 positions.

- Push the button (17) and push the handlebar (18) down to reduce the cutting height.
- Push the button (17) and pull the handlebar (18) up to increase the cutting height.

3.7 To use the mower with the grass catcher box



WARNING!

Cutting injury due to the blade

- Cut injury when the blade turns or the mower starts accidentally.
- Wait for the blade to stop, remove the safety key and use gloves before you open the protective flap.
- Do not put your hands in the discharge opening.

3.7.1 To put the grass catcher box into the mower

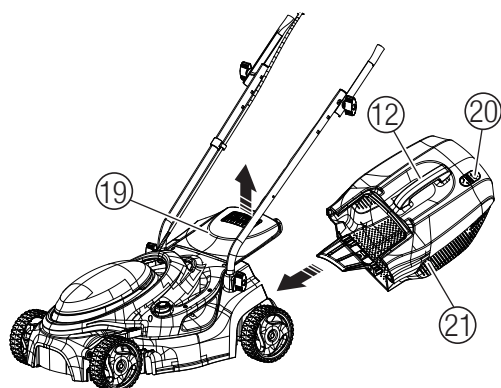

1. Lift the protective flap (19).
2. Hold the grass catcher box with the handle and attach it to the mower the grass catcher box (21) to the mower using the handle (12).
3. Make sure that the grass catcher box is securely connected.
4. Start the mower, see „3.8 To start / To stop the mower“ on page 6.

3.7.2 To empty the grass catcher box

The level indicator (20) opens during mowing. When it closes during mowing, the grass box is full.

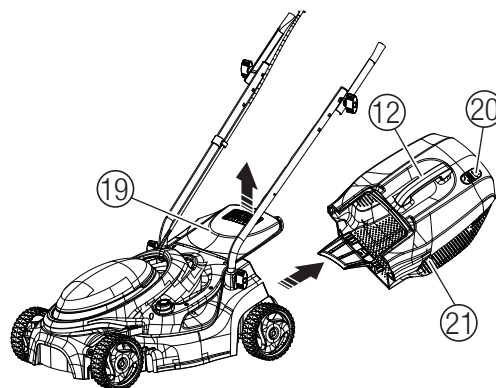

1. When the grass catcher box (21) is full, stop the mower.
2. Lift the protective flap (19).
3. Remove the grass catcher box by the catcher box handle (12).
4. Empty the grass catcher box (21).

3.8 To start / To stop the mower



WARNING!

Risk of physical injury

- Risk of cutting injuries if a damaged or bent knife or one with unbalanced or chipped cutting edges rotates.
- Do not use the mower when the blade is damaged, bent, out of balance or has chipped edges.
- Do not regrind the blade.
- Let the blade be replaced by an authorised FLYMO dealer.

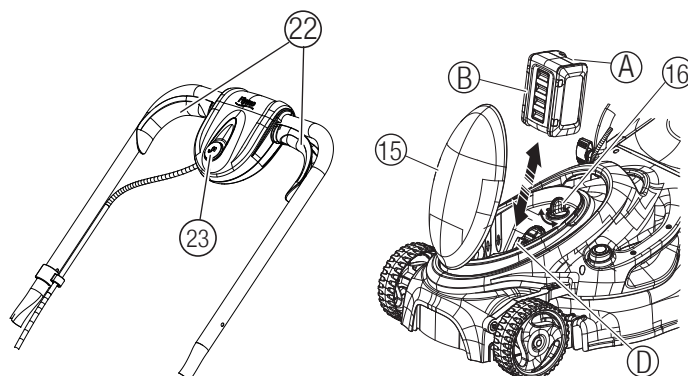

3.8.1 To start the mower

The product is provided with a two-handed safety device (start lever and safety interlock) to prevent the product from being turned on by accident. There are two start levers (22). Either one has to be used to start. We recommend using only the 4 Ah batteries P4A PBA 18V/72 (PNC 5313827-01) or larger.

1. Insert the battery into the battery holder (10), see „3.4 To insert the battery into the mower“ on page 5.
2. Insert the safety key (16) into the mower and turn it to the position I.
3. Press the safety interlock (23) with one hand and pull the start lever (22) with the other hand to the handlebar.
The mower starts.
4. Release the safety interlock (23).

3.8.2 To stop the mower



WARNING!

Risk of physical injury

- Risk of injury if the product does not stop when the start lever is released.
- Do not bypass the safety devices or switches.
- For example do not attach the start lever to the handlebar.

1. Release the start lever (22).
The mower stops.
2. Turn the safety key (16) to position 0.
3. Remove the battery (8) to protect it from discharging, see „3.3 To remove the battery from the mower“ on page 5.
4. Make sure that all moving parts have come to a complete stop.

4. MAINTENANCE



WARNING!

Cutting injury due to the blade

Risk of cut injury due to accidental starting.

- Use gloves.
- Wait for the blade to stop.
- Remove the safety key.
- Remove the battery.

4.1 To clean the mower:



CAUTION!

Risk of property damage

- Do not clean the product with water or with a water jet (in particular high-pressure water jet).
- Do not clean with chemicals including petrol or solvents. Some can destroy critical plastic parts.
- The airflow slots must always be clean.
- Clean the overside and underside of the mower after each use.

4.1.1 To clean the overside of the mower

1. Clean the overside with a damp cloth.
2. Clean the airflow slots and the grass box with a soft brush (do not use sharp objects).

4.1.2 To clean the underside of the mower

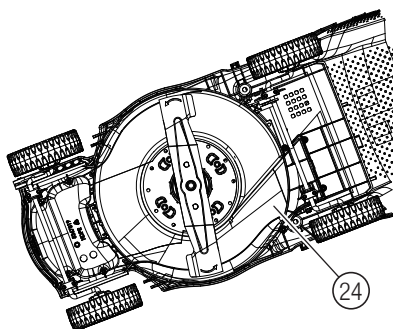

1. Lay the mower on its side carefully.
2. Clean the underside, the blade and the discharge opening 24 with a soft brush (do not use sharp objects).

4.1.3 To clean the grass catcher box

- Clean the grass catcher box with a soft brush (do not use sharp objects).

4.2 To clean the battery and the battery charger

The surface and the contacts of the battery and the battery charger must be clean and dry before the battery is connected to the battery charger.

- Do not use running water.

4.2.1 To clean the battery

- Occasionally clean the ventilation slots and the terminals on the battery using a soft brush that is clean and dry.

4.2.2 To clean the battery charger

- Clean the contacts and the plastic parts with a soft and dry cloth.

5. STORAGE AND TRANSPORT

5.1 To put into storage

- The product must be stored away from children.
- Always allow the machine to cool down before storing.
- Turn the safety key (19) to position 0 and remove it to prevent the battery from discharging.
- Remove the battery.
- Charge the battery.
- Empty the grass catcher box 21.

- Clean the mower, the battery and the battery charger (see „4. Maintenance“ on page 7).
- Store the mower, the battery and the battery charger in a dry, enclosed and frost-free place.

Storage position to save space:

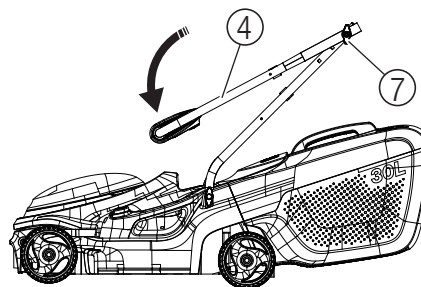

1. Loosen both wing nuts 7.
2. Fold the upper handlebar 4 downwards onto the mower.
3. Make sure that the cable is not trapped between the upper and lower handlebar, otherwise the cable may be damaged.

5.2 To transport the mower

- Always allow the machine to cool down before transporting.

1. Stop the cutting means
2. Turn the safety key to position 0 and remove it.

6. TROUBLESHOOTING

NOTE:

Repairs must only be done by an authorised FLYMO dealer.

- For any other malfunctions please contact the FLYMO customer service (see „9. Service / Warranty“ on page 8).



WARNING!

Cutting injury due to the blade

Risk of cut injury due to accidental starting.

- Use gloves.
- Wait for the blade to stop.
- Remove the safety key.
- Remove the battery.

6.1 Troubleshooting table:

Problem	Possible Cause	Remedy
Engine is blocked	Obstacle blocks the motor.	→ Remove the obstacle.
	Cutting height is too low.	→ Increase the cutting height.
Loud noises, the mower is rattling	Screws on motor, its fixing or on the mower chasing are loose.	→ Let the screws be tightened by an authorised specialist dealer.
Mower runs unevenly or vibrates strongly	Blade is damaged or worn.	→ Replace the blade.
	Blade bolt is released.	→ Tighten the blade bolt.
	Blade is very dirty.	→ Clean the mower. If this does not solve the problem, contact the customer service (see „9. Service / Warranty“ on page 8)
Lawn is not cleanly mowed	Blade is blunt or damaged.	→ Replace the blade.
	Cutting height is too low.	→ Increase the cutting height.
Mower does not start or stops.	Battery is empty.	→ Charge the battery.
	Battery temperature is the permissible temperature range. outside	→ Wait until the battery temperature is between 0 °C and + 45 °C again.
	There are drops of water or moisture between the battery contacts.	→ Remove the water drops or moisture with a dry cloth.
	Obstacle blocks the motor.	→ Remove the obstacle.
	Mower has a defect.	→ Contact the customer service (see „9. Service / Warranty“ on page 8)

Charging is not possible. Battery charge indicator  lights continuously green

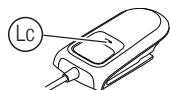

Charging is not possible. Battery charge indicator  does not light



Battery is not put completely into the battery holder.	→ Put the battery completely into the battery holder until it audibly engages.
Safety key is not turned to position 1.	→ Turn the safety key to position I.
Battery is defective.	→ Replace the battery.
Mower is defective.	→ Contact the customer service (see „9. Service / Warranty“ on page 8).
Battery is not slid onto the charger correctly.	→ Slide the battery onto the charger correctly.
Battery contacts are dirty.	→ Clean the battery contacts (e. g. by connecting and dis-connecting the battery several times. Replace the battery if necessary.
Battery temperature is outside the permissible temperature range.	→ Wait until the battery temperature is between 0 °C and + 45 °C again.
Battery has a defect.	→ Replace the battery.

Mains plug of the charger is not plugged in correctly.	→ Insert the mains plug completely into the mains socket.
Mains socket, mains cable or charger is defective.	→ Check the mains voltage. → Let the charger be checked if necessary by an authorised specialist dealer.

7. TECHNICAL DATA

Battery Lawnmower	Unit	Value
Speed of rotation cutting blade	rpm	3500
Cutting width	cm	32
Cutting height adjustment (4 positions)	mm	30 / 40 / 50 / 60
Cutting area with two 4,0 Ah P4A batteries	m ²	200
Volume of grass catcher box	l	30
Weight (without Battery)	kg	9.9
Sound pressure level $L_{pA}^{(1)}$	dB (A)	77
Uncertainty k_{pA}		3
Sound power level $L_{WA}^{(2)}$; measured/guaranteed	dB (A)	88 / 89
Uncertainty k_{WA}		0.6
Hand/arm vibration $a_{vhw}^{(1)}$	m/s ²	≤ 2.5
Uncertainty k_{vhw}		1.5

Measuring process complying with: ¹EN IEC 62841-4-3 ²RL 2000/14/EC / S.I. 2001 No.1701



NOTE: The stated vibration emission value has been measured according to a standardised test procedure and can be used for comparison of one electric power tool with another. It can also be used for preliminary evaluation of exposure. The vibration emission value can vary during actual use of the electric power tool depending on the ways in which the machine is used. As a safety measure, you should work with the machine for a maximum of 1 hour without interruption.

System Battery PBA 18V 4,0 Ah W-C	Unit	Value (PNC 5313827-01)
Battery voltage	V (DC)	18
Battery capacity	Ah	4.0
Number of cells (Li-Ion)		10
Appropriate POWER FOR ALL system Battery Chargers		AL 1810 CV / AL 1815 CV / AL 18V-20 / AL 1830 CV / AL 1880 CV
Battery Charger AL 1810 CV P4A	Unit	Value (PNC 5341476-01)
Mains voltage	V (DC)	220 – 240
Mains frequency	Hz	50 – 60
Rated power	W	26

Battery charging voltage		18
Max. battery charging current		1000
Battery charging time 80 % / 97 – 100 % (approx.)		
PBA 18V 2,0Ah W-B	min.	96 / 124
PBA 18V 2,5Ah W-B	min.	120 / 154
PBA 18V 4,0Ah W-C	min.	192 / 244
Permitted charging temperature range		°C 0 – 35
Weight according to EPTA-Procedure 01:2014		kg 0.17
Protection class		□ / II
Appropriate POWER FOR ALL system Batteries		PBA 18V

8. ACCESSORIES / SPARE PARTS

FLYMO Replacement Blade	As replacement for blunt blade.	FLY109
-------------------------	---------------------------------	--------

9. SERVICE / WARRANTY

9.1 Product registration

Please register your product at [gardena.com/registration](https://www.flymo.com/registration).

9.2 Service

Please find the current contact information of our service on the back page and online:



<https://www.flymo.com/uk/content/contact-us>

10. DISPOSAL

10.1. Disposal of the mower

(according to Directive 2012/19/EU / S.I. 2013 No. 3113):



The product must not be disposed of to normal household waste. It must be disposed of in line with local environmental regulations.

IMPORTANT!

→ Dispose of the product through or via your local recycling collection centre.

10.2. Disposal of the battery:



Li-ion



The battery contains lithium-ion cells that should not be disposed of with normal household waste at the end of its life.

IMPORTANT!



1. Discharge the lithium-ion cells completely (contact the FLYMO Service).
2. Protect the contacts on the lithium-ion cells against short circuits.
3. Dispose of the lithium-ion cells properly via or through your local recycling collection centre.

11. ANNEX

11.1. EU – Declaration of Conformity

	The undersigned Husqvarna AB, SE 561 82 Huskvarna, Sweden hereby certifies that, when leaving our factory, the unit(s) indicated below is/are in accordance with the harmonised EU guidelines, EU standards of safety and product specific standards. This certificate becomes void if the units are modified without our approval.
Description of the unit:	Lawn Mower
Type:	18V SimplicMow 320 18V SimplicMow 320 KIT 4.0
Article number:	9707036 01 9707037 01
EU directives:	2006/42/EC 2014/30/EU 2000/14/EC 2011/65/EU Charger: 2014/35/EU
Harmonised Standard:	EN ISO 12100 EN 62841-1 EN IEC 62841-4-3 Charger: EN 60335-1 EN IEC 60335-2-29
Noise level: measured / guaranteed:	88 dB(A) / 89 dB(A)
Conformity Assessment Procedure:	According to 2000/14/EC Art.14 Annex VI
Notified body:	DEKRA Testing and Certification GmbH Handwerkstraße 15 70565 Stuttgart
Deposited Documentation:	GARDENA Manufacturing GmbH Technische Dokumentation, M. Jäger Hans-Lorenser-Str. 40 89079 Ulm / Germany
Year of CE marking::	2023
Ulm, 20.09.2023	 Martin Lienhard , Senior Vice President, Business Unit Electric and Battery

11.2. UKCA – Declaration of Conformity

	Declaration of Conformity [only for UK] The manufacturer: Husqvarna AB, SE 561 85 Huskvarna, Sweden hereby certifies that, when leaving our factory, the unit(s) indicated below is/are in accordance with the UK Regulations, designated standards of safety and product specific designated standards. This certificate becomes void if the units are modified without our approval.
Description of the product:	Lawn Mower
Type:	18V SimplicMow 320 18V SimplicMow 320 KIT 4.0
Article number:	9707036 01 9707037 01
UK regulations:	S.I. 2008/1597 S.I. 2016/1091 S.I. 2012/3032 S.I. 2001/1701 Charger: S.I. 2016/1101
Designated standards:	EN ISO 12100 EN 62841-1 EN IEC 62841-4-3 Charger: EN 60335-1 EN IEC 60335-2-29
Approved Body:	Intertek Testing & Certification Ltd. Academy Place, 1-9 Brook Street, Brentwood, Essex, CM14 5NQ United Kingdom Approved Body Number: 0359
Noise level: measured / guaranteed	88 dB (A) / 89 dB (A)
Conformity Assessment Procedure:	According to S.I. 2001/1701 Art.11 Schedule 9
Dokumentation Deposited:	GARDENA Manufacturing GmbH, Technische Dokumentation, M.Jäger D-89079 Ulm, Hans-Lorenser-Str.40
UK importer:	Husqvarna UK Limited Preston Road, Aycliffe, County Durham UK DL5 6UP
Ulm, 20.09.2023	 Martin Lienhard Senior Vice President Business Unit Electric and Battery
Authorized representative:	Martin Lienhard Senior Vice President Business Unit Electric and Battery



**Service Address and
Importer to Great Britain**

Husqvarna UK Ltd
Preston Road
Aycliffe Industrial Park
Newton Aycliffe
County Durham
DL5 6UP
customer.services@husqvarna.co.uk



22320-85.960.02/1023
Husqvarna AB
Drottninggatan 2
SE-561 82 Huskvarna
Sweden

Our policy of continuous improvement means that the specification of products may be altered from time to time without prior notice.

Copyright © 2023 Flymo S.A. All rights reserved.

Flymo® and other product and feature names are registered or unregistered trademarks of Flymo S.A.