



Operator's Manual

user manual, maintenance instructions and spare parts

260BX Premium Blower
280BVX Premium Blower/Vacuum



Read this manual carefully before operating the machine

Original Instructions Version May 16

280BVX/260BX_1305163

CONTENTS

HOW TO READ THE MANUAL

Certain paragraphs in the manual contain particularly significant information and are marked with various levels of highlighting with the following meaning:

NOTE or IMPORTANT

These give details or further information on what has already been said and aim to prevent damage to the machine or cause other damage.

Non-observance will result in the risk of serious injury or death to oneself or others.



Getting to know the machine	1
Safety regulations	1
Operating instructions	8
1. Prepare the machine	8
2. Preparing to work	10
3. Using the machine	11
4. Operating modes	13
5. Routine maintenance	14
6. Warranty Work	17
7. Diagnostics	17
8. Technical information	18

GETTING TO KNOW THIS MACHINE

MACHINE DESCRIPTION AND USAGE

This machine is a portable gardening device fitted with an engine and, more precisely, a blower/suction device for DIY use. It basically consists of an engine that activates a rotor which is able to produce a high-speed air flow. When the accessory tools are fitted, the air flow can be regulated to operate in both blower and suction mode. (280 BVX Only)

Intended use

This machine was designed and manufactured for:

- the movement and accumulation, by blowing, of leaves, grass, debris of various limited weight and modest dimensions.
- vacuum collection of leaves, grass, various debris of limited weight and modest dimensions, excluding liquids of any kind.

Any other use differing from the above mentioned ones could be hazardous, harm people and/or damage things and the machine.

User types

This machine is intended for use by consumers, i.e. non-professional operators. The machine is intended for "DIY" use only.

Improper use

The machine must not be used for accumulation and collection of inflammable or explosive products, hot embers or combustion material without a flame, lit cigarettes, pieces of glass, sharp objects, metal objects, stones and any other objects that could be dangerous to the operator and others.

Examples of improper use may include, but are not limited to:

- aiming towards persons and/or animals
- allowing objects to enter the suction grid
- using the machine without the accessories specifically supplied by the manufacturer for specific uses, or use of accessories in a way not intended in these instructions
- use of the machine by more than one person

IDENTIFICATION LABEL (SYMBOL) AND MACHINE COMPONENTS

Your machine must be used carefully. Symbols have therefore been placed on various parts of the machine to remind you of the main precautions to be taken. Their meaning is explained below. You are also asked to carefully read the safety regulations in the specific chapter of this manual. Replace damaged or illegible labels.



(a). Operate the engine switch Flipping the switch to the "0" position, immediately the engine stops. "0" Stop, "I" Start



(b). Warning! Danger. The failure to use this machine correctly can be hazardous for oneself and others. Read the instruction manual before using the machine.



(c). Keep all persons away from the work area whilst using.



(d). If you are using the machine every day in normal conditions, you can be exposed to a noise level of 85 dB (A) or higher. Wear safety glasses and hearing protection.

(e). Wear gloves and protective footwear!



(f). Danger of dismemberment! Never use the machine with the grille open.



(g). Guarantee A-weighted emission noise power level

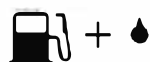

(h). Fuel mixture tank



(i). Close the choke



(j). Open the choke



(k). Adjustment of carburettor

"H" High speed adjustment, "L" Low speed adjustment



(l). Engine speed continuously variable

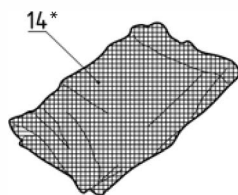
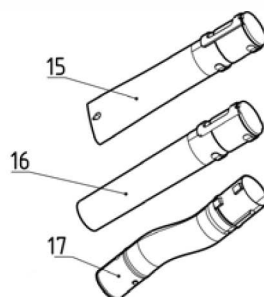
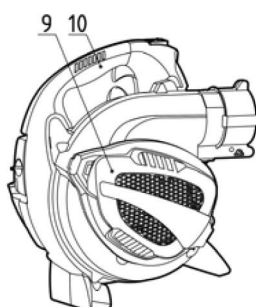
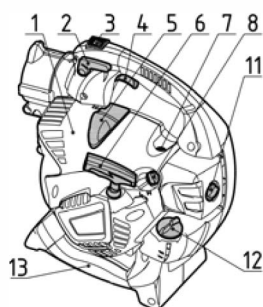

*Only Available with 280BVX Blower/Vacuum

- 1 Engine
- 2 Throttle setting device
- 3 Engine switch
- 4 Throttle trigger
- 5 Spark plug
- 6 Starter handle
- 7 Primer blub
- 8 Choke knob
- 9 Intake grille

- 10 Upper handle
- 11 Air filter screw
- 12 Fuel tank cap
- 13 Lower handle
- 14 Bag*
- 15 Second blow tube (flat end)
- 16 Second blow tube (round end)

- 17 First blow tube (curving)
- 18 Bag Coupling tube*
- 19 Second vacuum tube*
- 20 First vacuum tube*

*Only available with 280BVX Blower/Vacuum

SAFETY REGULATIONS

This machine is extremely noisy and operators must wear acoustic protection equipment.

A) TRAINING

- 1) **WARNING!** Read these instructions carefully before operating the machine. Become acquainted with the controls and the proper use of the machine. Learn how to stop the engine quickly.
- 2) Never allow children or people unfamiliar with these instructions to use the machine. Local laws can restrict the minimum age of the operator.
- 3) Never use the machine if the user is tired or unwell, or has taken medicine, drugs, alcohol or any substances which may slow their reflexes and compromise his judgment.
- 4) Bear in mind that the operator or user is responsible for accidents or unexpected events occurring to other people or their property.
- 5) If the machine is sold or lent to others, make sure that the operator reads the user instructions contained in this manual.

B) PRELIMINARY OPERATIONS

- 1) Always wear adequate clothing which does not hamper movements when using the machine.
 - Always wear slim-fitting protective clothes, anti-vibration gloves, protective goggles, half-mask respirator, protective earplugs, anti-shear safety boots with non-slip soles
 - Never wear scarves, shirts, necklaces or any hanging or flapping accessory that could catch in the machine
 - Tie your hair back if it is long
- 2) **WARNING: DANGER!** Petrol is highly flammable
 - Keep the fuel in containers which have been specifically manufactured and homologated for such use
 - Add fuel, using a funnel, only outdoors; do not smoke during this operation and each time fuel is handled
 - Slowly open the fuel tank to allow the pressure inside to decrease gradually
 - Add fuel before starting the engine; never remove the tank cap or add fuel while the engine is running or when the engine is hot
 - Always put the tank and fuel container caps back on and tighten well
 - Immediately clean up all traces of fuel spilt on the machine or on the ground
 - Never start the machine in the same place you refilled it with fuel; the engine must be started in an area at least 3 meters from where you refilled the fuel tank
 - Make sure your clothing does not come into contact with the fuel, if this happens, change your clothes before starting the engine

4) Replace faulty or damaged silencers.

5) Before using the machine, carry out an accurate inspection of the machine's efficiency and in particular:

- the throttle trigger must move freely, it must not need forcing and should return automatically and rapidly back to the neutral position
- the engine stop switch must easily move from one position to the other
- the electric cables and in particular the spark plug cable must be in perfect condition to avoid the generation of any sparks and the cap must be correctly fitted on the spark plug
- the machine handgrips and protection devices must be clean and dry and well fastened to the machine
- the guards must never be damaged
- the rotor must never be damaged
- the bag must never be damaged

6) Thoroughly inspect the whole work area and use a rake or yard brush to manually loosen debris and remove anything that could be projected by the machine (when used as a blower) or block the vacuum tube (when used as a vacuum collector) or be a hazardous source (stones, branches, wire, bones etc.)

C) DURING USE

1) Do not operate the engine in a confined space where dangerous carbon monoxide fumes can develop.

2) Work only in daylight or with good artificial light in good visibility conditions.

3) When working in dry dusty soil conditions, it is recommended to moisten the surface slightly.

4) Try not to cause any disturbance. Use this machine at reasonable times of the day only (not early morning or late evening when the noise could cause disturbance).

5) Do not mount equipment or accessories on the machine not foreseen or approved by the manufacturer.

6) Never use the machine: Without mounting all the accessories required for each use (as blower or vacuum collector); when people, especially children or pets are nearby; In confined spaces, in the presence of fumes, in an explosive environment or close to inflammable materials or electrical equipment.

7) Take on a firm and well-balanced position:

- where possible, avoid working on wet, slippery ground or in any case on uneven or steep ground that does not guarantee stability for the operator
- never run, but walk carefully paying attention to the lay of the land and any eventual obstacles
- assess the potential risks of the ground to be worked and take all necessary precautions to ensure your own safety, especially on slopes or on bumpy, slippery or unstable ground

8) Make sure the machine is securely held when you start the engine:

- check that there is nobody within at least 15 metres of the machine's range of action
- do not direct the silencer and therefore the exhaust fumes towards inflammable materials

9) Do not change the engine settings or over-speed the engine.

10) Do not strain the machine too much and do not use a small machine for heavy-duty works. If you use the right machine, you will reduce the risk of hazards and improve the quality of your work.

11) Ensure the machine does not come into contact with foreign bodies and possible flying debris and dust being thrown up by the air flow; do not direct the air jet in the direction of people or animals.

12) When used as a blower always pay the utmost attention to prevent removed material or dust from injuring people or animals or damaging property. Always assess wind direction and never work against the wind. Always extend the blower tube correctly so that the air flow works close to the earth.

13) Never insert objects into the vacuum inlet (when being used as a vacuum collector) and avoid the intake of large objects that could damage the rotor.

14) During use keep your hands well away from the intake grille and from the air outlet and do not obstruct the air vents.

15) Stop the engine:

- when mounting or removing accessories for blowing or collecting
- whenever you leave the machine unattended
- before refuelling
- when moving between work areas

16) Stop the engine and disconnect the spark plug cable:

- before checking, cleaning or working on the machine;
- after the intake of a foreign body. Inspect the machine for any damage and make repairs before restarting it again;
- if the machine starts to vibrate abnormally (find and remove the cause of the vibration immediately);
- when the machine is not in use.

17) To avoid the risk of fire, do not leave the machine with the engine hot on leaves, dry grass or other inflammable material

18) **WARNING** – If something breaks or an accident occurs while working, turn off the engine immediately and move the machine away to prevent further damage; if an accident occurs with injuries or third parties are injured, carry out the first aid measures most suitable for the situation immediately and contact the medical authorities for any necessary health care. Carefully remove any debris that might cause damage or harm persons or animals should they not be seen.

19) **WARNING** The noise and vibration levels shown in these instructions are the maximum levels for use of the machine. Insufficient maintenance has a significant impact on vibration and noise emissions. Consequently, it is necessary to take preventive steps to eliminate possible damage due to high levels of noise and stress from vibration. Maintain the machine well, wear ear protection devices, and take breaks while working.

20) Rotating parts can cause serious injury, avoid contacting the rotating parts when they are still rotating.

21) Don't operate the machine near open windows.

22) Operating the machine with a stable speed and gripping the handle firmly with suitable force can decrease the vibration level. Low engine speed means low-noise level, so operate the machine at the lowest engine speed necessary to accomplish the task. During a working day, you should take frequent and adequate breaks to prevent damage from vibration and damage to the ears.

23) Prolonged exposure to vibrations can cause injuries and neurovascular disorders (also called "Raynaud's syndrome" or "white hand"), especially to people suffering from circulation disorders. The symptoms can affect the hands, wrists and fingers and are shown through loss of sensitivity, torpor, itching, pain and discolouring of or structural changes to the skin. These effects can be worsened by low ambient temperatures and/or by gripping the handgrips excessively tightly. If the symptoms occur, the length of time the machine is used must be reduced and a doctor consulted.

D) MAINTENANCE AND STORAGE

- 1) **WARNING:** Before cleaning or doing maintenance work, disconnect the spark plug cap and read the relevant instructions. Wear proper clothing and protective gloves whenever your hands are at risk.
- 2) **WARNING:** Never use the machine with worn or damaged parts. Faulty or worn-out parts must always be replaced and not repaired. Only use original spare parts: the use of non-original and/or incorrectly fitted parts will jeopardize the machine, impair safety and may cause accidents or personal injuries for which the Manufacturer is under no circumstance liable or responsible.
- 3) Any adjustments or maintenance operations not described in this manual must be carried out by your Dealer or a specialized Service Centre with the necessary knowledge and equipment to ensure that the work is done correctly maintaining the machine's original safety level. Any operations performed in unauthorized centres or by unqualified persons will totally invalidate the Warranty and all obligations and responsibilities of the Manufacturer.
- 4) Keep all nuts and screws tight to be sure the machine is always in a safe working condition. Routine maintenance is essential for safety and for maintaining a high performance level.
- 5) Do not perform any work on the machine that is not described in this manual unless adequately skilled with appropriate tools.
- 6) Do not store the machine with fuel in the tank in an area where the fuel vapours could reach an open flame, a spark or a strong heat source.
- 7) Allow the engine to cool down before storing the machine in any enclosure.
- 8) To reduce fire hazards, keep the engine, exhaust silencer and fuel storage area free from sawdust, branches, leaves, or excessive grease; never leave containers with the debris inside the storage area.
- 9) If the fuel tank has to be emptied, this should be done outdoors once the engine has cooled down.
- 10) Wear work gloves when performing all maintenance.
- 11) Before putting the machine away, check you have removed wrenches or tools used for maintenance.
- 12) Store the machine out of the reach of children!
- 13) Often inspect the bag to avoid wear and a decrease in quality.

E) TRANSPORTATION AND HANDLING

- 1) Whenever the machine is to be handled or transported you must:
 - Turn off the engine and disconnect the spark plug cap
 - Only hold the machine using the handgrips and position the tubes so that they do not obstruct
- 2) When using a vehicle to transport the machine, remove the tubes and position it so that it can cause no danger to persons and fasten it firmly in place to avoid it from tipping over, ensure the machine is drained of fuel before transporting.

F) ENVIRONMENTAL PROTECTION

Environmental protection should be a priority of considerable importance when using the machine, for the benefit of both social coexistence and the environment in which we live. Try not to cause any disturbance to the surrounding area.

- Scrupulously comply with local regulations and provisions for the disposal of oils, petrol, damaged parts or any elements which have a strong impact on the environment; this waste must not be disposed of as normal waste, it must be separated and taken to specified waste disposal centres where the material will be recycled.
- At the time of decommissioning, do not pollute the environment.

OPERATING INSTRUCTIONS

1. PREPARE THE MACHINE

The machine can be used as both a blower and a vacuum collector; for both of these uses it is necessary to correctly arrange the appropriate accessories included with the equipment.



Unpacking and completing the assembly should be done on a flat and stable surface, with enough space for moving the machine and its packaging, always making use of suitable equipment.

IMPORTANT The safety systems prevent the engine from starting if the vacuum or blower tubes are not assembled correctly.

1.1 USE AS A BLOWER (Fig. 1)

- Align the protrusions of the first blower tube (1) with the air outlet nozzle compartments (2), then push the tube until it is firmly in place
- Align the compartment of the second blower tube (3) with the protrusion (4) of the first tube, push the tube in and rotate it 90 degrees clockwise to one of the two available positions, until it is firmly in place

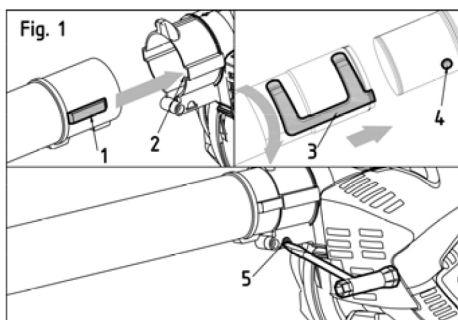

NOTE Fit the second tube with a flat or round end depending on the type of work to be accomplished; flat for a wider stream of air and higher velocity; round for more accuracy and a higher volume of air. To remove the first tube (1), insert the screwdriver included in the kit in the hole (5) and press firmly until you can slide the tube out from the air outlet nozzle.

1.2 USE AS A VACUUM COLLECTOR (Fig. 2)

- Align the protrusions of the bag coupling tube (1) with the air outlet nozzle compartments (2), then push the tube until it is firmly in place
- Insert the end nozzle of the coupling tube (1) into the bag inlet (3) and close the inlet with the velcro fastener provided (4).
- Connect the first vacuum tube (5) to the second (6), aligning the two reference arrows (7) and pushing it as far as possible until the protrusion (6a) of the second tube is firmly inserted in the hole (5a) of the first vacuum tube
- Insert the screwdriver included in the kit in the hole (8) and press to release the catch and open the intake grille (9).
- Align the reference plugs (10) with their respective compartments (11) on the first vacuum tube and turn it counter clockwise, until it is firmly in place.
- Position the bag over the shoulder and use the adjustable shoulder strap to regulate the height.

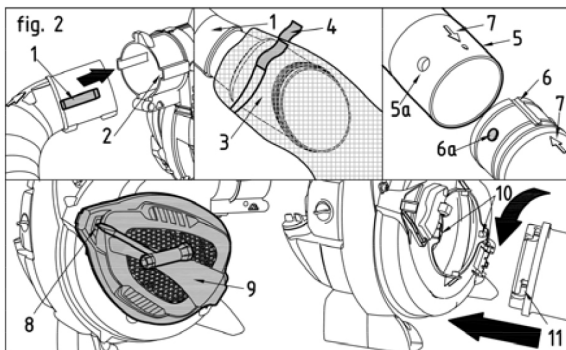

Only available with 280BVX Blower/Vacuum

NOTE The machine is correctly assembled when the rounded part of the chute curves down towards the base of the machine.

2. PREPARING TO WORK

2.1 CHECKING THE MACHINE

Before starting work please:

- check that all the screws on the machine are tightly fastened
- when used as a vacuum collector, make sure the bag is fitted correctly and that the zipper is closed
- check that the air filter is clean
- check that the hand grips are well fastened
- prepare accessories according to the type of work (as blower or vacuum collector) and make sure they are correctly mounted
- fill with fuel as indicated below

2.2 PREPARING THE FUEL MIXTURE

This machine is fitted with a two-stroke engine which requires a mixture of petrol and 2-Stroke oil.

IMPORTANT Using petrol alone will damage the engine and is cause for invalidation of the warranty.

IMPORTANT Use only quality fuels and oils to maintain high performance and guarantee the duration of the mechanical parts over time.

2.2.1 Petrol characteristics

Only use unleaded petrol with a fuel grade of at least 90 RON.

IMPORTANT Ethanol in Unleaded petrol creates deposits in the container and machine if left for more than 1 month. Always use fresh petrol!

2.2.2 Oil characteristics

Only use top quality synthetic oil specifically for two-stroke engines. Your Dealer can provide you with oils which have been specifically developed for this type of engine, and which are capable of guaranteeing a high level of protection.

2.2.3 Preparation and preservation of the fuel mixture

Petrol and the fuel mixture are highly inflammable!



- Keep the petrol and fuel mixture in homologated fuel containers, in a safe place, away from any flames or heat sources
- Never leave the containers within the reach of children.
- Never smoke whilst preparing the mixture and avoid inhaling the petrol fumes.

Two-Stroke Fuel

Refuel outdoors on bare ground, restart the engine at least 5m away from the refuelling stop. The engine is lubricated by oil mixed into petrol. Prepare a mixture of Unleaded petrol and semi-synthetic two-stroke oil that meets the specifications of: API TC, ISO-L-EGC, JASO FC (Low Smoke) oil.

Recommended mixing ratio is 40:1

FUEL WITH NO OIL (RAW PETROL) will cause severe damage to the engine which is not covered by the manufacturer's warranty.

Use fresh, unleaded petrol (90 RON) and semi-synthetic oil specially made for high performance two-stroke engines. Mix in a ratio of 40 parts petrol to 1 part oil. By using two-stroke oil specially made for two-stroke engines you will reduce the formation of ash and carbon deposits on the spark plug, piston, exhaust muffler and cylinder as well as reducing emissions of harmful exhaust gases.

Oil for 4-cycle engines should not be used as two-stroke lubrication oil as it can cause fouling of the spark plug, exhaust port blocking, piston ring sticking and other internal engine damage.

NOTE

Due to increased Ethanol content in petrol we recommend the use of B3C Ethanol Shield 2-Stroke Oil, or Ethanol Shield Fuel Stabiliser to protect your MITOX® engine against the harmful effects of Ethanol.

Visit www.b3cfuel.co.uk for more information.



IMPORTANT The fuel mixture tends to age. Do not prepare excessive amounts of the fuel mixture to avoid the formation of deposits.

IMPORTANT Keep the petrol and fuel mixture containers separate and easily identifiable to avoid the mistake of using one in place of the other.

IMPORTANT Periodically clean the petrol and fuel mixture containers to remove any eventual deposits.

2.3 REFUELING



Never smoke whilst refuelling and avoid inhaling the petrol fumes. Carefully open the tank top as pressure could have formed inside.

Before refuelling:

- Place the machine on a flat stable surface, with the fuel tank cap facing upwards.
- Clean the fuel tank cap and the surrounding area to avoid any dirt from entering the tank during refilling
- Carefully open the fuel tank cap to allow the pressure inside to decrease gradually.

To fuel:

- Shake the can with the fuel mixture well.
- Using a filtered funnel, pour an amount of fuel mixture suited to the work to be performed.
- Refuel without filling the tank to the rim (fig. 3).

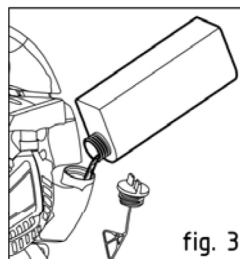

Always close the fuel tank cap firmly. Immediately clean all traces of fuel which may have dripped on the machine or the ground and do not start the engine until the petrol fumes have dissipated.

3. USING THE MACHINE

3.1 STARTING THE MACHINE

Before starting the engine, place the machine on stable ground and make sure the blowing or vacuum tubes are not crushed.

3.1.1 Cold starting (Fig. 4)

A "cold" start of the engine means starting it after at least 5 minutes from when it was switched off or after refuelling.

The start switch is automatically set to the 'ON' position.

1. Move lever (2) to «CHOKE».
2. Press the primer device button (3) 7 to 10 times to prime the carburettor.
3. Hold the machine firmly with one hand on the hand grip (6), in order not to lose control of the machine during starting.
4. Pull the starter rope slowly for 10 - 15 cm until you feel some resistance, then pull it rapidly a few times until you hear the engine fire.

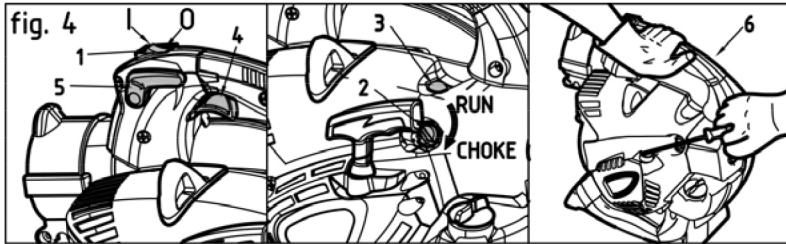

IMPORTANT To avoid breaking the starter rope, do not pull the whole length of it or let it slide along the edge of the rope guide hole. Release the starter gradually, to avoid letting it fly back uncontrollably.

5. Switch the lever (2) to the «RUN» position.
6. Pull the starter rope again until the engine starts, and press the throttle trigger all the way (4) until the engine starts as normal.
7. When the engine has started, press and release the throttle trigger (4) to allow the engine to idle.
8. Rev the engine a little and allow the engine to warm up for a few minutes before using the machine.

IMPORTANT If the starter rope is pulled repeatedly with the choke on, it may flood the engine and make starting difficult. If you happen to flood the engine, repeat the hot start procedure a few times to eliminate any excess fuel.

3.1.2 Hot starting

To hot start the engine immediately after it has stopped, follow steps 2 - 3 - 4 - 6 of the above procedure, making sure the primer (3) is activated 2-3 times only.

3.2 ADJUSTING THE SPEED (Fig. 4)

Rotor rpm must be proportionate to the type of work and regulated by the throttle trigger (4) located on the upper hand grip. The throttle trigger can be held in any required position by engaging the throttle setting device (5).

3.3 STOPPING THE ENGINE (Fig. 4)

To stop the engine:

- Turn the throttle setting device downwards (5)
- Release the throttle trigger (4)
- Press and hold the switch (1) in the «0» position until the engine switches off, then release the switch which will automatically move to the «I» position ready for the next start procedure

4. OPERATING MODES

4.1 USE AS A BLOWER



The machine must always be firmly gripped with your right hand on the upper hand grip during work.

The engine speed should be adjusted to the type of material to be removed:

- use the engine at low speed for lightweight material on the lawn
- use the engine at average speed to move grass and lightweight leaves on pavement or solid ground
- use the engine at high speed for heavier materials like fresh snow or voluminous dirt



Always pay the utmost attention to prevent removed material or dust from injuring people or animals or damaging property. Always assess the wind direction and never work against the wind.

4.2 USE AS A VACUUM COLLECTOR (280BVX Only)



The machine must always be firmly held with both hands during work. Place your right hand on the upper hand grip and your left hand on the lower hand grip so that the bag is on the left-hand side of the operator.

When used as a vacuum collector, it is best to use the engine at average/high speed. During collection, keep the rounded end of the tube a few centimeters off the ground. The bag also works as a filter, similar to a common home vacuum. For this reason it is best that:

- it is always free to expand and the support strap is not tangled
- it is not fully filled.
- collected objects that could jeopardise the bag's integrity are promptly removed



To empty the bag:

- switch the engine off.
- open the zipper (1) and empty the bag without disconnecting it from the coupling tube.

IMPORTANT When used as a vacuum collector do not collect damp grass or leaves to avoid clogging the rotor and bag.

IMPORTANT When using the machine as a vacuum collector, there is a risk of inadvertently suctioning objects which can obstruct the machine and block the rotor. In this case:

- switch the motor off immediately
- Disconnect the spark plug cap
- disassemble the vacuum tube
- remove the foreign body from inside the vacuum inlet
- Check that nothing is blocking the rotor before using the machine again.

IMPORTANT Overfilling the bag reduces the machine's efficiency and could cause the engine to over heat.

4.3 END OF OPERATIONS

When you have finished your work:

- Switch off the engine as indicated above (Chap. 3.3)
- Disconnect the spark plug cap

5. ROUTINE MAINTENANCE



Correct maintenance is essential to maintain the original efficiency and safety of the machine over time.

During maintenance operations:

- Remove the spark plug cap
- Wait until the engine is sufficiently cold
- Wear protective gloves
- Do not work on the machine if not in possession of the necessary skills and tools

5.1 STORAGE

After every working session, clean the machine thoroughly to remove all dust and debris, and repair or replace any faulty parts. The machine must be stored in a dry place away from the elements.

5.2 CYLINDER AND SILENCER

To reduce overheating & fire risks, periodically clean the cylinder fins with compressed air and clear the silencer area from dust, leaves or other debris.

5.3 STARTING SYSTEM

To avoid overheating and damage to the engine, always keep the cooling air vents clean and free of sawdust and debris. The starter rope must be replaced as soon as it shows signs of wear.

5.4 NUTS AND SCREWS

Periodically check that all the nuts and screws are securely tightened and the hand grips are tightly fastened.

IMPORTANT Cleaning the air filter is essential to guarantee the efficiency and duration of the machine. Do not work with a damaged filter or without a filter, as this could permanently damage the engine. It must be cleaned after every 8-10 working hours.

Clean the filter as follows:

- Loosen the knob (1), remove the cover (2) and the filter element (3)
- Wash the filter element (3) with soap and water. Do not use petrol or other solvents
- Leave the filter to dry in the open air
- Replace the filter element (3) and the cover (2) and tighten the knob (1)

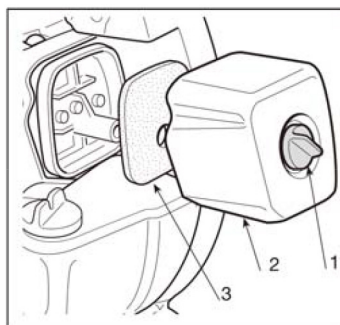

5.6 CHECKING THE SPARK PLUG

Periodically remove and clean the spark plug using a metal brush to remove any deposits. Check and reset the correct distance between the electrodes. Replace the spark plug and fasten it firmly using the supplied wrench. The spark plug must be replaced with one with the same characteristics whenever the electrodes have burnt or the insulation has worn, and in any case every 50 working hours.

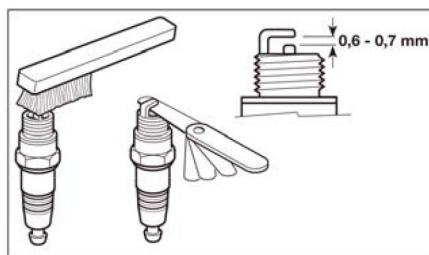

5.7 CARBURETTOR ADJUSTMENTS

IMPORTANT When the engine tends to switch off or there is not much difference in speed when using the throttle trigger, it is recommended to adjust the carburation settings. This operation must be performed by your Dealer only.

5.8 LONG PERIODS OF NON-USE

IMPORTANT If the machine will not be used for a period of more than 1 month it is recommended to remove the fuel to avoid difficulty when you wish to use the machine and to prevent permanent damage to the engine; unless using B3C 2-Stroke Oil or Ethanol Shield. (SEE 5.8.1 STORAGE FOR MORE INFORMATION)

5.8.1 STORAGE FOR MORE INFORMATION)

5.8.1 Storage

Before putting the machine away:

- Empty the fuel tank
- Start the engine and run it at idle until it comes to a halt, so that it uses up all the fuel that is left in the carburettor
- Allow the engine to cool down and remove the spark plug cap

5.8.2 Restarting work

When you wish to start using the machine again:

- Replace the spark plug cap
- Prepare the machine as indicated in the paragraph entitled “Preparing for work”

The following intervals apply to normal operating conditions only. If your daily working time is longer or operating conditions are difficult (very dusty work area, etc.), shorten the specified interval accordingly.		Before starting working	After finishing work daily	After each refuelling stop	Weekly	Monthly	Every 12 months	If problem	If damaged	If required
Complete machine	Visual inspection (condition, wear, leaks)	*		*						
	Clean		*							
Control Handle	Check operation	*		*						
Air filter	Clean						*	*		*
	Replace								*	*
Filter in fuel tank	Check							*		
	Replace filter						*		*	*
Carburettor	Check idle setting	*		*						
	Readjust idle									*
Spark plug	Readjust electrode gap							*		
	Replace after 50 hours of operation									
Cooling inlets	Clean									*
All accessible screws	Check							*		
	Retighten									*
Anti-vibration elements	Check	*						*		*
	Replace(1)								*	
Safety labels	Replace								*	
Muffler	Clean(1)							*		*

(1) MITOX recommends that this work be done by a MITOX servicing dealer. Use only the spare parts recommended by MITOX.

6. WARRANTY WORK

This work must be carried out exclusively by your Dealer. All and any operations performed in unauthorised centres or by unqualified persons will invalidate the warranty.

6.1 FUEL FILTER

Inside the fuel tank there is a filter which prevents impurities from entering the engine.

The filter should be replaced once a year by your Dealer.

6.2 CARBURETTOR ADJUSTMENTS

The carburettor is tuned by the manufacturer to achieve maximum performance in all situations, with a minimum emission of toxic gas in compliance with the regulations in force. In the case of poor performance contact your Dealer for a check of the carburation and engine.

7. DIAGNOSTICS

What to do when...			
Source of problem	Corrective action	Source of problem	Corrective action
1. The engine will not start or will not keep running		3. The engine runs irregularly and lacks in power when increasing the throttle	
Incorrect starting procedure	Follow the instructions (see chapter 3)	Dirty spark plug or incorrect distance between the electrodes	Check the spark plug (see chapter 5)
Dirty spark plug or incorrect distance between the electrodes	Check the spark plug (see chapter 5)	Carburation problems	Contact your Dealer
Air filter clogge	Clean or replace the filter (see chapter 5)	Bag full or clogged	Empty the bag (see chapter 4)
Carburation problems	Contact your Dealer	4. The engine makes too much smoke	
Intake grille open without having mounted the firs vacuum tube	Close the grille or mount the firs vacuum tube (see chapter 1)	Incorrect composition of the fuel mixture	Prepare the fuel mixture according to the instructions (see chapter 2)
Blower or vacuum tube not fitte	Fit the tube	Carburation problems	Contact your Dealer
2. The engine starts but is lacking in power		5.The machine starts to vibrate abnormally	
Air filter clogge	Clean or replace the filter (see chapter 5)	Damaged or loose parts	Stop the machine and disconnect the spark plug cable. Inspect for damage. Check for and tighten any loose parts. Have all checks, repair work and replacements carried out by a specialized Dealer only.
Carburation problems	Contact your Dealer		

TECHNICAL INFORMATION

Technical Data	Unit	280BVX	260BX
Capacity	cm ³	27.6	27.6
Power	kw	0.8	0.8
Maximum Engine Rotation Speed	min<1	8300	8300
Spark Plug		Champion RCJ7Y	Champion RCJ7Y
Mixture (Petrol:2-Stroke)		40:1	40:1
Fuel Tank Capacity	ml	400	400
Operator Ear Nose Press Level LpA Measurement Uncertainty	dB (A) dB (A)	93.9 3	93.9 3
Measured Acoustic Power Level Measurement Uncertainty	dB (A) dB (A)	106.6 3	106.6 3
Acoustic Power Level Guaranteed	dB (A)	109	109
Vibration Level - Upper Handle - Lower Handle Measurement Uncertainty	m/s ² m/s ² m/s ²	2.0 1.4 1.5	2.0 1.4 1.5
Weight (Blower/Vacuum Collector) - Blower - Vacuum	kg kg	4.7 5.8	4.7 N/A
Air Flow - Blowing - Aspirating	m ³ /h m ³ /h	610 600	610 N/A
Maximum Air Speed	m/s	72 (161mph)	72 (161mph)
Length (Without Tube)	mm	350	350
Width (Without Tube)	mm	250	250
Height (Without Tube)	mm	350	350

260BX Premium Blower
280BVX Premium Blower/Vacuum



Parts Diagram

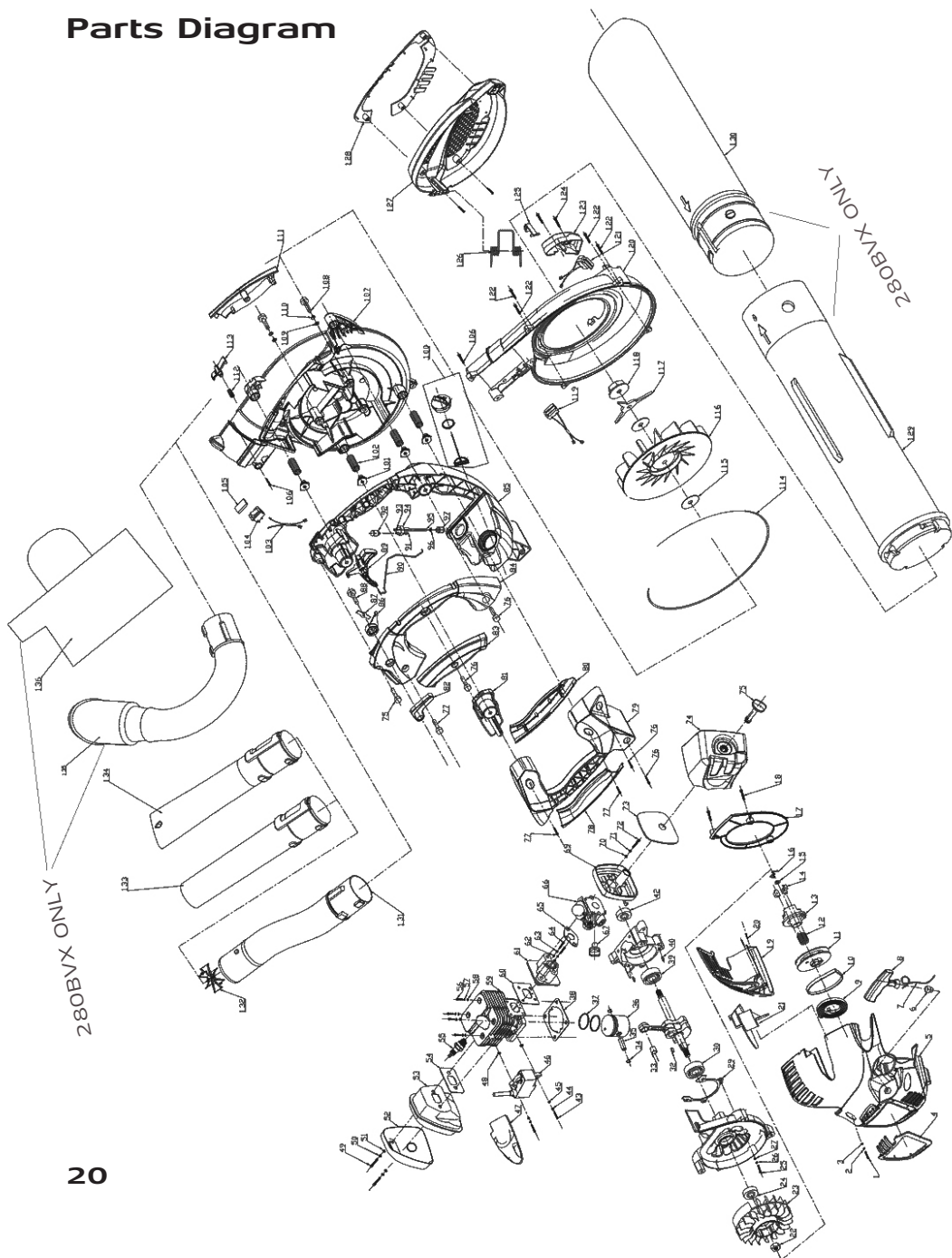

Parts List

ID No.	Part Number	DESCRIPTION
1	MIGB/T2671.2 M5X20	SCREW M5X20
2	MIGB/T93 M5	LOCK WASHER M5
3	MIGB/T97.1 M5	PLATE WASHER M5
4	MIF28.0210.0001	STARTER COVER PLATE
5	MIF28.0210.0100	STARTER COVER
6	MIYD25.02.01-2	ROPE GUIDE
7	MIYD25.02.00-5	STARTER ROPE
8	MIYD62.02.00-3	STARTER HANDLE
9	MIYD42.06-6	RECOIL SPRING
10	MIYD42.06-7	RECOIL SPRING COVER
11	MIF28.0110.0009	RECOIL PULLEY
12	MIF28.0110.0002	TORSION SPRING
13	MIF28.0110.0001	RATCHET
14	MIF28.0110.0003	STARTER PAWLS
15	MIF28.0110.0004	PLATE WASHER
16	MIF28.0110.0005	PAWL SPRING CLIP
17	MIF28.0210.0002	AIR DEFLECTOR
18	MIGB/T845 ST4X10	SCREW ST4X10
19	MIF28.0110.0006	MUFFLER COVER
20	MIGB/T845 ST4X10	SCREW ST4X10
21	MIF28.0110.0008	SEAL
22	MIGB/T6177.2 M8	FLANGE NUT M8
23	MIF28.0106.0100	FLYWHEEL
24	MIYD38-3.01.01.02-00	OIL SEAL 12X22X7
25	MIGB/T2671.2 M5X25	SCREW M5X25
26	MIGB/T93 M5	SPRING WASHER M5
27	MIGB/T97.1 M5	WASHER M5
28	MIF28.0102.0001	L/H CRANKCASE
29	MIF28.0102.0003	GASKET - CRANK CASE
30	MIGB/T276 6201/P5	BALL BEARING 6201/P5
31	MIF28.0103.0100	CRANKSHAFT

Parts List

ID No.	Part Number	DESCRIPTION
32	MIGB/T1099 3X5X13	KEY 3X5X13
33	MIF28.0103.0400	BEARING 8X11X10
34	MIYD36.01.03.00-4	PISTON PIN CLIP
35	MIF28.0103.0003	PISTON PIN
36	MIF28.0103.0300	PISTON
37	MIF28.0103.0002	PISTON RING
38	MIF28.0101.0006	GASKET - CYLINDER
39	MIGB/T276 6201/P5	BALL BEARING 6201/P5
40	MIGB/T119 3X9	PIN 3x9
41	MIF28.0102.0002	R/H CRANKCASE
42	MIYD38-3.01.01.02-00	OIL SEAL 12X22X7
43	MIGB/T2671.2 M4X20	SCREW M4X20
44	MIGB/T93 M4	WASHER M4
45	MIGB/T97.1 M4	PLAIN WASHER M4
46	MIF28.0106.0200	IGNITION COIL
47	MIF28.0106.0201	SPARK PLUG COVER
48	MIF28.0101.0005	INSULATOR RING
49	MIGB/T2671.2 M5X60	SCREW M5X60
50	MIGB/T93 M5	LOCK WASHER M5
51	MIGB/T97.1 M5	WASHER M5
52	MIF28.0101.0004	MUFFLER INSULATION COVER
53	MIF28.0105.0000	MUFFLER
54	MIF28.0101.0003	GASKET - MUFFLER
55	MIBPMR7A	SPARK PLUG
56	MIGB/T2671.2 M5X25	SCREW M5X25
57	MIGB/T93 M5	SPRING WASHER M5
58	MIGB/T97.1 M5	WASHER M5
59	MIF28.0101.0002	CYLINDER
60	MIF28.0101.0001	GASKET - INLET
61	MIF28.0101.0100	MANIFOLD
62	MIGB/T97.1 M5	WASHER M5

Parts List

ID No.	Part Number	DESCRIPTION
63	MIGB/T93 M5	SPRING WASHER M5
64	MIGB/T2671.2 M5X20	SCREW M5X20
65	MITBC261D.01.00.00-4	GASKET - MANIFOLD
66	MIF28.0101.0200	CARBURETTOR
67	MIF28.0100.0001	KNOB - CHOKE
69	MIF28.0104.0003	AIR FILTER COVER BASE
70	MIGB/T97.1 M5	WASHER M5
71	MIGB/T93 M5	SPRING WASHER M5
72	MIGB/T2671.2 M5X50	SCREW M5X50
73	MIF28.0104.0002	AIR FILTER
74	MIF28.0204.0004	AIR BOX COVER
75	MIF28.0104.0004	KNOB - AIR FILTER COVER
76	MIGB/T845 ST5X16	SCREW ST5X16
77	MIGB/T845 ST5X19	SCREW ST5X19
78	MIF28.0112.0300	LOWER HANDLE GRIP
79	MIF28.0112.0003	LOWER HANDLE
80	MIF28.0112.0400	LOWER HANDLE GRIP
81	MIF28.0112.0004	LOWER HANDLE SUPPORT
82	MIF28.0112.0010	KNOB - THROTTLE SETTING
83	MIF28.0112.0100	UPPER HANDLE GRIP
84	MIF28.0112.0002	UPPER HANDLE L/H COVER
85	MIF28	UPPER HANDLE R/H COVER
86	MIF28.0112.0008	LEVER
87	MIF28.0112.0009	ARM
88	MIGB/T845 ST5X16	SCREW ST5X16
89	MIF28.0112.0006	THROTTLE TRIGGER
90	MIF28.0112.0007	THROTTLE ROD
91	MIF28.0117.0003	BREATHER PIPE
92	MIYD45.03.00-5	BREATHER
93	MIF28.0117.0002	FUEL RETURN PIPE
94	MITBC431D.01.13.00-3	GROMMET

Parts List

ID No.	Part Number	DESCRIPTION
95	MIF28.0117.0001	FUEL TUBE
96	MI\45.0102.0103	CIRCLIP
97	MIYD38-3.03.04-00	FUEL FILTER
100	MIYD62.00.03-1	FUEL CAP ASSY
101	MIF28.0111.0003	MOUNT
102	MIF28.0111.0002	AV SPRING
103	MIF28.0213.0100	EARTH WIRES
104	MI02.05.92	SWITCH
105	MI23151-B001-0000	WATERPROOF CAP
106	MIGB/T845 ST5X19	SCREW ST5X19
107	MIF28.0111.0100	FAN CASE L/H
108	MIGB/T2671.2 M5X25	SCREW M5X25
109	MIGB/T97.1 M5	WASHER M5
110	MIGB/T93 M5	SPRING WASHER M5
111	MIF28.0112.0200	UPPER HANDLE GRIP
112	MISBC653KD.02.01-06	SPRING
113	MIF28.0111.0006	FIXED LINK
114	MIF28.0111.0013	SEAL
115	MIF28.0111.0010	PLATE WASHER
116	MIF28.0111.0009	FAN
117	MIF28.0111.0011	BLADE
118	MIGB/T6171 M8	M8 NUT - L/H
119	MIF28.0213.0200	SAFETY SWITCH - FRONT
120	MIF28.0111.0001	FAN CASE R/H
121	MIF28.0213.0300	SAFETY SWITCH - SIDE
122	MIGB/T845 ST5X16	SCREW ST5X16
123	MIF28.0111.0005	COVER
124	MIGB/T845 ST4X10	SCREW ST4X10
125	MIF28.0111.0004	SWITCH CONTACT
126	MIF28.0111.0008	COVER SPRING
127	MIF28.0211.0101	FAN COVER

Parts List

ID No.	Part Number	DESCRIPTION
128	MIF28.0211.0102	FAN COVER PLATE
129	MIF28.0114.0001	SUCTION TUBE - UPPER
130	MIF28.0114.0002	SUCTION TUBE - LOWER*
131	MIF28.0214.0001	BLOW TUBE - UPPER
132	MIF28.0114.0004	SAFETY GRILL
133	MIF28.0114.0003	BLOW PIPE - ROUND
134	MIF28.0115.0002	BLOW PIPE - FLAT
135	MIF28.0115.0200	COLLECTION ELBOW
136	MIF28.0115.0100	COLLECTION BAG*

*280BVX Only



EC Declaration of Conformity

We Mitox (Rochford Garden Machinery Ltd) - BA9 9RS (importer) declare that the product(s):

Designation: Petrol Blower / Blower Vacuum
Model(s): 260BX Premium / 280BVX Premium
Type/Serial No: As per rating label on machine

Complies with the following directive(s):
2006/42/EC machinery directive

The conformity assessment procedure followed was in accordance with:
EN15503:2009 / A1:2013

Notified Body:
Intertek Testing Services

Addesses:
Building No. 86, 1198 Qinzhou Road (North) Shanghai 200233, China

Measured Sound Power Level: 106.6 dB (A)
Guaranteed Sound Power Level: 109 dB (A)

Authorised Signatory and Technical File Holder
Date: 16/05/2016

Signature:

A handwritten signature in black ink, which appears to read "S. Anderson", is written over a horizontal line.

Name: Stewart Anderson
Position: Managing Director
Company: Mitox (Rochford Garden Machinery Ltd)
Address: Wincanton Business Park
Wincanton
Somerset
BA9 9RS



260BX Premium Blower
280BVX Premium Blower/Vacuum



260BX Premium Blower

280BVX Premium Blower/Vacuum

CONDITIONS OF WARRANTY

The manufacturer warrants the product against faulty materials and workmanship for a standard 1 year period and thereafter for the set period specific to each range from the date of purchase. Warranty does not extend to failure due to fair wear and tear.

SP	- 1 Year
SELECT	- 3 Years (Subject to yearly servicing)
PREMIUM	- 5 Years (Subject to yearly servicing)
PRO	- 5 Years Domestic / 3 Years Commercial (Subject to yearly servicing)

Extended warranty is subject to online registration and yearly servicing

SP, SELECT and PREMIUM ranges used for commercial purposes have a warranty period of 3 months from the date of purchase.

The manufacturer undertakes to replace, any spare parts that are classified as defective by an appointed Mitox service dealer. The manufacturer will not accept liability for the replacement of the machine, either partially or wholly, and /or consequential damages and /or interest charges either directly or indirectly.

Warranty does not cover failure due to:

Insufficient maintenance.

Incorrect fuel mixture and stale fuel.

Abnormal use or accidental damage.

Incorrect assembly, adjustment or operation of the product.

Spare parts that are subject to wear e.g. bag, blades, bearings, cables, guards, deflectors, spark plugs, air filters etc.

Neither does warranty extend to:

Freight and packing costs.

Use of non-genuine spare parts i.e. those from another manufacturer.

Use of the machine for any other purpose than that for which it was designed.

Use and maintenance of the machine in a manner not described in the owner's manual.

As part of our policy of continuous product improvement, we reserve the right to alter or amend this specification without notice. As a result, the product may differ from the information contained herein but any alteration will only be implemented without notice if it is classified as an improvement to the above specification.

READ THE MANUAL CAREFULLY BEFORE OPERATING THE MACHINE

When ordering spare parts, please quote the part number, this can be found in the parts list included in this manual.

Retain your proof of purchase without which no warranty can be offered.

Mitox Garden Machinery, Wincanton Business Park, Wincanton, Somerset, BA9 9RS