



Operator's Manual

user manual, maintenance instructions and spare parts

360UX, 460UVX Premium Brushcutter



Read this manual carefully before operating the machine

Original Instructions Version November 17

360UX/460UVX_1011171

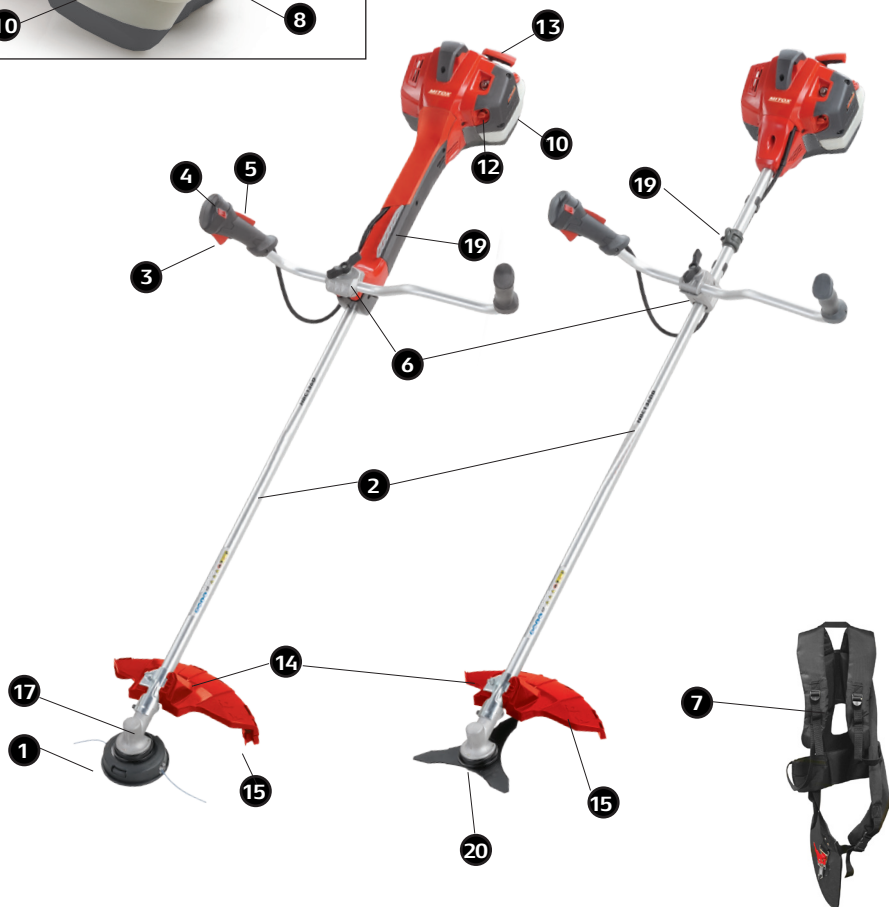

Component Location

1	NYLON CUTTING HEAD	Auto bump feed nylon cutting head.
2	DRIVE SHAFT	Contains the drive shaft.
3	THROTTLE TRIGGER	Spring loaded to return to idle when released.
4	IGNITION SWITCH	Slide switch, forward to run, back to stop.
5	SAFETY LEVER	Prevents accidental operation of the throttle.
6	HANDLE	This handle can be adjusted for maximum comfort
7	HARNESS ASSEMBLY	Fully adjustable for maximum comfort
8	PETROL CAP	
9	PURGE BULB	Push the purge bulb to remove the air from the fuel system.
10	FUEL TANK	Contains fuel and fuel filter
11	AIR CLEANER	Contains replaceable filter
12	CHOKE	To help in cold starting
13	STARTER HANDLE	Pull to start the engine
14	DEBRIS SHIELD	Helps protect the operator from debris
15	CUT-OFF KNIFE	Cuts the nylon line to the correct length
16	FRONT HANDLE	This handle can be adjusted for maximum comfort
17	GEARBOX	For attaching a blade or nylon head to
18	REAR HANDLE	Incorporating throttle trigger, switch, and safety lever
19	HARNESS FIXING POINT	Fixing point to attach the harness
20	METAL BLADE	Metal blade cutting head

Warnings in the Manual



This mark indicates instructions which must be followed in order to prevent accidents which could lead to serious bodily injury or death.















This mark indicates instructions which must be followed or it leads to mechanical failure, breakdown, or damage.

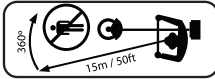

This mark indicates hints or useful directions in the use of the product.

Safety Symbols

Warning: Danger, Caution	
Read the documentation and safety instructions which are provided in this user manual.	
When operating this machine, use protective equipment such as goggles, helmet and ear defenders.	
Wear security shoes and gloves.	
Check the condition of working area to avoid any accident by hitting hidden obstacles such as stumps, stones, cans, or broken glass.	
Hot surface: Risk of burn.	
Danger: Risk of intoxication.	
Danger: Risk of fire or explosion	
Directive 2000-14/CE. Guaranteed noise levels	
Beware of objects being thrown from the operating zone	
Warning: Keep all people, animals and vulnerable objects at least 15 metres from the working area.	

Never modify the cutter in any way. Improper use of any cutter can cause serious or fatal injury.	
Beware of blade thrust	

Taking Care of Warning Labels

Always keep warning labels clean and free of scratches, which might make them illegible or difficult to read. If the warning labels provided with your Brushcutter become damaged, peel off, or otherwise become illegible or difficult to read, order new labels from the authorised servicing dealer and replace the damaged labels. When applying new labels, first wipe away any dirt and dry the surface before applying the new label in the same place as the original label.

Explanation of Symbols on the Machine

For safe operation and maintenance, symbols are carved in relief on the machine:

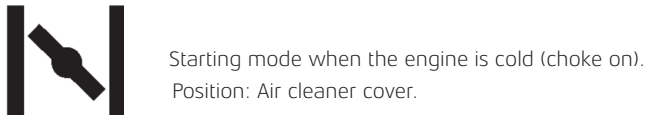
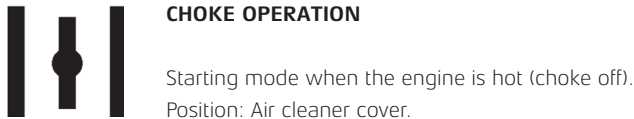
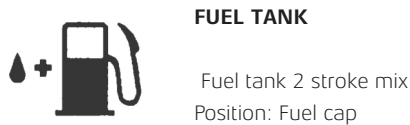

Safety Precautions

Introduction

Read this Owner/Operator Manual carefully. Be sure you understand how to operate this Brushcutter properly before you use it. Failure to do so could result in serious injury.

Keep this manual handy so that you may refer to it later whenever any questions arise. Also note that you are able to contact the dealer from whom you purchased the product for assistance.

Always include this manual when selling, lending, or otherwise transferring the ownership of this product.

This product has been designed to be used as a Brushcutter power tool as described previously and it should never be used for any other purpose; doing so could result in unforeseen accidents and injuries occurring. Only approved Mitox accessories should be used with this product.

This Brushcutter is equipped with extremely sharp blades, always wear sturdy gloves when handling the blades and fit the safety guards when not in use.

When using this Brushcutter for the first time, take the Brushcutter to a wide, clear, open space, start the engine, and practice handling the Brushcutter until you are sure that you will be able to handle it properly in actual operation.

You should never use this Brushcutter when under the influence of alcohol, suffering from exhaustion or lack of sleep, suffering from drowsiness as a result of having taken medicine, or at any other time when your judgement might be impaired or that you might not be able to operate the Brushcutter properly and in a safe manner.

Never allow children or anyone unable to fully understand the directions given in this manual to use this Brushcutter

When planning your work schedule, allow plenty of time to perform the work and allow plenty of time for rest. Limit the amount of time you continuously use the Brushcutter to 30~40 minutes per session and take 10~20 minutes of rest between work sessions. Also, try to keep the total amount of work performed in a single day to 2 hours.

Never run the engine indoors as the exhaust gases contain harmful carbon monoxide.

Never use the Brushcutter in conditions as described below:

When the ground is slippery or when other conditions exist which might make it difficult to maintain a steady posture while using the Brushcutter.

At night, at times of heavy fog, or at any other times when your field of vision is limited and it would be difficult to gain a clear view of the area where the Brushcutter is to be used. In heavy rain, during lightning storms, at times of strong or gale-force winds, or at any other times when weather conditions might make it unsafe to use this product.

Lack of sleep, tiredness, or physical exhaustion results in lower attention spans, and this in turn can lead to accidents and injury.

Work Clothing and Safety Equipment

When using the product, you should wear proper clothing and protective equipment.

- Helmet
- Protection goggles or face protector
- Ear protectors
- Thick work gloves
- Non-slip sole work boots
- When using your Brushcutter, always wear strong, durable, work clothing; shirts should be long-sleeved and trousers should be full-length.

Safety and Operation



This Brushcutter is equipped with a very sharp blade, and when used incorrectly the blade can be extremely dangerous.

Improper handling can cause accidents which may in turn lead to serious injury or death. For

this reason, you should always be careful to adhere to the following instructions when using your Brushcutter.

Never hold the Brushcutter in a way in which the cutting head is pointing towards someone else.

Never allow the blade to come into contact with your body.

Always turn off the engine before adjusting the Brushcutter, or at any time when coming into close proximity with the cutting head.

Always wear thick work gloves when adjusting the Brushcutter.

Safe Handling of Fuel



The engine of the Brushcutter is designed to run on a two stroke oil/fuel mixture.

This fuel is highly flammable, never store cans of fuel or refill the fuel tank in any place where there is a source of heat or fire, which might ignite the fuel.

Do not smoke whilst operating the Brushcutter or refilling, keep lit cigarettes away from the Brushcutter at all times.

When refilling the fuel tank always stop the engine first and carefully make sure that there are no sparks or naked flames anywhere nearby before refuelling.

If any fuel spillage occurs during refuelling, use a dry rag to wipe any fuel which has been spilled onto the Brushcutter before starting the engine.

After refuelling, screw the fuel cap back tightly onto the fuel tank and carry the Brushcutter to a spot 5 metres or more away from where it was refuelled before starting the engine.

Before Operating the Brushcutter

Before beginning work, carefully check the work area and remove any obstacles. Within a perimeter of 15 metres of the work area should be considered a hazardous area into which no-one should enter while the Brushcutter is being used, and when necessary this area should be marked with a warning rope, warning signs, or other forms of warning.

When work is to be performed simultaneously by two or more operators, care should also be taken to constantly look around to check the presence and locations of other operators within the work area to maintain a safe distance between each operator.

Before beginning work, each component of the Brushcutter should be checked to make sure that it is in proper working order, make sure that there are no loose screws or bolts, fuel leaks, ruptures, dents, broken guards or any other problems which might interfere with safe operation.

Keep all parts of your body away from the cutting head when the engine is running.

Before Starting the Engine

Carefully check the work area to make sure that no obstacles exist within a perimeter of 15 metres around the Brushcutter before starting the engine.

To start the engine, place the Brushcutter onto the ground in a flat clear area and hold it firmly in place to ensure that neither the cutting head nor the throttle come into contact with any obstacles when the engine starts.

After starting the engine, make sure that the cutting head stops moving when the throttle trigger is released (idle). If the cutting head continues to move when the engine is at idle, adjust the idle screw on the carburettor to a point where the cutting head stops moving, if this cannot be achieved, take the Brushcutter to your authorised service dealer for adjustment.

Avoid Noise Problems

Check and follow the local regulations for sound levels and hours of operation for garden machinery.

In general, operate Brushcutters between 8 am and 5 pm on weekdays and 9 am to 5 pm at weekends.

Avoid using the Brushcutter late at night and/or early in the morning.

Safety when using the Brushcutter

When using the Brushcutter, grip the handles firmly with both hands, place your feet slightly apart so your weight is distributed evenly across both legs, and always maintain a steady even posture while working.

- Maintain full engine speed when cutting.
- Never allow other persons to come within the work area as doing so might expose them to danger.
- Keep work area clear of all persons, particularly small children and pets. Injury may result from flying debris.
- If grass or other objects get caught in the Brushcutter during operation, always stop the engine before removing the object.
- Never touch the spark plug or plug HT cable while the engine is in operation, doing so may result in an electrical shock.
- Never touch the exhaust, spark plug, or any metallic parts while the engine is in operation or immediately after shutting down the engine. These parts reach high temperatures during operation and doing so could result in serious burns.
- When you finish cutting in one location and wish to continue work in another area, stop the engine.
- Always remove fuel from the fuel tank before transportation to prevent fuel spillage.
- Never leave the Brushcutter exposed to direct sunlight as this can heat the fuel tank and may cause a discharge of fuel, and flood the engine.
- Be careful not to hit the nylon cutting head against stones or the ground.



Two-Stroke Fuel



Fuel is very flammable. Do not smoke or bring any flame or sparks near fuel.

Always stop the engine and allow it to cool before refuelling.

Refuel outdoors on bare ground, restart engine at least 5m away from the refuelling stop.

The engine is lubricated by oil mixed into petrol. Prepare a mixture of unleaded petrol and semi-synthetic two-stroke oil that meets the specifications of: API TC, ISO-L-EGC, JASO FC (Low Smoke) oil.

Recommended mixing ratio is 40:1

FUEL WITH NO OIL (RAW PETROL) will cause severe damage to the engine which is not covered by manufacturer's warranty.

Use fresh, unleaded petrol (95 RON) and semi-synthetic oil specially made for high performance two-stroke engines. Mix in a ratio of 40 parts petrol to 1 part of oil.

By using two-stroke oil specially made for two-stroke engines you will reduce the formation of ash and carbon deposits on the spark plug, piston, exhaust muffler and cylinder as well as reducing emissions of harmful exhaust gases.

Oil FOR 4-CYCLE ENGINES should not be used as two-stroke lubrication oil as it can cause fouling of the spark plug, exhaust port blocking, piston ring sticking and other internal engine damage.

NOTE

Due to increased Ethanol content in petrol we recommend the use of B3C Ethanol Shield 2-Stroke Oil, and Ethanol Shield Fuel Stabiliser to protect your MITOX® engine against the harmful effects of Ethanol.

www.b3cfuel.co.uk



Fuel Storage

Mixed two-stroke fuel which has been left unused for a period of one month or more may damage the carburettor and result in the engine failing to start or operate correctly.

When storing the Brushcutter for a period of more than one month, empty the fuel tank, and run the engine to empty the carburettor of fuel.

Two stroke fuel can cause deterioration of rubber and/or plastic components during prolonged storage.

It is important to only use good quality, fresh fuel mix.

Fuelling

Shake the fuel container to thoroughly mix the two-stroke oil and petrol.

Clean dirt from around the fuel cap before removing.

Pour two-stroke fuel into the fuel tank with a filtered funnel, up to 80% of the fuel tank's capacity.

Replace the fuel cap and tighten securely. Spilled fuel must be wiped away from the Brushcutter before starting the engine.

Move at least 5m away from the refuelling area before restarting the engine.



When refilling the tank, always turn off the engine and allow it to cool down. Take a careful look around to make sure that there are no sparks or open flames anywhere nearby before refuelling.

Assembly of the Brushcutter



The blade fitted to the guard is sharp and can cause injury, always wear gloves.

The guard extension shall always be fitted when using the trimmer head. The guard extension shall always be removed when using the grass blade.

Installing the Guard

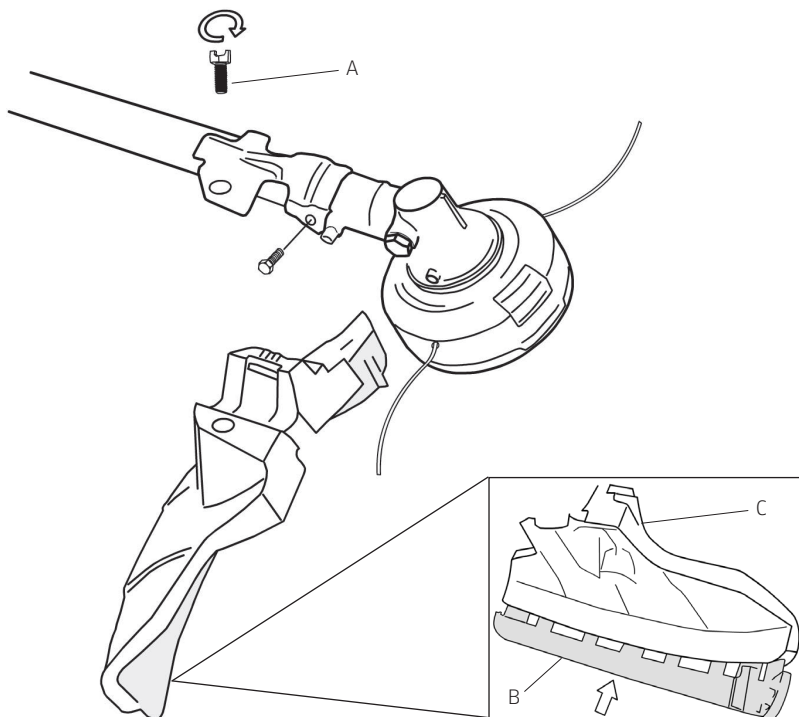

- Hook the blade guard/combination guard onto the fitting on the shaft and secure with special bolt (A).
- Guide the lower guard extension pegs (B) into the slots of the upper guard (C), then Secure by clicking (B) into (C).

Installing the 3 Tooth Blade

Lay the Brushcutter on its back with the gearbox shaft facing up.

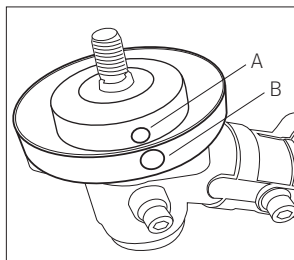

Rotate the gear box shaft until the hole in the holder (a) lines up with the slot in the metal guard (b).

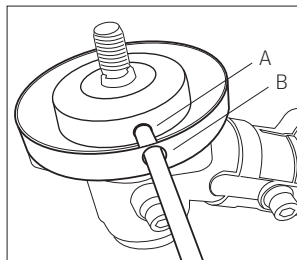

Insert an Allen key or screwdriver into the hole in the gearbox cover (a) and into holder (b).

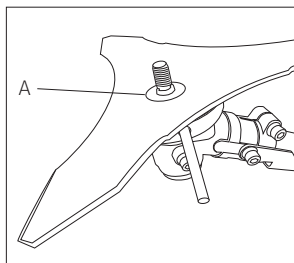

Place the 3 tooth blade on the holder (a), centring the blade on the raised centre.

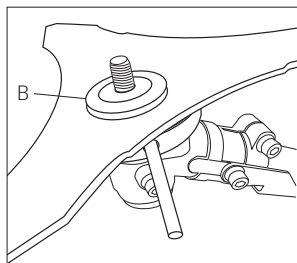

Fit the holder (b) over the blade.

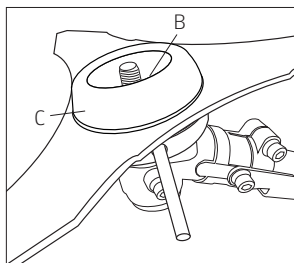

Fit the domed nut protector (c) over holder (b) and the blade.

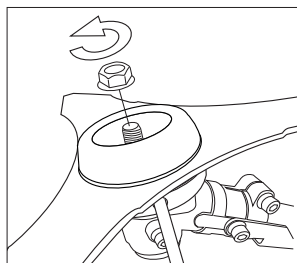

Fit the nut anti-clockwise (turn left) and tighten using the spanner provided. Remove the Allen key / screwdriver.



THE BLADE MUST BE CORRECTLY POSITIONED ON THE UPPER BLADE CLAMP OTHERWISE SERIOUS DAMAGE AND INJURY TO PERSONS AND PROPERTY COULD RESULT.

Installing the Nylon Head

Lay the Brushcutter on its back with the gearbox shaft facing up.

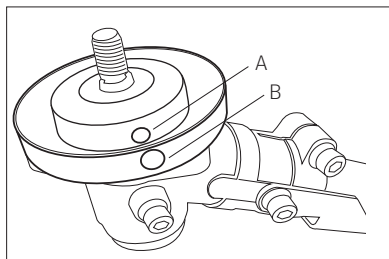

Rotate the gear box shaft until the hole in the holder (a) lines up with the slot in the metal guard (b).

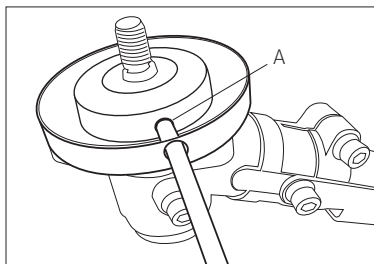

Insert an Allen key or screwdriver into the hole in the gearbox cover and into holder (a).

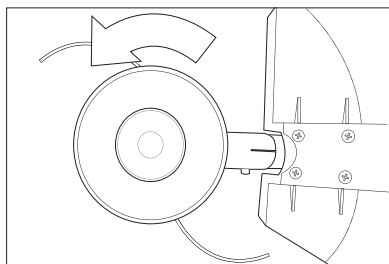

Screw the nylon head anti-clockwise (turn left) onto the threaded shaft on the end of the gearbox.

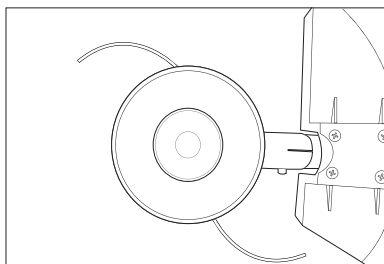

Make sure that the nylon head is securely locked in position and remove the Allen key.



Using the Brushcutter

Choosing the cutting device

Choose the most suitable cutting device for the job to be done, according to these general indications:

- The cutting line head can eliminate tall grass and non-woody vegetation
- The 3-point blade is suitable for cutting brushwood and small shrubs up to 2 cm in diameter.

Nylon Head

- Cut the grass in 1.5 metre widths, keeping the machine well balanced.
- Avoid engaging stones, piles of earth, small pieces of wood or anything that could be hidden or difficult to see in the grass. If a large object is accidentally struck, if the cutting head gets blocked, overloaded or stringy material gets wrapped in the cutting head, reduce the engine speed so the engine idles. Make sure that the cutting head has stopped rotating switch off the engine and remove the material.
- Put the Brushcutter on the ground and check that the cutting head has not been damaged. If necessary, change the cutting head. If the head is only wrapped by vegetation, remove by hand and clean the cutting head.
- Always wear safety gloves for this operation and ensure the engine is switched off and the head is stationary.
- When the 2 nylon cords become too short, accelerate the engine and bump the nylon head on the ground. Automatically the 2 nylon cords will feed out and be cut to the correct length. Repeat the operation if necessary.

3-Point Blade

- Start cutting above the undergrowth and then move down with the blade so as to cut the brush into small pieces.
- Avoid hitting stones, piles of earth, small pieces of wood or anything that could be hidden or difficult to see in the grass.

Installing the U Handle Assembly (460UVX)

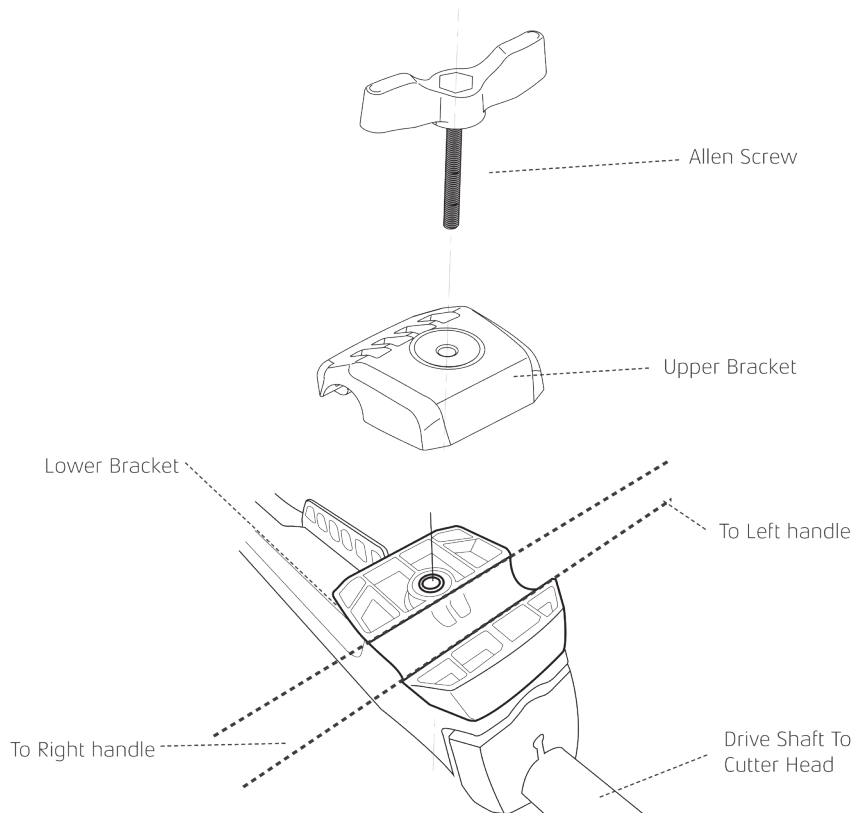

- Remove the upper bracket from the assembly by undoing the Lockscrew.
- Install the U handle assembly, reassemble the bracket assembly and secure using the Lockscrew.
- Ensure that the controls are located on the right and adjust the handle for maximum comfort before securing.

Installing the U Handle Assembly (360UX)

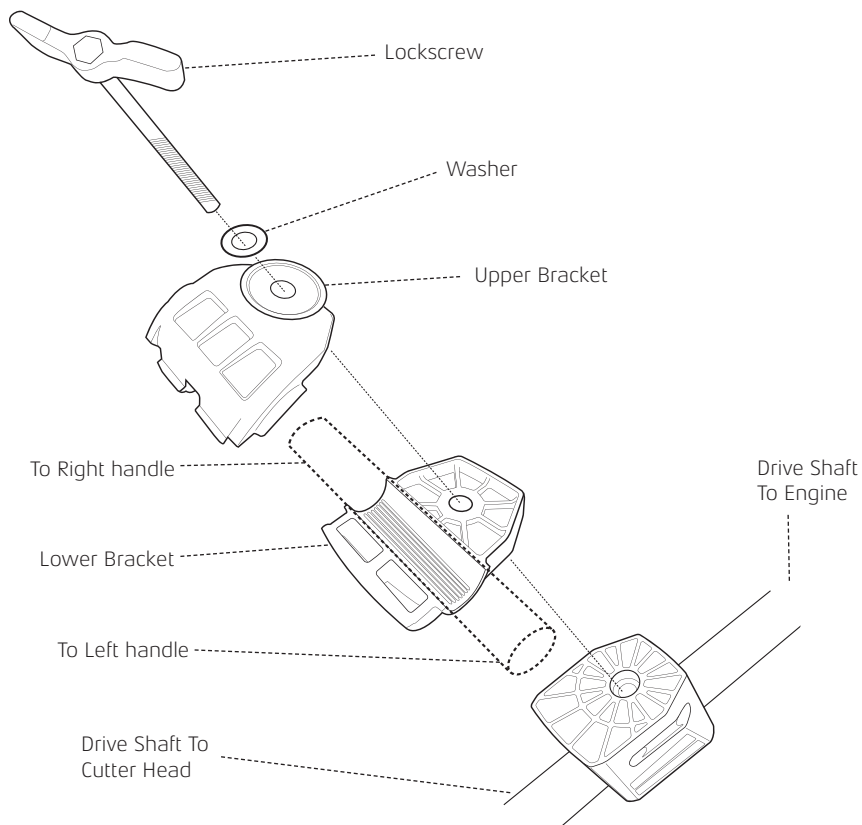

- Remove the upper bracket from the assembly by undoing the Lockscrew.
- Install the U handle assembly, reassemble the bracket assembly and secure using the Lockscrew.
- Ensure that the controls are located on the right and adjust the handle for maximum comfort before securing.

Operation



Keep clear of the cutter head as it may start moving when the engine starts.

Starting the Engine

CAUTION do not pull the starter cord all the way out and do not let go of the starter handle when the cord is extended, this can damage the starter mechanism.

The switch will automatically return to the 'On' position. Wait 10 seconds before attempting to restart the engine to allow the switch to reset

Cold Engine Starting

Rest the unit on a flat, firm surface. Keep the cutting head off the ground and clear of surrounding objects as it may start moving when starting the engine.

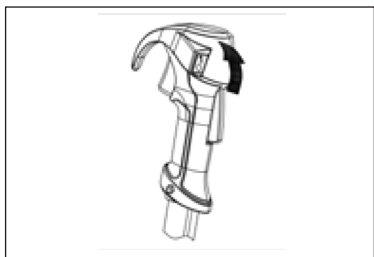

a). Starting: Ignition Switch automatically set in the (I) position.

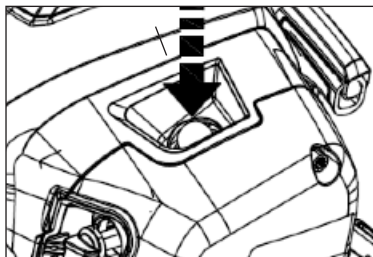

b). Primer bulb: Press the primer bulb repeatedly until fuel begins to fill the bulb. The bulb need not be completely filled.

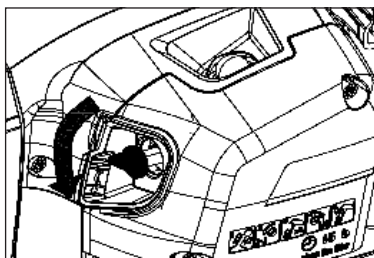

c). Choke: Set the choke lever in the choke (N) position (on front of engine)

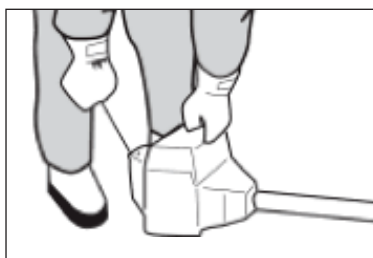

d). While holding the unit, pull out the starter rope firmly until engine fires (indicated by a 'cough' from the engine).

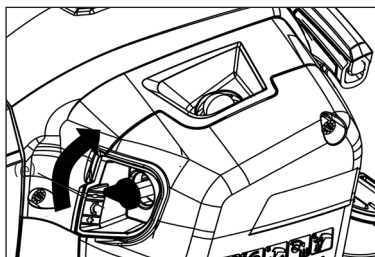

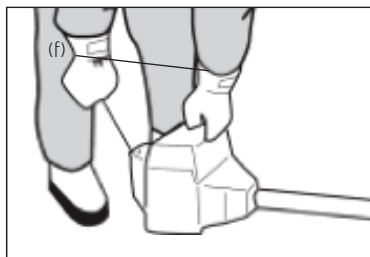

e). Move the choke lever to the open () position.



f). Repeat pulling the cord until the engine starts. When the engine starts, allow the engine to warm up with the throttle pulled slightly.

Allow the engine to warm up before use. When cutting, always use the Brushcutter on full throttle.

Hot Engine Starting

- Set the ignition switch to the START (I) position.
- Check the clear return fuel line. If the line is empty, push the air purge bulb until fuel is visible in the clear return fuel line.
- Move the choke lever to the closed () position, then back to the open () position. This will set the throttle to the hot start position.
- Pull the starter rope until the engine starts, then squeeze the throttle briefly to release the fast idle control and return the engine to idle.
- If the engine does not start after 5 pulls, use the Cold Start procedure.

Overchoking

Should the engine become flooded due to overchoking, turn the ignition switch off, unscrew the spark plug, wipe it dry or replace.

Stopping the Engine



NOTE

Switch automatically set in the "I" position.

Set the engine to idling by releasing the throttle lever.

Set the ignition switch to the off position "O" (STOP).

If the engine fails to stop, set the choke lever to the closed position to stall the engine; do not use the machine until the ignition switch is repaired.

Running In

During the first ten hours of work, avoid running the engine at maximum speed for a prolonged period until all the components have bedded in, after the engine has been run in, it will reach its maximum power.

Transportation

Never transport the Brushcutter with the engine running. An engine that is running could be accidentally accelerated causing the blade to engage.

Make sure the blade safety guards are in place when transporting the Brushcutter.

When carrying by hand, the cutting head should be pointing backwards.

Ensure the Brushcutter is secure when transporting in a vehicle and the tank is drained of fuel.

Maintenance

IMPORTANT

After every use, check that all nuts, bolts and screws are securely fastened and tighten if necessary.

In the event of an accident, breakdown or blockage, ensure the engine is turned off before any work is carried out to rectify this.

Make sure the engine has stopped and is cool before performing any service to the machine.

Contact with moving cutting head or hot muffler may result in a personal injury.

Fuel Filter

Every 15 hours of operation, using a wire hook, take the fuel filter from the fuel tank and clean or replace with a new fuel filter.

Spark Plug

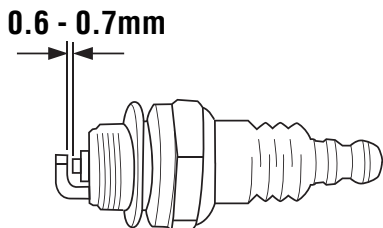

Poor starting or misfiring is often caused by a fouled or defective spark plug, clean and reset the gap to 0.65 mm, or replace the spark plug with RCJ7Y (Champion) as necessary.

Air Filter

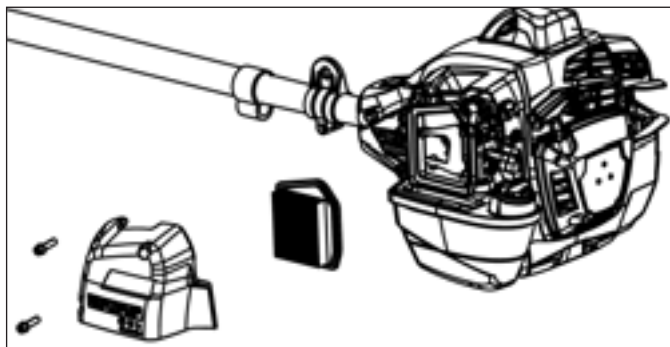

Images are for illustrative purposes only.

The air filter must be regularly cleaned to remove dust and dirt in order to avoid:

- Carburettor
- Starting problems
- Loss of engine power
- Unnecessary wear to engine parts
- Excessive fuel consumption

Clean the filter every 25 hours, or more regularly if conditions are exceptionally dusty.

Carburettor

The carburettor is adjusted at the factory; if adjustment is required it must be performed by your authorised Mitox dealer.



If the head rotates at idle speed, stop the machine and return it to your authorised Mitox dealer for repair.

Safety Lock

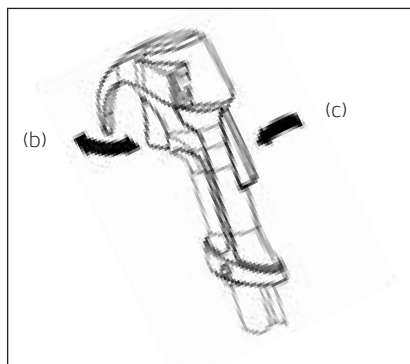

The safety lock is to prevent the throttle lever from accidentally being engaged. The throttle lever (b) can only be pressed in if the safety lock (c) is held down. Check if the safety lock and throttle lever returns to its original position and the engine returns to idling when you release your hand from the handle.

Any defects contact your nearest service agent for repairs before using the machine.

Storage

- Remove the spark plug; pour a small amount of oil into the cylinder. Rotate the crankshaft several times using the starting rope in order to distribute the oil. Put the spark plug back in.
- Remove the fuel from the machine.

Gear Case

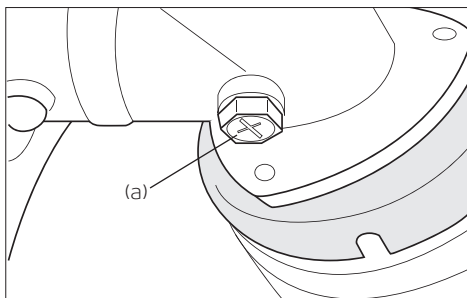

- Remove the bolt (a) on the gear case, top up the gearbox using Lithium grease and refit the bolt, every 15 hours use.

Replacing the Nylon Cord

Check to see if the nylon head is damaged before replacing the cord. If you can see serious traces of wear or damage, you must replace the complete nylon head.

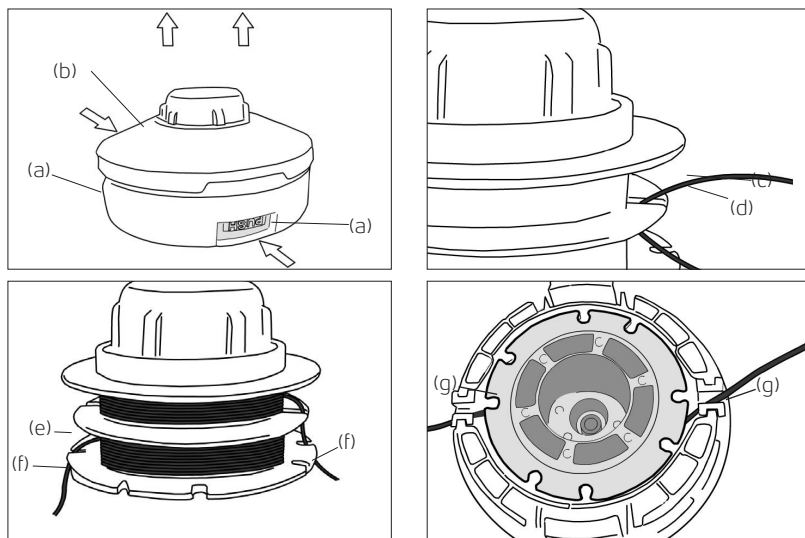

Images are for illustrative purposes only. Actual head design may vary, however the method remains the same.

1. Stop the engine.
2. Open the nylon head by pushing on the catch, (a), and lifting the cover (b).
3. Pull the bobbin out of the nylon head and take out the rest of the nylon cords.
4. Cut a new length of cord, 2.4mm Ø and 5 metres long.
5. Fold the new cord in half and place the centre of the fold (c) into the clip (d) in the empty bobbin.
6. Wind the line in the direction of the arrows on the bobbin, with half of the line above and half below the divider (e). Maintain an even and firm tension onto the bobbin, being careful not to twist the line.
6. After winding the cord, insert both ends into the notches on the bobbin, (f).
7. Put the filled bobbin back into the carrier. Release the cords from the notches in the bobbin and thread them into the eyelets in the carrier (g). The cords should stick out approx 15 cm either side.
8. Refit the spool cover (b), ensuring it is securely clicked into place.

Never use a cutting device other than those supplied by the manufacturer. (Steel cord is never allowed) Always use original spare parts in order to benefit from continuous warranty.

Troubleshooting

Engine will not start, power loss:

- Check that the fuel tank is not empty. Fill with mixed fuel.
- The fuel does not reach the carburettor. Change the fuel filter in the fuel tank.
- There is water in the fuel. Drain and clean the fuel system.
- The air filter is dirty. Clean or replace the air filter.
- There are carbon deposits in the exhaust muffler restricting the engine. Clean or change the muffler.
- Spark plug is worn. Replace spark plug.

Maintenance Timescale

The following intervals apply to normal operating conditions only. If your daily working time is longer or operating conditions are difficult (very dusty work area, etc.), shorten the specified intervals		Before starting working	After finishing work daily	Weekly	Monthly	Every 12 months	If problem	If damaged	If required
Complete machine Control handle	Visual inspection (condition, wear, leaks)	*		*					
	Clean		*						
Control handle	Check operation	*		*					
Air filter	Clean				*		*		*
	Replace							*	*
Filter in fuel tank	Check						*		
	Replace filter					*		*	*
Carburettor	Adjustments by Mitox Dealers only								
Spark plug	Readjust electrode gap						*		
	Replace after 100 hours of operation								
Cooling inlets	Clean								*
All accessible screws	Check	*					*		
	Retighten	*							*
Anti-vibration elements	Check	*					*		*
	Replace							*	
Safety labels	Replace							*	
Muffler	Clean						*		

Specifications

Model	360UX PREMIUM	460UVX PREMIUM
Capacity	36.3 cm ³	46.5 cm ³
Power	1.6 kw	1.95 kw
Weight (without fuel, harness, cutting attachment and guard)	8.2 kg	8.7 kg
Maximum engine rotation speed	9500 for grass trimmer, 10500 for brush cutter min -1	10000 for grass trimmer, 10500 for brush cutter min -1
Speed of output shaft	7340 for grass trimmer, 8150 for brush cutter	7750 for grass trimmer, 8150 for brush cutter
Idling speed	3000 ± 400	
New Shaft	Straight	Straight
Handle	Bike	Full AV Bike
Spark plug	CHAMPION RZ7C	
Mixture (petrol: 2-stroke oil)	40:1	
Fuel tank capacity	1000 ml	
Measured acoustic power level	110.3 dB(A)	111.7 dB(A)
Measurement uncertainty	3	3
Acoustic power level guaranteed	114	
Vibration level - Nylon Head - Left handle - Right handle Measurement uncertainty	4.64 m/s ² 4.53 m/s ² 1.5 m/s ²	4.36 m/s ² 3.12 m/s ² 1.5 m/s ²
Vibration level - Metal Blade - Left handle - Right handle Measurement uncertainty	4.79 m/s ² 5.18 m/s ² 1.5 m/s ²	4.17 m/s ² 2.63 m/s ² 1.5 m/s ²

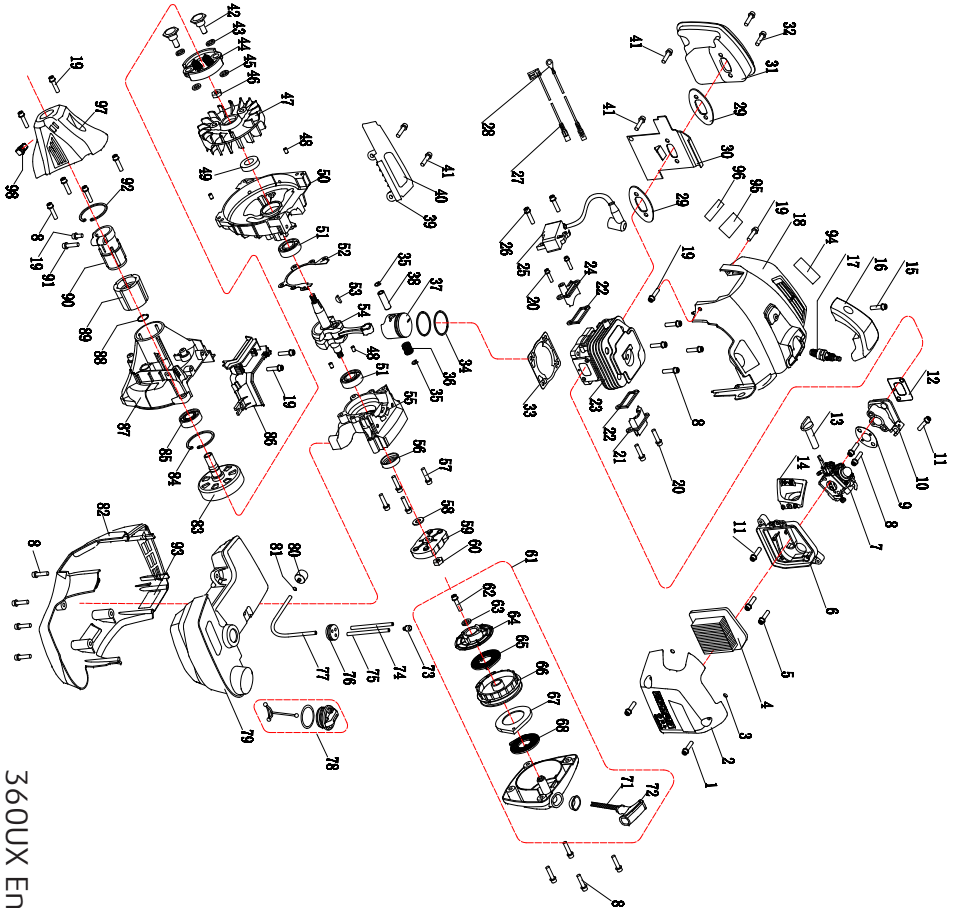

360UX Engine Diagram

360UX Parts - Engine Unit

ID	PART NUMBER	DESCRIPTION			
1	MIC36.1104.0001	SCREW	28	MIC36.1106.0302	WIRE B
2	MIC36.1104.0002	AIR FILTER COVER	29	MIC36.1101.0006	MUFFLER GASKET
3	MIGB/T3452.1 3.63X2.62	O-RING	30	MIC36.1101.0007	HEAT SHIELD
4	MIC36.1104.0200	AIR FILTER	31	MIC36.1105.0000	MUFFLER
5	MIGB/T2671.2 M5X45	SCREW M5X45	32	MIGB/T2671.2 M6X60	SCREW M6X60
6	MIC36.1104.0004	AIR FILTER BASE	33	MIC36.1101.0005	CYLINDER GASKET
7	MIC36.1101.0100	CARBURETOR	34	MIC36.1103.0002	PISTON RING
8	MIGB/T2671.2 M5X25	SCREW M5X25	35	MIA38.0303.0003	PISTON PIN CIRCLIP
9	MIA38.0301.0010	CARB GASKET	36	MIC43.0103.0300	BEARING
10	MIC36.1101.0200	MANIFOLD	37	MIC36.1103.0001	PISTON
11	MIGB/T845 ST4X10	SCREW ST4X10	38	MIC36.1103.0003	PISTON PIN
12	MIC36.1101.0002	INLET GASKET	39	MIC36.1101.0008	TANK GUARD
13	MIC36.1101.0101	CHOKE LEVER	40	MIA62.0113.0005	HEAT INSULATION
14	MIC36.1104.0005	COVER	41	MIGB/T2671.2 M5X16	SCREW M5X16
15	MI01.014111	SCREW ST4.8X14	42	MIC36.1101.0010	CLUTCH BOLT
16	MIC36.1101.0003	SPARK PLUG COVER	43	MIGB/T755 M10	WASHER M10
17	MIA45.0806.0400	SPARK PLUG	44	MIC36.1101.0501	CLUTCH ASSEMBLY
18	MIC36.1101.0400	ENGINE COVER	45	MIC43.0101.0009	FLAT WASHER
19	MIGB/T2671.2 M5X14	SCREW M5X14	46	MIGB/T6187 M8	FLANGE NUT M8
20	MIGB/T2671.2 M4X14	SCREW M4X14	47	MIC36.1106.0100	FLYWHEEL
21	MIC36.1101.0303	REAR COVER	48	MIGB/T119 B5X10	PIN 5X10
22	MIC36.1101.0304	GASKET	49	MIC43.0101.0300	OIL SEAL
23	MIC36.1101.0301	CYLINDER	50	MIC36.1102.0002	CRANKCASE LH
24	MIC36.1101.0302	FRONT COVER	51	MIGB/T276 6202	BEARING 6202
25	MIC36.1106.0200	IGNITION COIL	52	MIC36.1102.0003	CRANKCASE GASKET
26	MIGB/T2671.2 M5X20	SCREW M5X20	53	MIGB/T1099 3X5X13	KEY
27	MIC36.1106.0301	WIRE A	54	MIC36.1103.0100	CRANKSHAFT ASSEMBLY
			55	MIC36.1102.0001	CRANKCASE RH
			56	MIA38.0302.0200	OIL SEAL
			57	MIGB/T2671.2 M5X30	SCREW M5X30

360UX Parts - Engine Unit

ID	PART NUMBER	DESCRIPTION	ID	PART NUMBER	DESCRIPTION
58	MIGB/T97.1 M8	FLAT WASHER M8	89	MIC45.6808.0001	AV RUBBER
59	MIC36.1101.0600	PAWL ASSEMBLY	90	MIC45.6808.0002	CLAMP
60	MIGB/T6175 M8	NUT M8	91	MIGB/T2671.2 M6X25	SCREW M6X25
61	MIC36.1110.0000	STARTER ASSEMBLY	92	MIGB/T893.1 45	CIRCLIP 45
62	MIGB/T2672 M5X14	SCREW M5X14	92	MIC36.1101.0013	HEAT INSULATION
63	MIGB/T96 M5	PLATE WASHER M5	93	MIC36.1101.0014	HEAT INSULATION A
64	MIC43.2110.0006	RATCHET WHEEL	94	MIC36.1101.0015	HEAT INSULATION B
65	MIC36.1110.0005	SPRING	95	MIC36.1101.0016	HEAT INSULATION C
66	MIC43.2110.0003	RECOIL PULLEY	96	MIC36.1101.0011	HOUSING SLEEVE
67	MIC43.2110.0004	SPRING HOUSING	97	MIC36.1111.0106	CABLE CLIP
68	MIA36.0110.0003	RECOIL SPRING	98	C36.1111.0106	CABLE CLIP
71	MIA45.0110.0006	STARTER ROPE			
72	MIA41.1110.0003	STARTER GRIP			
73	MIA45.0111.0200	TANK VENT			
74	MIC36.1107.0003	VENT PIPE			
75	MIC36.1107.0002	RETURN PIPE			
76	MIC43.1107.0003	TANK GROMMET			
77	MIC36.1107.0001	FUEL PIPE			
78	MIA42.1111.0300	TANK CAP ASSEMBLY			
79	MIC36.1107.0000	FUEL TANK ASSEMBLY			
80	MIA38.0311.0500	FUEL FILTER			
81	MIA45.0102.0103	CLAMP			
82	MIC36.1101.0009	FUEL TANK HOUSING			
83	MIC36.1108.0100	CLUTCH DRUM			
84	MIGB/T893.1 35	CIRCLIP 35			
85	MIGB/T276 6202-2RSP5	BEARING 6202-2RS			
86	MIC36.1101.0004	PLATE			
87	MIC36.1108.0001	CLUTCH DRUM HOUSING			
88	MIGB/T894.1 15	CIRCLIP 15			

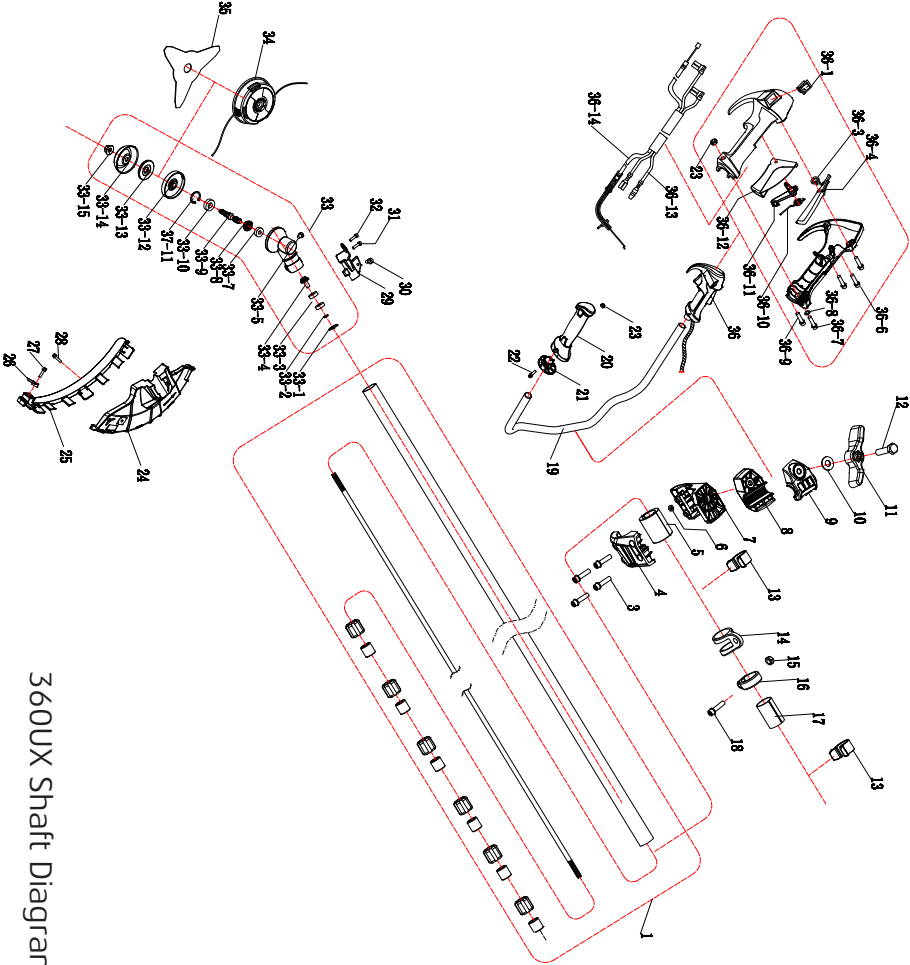

360UX Shaft Diagram

360UX Parts - Shaft Assembly

ID	PART NUMBER	DESCRIPTION			
1	MIC36.1800.0100	SHAFT ASSEMBLY	30	MIC43.2113.0307	LOCK SCREW
3	MIGB/T2671.2 M5X20	SCREW M5X20	31	MIGB/T2671.2 M6X25	SCREW M6X25
4	MIC27.6111.0203	LEFT CLAMP	32	MIGB/T2671.2 M6X12	SCREW M6X12
5	MIC27.6111.0206	AV RUBBER	33	MIC43.B116.0000	GEAR CASE ASSEMBLY 26MM
6	MIGB/T41 M8	NUT M8	33-1	MIGB/T893.1 28	CIRCLIP 28
7	MIC27.6111.0204	RIGHT CLAMP	33-2	MIGB/T894.1 12	CIRCLIP 12
8	MIC27.6111.0202	LOWER CLAMP	33-3	MIGB/T276 6001-2Z	BEARING 6001-2Z
9	MIC27.6111.0201	UPPER CLAMP	33-4	MIC48.B116.0002	PINION
10	MIGB/T96 M8	WASHER M8	33-5	MIGB/T5781 M6X8	SCREW M6X8
11	MIC27.6111.0205	LOCK KNOB	33-7	MIGB/T276 6000-2Z	BEARING 6000-2Z
12	MIGB/T5782 M8X60	SCREW M8X60	33-8	MIC43.B116.0004	GEAR
13	MIC43.1100.0003	CABLE CLIP	33-9	MIC43.B116.0003	GEAR SHAFT
14	MIC33.2112.0204	HARNESS LOOP	33-10	MIGB/T276 6002- 2RSP5	BEARING 6002-2RS
15	MIGB/T6170 M5	NUT M5	33-11	MIGB/T893.1 32	CIRCLIP 32
16	MIC33.2112.0203	CLAMP	33-12	MIC43.B116.0006	HOLDER A
17	MIC33.2112.0201	SUPPORT	33-13	MIC43.B116.0005	HOLDER B
18	MIGB/T2671.2 M5X22	SCREW M5X22	33-14	MIC43.B116.0007	PROTECTOR
19	MIC43.2111.0001	HANDLE TUBING	33-15	MIGB/T6177.2 M10X1.25	FLANGE NUT M10X1.25
20	MIC43.2111.0201	GRIP	34	MI TBC	NYLON HEAD AS- SEMBLY
21	MIC43.2111.0202	CLAMP	35	MIC43.1100.0001	BLADE
22	MIGB/T2671.2 M5X45	SCREW M5X45	36	MIC36.1111.0300	THROTTLE CONTROL ASSEMBLY
23	MIGB/T56 M5	NUT M5	36-1	MIC43.1111.0700	SWITCH
24	MIC24.0113.0101	UPPER GUARD	36-3	MIC36.1111.0107	SAFETY LEVER SPRING
25	MIC24.0113.0105	LOWER GUARD	36-4	MIC43.2111.0106	LOCK TRIGGER
26	MIC24.0113.0104	CUTTING BLADE	36-6	MI01.01.3121	SCREW ST4X14
27	MIGB/T6564 ST4.2X13	SCREW ST4.2X13	36-7	MIGB/T2671.2 M5X35	SCREW M5X35
28	MIC43.2113.0309	SCREW ST4.8X19			
29	MI00.06.04.106	GUARD CLAMP			

360UX Parts - Shaft Assembly

36-8	MIGB/T97.1 M5	WASHER M5
36-9	MIGB/T845 ST3.5X9.5	SCREW ST3.5X9.5
36-10	MIC36.1111.0108	TRIGGER SPRING
36-11	MIC43.2111.0104	ROD
36-12	MIC43.2111.0103	TRIGGER
36-13	MIC36.1111.0302	WIRE ASSEMBLY
36-14	MIC36.1111.0301	THROTTLE CABLE AS- SEMBLY

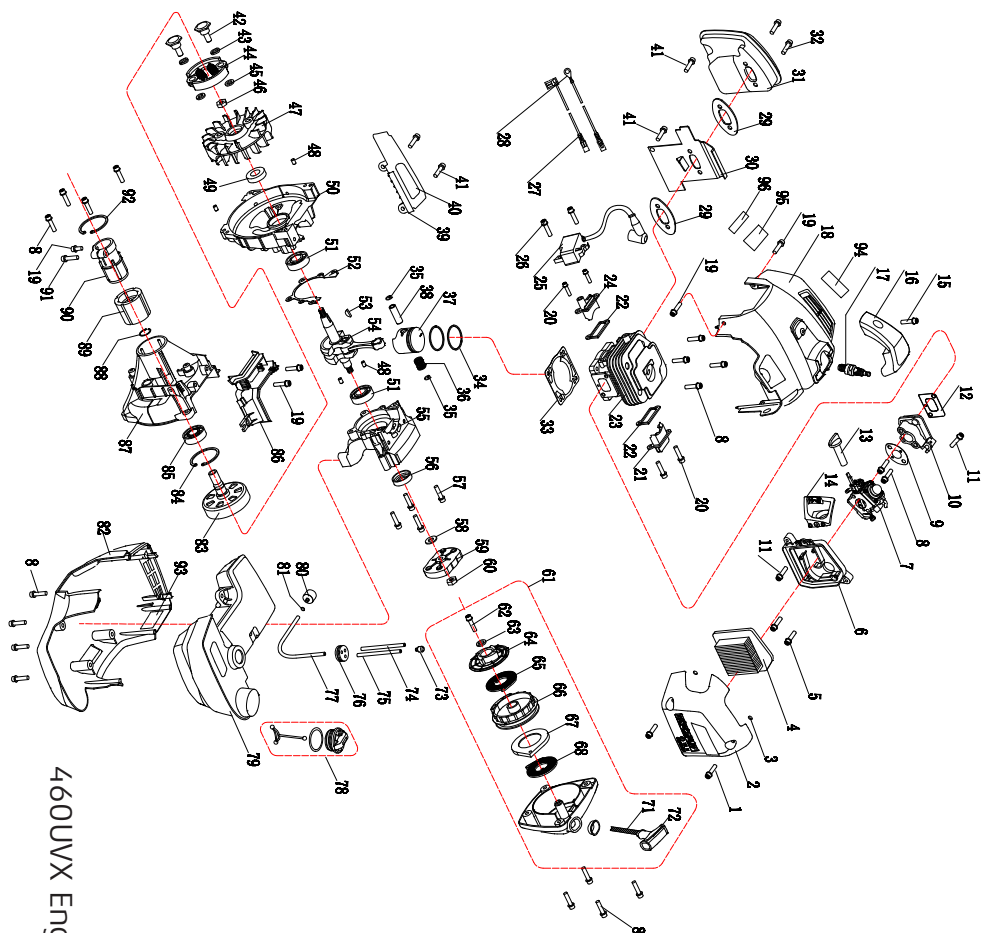

460UVX Engine Diagram

460UVX Parts - Engine Unit

ID	PART NUMBER	DESCRIPTION
1	MIC36.1104.0001	SCREW
2	MIC36.1104.0002	AIR FILTER COVER
3	MIGB/T3452.1 3.63X2.62	O-RING
4	MIC36.1104.0200	AIR FILTER
5	MIGB/T2671.2 M5X45	SCREW M5X45
6	MIC36.1104.0004	AIR FILTER BASE
7	MIC36.1101.0100	CARBURETOR
8	MIGB/T2671.2 M5X25	SCREW M5X25
9	MIA38.0301.0010	CARB GASKET
10	MIC36.1101.0200	MANIFOLD
11	MIGB/T845 ST4X10	SCREW ST4X10
12	MIC36.1101.0002	INLET GASKET
13	MIC36.1101.0101	CHOKE LEVER
14	MIC36.1104.0005	COVER
15	MI01.01.4111	SCREW ST4.8X14
16	MIC36.1101.0003	SPARK PLUG COVER
17	MIA45.0806.0400	SPARK PLUG
18	MIC36.1101.0400	TOP HOUSING
19	MIGB/T2671.2 M5X14	SCREW M5X14
20	MIGB/T2671.2 M4X14	SCREW M4X14
21	MIC46.1101.0303	REAR COVER
22	MIC36.1101.0304	GASKET
23	MIC46.1101.0301	CYLINDER
24	MIC46.1101.0302	FRONT COVER
25	MIC36.1106.0200	IGNITION COIL
26	MIGB/T2671.2 M5X20	SCREW M5X20
27	MIC36.1106.0301	WIRE A

28	MIC36.1106.0302	WIRE B
29	MIC36.1101.0006	MUFFLER GASKET
30	MIC36.1101.0007	HEAT SHIELD
31	MIC36.1105.0000	MUFFLER
32	MIGB/T2671.2 M6X60	SCREW M6X60
33	MIC36.1101.0005	BASE GASKET
34	MIC46.1103.0002	PISTON RING
35	MIA38.0303.0003	PISTON PIN CIRCLIP
36	MIC43.0103.0300	BEARING
37	MIC46.1103.0001	PISTON
38	MIC46.1103.0003	PISTON PIN
39	MIC36.1101.0008	FUEL TANK GUARD
40	MIA62.0113.0005	INSULATION
41	MIGB/T2671.2 M5X16	SCREW M5X16
42	MIC36.1101.0010	CLUTCH BOLT
43	MIGB/T755 M10	WASHER M10
44	MIC36.1101.0501	CLUTCH ASSEMBLY
45	MIC43.0101.0009	FLAT WASHER
46	MIGB/T6187 M8	FLANGE NUT M8
47	MIC36.1106.0100	FLYWHEEL
48	MIGB/T119 B5X10	PIN 5X10
49	MIC43.0101.0300	OIL SEAL
50	MIC36.1102.0002	CRANKCASE L/H
51	MIGB/T276 6202- 2RSP6	BEARING 6202 P6
52	MIC36.1102.0003	GASKET
53	MIGB/T1099 3X5X13	KEY
54	MIC36.1103.0100	CRANKSHAFT ASSEMBLY
55	MIC36.1102.0001	CRANKCASE R/H

460UVX Parts - Engine Unit

56	MIA38.0302.0200	OIL SEAL	86	MIC36.1101.0004	PLASTIC PLATE
57	MIGB/T2671.2 M5X30	SCREW M5X30	87	MIC36.1108.0001	CLUTCH DRUM HOUS- ING
58	MIGB/T97.1 M8	WASHER M8	88	MIGB/T894.1 15	CIRCLIP 15
59	MIC36.1101.0600	PAWL ASSEMBLY	89	MIC45.6808.0001	AV RUBBER
60	MIGB/T6175 M8	NUT M8	90	MIC45.6808.0002	CLAMP
61	MIC36.1110.0000	STARTER ASSEMBLY	91	MIGB/T2671.2 M6X25	SCREW M6X25
62	MIGB/T2672 M5X14	SCREW M5X14	92	MIGB/T893.1 45	CIRCLIP 45
63	MIGB/T96 M5	PLATE WASHER M5	93	MIC36.1101.0013	INSULATION
64	MIC43.2110.0006	RATCHET WHEEL	94	MIC36.1101.0014	INSULATION A
65	MIC36.1110.0005	SPRING	95	MIC36.1101.0015	INSULATION B
66	MIC43.2110.0003	RECOIL PULLEY	96	MIC36.1101.0016	INSULATION C
67	MIC43.2110.0004	SPRING HOUSING			
68	MIA36.0110.0003	RECOIL SPRING			
71	MIA45.0110.0006	RECOIL ROPE			
72	MIA41.1110.0003	GRIP			
73	MIA45.0111.0200	TANK VENT			
74	MIC36.1107.0003	VENT PIPE			
75	MIC36.1107.0002	RETURN FUEL LINE			
76	MIC43.1107.0003	TANK GROMMET			
77	MIC36.1107.0001	FUEL PIPE			
78	MIA42.1111.0300	TANK CAP ASSEMBLY			
79	MIC36.1107.0000	FUEL TANK			
80	MIA38.0311.0500	FUEL FILTER			
81	MIA45.0102.0103	PIPE CLAMP			
82	MIC36.1101.0009	TANK HOUSING			
83	MIC36.1108.0100	CLUTCH DRUM			
84	MIGB/T893.1 35	CIRCLIP 35			
85	MIGB/T276 6202- 2RSP5	BEARING 6202-2RS			

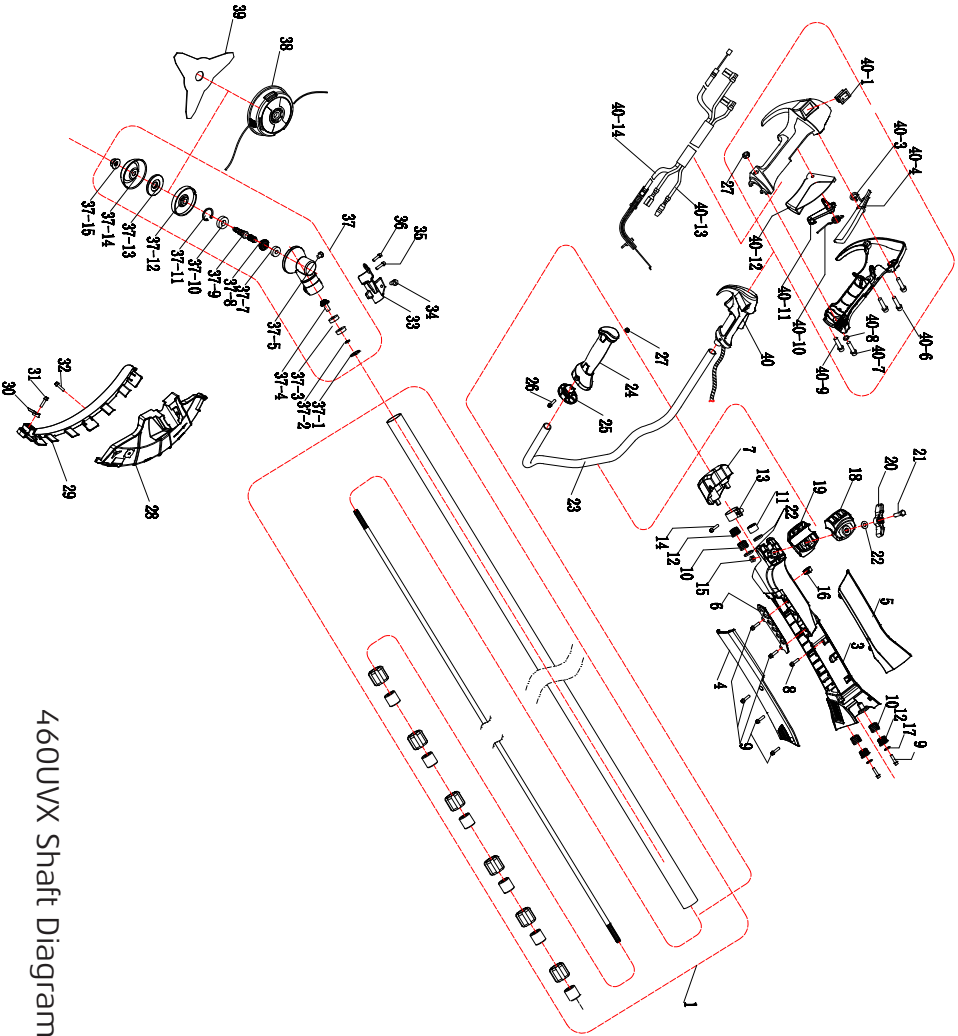

460UVX Shaft Diagram

460UVX Parts - Shaft Assembly

ID	PART NUMBER	DESCRIPTION
1	MIC36.1100.0100	SHAFT ASSEMBLY
3	MIC36.1111.0101	VIBRATION COVER
4	MIC36.1111.0102	SIDE COVER
5	MIC36.1111.0103	UPPER COVER
6	MIC36.1111.0104	HARNESS PLATE
7	MIC36.1111.0105	SUPPORT SEAT
8	MIGB/T6564 ST4.8X12	SCREW ST4.8X12
9	MIGB/T6564 ST4.8X19	SCREW ST4.8X19
10	MIC43.2111.0306	AV SPRING
11	MIC43.2111.0307	SLEEVE
12	MIC43.2111.0308	SLEEVE
13	MIC43.2111.0310	CLAMP
14	MIGB/T2671.2 M5X16	SCREW M5X16
15	MIGB/T41 M8	NUT M8
16	MIC36.1111.0106	CABLE CLAMP
17	MIGB/T96.1 M5	WASHER M5
18	MIC36.1111.0201	UPPER CLAMP
19	MIC36.1111.0202	LOWER CLAMP
20	MIC27.6111.0205	LOCK KNOB
21	MIGB/T5782 M8X60	SCREW M8X60
22	MIGB/T96.1 M8	PLATE WASHER M8
23	MIC43.2111.0001	HANDLE TUBING
24	MIC43.2111.0201	GRIP
25	MIC43.2111.0202	LEFT HANDLE CLAMP
26	MIGB/T2671.2 M5X45	SCREW M5X45
27	MIGB/T56 M5	NUT M5
28	MIC24.0113.0101	UPPER GUARD
29	MIC24.0113.0105	LOWER GUARD
30	MIC24.0113.0104	CUTTING BLADE
31	MIGB/T6564 ST4.2X13	SCREW ST4.2X13
32	MIC43.2113.0309	SCREW ST4.8X19
33	MIC43.2113.0305	GUARD CLAMP
34	MIC43.2113.0307	LOCK SCREW
35	MIGB/T2671.2 M6X12	SCREW M6X12
36	MIGB/T2671.2 M6X25	SCREW M6X25
37	MIC48.B116.0000	GEAR CASE ASSEMBLY
37-1	MIGB/T893.1 28	CIRCLIP 28
37-2	MIGB/T894.1 12	CIRCLIP 12
37-3	MIGB/T276 6001- 2Z	BEARING 6001-2Z
37-4	MIC48.B116.0002	PINION GEAR
37-5	MIGB/T5781 M6X8	SCREW M6X8
37-7	MIGB/T276 6000- 2Z	BEARING 6000-2Z
37-8	MIC43.B116.0004	GEAR
37-9	MIC43.B116.0003	GEAR SHAFT
37-10	MIGB/T276 6002- 2RSP5	BEARING 6002-2RS
37-11	MIGB/T893.1 32	CIRCLIP 32
37-12	MIC43.B116.0006	HOLDER A
37-13	MIC43.B116.0005	HOLDER B
37-14	MIC43.B116.0007	NUT PROTECTOR
37-15	MIGB/T6177.2 M10X1.25	FLANGE NUT M10X1.25
38	MI TBC	NYLON HEAD AS- SEMBLY
39	MIC43.1100.0001	BLADE

460UVX Parts - Shaft Assembly

40	MIC36.1111.0300	THROTTLE CONTROL ASSEMBLY
40-1	MIC43.1111.0700	SWITCH
40-3	MIC36.2111.0107	SPRING
40-4	MIC43.2111.0106	LOCK TRIGGER
40-6	MI01.01.3121	SCREW ST4X14
40-7	MIGB/T2671.2 M5X35	SCREW M5X35
40-8	MIGB/T97.1 M5	WASHER M5
40-9	MIGB/T845 ST3.5X9.5	SCREW ST 3.5X9.5
40-10	MIC43.2111.0105	TRIGGER SPRING
40-11	MIC43.2111.0104	ROD
40-12	MIC43.2111.0103	TRIGGER
40-13	MIC36.1111.0302	WIRE ASSEMBLY
40-14	MIC36.1111.0301	THROTTLE CABLE ASSEMBLY

EC DECLARATION OF CONFORMITY

The undersigned, as authorised by: Mitox Garden Machinery

Declares that the following equipment manufactured by Mitox conforms to the Directive: -

2000/14/EC

of the European Parliament and of the council on the approximation of the laws of the Member States relating to the noise emission in the environment by equipment for use outdoors.

Equipment Category – Powered Brushcutters and Grass Trimmers

Product Name/Model: Mitox 360UX

Type/Serial No.: As per rating label on machine

Cutting Width: 430mm (Grass Trimmer) / 255mm(Brushcutter)

Net installed power: 36.3 cm3 / 1.6 kW

The technical documentation is kept by: Stewart Anderson, Rochford Garden Machinery Ltd., Murray Way, Wincanton Business Park, Somerset, BA9 9RS

The conformity assessment procedure followed was in according with annex EN ISO 11806-1:2011 of the Directive.

Notified Body: Interket Testing Services Shanghai, Building No. 86, 1198 Qinzhou Road (North), Shanghai 200233, China

Measured Sound Power Level: 97 dB

Guaranteed Sound Power Level: 110 dB

A copy of this certificate has been submitted to the European Commission and to EU Member State United Kingdom

Place of Declaration: China

Date:16/11/2017



Signed by: S. Anderson

Position in Company: Managing Director

Name and address of Authorised representative: Rochford Garden Machinery Ltd., Murray Way, Wincanton Business Park, Somerset, BA9 9RS

EC DECLARATION OF CONFORMITY

The undersigned, as authorised by: Mitox Garden Machinery

Declares that the following equipment manufactured by Mitox conforms to the Directive: -

2000/14/EC

of the European Parliament and of the council on the approximation of the laws of the Member States relating to the noise emission in the environment by equipment for use outdoors.

Equipment Category – Powered Brushcutters and Grass Trimmers

Product Name/Model: Mitox 460UVX

Type/Serial No.: As per rating label on machine

Cutting Width: 430mm (Grass Trimmer) / 255mm(Brushcutter)

Net installed power: 46.5 cm3 / 1.95 kW

The technical documentation is kept by: Stewart Anderson, Rochford Garden Machinery Ltd., Murray Way, Wincanton Business Park, Somerset, BA9 9RS

The conformity assessment procedure followed was in according with annex EN ISO 11806-1:2011 of the Directive.

Notified Body: Interket Testing Services Shanghai, Building No. 86, 1198 Qinzhou Road (North), Shanghai 200233, China

Measured Sound Power Level: 98 dB

Guaranteed Sound Power Level: 112 dB

A copy of this certificate has been submitted to the European Commission and to EU Member State United Kingdom

Place of Declaration: China

Date:16/11/2017



Signed by: S. Anderson

Position in Company: Managing Director

Name and address of Authorised representative: Rochford Garden Machinery Ltd., Murray Way, Wincanton Business Park, Somerset, BA9 9RS

CONDITIONS OF WARRANTY

The manufacturer warrants the product against faulty materials and workmanship for a standard 1 year period and thereafter for the set period specific to each range from the date of purchase. Warranty does not extend to failure due to fair wear and tear.

SP	- 1 Year
SELECT	- 3 Years (Subject to yearly servicing)
PREMIUM	- 5 Years (Subject to yearly servicing)
PRO	- 5 Years Domestic / 3 Years Commercial (Subject to yearly servicing)

(Extended warranty is subject to online registration and yearly servicing)

SP, SELECT and PREMIUM ranges used for commercial purposes have a warranty period of 3 months from the date of purchase.

The manufacturer undertakes to replace any spare parts that are classified as defective by an appointed Mitox service dealer. The manufacturer will not accept liability for the replacement of the machine, either partially or wholly, and /or consequential damages and /or interest charges either directly or indirectly.

Warranty does not cover failure due to:

Insufficient maintenance.

Incorrect fuel mixture and stale fuel.

Abnormal use or accidental damage.

Incorrect assembly, adjustment or operation of the product.

Spare parts that are subject to wear e.g. bag, blades, bearings, cables, guards, deflectors, spark plugs, air filters etc.

Neither does warranty extend to:

Freight and packing costs.

Use of non-genuine spare parts i.e. those from another manufacturer.

Use of the machine for any other purpose than that for which it was designed.

Use and maintenance of the machine in a manner not described in the owner's manual.

As part of our policy of continuous product improvement, we reserve the right to alter or amend this specification without notice. As a result, the product may differ from the information contained herein but any alteration will only be implemented without notice if it is classified as an improvement to the above specification.

READ THE MANUAL CAREFULLY BEFORE OPERATING THE MACHINE

When ordering spare parts, please quote the part number, this can be found in the parts list included in this manual.

Retain your proof of purchase, without which no warranty can be offered.

Mitox Garden Machinery, Wincanton Business Park, Wincanton, Somerset, BA9 9RS