



Operator's Manual

user manual, maintenance instructions and spare parts

801 LSV 8 Ton Electric Logsplitter

(Art No. MILS26)



Read this manual carefully before operating the machine
Original Instructions Version August 19

SAFETY WARNINGS & EXPLANATION OF SYMBOLS ON THE MACHINE

UNDERSTAND YOUR LOG SPLITTER

Read and understand the owner's manual and labels affixed to the log splitter. Learn its application and limitations as well as the specific potential hazards peculiar to it.



DRUGS, ALCOHOL AND MEDICATION

Do not operate the log splitter while under the influence of drugs, alcohol, or any medication that could affect your ability to use it properly.



AVOID DANGEROUS CONDITIONS

Always operate your log splitter on dry, solid, level ground. Never operate your log splitter on slippery, wet, muddy, or icy surfaces. Keep your work area clean and well lit. Cluttered areas invite injuries. Do not use the log splitter in wet or damp areas or expose it to rain. Do not use it in areas where fumes from paint, solvents or flammable liquids pose a potential hazard.



INSPECT YOUR LOG SPLITTER

Check your log splitter before turning it on. Keep guards in place and in working order. Replace damaged, missing or failed parts before using it. Make sure all nuts, bolts, screws, hydraulic fittings, hose clamps, etc. are securely tightened. Always check the oil level in the hydraulic oil tank. Never operate your log splitter when it is in need of repair or is in poor mechanical condition.

WORK WEAR

Do not wear loose clothing, gloves, neckties or jewellery (rings, wrist watches). They can be caught in moving parts. Protective gloves and non-skid footwear are recommended when working. Wear protective hair covering to contain long hair, preventing it from getting caught in machinery.



PROTECT YOUR EYES AND FACE

Any log splitter may throw foreign objects into the eyes. This can cause permanent eye damage. Always wear safety goggles. Everyday eyeglasses have only impact resistant lenses. They are not safety glasses.



EXTENSION CORDS

Improper use of extension cords may cause inefficient operation of the log splitter which can result in overheating. Be sure the extension cord is no longer than 10m and its section is no less than 2.5mm² to allow sufficient current flow to the motor. Connections must be made with protected material suitable for outdoor use.

AVOID ELECTRICAL SHOCK

Check that the electric circuit is adequately protected and that it corresponds with the power and voltage of the motor. Check that there is a ground connection. Never open the switch / plug box. Should this be necessary, contact a qualified electrician. Make sure your fingers do not touch the plug's metal prongs when plugging or unplugging the log splitter.

PREVENT FIRES

Do not smoke or have open flames when operating or refuelling the log splitter. Never operate the log splitter near a flame or spark. Oil is flammable and can be ignited.



KEEP BYSTANDERS AWAY

Allow only one person to load and operate the log splitter. Always keep bystanders, including visitors, children and pets away from the work area, especially when the log splitter is under operation. Only the operator should stand near the machine and only within the safe operating area prescribed in this manual. Never use another person to help you with freeing a jammed log. No one under the age of 16 should be allowed to operate the log splitter. Any individual under the age of 18 should have the necessary training and skills to perform the functions properly and safely and should always be under the supervision of an adult.

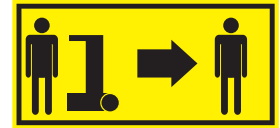

INSPECT YOUR LOG

Never attempt to split logs containing nails, wire or debris. Always make sure that both ends of the log you are splitting are cut as square as possible. This will prevent the log from sliding out of position while under pressure. Branches must be cut off flush with the trunk.

DON'T OVERREACH

Keep a proper footing and balance at all times. Never stand on the log splitter. Serious injury could occur if the tool is tipped or if the cutting tool is unintentionally contacted. Do not store anything above or near the log splitter where anyone might stand on the tool to reach it.

AVOID INJURY FROM UNEXPECTED ACCIDENT

Do not straddle or reach across the splitting area when operating the log splitter. Never pile logs to be split in a manner that will cause you to reach across the log splitter. Only use your hands to operate the control levers. Never use your foot, knee, a rope, or any other extension device. Always pay full attention to the movement of the wedge ram. Never attempt to load your log splitter while the ram is in motion. Keep hands out of the way of all moving parts. Never try to split two logs. One of them may fly up and hit you.



PROTECT YOUR HANDS

When the ram of the log splitter is in the return mode, keep your hands off the machine – the log splitter is designed to automatically stop when the cylinder is fully retracted. Keep your hands away from splits and cracks which open in the log. They may close suddenly and crush or injure your hands. Do not remove jammed logs with your hands.

INCORRECT USE

The log splitter will do a better and safer job at its designed rate. Don't use the log splitter for a purpose for which it was not intended. Do not, under any circumstances, alter your log splitter. This equipment was designed and engineered to be used in accordance with the operating instructions. Altering the equipment, or using the equipment in such a way as to circumvent its design capabilities and capacities, could result in serious or fatal injury and will void the warranty. Never try to split logs larger than those indicated in the specifications table. This could be dangerous and may damage the machine.

NEVER LEAVE THE LOG SPLITTER RUNNING UNATTENDED

Don't leave the tool until it has come to a complete stop.

DISCONNECT POWER

Unplug the log splitter when not in use, before making adjustments, changing parts, cleaning, or working on the log splitter. Consult the technical manual before servicing.



PROTECT THE ENVIRONMENT

Take used oil to an authorized collection point or follow the stipulations in the country where the log splitter is used. Do not discharge into drains, soil or water.

MAINTAIN YOUR LOG SPLITTER WITH CARE

Always clean the unit after each use. Keep the log splitter clean for best and safest performance. Follow the instructions for lubricating. Inspect all hydraulic seals, hoses and couplers for leaks prior to use. Control levers and power switch must be kept clean, dry and free from oil and grease at all times.



MAKE THE WORKSHOP CHILDPROOF

Lock the workshop or garage. Store the log splitter away from children and others not qualified to use it.

MAKE THE WORKSHOP CHILDPROOF

Lock the workshop or garage. Store the log splitter away from children and others not qualified to use it.

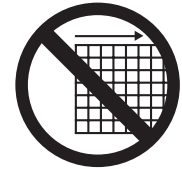

FOR YOUR SAFETY

Do not remove or tamper with any of the machines protection or safety devices or modify the log splitter in any way.

TABLE OF CONTENTS

Safety Warnings & Cautions2

Specifications5

Package Contents.....6

Intended Use & Safety Notes.....7

Unpacking & Assembly9

Log Splitter Operation.....12

Electrical Connections14

Log Splitter Maintenance.....15

Trouble Shooting.....16

Parts Schematic18

Declaration of Conformity21

DESCRIPTION OF MACHINE

The log splitter is designed to be used in a domestic application.

The log splitter is designed exclusively for the following applications:

-Splitting freshly cut timber that does not exceed the dimensions specified in the technical data.

APPLICATION CONDITIONS

This log splitter is designed to operate under ambient temperatures between +5°C and 40°C and for installation at altitudes no more than 1000m above M.S.L. The surrounding humidity should be less than 50% at 40°C. It can be stored or transported under ambient temperatures between -25°C and 55°C.

SPECIFICATIONS

Model Number	801 LSV	
Motor	3000W - 230V	
Maximum Log Length	550mm	
Log Diameter	10cm - 30cm	
Maximum Force	8 Ton	
Hydraulic Oil Capacity	4 L	
Ram Travel	550mm	
Forward Speed	3.1cm / sec.	
Retract Speed	17.3cm / sec.	
Noise Level		
Overall Sizes	Depth	85cm
	Width	94cm
	Height	150cm
Weight	110kg	

ELECTRICAL REQUIREMENTS

With a 230 Volt / 50Hz motor, the log splitter should be connected to a standard 230V+10% / 50Hz+1Hz. electrical supply as well as a residual current device (RCD) with the maximum residual current Rated at 0.03A.

- 1. Transport handles
- 2. Riving knife
- 3. Riving bar
- 4. Adjustable claws
- 5. Table
- 6. Oil dipstick
- 7. Wheels
- 8. Stroke setting bar
- 9. Control handle
- 10. Complete control arms
- 11. Tray table (lateral)
- 12. Combination switch/plug
- 13. Motor
- 14. Cover

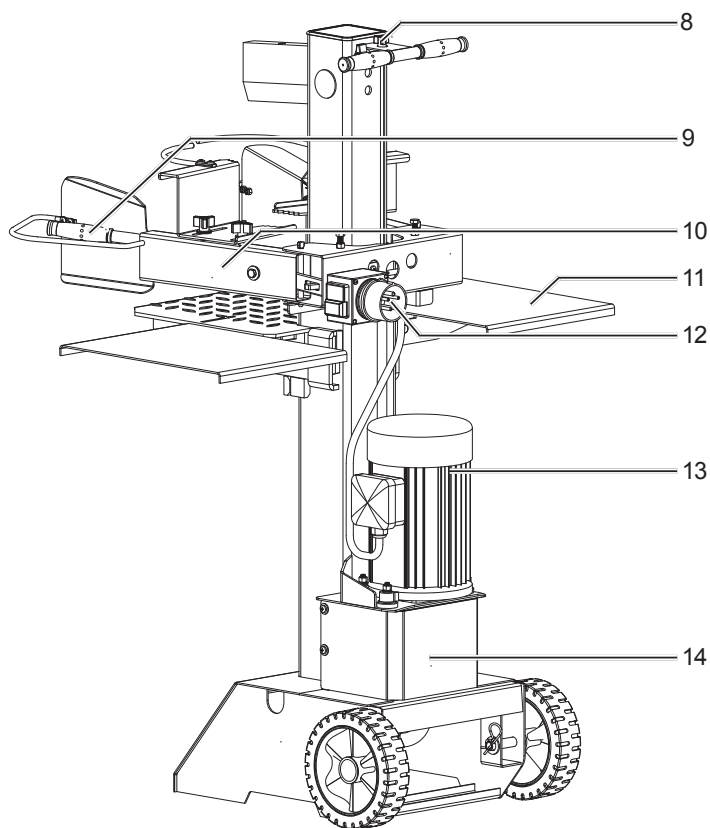
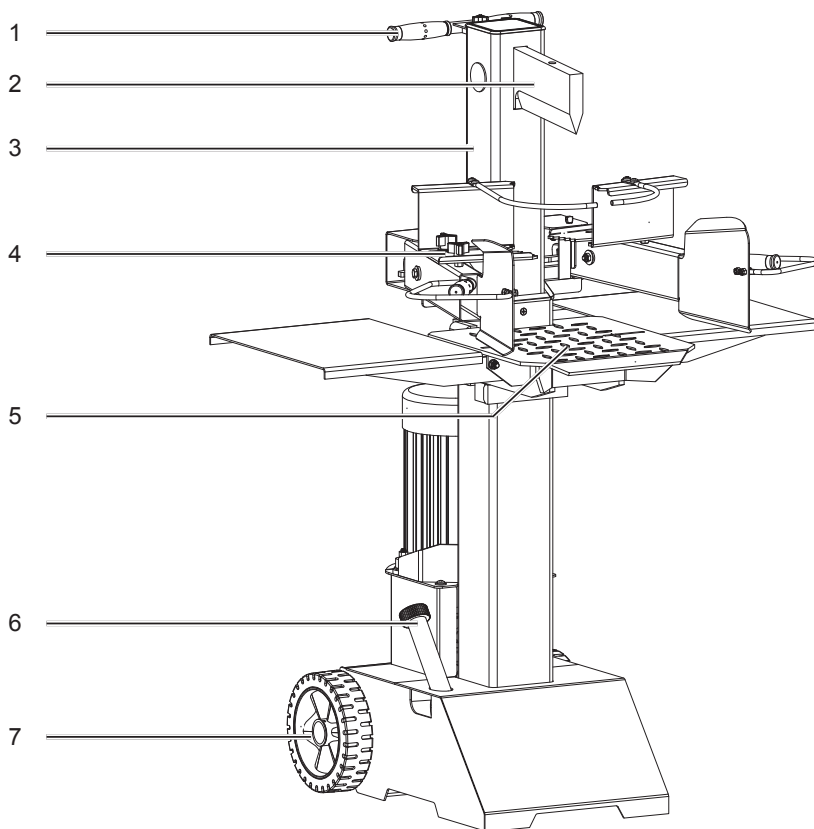

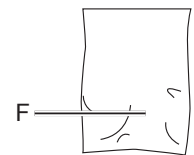
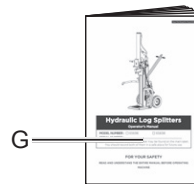
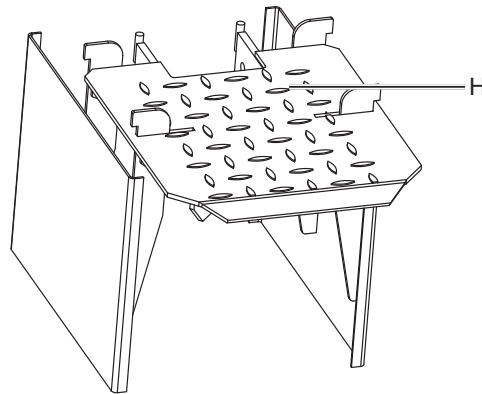
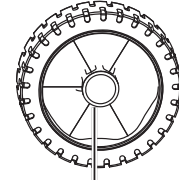
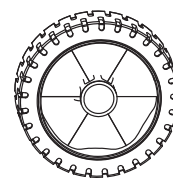
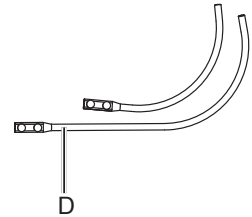
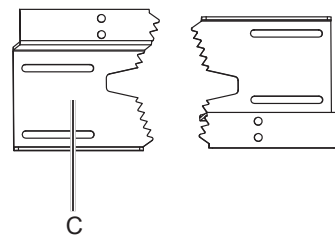
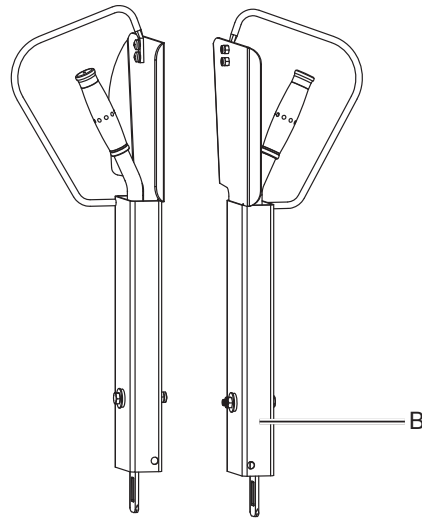
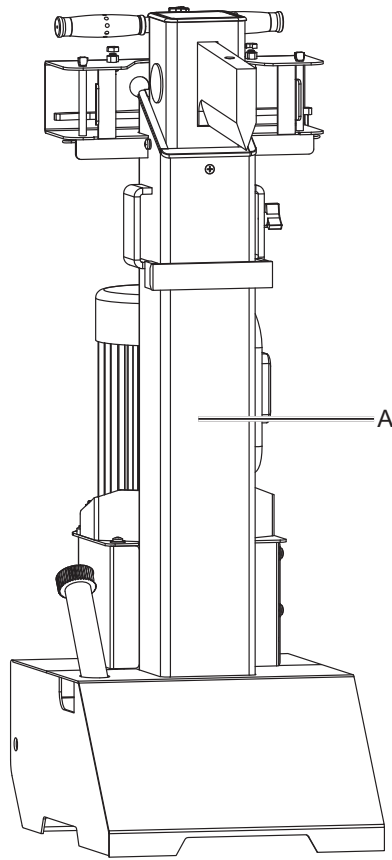

			× 2	A
			× 2	
			× 6	
			× 2	

			× 2	B
			× 2	

			M6 × 16	× 4	C
				× 4	

- A. Splitter
- B. Control arms
- C. Adjustable claws
- D. Additional retainers
- E. Wheels
- F. Enclosed accessories bag (A, B, C)
- G. Operating manual
- H. Table including tray tables

4. Intended use

The equipment is to be used only for its prescribed purpose. Any other use is deemed to be a case of misuse. The user / operator and not the manufacturer will be liable for any damage or injuries of any kind caused as a result of this. The equipment is to be operated only with suitable saw blades. It is prohibited to use any type of cutting-off wheel. To use the equipment properly you must also observe the safety information, the assembly instructions and the operating instructions to be found in this manual.

All persons who use and service the equipment have to be acquainted with this manual and must be informed about the equipment's potential hazards. It is also imperative to observe the accident prevention regulations in force in your area. The same applies for the general rules of health and safety at work.

The manufacturer will not be liable for any changes made to the equipment nor for any damage resulting from such changes.

- The hydraulic log splitter can only be used in a vertical position. Logs may only be split along the direction of the fiber. Log dimensions are: Log lengths 55 cm / Ø min. 10 cm, max. 30 cm
- Never split logs in horizontal position or against the direction of the fiber.
- Observe the safety, working, and maintenance instructions of the manufacturer, as well as the dimensions given in the chapter Technical data.
- The applicable accident prevention regulations as well as all generally recognized safety rules must be adhered to.
- Only persons who have been trained in the use of the machine and have been informed of the various dangers may work with the machine and service or repair it. Arbitrary modifications of the machine release the manufacturer from any responsibility for resulting damage.
- The machine may only be used with original accessories and original tools of the manufacturer.
- Any other use exceeds authorization. The manufacturer is not responsible for any damages resulting from unauthorized use; risk is the sole responsibility of the operator.

The machine may be operated only with original parts and original accessories of the manufacturer.

The safety, work and maintenance instructions of the manufacturer as well as the dimensions indicated in the Technical Data section must be adhered to.

Please note that our equipment has not been designed for use in commercial, trade or industrial applications. Our warranty will be voided if the equipment is used in commercial, trade or industrial businesses or for equivalent purposes.

5. Safety notes



WARNING: When you use electric machines, always observe the following safety instructions in order to reduce the risk of fire, electric shock, and injuries.

Please read all the instructions before you work with this machine.

- Observe all safety notes and warnings attached to the machine.
- See to it that safety instructions and warnings attached to the machine are always complete and perfectly legible.
- Protection and safety devices on the machine may not be removed or made useless.
- Check electrical connection leads. Do not use any faulty connection leads.
- Before putting into operation check the correct function of the two-hand control.
- Operating personnel must be at least 18 years of age. Trainees must be at least 16 years of age, but may only operate the machine under adult supervision.
- Wear working gloves when working.
- Caution when working: There is a danger to fingers and hands from the splitting tool.
- Use adequate supports when splitting heavy or bulky logs.
- Before starting any conversion, setting, cleaning, maintenance or repair work, always switch off the machine and

disconnect the plug from the power supply.

- Connections, repairs, or servicing work on the electrical equipment may only be carried out by an electrician.
- All protection and safety devices must be replaced after completing repair and maintenance procedures.
- When leaving the work place, switch off the machine and disconnect the plug from the power supply.

6. Additional safety instructions

- The log splitter may only be operated by one person.
- Wear protective gear like safety goggles or other eye protection, gloves, safety shoes etc. to protect yourself from possible injuries.
- Never split logs containing nails, wire, or other foreign objects.
- Already split wood and wood chips can be dangerous. You can stumble, slip or fall down. Keep the working area tidy.
- While the machine is switched on, never put your hands on moving parts of the machine.
- Only split logs with a maximum length of 55 cm.

Remaining hazards

The machine has been built using modern technology in accordance with recognized safety rules. Some remaining hazards, however, may still exist.

- The splitting tool can cause injuries to fingers and hands if the wood is incorrectly guided or supported.
- Thrown pieces can lead to injury if the work piece is not correctly placed or held.
- Injury through electric current if incorrect electric connection leads are used.
- Even when all safety measures are taken, some remaining hazards which are not yet evident may still be present.
- Remaining hazards can be minimized by following the safety instructions as well as the instructions in the chapter Authorized use and in the entire operating manual.
- Health hazard due to electrical power, with the use of improper electrical connection cables.
- Release the handle button and switch off the machine prior to any operations.
- Avoid accidental starts of the machine: Do not press the start button while inserting the plug into the socket.
- Use the tools recommended in this manual to obtain the best results from your machine.
- Always keep hands away from the work area when the machine is running.

7. Unpacking

Open the packaging and remove the device carefully.

Remove the packaging material as well as the packaging and transport bracing.

Check that the delivery is complete.

Check the device and accessory parts for transport damage.

In case of complaints the dealer must be informed immediately. Subsequent complaints will not be accepted.

If possible, store the packaging until the warranty period has expired.

Read the operating manual to make yourself familiar with the device prior to using it.

Only use original parts for accessories as well as for wearing and spare parts. Spare parts are available from your specialized dealer.

Specify our part numbers as well as the type and year of construction of the device in your orders.



ATTENTION

The device and packaging materials are not toys!

Children must not be allowed to play with plastic bags, film and small parts! There is a risk of swallowing and suffocation!

8. Attachment / Before starting the equipment

8.1 Fitting the wheels (7) (accessories bag A)

- Insert the bolt through the wheel.
- Attach two washers.
- Now insert the bolt through the holes in the lower part of the splitter (fig. 3).
- Now fix the bolt with a washer and a cotter pin.
- Finally fit the small wheel cap
- Repeat this process on the other side.

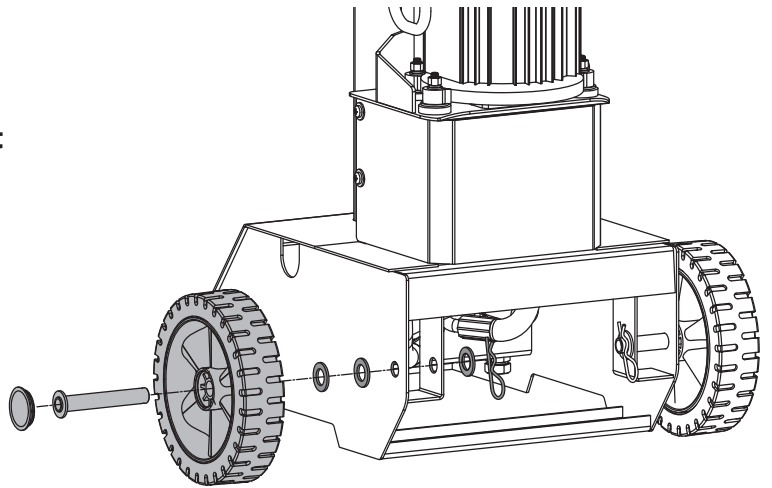

8.2 Fitting the table (5)

- Undo the star-grip screw (Fig. 4)

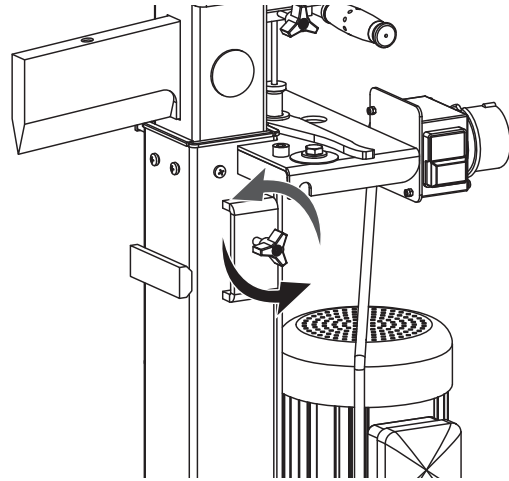

- Now fold out both side trays (11), as shown.

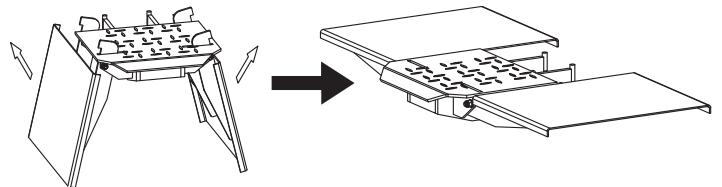

- Now fit the table in the retainer intended (Fig. 6 (1) and re-tighten the star grip screws previously loosened (Fig. 6 (2)).

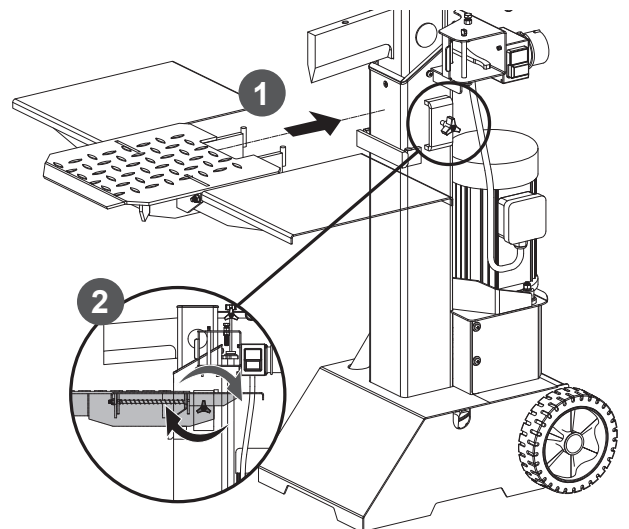

8.3 Fitting the complete control arms (10) (accessories bag B)

- Remove pre-assembled bolt (C).
- Grease the top and bottom plates.
- Insert the complete control arm in the position provided (1).
- Guide control arm (A) into the rocker switch (B) (2)
- Secure the control arms completely with the bolts (C) and fix them with a cotter pin.
- Now fasten the other control arm on the other side in accordance with the method described

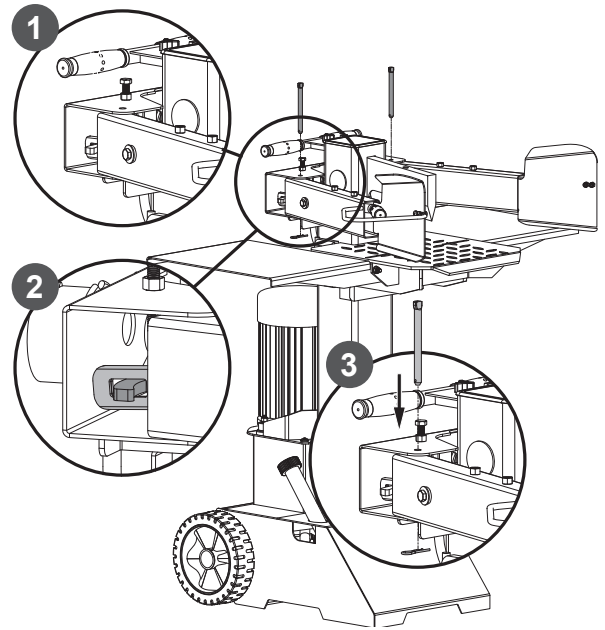

9.4 Fitting the claws (enclosed accessories bag C)

- Fasten the additional retainers (D) to the claws with two Phillips head screws, washers and nuts
- Make sure that the larger additional retainer is fastened with the left claw (4).
- Place the adjustable claws on the hexagon nuts previously attached, and fasten these with the star grip screws and washers enclosed

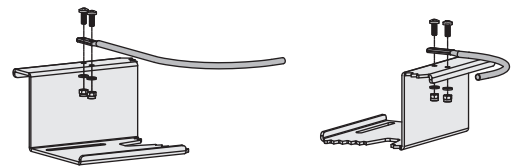

- Note that the prongs on the claws must point towards each other after installation

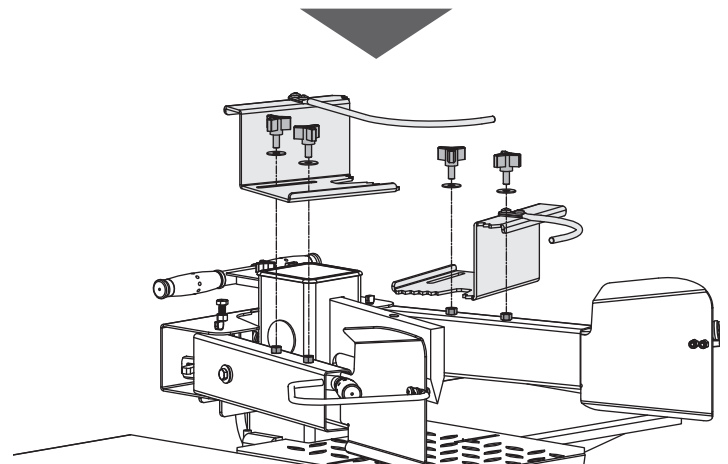

- Note that the prongs on the claws must point towards each other after installation

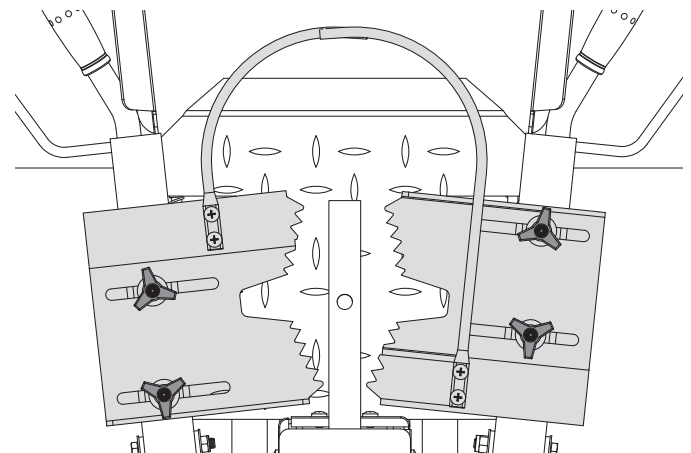

IMPORTANT!

You must fully assemble the appliance before using it for the first time!

10. Initial operation

Make sure the machine is completely and expertly assembled. Check before every use:

- The connection cables for any defective spots (cracks, cuts etc.).
- The machine for any possible damage.
- The firm seat of all bolts.
- The hydraulic system for leakage.
- The oil level.

Checking the oil level

The hydraulic unit is a closed system with oil tank, oil pump and control valve. Check the oil level regularly before every use. Too low an oil level can damage the oil pump. The correct oil level is approx. 10 to 20 mm below the oil tank surface.

Note: The level of oil must be checked when the riving knife is pulled back. If the oil level is at the lower notch, then the oil level is at a minimum. Should this be the case, oil must be immediately added. The upper notch indicates the maximum oil level. The machine must be on level ground. Screw in the oil dipstick fully, to measure the oil level.

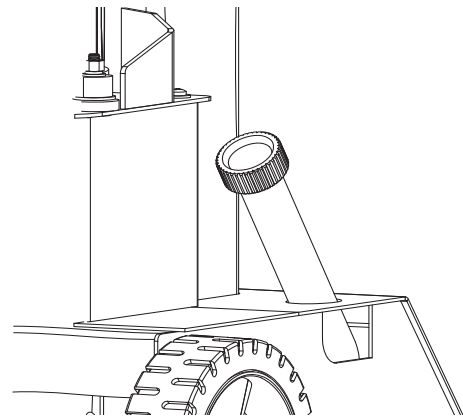

Functional test

Test the function before every use.

Check the oil level before every use – see chapter “Maintenance”.

Venting

Before working with the log splitter, vent the hydraulic system.

- Release the venting cap 6 by a few revolutions so the air can escape from the oil tank.
- Leave the cap open during the operation.
- Before you move the log splitter, close the cap again in order not to lose any oil.

If the hydraulic system is not vented, the enclosed air will damage the gaskets and with it the complete log splitter.

Action:	Result:
Push both handles towards below.	Splitting knife goes down to approx. 10 cm above the table.
Let one handle loose, then the other.	Splitting knife stops in the desired position.
Let both handles loose.	Splitting knife returns to upper position.

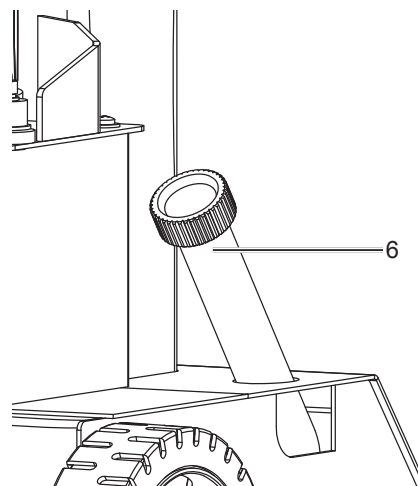

Stroke limit for short logs

Lower splitting knife position about 10 cm above table.

- Move splitting knife to the desired position
- Release one operating arm
- Switch motor off
- Release the second operating arm
- Undo the star grip screw (10a)
- Push the stroke set rod (8) to the top until it is stopped by the spring
- Tighten the star grip screw (10a) again.
- Switch motor on
- Check upper position

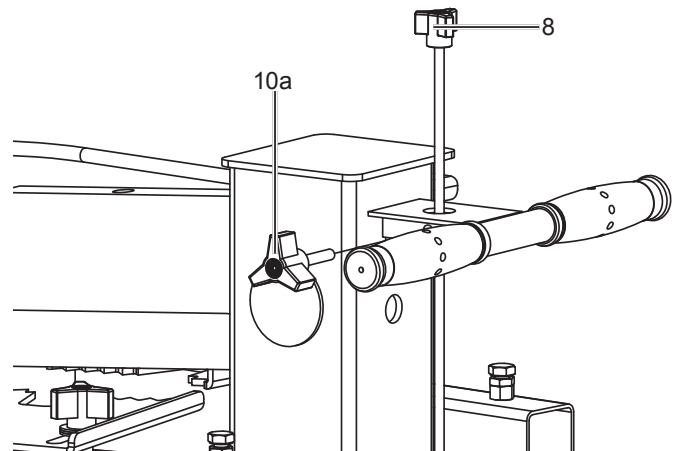

Switching on and off (12)

Press the green button for switching on.

Press the red button for switching off.

Note: Check the function of the ON/OFF unit before every use by switching on and off once.

Restarting safety in case of current interruption (no-volt release).

In case of current failure, inadvertent pulling of the plug, or a defective fuse, the machine is switched off automatically.

For switching on again, press anew the green button of the switch unit.

Splitting

- Place the log on the table, hold it with both handles, press the handles down. As soon as the splitting knife enters the wood, push the handles down and to the outside at the same time. This prevents the wood from putting pressure on the holder plates.
- Only split straight cut logs.
- Split the logs in vertical position.
- Never split in horizontal position or across.
- Wear protective gloves when splitting.

End of work

- Move the splitting knife to the lower position.
- Release one operating arm.
- Switch the machine off and pull the power plug.
- Close the venting cap.
- Observe the general maintenance instructions.

Electrical connection

The electrical motor installed is connected and ready for operation. The connection complies with the applicable VDE and DIN provisions.

The customer's mains connection as well as the extension cable used must also comply with these regulations.

Damaged electrical connection cable

The insulation on electrical connection cables is often damaged.

This may have the following causes:

- Passage points, where connection cables are passed through windows or doors.
- Kinks where the connection cable has been improperly fastened or routed.
- Places where the connection cables have been cut due to being driven over.
- Insulation damage due to being ripped out of the wall outlet.
- Cracks due to the insulation ageing.

Such damaged electrical connection cables must not be used and are life-threatening due to the insulation damage.

Check the electrical connection cables for damage regularly. Make sure that the connection cable does not hang on the power network during the inspection.

Electrical connection cables must comply with the applicable VDE and DIN provisions. Only use connection cables with the marking „H07RN“.

The printing of the type designation on the connection cable is mandatory.

For single-phase AC motors, we recommend a fuse rating of 16A (C) or 16A (K) for machines with a high starting current (starting from 3000 watts)!

AC motor 230 V/ 50 Hz

Mains voltage 230 Volt / 50 Hz.

The mains connection and the extension cable have to be three-core cables = P + N + SL. - (1/N/PE).

Extension cables must have a minimum cross-section of 1.5 mm². Mains fuse protection is 16 A maximum.

11. Cleaning

Attention!

Pull out the power plug before carrying out any cleaning work on the equipment.

We recommend that you clean the equipment immediately after you use it.

Clean the equipment regularly with a damp cloth and some soft soap. Do not use cleaning agents or solvents; these may be aggressive to the plastic parts in the equipment. Ensure that no water can get into the interior of the equipment.

12. Transport

For transport, the splitting knife A must be completely moved down. Slightly tilt the log splitter with handle B on the splitting column until the machine is inclined on the wheels and can be moved.

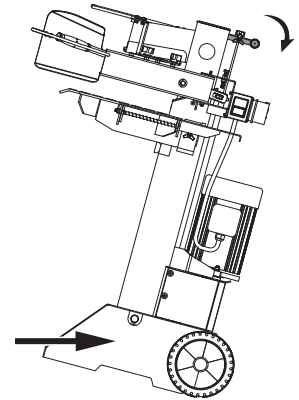

13. Storage

Store the device and its accessories in a dark, dry and frost-proof place that is inaccessible to children. The optimum storage temperature is between 5 and 30°C.

Cover the electrical tool in order to protect it from dust and moisture. Store the operating manual with the electrical tool.

14. Maintenance

Attention!

Pull out the power plug before carrying out any maintenance work on the equipment.

When must the oil be changed?

First oil change after 50 operating hours, then every 500 operating hours.

Oil change

- Completely retract the splitting column.
- Put a container with a volume of at least 6 litres under the splitter.
- Release the oil dipstick 6.
- Open the oil drain plug 12a under the oil tank so the oil can flow out.
- Afterwards, close the oil drain plug 12a again.
- Remove the ventilation cap, pour in 4 litres of fresh hydraulic oil using a clean funnel.
- Screw the oil dipstick in again.

Dispose of the used oil in a correct manner at a public collection facility. It is prohibited to drop old oil on the ground or to mix it with waste.

We recommend oil from the HLP 32 range.

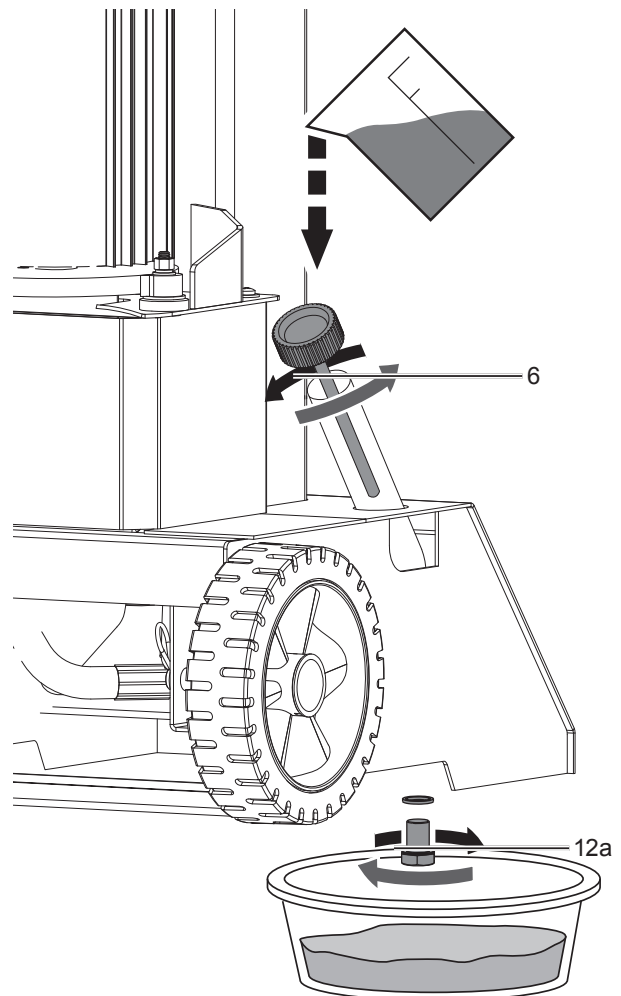

Splitting spar

Before use, the spar of the splitter must be slightly greased. Repeat this procedure every five operating hours. Slightly apply grease or oil spray. The spar may never run dry.

Hydraulic system

The hydraulic unit is a closed system with oil tank, oil pump and control valve. The system is complete when the machine is delivered, and may not be changed or manipulated.

Connections and repairs

Connections and repairs of electrical equipment may only be carried out by an electrician.

Service information

Please note that the following parts of this product are subject to normal or natural wear and that the following parts are therefore also required for use as consumables. Wear parts*: splitting wedge guides, hydraulic oil, splitting wedge

* Not necessarily included in the scope of delivery!

15. Troubleshooting

The table below contains a list of error symptoms and explains what you can do to solve the problem if your tool fails to work properly. If the problem persists after working through the list, please contact your nearest service workshop.

Malfunction	Possible cause	Remedy
The hydraulic pump does not start	No electric power	Check cable for electric power
	Thermal switch of motor cut off	Engage thermal switch inside the motor casing again
The column does not move down	Low oil level	Check oil level and refill
	One of the levers not connected	Check fixing of lever
	Dirt in the rails	Clean the column
Motor starts but column does not move down	Wrong turning direction of 3-phase motor	Check turning direction of motor and change

16. Disposal and recycling

The equipment is supplied in packaging to prevent it from being damaged in transit. The raw materials in this packaging can be reused or recycled. The equipment and its accessories are made of various types of material, such as metal and plastic. Defective components must be disposed of as special waste. Ask your dealer or your local council.

Old devices must not be disposed of with household waste!



This symbol indicates that this product must not be disposed of together with domestic waste in compliance with the Directive (2012/19/EU) pertaining to waste electrical and electronic equipment (WEEE). This product must be disposed of at a designated collection point. This can occur, for example, by handing it in at an authorised collecting point for the recycling of waste electrical and electronic equipment. Improper handling of waste equipment may have negative consequences for the environment and human health due to potentially hazardous substances that are often contained in electrical and electronic equipment. By properly disposing of this product, you are also contributing to the effective use of natural resources. You can obtain information on collection points for waste equipment from your municipal administration, public waste disposal authority, an authorised body for the disposal of waste electrical and electronic equipment or your waste disposal company.

* = Included in Assembly A (Handle Arm -Right)
 ** = Included in Assembly B (Handle Arm -Left)

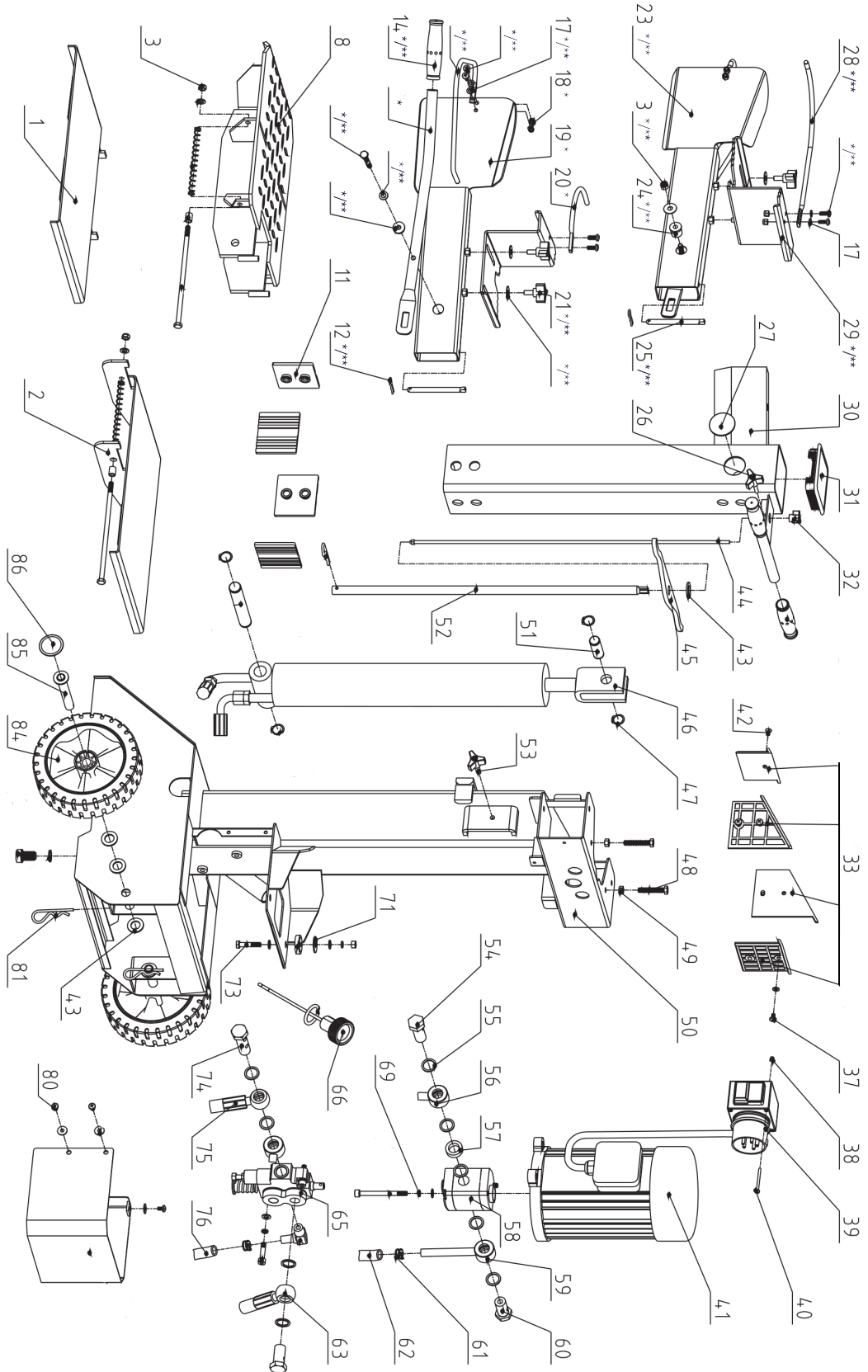

ID	PART No	DESCRIPTION
1	MI5905309001	SIDE SUPPORT
2	MI5905309002	SIDE SUPPORT
3	MI02098505	LOCK NUT M8
8	MI5905310001	LOG SUPPOTY
11	MI3905301015	LINING PLATE
12	MI1905501013	CLIP
14	MI3905314013	HAND GRIP
17	MI02012504	WASHER
18	MI02098504	LOCK NUT M6
19	MI5905310002	ARM GUARD RH
20	MI5905309006	RETAINER RH
21	MI15400359	HAND WHEEL
23	MI5905310003	ARM GUARD LH
24	MI3905314029	BUSH
25	MI3905314021	PIN
26	MI05006024	HAND WHEEL M6
27	MI3905301042	CAP
28	MI5905309008	RETAINER LH
29	MI5905309009	CLAMP
30	MI3905314073	ANVIL
31	MI3905301035	SQUARE CAP
33	MI3905314075	SLIDER PACK
37	MI05005401	SCREW M6X12
38	MI02098502	LOCKNUT M4
39	MI16040888	SWITCH ASSEMBLY - 230V
40	MI02798513	SCREW M6X40
41	MI5905303026	MOTOR AND SWITCH ASSEMBLY - 3KW 230V 50Hz
42	MI05005410	SCREW M6X10
43	MI02012510	WASHER
44	MI3905314057	PULL ROD
45	MI3905314056	LEVER
46	MI3905314074	CYLINDER
47	MI01047119	CIRCLIP
48	MI01093371	BOLT M8X50
49	MI01093405	NUT M8
50	MI5905310004	MAIN FRAME
51	MI3905314055	PIN - SHORT
52	MI3905314052	TUBE

53	MI05006009	HAND WHEEL
54	MI16040811	OIL PLUG
55	MI16040812	WASHER
56	MI3905314062	OIL HOSE
57	MI3905314063	COLLAR
58	MI5905303087	PUMP
59	MI3905314041	NOZZLE
60	MI16040688	OIL PLUG
61	MI05009402	HOSE CLAMP
62	MI16040660	OIL HOSE
63	MI3905314042	OIL HOSE
65	MI5905303064	VALVE
66	MI5905402093	DIPSTICK
69	MI02013707	SPRING WASHER
73	MI02093370	BOLT M8X45
74	MI16040815	OIL PLUG
75	MI3905314043	OIL HOSE
76	MI3905402055	OIL HOSE
80	MI05005401	SCREW M6X12
81	MI05003803	CLIP
84	MI3905301022	WHEEL
85	MI3905314048	WHEEL AXLE
86	MI16040497	WHEEL CAP
88	MI05003803	CLIP
*	MI5905310005	HANDLE ARM ASSEMBLY RH
**	MI5905310006	HANDLE ARM ASSEMBLY LH
Not drawn	MI16040512	MOTOR FAN
Not drawn	MI3905312051	FAN COVER
Not drawn	MI3905305021	ADJUSTMENT SHIM - SIDE
Not drawn	MI3905305020	ADJUSTMENT SHIM - FRONT
Not drawn	MI16040891	CAPACITOR 230V

EC Declaration of Conformity

We herewith declare

that the following machine complies with the appropriate basic safety and health requirements of the EC Directive based on its design and type, as brought into circulation by us.

In case of alteration of the machine, not agreed by us, this declaration will lose its validity.

Description : Log Splitter
Type: 65887A (MITOX 801 LSV)
Test report No. AM 50414808 0001 / 17703106 029

Applicable EC Directives : EC Directive of Machinery (2006/42/EC)
 EC Directive of Electromagnetic
 Compatibility (2014/30/EU)

Applicable Harmonized Standards: EN 60204-1:2006+A1:2009+AC:2010;
 EN 609-1:2017
 EN 55014-1:2017
 EN 55014-2:2015
 EN 61000-3-2:2014
 EN 61000-3-11:2000

Name of Company: TIYA International Co., Ltd.
Address: B12B, Shenye Center, 9 Shandong Road,
 Qingdao, China
Tel: (532) 8582 3333
Fax: (532) 8582 4444
Name / Title: Yuan Yue/ Director

Singature:

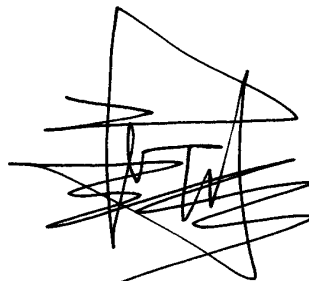

Place / Date: Qingdao, China / 30/08/18

CONDITIONS OF WARRANTY

The manufacturer warrants the product against faulty materials and workmanship for a period of 2 years from the date of first purchase. The warranty is applicable when the product is used in a "home owner" application. If products are used for commercial or professional purposes, the warranty period is for 3 months from the date of first purchase. Warranty does not extend to failure due to fair wear and tear.

The manufacturer undertakes to replace any spare parts that are classified as defective by an appointed Mitox service dealer. The manufacturer will not accept liability for the replacement of the machine, either partially or wholly, and/or consequential damages, and/or interest charges either directly or indirectly.

Warranty does not cover failure due to:

- Insufficient maintenance.
- Incorrect fuel or stale fuel.
- Abnormal use or accidental damage.
- Incorrect assembly, adjustment or operation of the product.
- Spare parts that are subject to wear e.g. safety parts, blades, blade supports, bearings, cables, guards, deflectors, spark plugs, air filters etc.

Neither does warranty extend to:

- Freight and packing costs.
- Use of non-genuine spare parts i.e. those from another manufacturer.
- Use of the machine for any other purpose than that for which it was designed.
- Use and maintenance of the machine in a manner not described in the owner's manual.

As part of our policy of continuous product improvement, we reserve the right to alter or amend this specification without notice. As a result, the product may differ from the information contained herein, but any alteration will only be implemented without notice if it is classified as an improvement to the above specification.

READ THE MANUAL CAREFULLY BEFORE OPERATING THE MACHINE

When ordering spare parts, please quote the part number, this can be found in the parts list included in this manual.

Retain the receipt of purchase without which no warranty can be offered.

Distributed by Mitox Garden Machinery
Wincanton Business Park
Wincanton
Somerset
BA9 9RS

www.mitox.co.uk

For more information on the Mitox[®] range of garden products please visit our website:

www.mitox.co.uk