



INSTRUCTION MANUAL

33cm Electric Lawnmower

Model No: QG33-1200
Product No: 1938283001

ASSEMBLY REQUIRED
SAVE THESE INSTRUCTIONS

Please read & understand this manual, paying attention to the safety instructions, before use.

Incorrect use of the product could put the operator or machine in danger.

Whilst every effort has been made to ensure the accuracy of information contained in this manual, our policy of continuous improvement determines the right to make modifications without prior warning.

Images used are for illustration purposes only.

Copyright Notice

Copyright © Handy Distribution

Permission is granted to reproduce this publication for personal & educational use only.

Commercial copying, redistribution, hiring or lending is prohibited.

No part of this publication may be stored in a retrieval system or transmitted in any other form or means without written permission from Handy Distribution.

In all cases this copyright notice must remain intact.

CONTENTS

SPECIFICATION
IMPORTANT INFORMATION
GENERAL SAFETY INSTRUCTIONS
KNOW YOUR MACHINE
ASSEMBLY
OPERATION
MAINTENANCE & STORAGE
TROUBLE SHOOTING
PARTS DIAGRAM & LIST
DECLARATION OF CONFORMITY
WARRANTY

**If you require any assistance with regards to the contents or operation of your machine,
please contact us:**

TEL: 01793 333212

EMAIL: CUSTOMERSERVICE@HANDYDISTRIBUTION.CO.UK

**Opening hours weekdays: February to October 8:30am - 5:30pm / November to January
8:30am - 5:00pm (Closed Bank Holidays)**

SPECIFICATION

The manufacturer reserves the right to change the product specification and livery according to continued product improvements.

Model	QG33-1200
Product Number	1938283001
Voltage	220-240V, 50Hz
Power	1200W
Working Width	330mm
Drive Type	Hand Push
Cutting Heights	20-40-60MM
Collector Capacity	30L
Deck	Plastic
Front / Rear Wheel	140mm / 160mm
Guaranteed Noise Power Level (L _{WA})	96 dBA - uncertainty: 3.0 dB(A)
Emission Sound Pressure Level (L _{PA})	81.0 dB(A)
Vibration (a _{hv})	2.85 m/s ² - uncertainty K: 1.5 m/s ²

IMPORTANT INFORMATION



WARNING

Read this instruction manual carefully before operating this machine. Make sure that you are familiar with the controls and properly operate the machine. Following these instructions can reduce the risk of fire, electric shock and personal injury.

IF NOT USED PROPERLY THIS MACHINE CAN BE DANGEROUS!

This machine can cause serious injury to the operator and others, the warning and safety instructions must be followed to ensure reasonable safety and efficiency in using this product. The operator is responsible for following the warning and safety instructions in this manual and on the machine. Never use the product unless the grass box or guards are correctly positioned.

DESIGNED FOR DOMESTIC USE ONLY.

This machine is to be used exclusively for cutting natural grass. Never use the mower for other purposes. Any other use can endanger your safety and can involve damage to the mower. Persons under 16 years of age and persons who are not familiar with the user instructions must not use the mower.

The user is responsible for the safety of other people in the working area. Keep children and domestic animals at a safe distance while the mower is in use.

Before mowing, remove all foreign objects from the lawn which may be thrown by the machine, stay alert for any foreign objects which may have been missed.

These operating instructions must be kept and referred to in order to ensure that the equipment is properly used and maintained. The instructions contain valuable information on operating, maintenance and servicing conditions.

TRAINING

Read the instructions carefully: Be familiar with the controls and the proper use of the equipment.

Never allow children or people unfamiliar with these instructions to use the product. Local regulations can restrict the age of the operator.

Never operate while people, especially children, or pets are nearby.

Keep in mind that the operator or user is responsible for accidents or hazards involving the machine that occur to other people or their property.



WARNING

The equipment is to be used only for its prescribed purpose. Any other use is deemed to be a case of misuse. The user/operator and not the manufacturer will be liable for any damage or injuries of any kind caused as a result of this.

Please note that our equipment has not been designed for use in commercial, trade or industrial applications. Our warranty will be 90 days from the original date of sale for commercial, trade or industrial businesses or for equivalent purposes.

GENERAL SAFETY INSTRUCTIONS

It is important that you read and understand the owner's manual and labels affixed to the machine. Learn its application and limitations as well as the specific potential hazards. Retain these instructions for future reference. The operator is responsible for following the warnings & instructions in this manual and on the product.

	Read & understand operator's manual before using the machine. Failure to follow instructions could result in death or serious injury. Please keep in a safe place for future reference.		Always wear eye and ear protection
	Keep all bystanders & animals away from the machine during operation. If approached, stop the machine immediately.		Always wear gloves to protect your hands. SHARP ROTATING BLADES
	Before working or undertaking any servicing or cleaning of the machine, ensure the electrical cable is removed from the power source.		Wear foot protection or sensible shoes when using the machine
	WARNING Remove the plug from the power source immediately if the cable is damaged or cut.		Do not expose to rain or damp conditions.
	Keep electrical cable away from cutting blade		Moving Parts Rotating parts can contact or entangle hands, feet, hair, clothing or accessories. Traumatic amputation or severe laceration can result
	Keep guards in place and in working order. Replace damaged, missing or failed parts before using it.		Safety alert symbol. Used to alert you to potential personal injury hazards. Obey all safety messages that follow this symbol to avoid possible injury.
	Indicates an imminently hazardous situation which, if not avoided, will result in serious injury		Indicates a potentially hazardous situation which, if not avoided, could result in serious injury
	Indicates a potentially hazardous situation which, if not avoided, may result in minor or moderate injury.		Used without the safety alert symbol indicates a potentially hazardous situation which, if not avoided, may result in property damage.
	CE Marking - the product meets demand and regulations set by the EU		Noise Level - See label on machine



According to the European directive 2012/19/EU for Waste Electrical and Electronic Equipment and its implementation into national law, electrical and electronic equipment that are no longer usable must be collected separately and disposed of in an environmentally correct manner.



GENERAL SAFETY RULES



Before you put the machine into operation, you must read this instruction manual. When using this machine, observe the following safety instructions to exclude the risk of personal injury or material damage. Please also observe the special safety instructions in the respective chapters. Where applicable, follow the legal directives or regulations for the prevention of accidents in relation to the use of this machine.



WARNING

When using electric tools, basic safety precautions, should always be followed to reduce the risk of serious personal injury and/or damage to the unit.



DANGER

**Danger from contact with live parts!
Immediately disconnect the plug from the mains if the extension lead is damaged or severed!**

TRAINING



The operator must receive proper training in the use, adjustment and operation of the machine, including prohibited operations.

1. Read the instructions carefully. Be familiar with the controls & proper use of the equipment. Spend time to familiarise yourself with your machine before each use.
2. Never allow children or people unfamiliar with these instructions to use the machine. Local regulations can restrict the operator age.
3. This machine is not intended for use by persons (including children) with reduced physical, sensory or mental capabilities, or lack of experience and knowledge, unless they have been given supervision or instruction concerning use of the machine by a person responsible for their safety.
4. Never work while people, especially children, or pets are nearby.
5. The operator or user is responsible for accidents or hazards occurring to other people or their property.

ELECTRIC SAFETY

1. The domestic mains voltage must match the mains voltage specifications in the technical data; do not use any other supply voltage.
2. The fuse must be a residual current circuit- breaker with a measured residual current of no more than 30 mA.
3. Ensure any extension lead used with this product, meets the minimum requirements of the machine and is suitable for outside use.
4. Damaged or brittle machine cables or extension leads must not be used.
5. Always check the condition of your cable or extension lead before operating the machine.
6. Always keep cable & extension lead out of the cutting area and routed away from the machine.
7. Never run over the cable or extension lead with the lawnmower.
8. Protect the machine against moisture.

SAFETY INSTRUCTIONS FOR WORKING WITH YOUR LAWMOWER

1. Operate in daylight or good artificial lighting. If possible, do not use on overly wet ground.
2. Ensure good stability on slopes. Always operate across the slope, never up and down.
3. Be particularly careful if changing direction of travel on the slope.
4. Do not operate on steep slopes.
5. Operate whilst walking, do not run.
6. Be particularly careful when you turn or when you pull the machine towards you.
7. Stop the motor and blade, if it is to travel across other areas or must be transferred to/from working area.
8. Never use the machine with damaged safety protection guards.
9. Do not change the motor regulation set up.
10. Carefully start the motor. Keep your feet clear of the blade.
11. Never reach behind or under the rotating parts with hands or feet.
12. Never lift or carry the machine while the motor is on.
13. Switch the motor off and remove electrical plug from the power source, before unblocking or removing obstacles from the blade or exit chute:
 - Before releasing blockages, inspecting, cleaning or working on the machine.
 - After hitting an obstruction. Search for damage on the machine & make repairs as necessary. If the machine starts vibrating unusually, it should be inspected by an Approved Service Dealer.

WORK AREA

1. Keep work area clean and well lit. Cluttered and dark areas invite accidents.
2. Check the landscape where the machine will be used and remove all objects such as stones, toys, sticks and wires, which could be caught and thrown away from the work area. Damage of the machine or operator's injury could be caused.
3. Do not operate this machine in explosive atmospheres, in the presence of flammable liquids, gases or dust. Machines create sparks which may ignite the dust or fumes.
4. Keep children & bystanders away while operating the machine. Distractions can cause you to lose control.

PERSONAL SAFETY

1. This machine is not intended for use by persons (including children) with reduced physical, sensory or mental capabilities, or lack of experience and knowledge, unless they have been given supervision or instruction concerning use of the machine by a person responsible for their safety.
2. Children should be supervised to ensure that they do not use or play with the machine.
3. Stay alert, watch what you are doing and use common sense when operating this machine.
4. Do not use this machine while you are tired, ill or under the influence of drugs, alcohol, or medication. A moment of inattention while operating this machine can cause you to lose control & may result in serious personal injury.
5. Do not overreach. Always keep proper footing and balance. This enables better control of the tool in unexpected situations.
6. Remove any adjusting tools before turning the machine on. A tool that is left attached to a rotating part of the machine may result in personal injury.
7. Use safety equipment. Always wear eye protection. Safety equipment such as a dust mask, non-skid safety shoes, hard hat, or hearing protection used for appropriate condition will reduce personal injuries.
8. Dress properly. Do not wear loose clothing or jewellery. Keep your hair, clothing & gloves away from moving parts. Loose clothes, jewellery or long hair can be caught in moving parts. Wear foot protection or sensible shoes when using the machine.
9. Prolonged use of the machine may lead to disorders of blood circulation in hands caused by vibration. These effects can be worsened by low ambient temperatures and/or by gripping the handgrips excessively tightly. Period of use you can extend with appropriate gloves or regular breaks. Take frequent work breaks. Limit the amount of

exposure per day.

10. Do not force the machine. Use the correct machine for your application. The correct machine will do the job better and safer at the rate for which it was designed.
11. Do not use the machine if the trigger levers do not work to turn the machine off. Any machine that cannot be controlled with the trigger levers is dangerous and must be repaired.
 1. Turn machine off completely and the electrical plug removed from the power source before making any adjustments, changing accessories, or storing. Such preventive safety measures reduce the risks of starting the machine accidentally.
 2. Store idle machines out of the reach of children and do not allow persons unfamiliar with the machine or these instructions to operate. Electric machines are dangerous in the hands of untrained users.
 3. Maintain your machine. Check for misalignment or binding of moving parts, breakage of parts & any other condition that may affect the operation. If damaged, have the machine repaired by an Approved Service Dealer immediately. Many accidents are caused by poorly maintained machines.
 4. Use the machine, accessories and tool bits etc., in accordance with these instructions and in the manner intended for the particular type of electric machine, taking into account the working conditions and the work to be performed. Use of the machine for operations different from intended could result in a hazardous situation.

PERSON PROTECTION

1. In case of any injury, always proceed in accordance with the principles of first aid.
2. If someone is cut, cover the wound with a clean cloth & press hard to stop the flow of blood.
3. Individuals with poor circulation who are exposed to excessive vibration may experience injury to blood vessels or the nervous system. Vibration may cause the following symptoms to occur in the fingers, hands or wrists: numbness, tingling, pain, stabbing sensation, alteration of skin colour or of the skin. If any of these symptoms occur, see a doctor.

Put safety first in the case of fire:

4. If fire comes from the motor appears, at first distance yourself from the product to ensure your physical safety.
5. Use a dry powder fire extinguisher on the fire to prevent it from spreading.
6. A panicked reaction could result in the fire and other damage becoming more extensive.

KNOW YOUR MACHINE

1. Trigger	2. Upper Handle
3. Lower Handle	4. Safety Button
5. Rear Wheel	6. Front Wheel
7. Cutting Deck	8. 30L Grass Collector
9. Handle Knob	

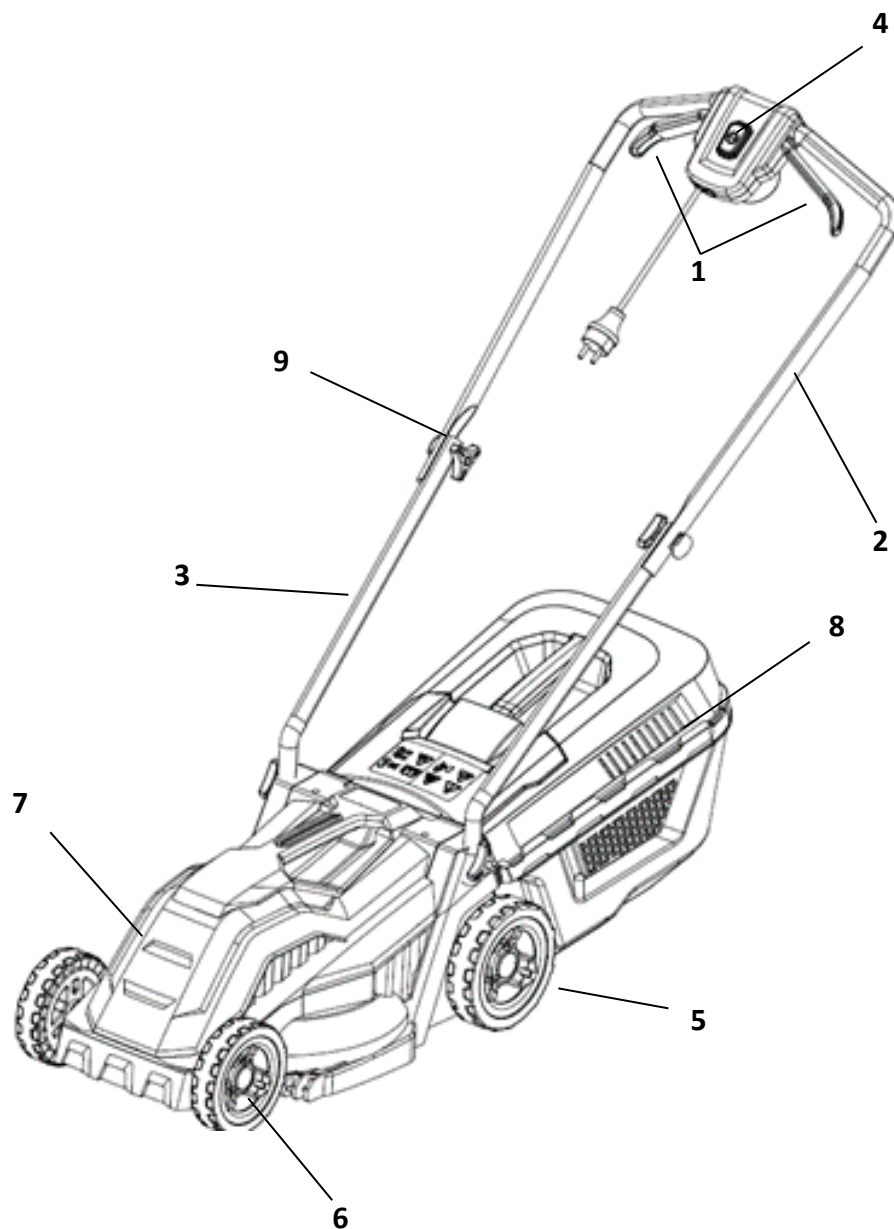

ASSEMBLY



WARNING

Stop the motor and unplug the electrical cable before any repairs or maintenance operations.

DO NOT attempt to start this machine without it first being FULLY assembled.

LOWER HANDLES

1. Insert the lower handle against the fixed bolt of the machine, located above the rear wheel.
2. Secure with the handle knob.
3. Repeat on the opposite side of the lawnmower.

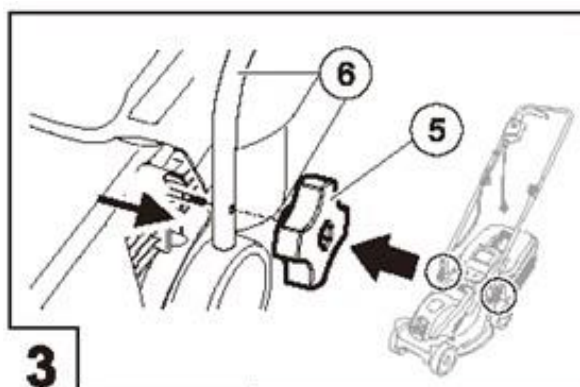

UPPER HANDLES

1. Position the upper handle over the lower handles, aligning the holes in the upper handle with those in the lower handles.
2. Insert the bolt through the handle assembly.
3. Secure with the handle knob.
4. Repeat on the opposite side of the lawnmower.

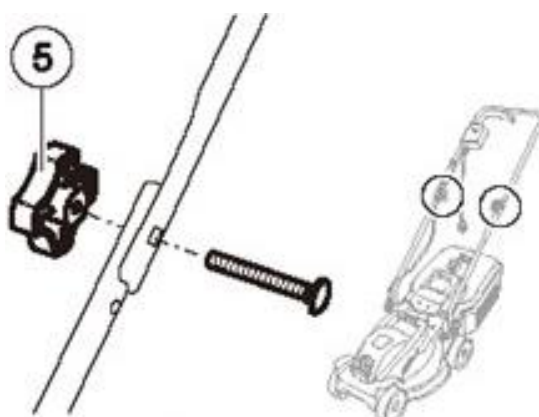

CABLE TIDY

1. Place the cable into the fixed cable tidy.

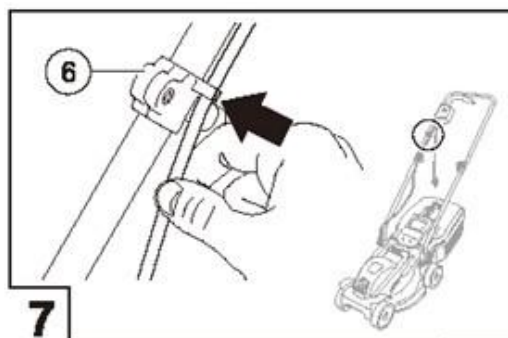

GRASS COLLECTOR

1. Snap the handle into the collector top.

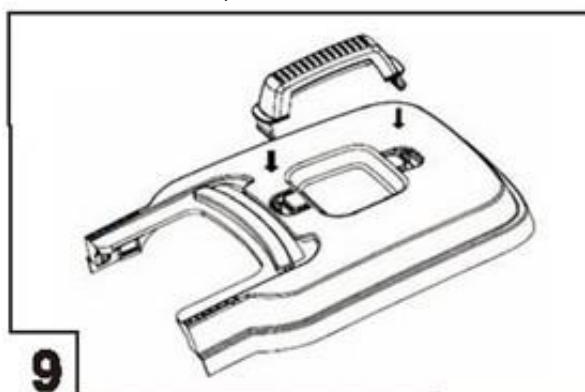

2. Attached the two lower halves of the collector together.
3. Attach the collector top to the assembled collector bottom.

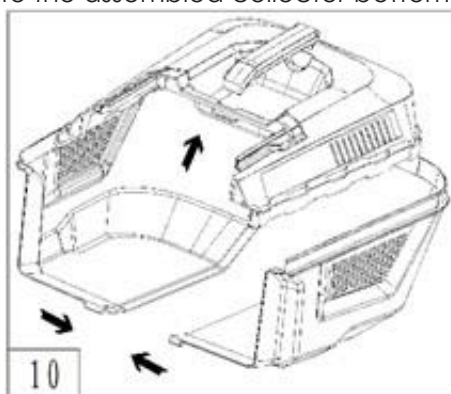

4. Left the grass collector flap up, so that it opens past the handle assembly. Hold in position and place the grass collector on the hooks on the back of the deck and place into position.
5. Lower the grass collector flap to sit onto the grass collector.

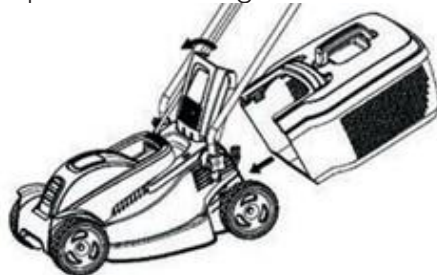

HEIGHT OF CUT

The machine has been supplied with three cutting heights from 20-40-60 mm.

1. Adjusting the height of cut should only be undertaken when the motor is off, and the electrical plug removed from the power source and the blade has come to a complete standstill.
2. To adjust the cutting height, move front and rear axles up and down the height gauge.
3. Ensure both axles are located at the same cutting height, to ensure an even cut.

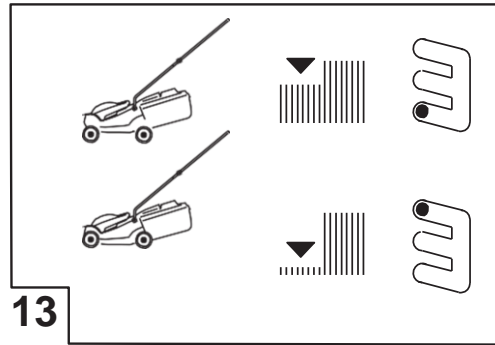
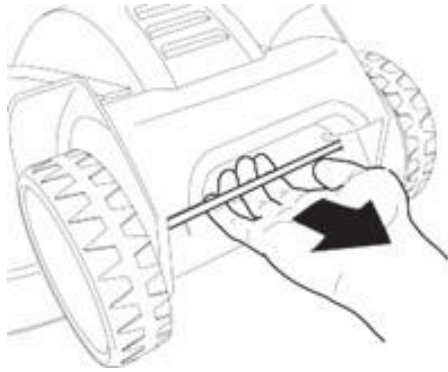

OPERATION

MOTOR STARTING & STOPPING PROCEDURE

NOTE:

Only start the lawnmower on even ground and not in long grass. The ground must be free of foreign bodies, such as stones. Do not lift the lawn mower to start it.

STARTING THE MOTOR

1. Press the safety button. Do not release.
2. Lift the trigger lever the upper handle.
3. The motor will now begin, and the cutting blade rotates.
4. Release the safety button.

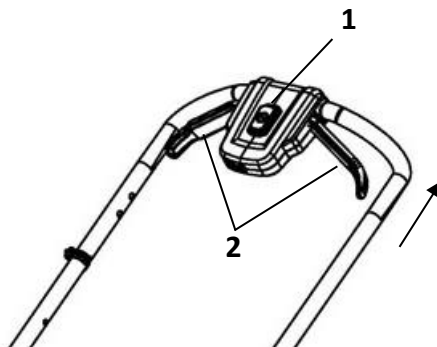

STOPPING THE MOTOR

1. Release the trigger lever. The motor will come to a stop and a couple of seconds later, the blade will stop rotating.

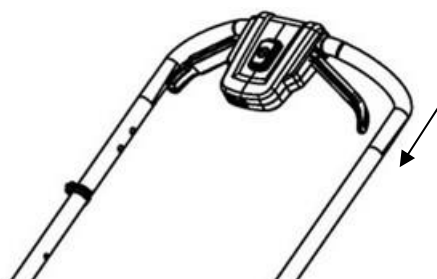

MOWING WITH COLLECTOR



WARNING

Always observe the strictest safety procedures when using the lawnmower. Carefully read the safety instructions of this manual before using the lawnmower.

Never open the rear flap when the grass bag has been detached (to be emptied) and the motor is still running. The rotating blade can cause serious injuries!

1. Select your required height of cut setting.
2. Start the motor and allow it to run.
3. Keep a firm grip on the upper handle with trigger lever always engaged when attempting to cut.

EMPTYING THE GRASS BAG

As soon as grass clippings start to trail the lawnmower, it is time to empty the grass bag.

NOTE:

Before taking off the grass collector, switch off the motor & wait for the blade has come to a stop. Remove the electrical plug from the power source

1. To take off the grass collector, use one hand to lift the rear collector cover and the other to grab onto the grass collector carry handle. The rear collector cover automatically falls after removing the grass collector and closes off the rear chute opening.
2. Empty the grass debris from the grass collector and refit.

NOTE:

If any grass residue is caught in the discharge chute, clean it using a brush. Do not remove grass debris in the mower deck or on the blade by hand or with your feet. Instead use suitable tools such as a brush or broom. To ensure that the cut grass can be collected into the grass collector, the discharge opening and inside the mower deck must be cleared of any blockage.

MOWING TIPS

1. Start mowing as close as possible to the power socket.
2. Always keep the electrical cable and any extension lead on the section of lawn than has already been mown.
3. Maintain a constant cutting height of 30–50mm; do not shorten the grass to less than half its original height.
4. Do not overload the lawnmower! If the motor speed drops perceptibly due to long, heavy grass, increase the cutting height and mow several times.
5. Mow in the morning or late afternoon to prevent the freshly cut grass from drying out, especially in hot, dry seasons
6. During phases of strong growth, mow twice weekly; in periods of low rainfall, increase intervals between mowing accordingly.

MOWING INSTRUCTIONS

1. Walk, never run with the mower, be very careful when mowing uneven or rough ground.
2. Be careful when changing the direction of the mower on a slope. Mow across the face of slopes, never down or up.
3. Do not mow excessively steep slopes.
4. Best results will be achieved if the grass is dry. Wet grass will clog the blade & grass collection system.
5. Grass grows at different rates at different times of the year. Never use the lowest cutting height for the first cut of the season or in drought conditions.
6. Do not remove grass debris in the mower deck or on the blade by hand or with your feet. Instead use suitable tools such as a brush or broom.
7. Check that all nuts, bolts and screws are well tightened.
8. Before mowing, place the grass collector in its position.
9. Before mowing make sure that the blade and the blade fixing screw are securely fastened. When blade cutting edges require re-sharpening, this must be done evenly on both sides, to prevent any imbalance. If you are unsure how to sharpen the blade, please visit an Approved Service Dealer. If the blade is damaged, it must be replaced.
10. When mowing, always wear a long trousers and strong footwear.
11. Work only when there is enough light.
12. Turn off the motor and remove the electrical plug from the power source, if you must leave the lawnmower unattended.
13. Never lift the rear of the mower while starting the motor. Never place your hands and feet underneath the deck or into the rear discharge chute while the motor is running.
14. Never change in any way the rated speed of the motor.
15. Never lift or carry the mower while the motor is running.
16. Stop the motor and remove the electrical cable from the power source in these cases:
 - Before any operation under the deck or the rear discharge chute.

- Before any maintenance, repairing or checking operations.
- Before carrying, lifting or removing the mower.
- If you leave the mower unattended or changing the cutting height.
- To remove and emptying the grass catcher.
- After hitting a foreign object, stop the motor and check thoroughly the mower in order to see if it is damaged. Take the machine to a local Approved Service Dealer for inspection if necessary. Repairs of this nature are not covered under the Manufacturer's warranty.
- If the mower vibrates in an abnormal way, find the reasons why, and take your mower to a local Approved Service Dealer.



WARNING

After the motor has stopped, the blade will still rotate a couple of seconds.



CAUTION

Operating on gradients could cause the machine to tip over.

Allowing anyone to operate this machine without proper instruction may result in injury.

Wear sturdy, full coverage footwear. Operating this machine with bare feet, or with open toe shoes or sandals increases your risk of injury.

Do not use the machine at night or in poor light.

Be sure to transport the machine from one place to another with the motor off.

Be sure to wear heavy gloves when cleaning underside of the deck or handling the blade.

To prevent damage, check the machine for any signs of damage or other faults when operated.

MAINTENANCE & STORAGE



WARNING

Improper maintenance & storage of the machine may void your warranty. Keep the machine clean for better and safer performance.

Turn off the motor and remove the electrical plug from the power source before performing any maintenance.

MAINTENANCE

Use only original equipment replacement parts. Other parts may not perform as well, may damage the unit and may result in injury. In addition, use of other parts may invalidate your warranty.

- Before each use, check all nuts & bolts to be sure they are sufficiently tightened.
- We recommend only manufacturer original parts are used when maintaining this machine. Failure to do so could invalidate your manufacturer's warranty.
- The motor must be switched off and the electrical plug removed from the power source, before the machine is unassembled, cleaned, serviced or maintained.

CLEANING



CAUTION

Do not use a water hose or pressure washer to clean the machine. Water can damage the motor.

- Keep your machine clean. Thoroughly clean the machine at the end of each use.
- Clean the motor air vents with a cloth or brush. Motor air vents should be free from debris to allow air circulation around the motor during use.
- Clean the underside of the deck with a stiff brush, before any maintenance is undertaken to the blade.
- Remove the belt casing by removing the screws and clean around the transmission and drive belts with a brush or compressed air once or twice a year.

GRASS COLLECTOR CLEANING

- Pores in the grassbox can become filled with dirt and dust, during use and will collect less grass. To prevent this, regularly hose the catcher off with water and let dry before using.

STORAGE & TRANSPORT

The following steps should be taken to prepare your machine for storage.

STORING THE LAWNMOWER

- Always unplug the machine from the mains for storage.
- For trouble free service, make sure the machine is clean and dry before storing.
- Please ensure the machine is stored away from direct sunlight.
- Store indoors or in a safe, locked protected area during severe weather and winter months.
- If storing for an extended period, inspect, clean and repair the machine if necessary. Store in a clean, dry, dust free area.
- Ensure the machine is stored in a position, where any persons cannot step on to attempt to reach items up high, due to risk of movement.

TRANSPORT

- Always unplug the machine from the mains for storage.
- Use the original packaging to ship whenever possible.

TROUBLE SHOOTING



WARNING!

Only perform the steps described in these instructions!

All further inspection, maintenance and repair work must be performed by an authorised service specialist!

Contact your local authorised service dealer if the problem cannot be solved by yourself!



WARNING!

If the product does not perform properly, makes unusual sounds, the motor does not start or stop as described, the cutting device does not work properly, or any other irregularity or malfunction occurs, do not attempt to repair the product by yourself.

PROBLEM	POSSIBLE CAUSES	REMEDIAL ACTION
Motor does not start	No power supply	Check fuse / extension lead.
	Machine cable defective	Contact Approved Service Dealer.
	Blade jammed	Clean exit chute: the blade must rotate freely. Start on low grass or on the section of lawn that has already been mown; correct the cutting height.
Loss of motor performance	Too much grass in the exit chute.	Clean exit chute: the blade must rotate freely. Start on low grass or on the section of lawn that has already been mown; correct the cutting height.
	Blade blunt	Contact Approved Service Dealer and have the blade sharpened/replaced.
Grass collection box does not fill up sufficiently	Lawn wet	Allow the lawn to dry.
	Grass collection box clogged	Clean the vents grass collector.
	Too much grass in exit chute channel	Clean exit chute. Correct the cutting height
	Blade blunt	Contact Approved Service Dealer and have the blade sharpened/replaced.

This exploded view diagram illustrates the assembly of a robotic vacuum cleaner. The components are organized into two main groups: A (top) and B (bottom).

Group A Components:

- A-1: Small circular component (possibly a filter or cap).
- A-2: Small rectangular component.
- A-3: Small rectangular component.
- A-4: Small rectangular component.
- A-5: Small rectangular component.
- A-6: Small rectangular component.
- A-7: Long, thin component (possibly a sensor or antenna).
- A-8: Small rectangular component.
- A-9: Small rectangular component.
- A-10: Curved component (possibly a bumper or sensor).
- A-11: Small rectangular component.
- A-12: Small rectangular component.
- A-13: Small rectangular component.
- A-14: Small rectangular component.
- A-15: Small rectangular component.
- A-16: Long, thin component (possibly a sensor or antenna).
- A-17: Small rectangular component.
- A-18: Small rectangular component.
- A-19: Small rectangular component.
- A-20: Small rectangular component.
- A-21: Small rectangular component.

Group B Components:

- B-1: Motor assembly.
- B-2: Gear or pulley.
- B-3: Gear or pulley.
- B-4: Gear or pulley.
- B-5: Gear or pulley.
- B-6: Gear or pulley.
- B-7: Gear or pulley.
- B-8: Gear or pulley.
- B-9: Gear or pulley.
- B-10: Gear or pulley.
- B-11: Gear or pulley.
- B-12: Gear or pulley.
- B-13: Gear or pulley.
- B-14: Gear or pulley.

The diagram also shows the main body of the vacuum cleaner, which is composed of several parts including the top cover, side panels, and internal components. The main body is shown in a disassembled state, with various parts labeled C-1 through C-35. The main body parts include:

- C-1: Main body housing.
- C-2: Main body housing.
- C-3: Main body housing.
- C-4: Main body housing.
- C-5: Main body housing.
- C-6: Main body housing.
- C-7: Main body housing.
- C-8: Main body housing.
- C-9: Main body housing.
- C-10: Main body housing.
- C-11: Main body housing.
- C-12: Main body housing.
- C-13: Main body housing.
- C-14: Main body housing.
- C-15: Main body housing.
- C-16: Main body housing.
- C-17: Main body housing.
- C-18: Main body housing.
- C-19: Main body housing.
- C-20: Main body housing.
- C-21: Main body housing.
- C-22: Main body housing.
- C-23: Main body housing.
- C-24: Main body housing.
- C-25: Main body housing.
- C-26: Main body housing.
- C-27: Main body housing.
- C-28: Main body housing.
- C-29: Main body housing.
- C-30: Main body housing.
- C-31: Main body housing.
- C-32: Main body housing.
- C-33: Main body housing.
- C-34: Main body housing.
- C-35: Main body housing.

PARTS LIST - QG33-1200 (1938281001)

Item No.	Part No.	Description	Qty
A	QG123-ZAKGH360025	Switch Assembly	1
A-16	QG125-GKDA0000001	Upper Handle	1
A-17	QG125-GKDB0000001	Lower Handle	2
A-18	QG123-GHAB0000010	Cable Clamp	2
A-19	QG123-B5019W00000	Washer	4
A-20	QG125-B1084W08040	Bolt M8x41	2
A-21	QG125-G33C1100025	Knob	4
B	QG125-ZADJ12X0000	1200W Motor Assembly	1
C-1	QG125-GHD1000001R	Grassbox Handle	1
C-2	QG125-GHD20000010	Grassbox Top	1
C-3	QG125-GHD3R000010	Grassbox Bottom Right	1
C-4	QG125-GHD3L000010	Grassbox Bottom Left	1
C-5	QG125-GHD4000001R	Rear Flap	1
C-6	QG125-GHD50000000	Spring	1
C-7	QG125-B1098B08060	Bolt M8x60	2
C-8	QG123-B3056B00000	Screw ST4.0X20-F	4
C-9	QG125-GHD70000010	Cutting Deck	1
C-10	QG125-GKD10000010	Deck Handle	1
C-11	QG125-GKD3000001R	Upper Deck	1
C-12	QG125-GKJFL000010	Motor Housing	1
C-13	QG123-B3058B00000	Screw ST4.0X16-C	20
C-14	QG125-BB005W00000	Pin D1.6X27	6
C-15	QG123-B5019W00000	Washer	6
C-16	QG125-GHD80000010	Front Wheel	2
C-17	QG125-GHD9000001R	Wheel Trim	2
C-18	QG125-GHDA0000000	Front Axle	1
C-19	QG125-GHDB0000000	Spring	4
C-20	QG125-GHDC0000000	Rear Axle	1
C-21	QG125-GKDD0000010	Rear Wheel	2
C-22	QG125-GKDE000001R	Wheel Trim	2
C-23	QG123-GHDF0000000	Blade Adaptor	1
C-24	QG125-SH513300000	Blade	1
C-25	QG123-E10BM200000	Blade Washer	1
C-26	QG123-B1109B10025	Blade Bolt	1
C-27	QG125-GJPZK000000	Plate	1
C-28	QG125-GKH00000000	Current Protection	1
C-29	QG125-GKD60000000	Connection Wire	2
C-30	QG123-GKJYXM00000	Wire Cap	3
C-31	QG123-GLB30000000	Capacitor	1
C-32	QG125-B3063B00000	Screw ST4.0X25-F	5
C-33	QG123-G37B0000000	Nylon Cable Tie	2
C-34	QG123-GHA70000010	Switch Lower Cover	1
C-35	QG125-GHDH0000000	Rear Roller Shaft	1
C-36	QG125-GHDGN000000	Rear Roller	1

EC DECLARATION OF CONFORMITY

Q Garden

We Handy Distribution Ltd - SN3 5HY (Importer) declare that the product:

Designation: Electric Hand Push 330mm Lawnmower

Model(s): QG33-1200

Product Number: 1938283001

Type/Serial No. As per rating label on machine

Motor Power: 1200W

Voltage: 220-240V, 50Hz

Electrical Safety Class: Class II

Complies with the following directives:

2006/42/EC – Machinery Directive

2000/14/EC & 2005/88/EC - Outdoor Noise Directive

The conformity assessment procedure followed was in accordance with

EN 60335-1:2012+A11:2014+A13:2017+A1:2019+A2:2019+A14:2019, EN 60335-2-77:2010,
EN62233:2008

Guaranteed Sound Power Level:

(L_{WA}) 96 dB(A)

Emission Sound Pressure Level:

(L_{PA}) 81 dB(A)

Vibration Measurement:

(a_{hv}) 2.85 m/s² - uncertainty K: 1.5 m/s²

Notified Bodies:

Intertek Testing Services Hangzhou

Address(es):

16 No.1 Ave., Xiasa Economic Development District, Hangzhou 3110018, P.R.C.

Authorised signatory & technical file holder

Date:

29/10/2020

Signature:



Name:

Mr Simon Belcher

Position:

Chairman

Company:

Handy Distribution Ltd

Address:

Murdock Rd, Dorcan, Swindon, Wiltshire, SN3 5HY.



GJ HANDY & CO LTD USER WARRANTY POLICY

Users Statement of Warranty

Each new machine is warranted against defective material or assembly of material under normal usage. The warranty applies to the original purchaser and covers faulty parts and the labour involved in replacing and repairing those parts, which are of original manufacture.

Period of Warranty

The Handy (Petrol & Electric only), Webb (excludes Dynamic, Heritage, Legacy), Sanli Engine

- a) 2 years from the original date of sale to the first domestic user.
- b) 90 days from the original date of sale to the professional/commercial user.
- c) 90 days from the original date of sale when used for hire.
- d) A reduced warranty period of 90 days applies to those items which are subject to normal wear and tear (e.g. but not limited to wheels, tyres, cutter bars, cylinders, cutting blades, blade boss, belts, cables, nylon line & spool, collection bags, spark plugs).
- e) Engines are supplied with a separate warranty to the machine. The engine manufacturers warranty statement which will be supplied within the engine instruction manual. All enquiries and warranty repairs should be discussed with the engine manufacturer or approved warranty repair dealer.
- f) 90 days from the original date of purchase for Replacement Spare Parts (unless normal wear & tear component, which are covered for 30 days).
- g) All machines' must be serviced within the first 12 months from the original date of purchase to comply with the warranty (if applicable), failure to do so will invalidate the 2nd year of the warranty.

Webb Dynamic, Heritage & Legacy, Handy (All non-Petrol & Electric), Mowerland, Q-Garden

- a) 1 year from the original date of sale to the first domestic user.
- b) 90 days from the original date of sale to the professional/commercial user.
- c) 90 days from the original date of sale when used for hire.
- d) A reduced warranty period of 90 days applies to those items which are subject to normal wear and tear (e.g. but not limited to wheels, tyres, cutter bars, cylinders, cutting blades, blade boss, belts, cables, nylon line & spool, collection bags, spark plugs).
- e) Engines are supplied with a separate warranty to the machine. The engine manufacturers warranty statement which will be supplied within the engine instruction manual. All enquiries and warranty repairs should be discussed with the engine manufacturer or approved warranty repair dealer.
- f) 90 days from the original date of purchase for Replacement Spare Parts (unless normal wear & tear component, which are covered for 30 days).

All warranty repairs must be undertaken by an authorised service dealer. These dealers have been accredited by GJ Handy & Co Ltd and agree to only use genuine parts and follow our repair procedures.

Not covered by this warranty

- a) The warranty policy does not cover any depreciation or damages caused by ordinary wear, rusting or corrosion, lack of correct maintenance or operation, misuse, abuse, lack of transportation or accident.
- b) The warranty policy does not cover any costs necessary for the standard periodic maintenance services instructed by the operator's manual, or service parts replacement which would include oil, filters, tyres, belts, brake linings, fuses, blades, seals and other service parts unless it can be proven that the item has evidence of faulty manufacture.
- c) The warranty policy will not cover failure or damage caused as a result of parts or accessories being modified without the written approval of GJ Handy & Co Ltd.
- d) The warranty policy will not cover the unit if non-genuine parts have been fitted and as a result damage has occurred to the unit.
- e) The warranty policy is non-transferable and is only applicable to the original purchaser.

Disclaimer

- a) This warranty is only a remedy for defect of products. GJ Handy & Co Ltd will never warranty in terms of the merchantability or the fitness for a particular purpose.
- b) No person is authorised to make any warranties, representations or promises, expressed or implied, on behalf of GJ Handy & Co Ltd, or to modify the terms conditions or limitation of this warranty policy in any way.
- c) Neither GJ Handy & Co Ltd nor any company affiliated with GJ Handy & Co Ltd shall be liable in any event or manner whatsoever for incidental or consequential damages or injuries, including, but not limited to, loss of crops, loss of profit, out of pocket expenses or profits, rental of substitute equipment or other commercial losses.

General

- a) Most warrantable failures show up within the first few weeks of use. These failures are usually straightforward and warranty assessment is relatively easy.
- b) Failures relating to cutter decks and belts need careful investigation, as the cause may not always be straightforward. Look for damage to blades and pulleys especially when the cutter belt or blade boss have snapped or cracked as this could be due to impact damage.
- c) Customers should always refer to the operator/instruction manual when any disputed problem arises, you will find most areas covered within the manual.

**For spares or support of your Q Garden product,
please contact us:**

Tel: 01793 333212

Email: customerservice@handydistribution.co.uk

Opening hours weekdays:

February to October 8:30am - 5:30pm

November to January 8:30am - 5:00pm

(Closed Bank Holidays)

**Distributed by
Handy Distribution,
Murdock Road,
Dorcan,
Swindon,
Wiltshire,
SN3 5HY,
UK**