



250W Electric
Line Trimmer
WEELT250
1938171001

Operator's Manual

Please read & understand this manual, paying particular attention to the safety instructions, before use.
The manufacturer reserves the right to change the product specification and livery according to continues product improvements.





CONTENTS

SPECIFICATION
IMPORTANT INFORMATION
GENERAL SAFETY INSTRUCTIONS
KNOW YOUR MACHINE
ASSEMBLY
OPERATION
CLEANING & MAINTENANCE
PARTS DIAGRAM & LIST
GUARANTEE
DECLARATION OF CONFORMITY

SPECIFICATION

Model	WEELT250
Product Number	1938171001
Motor Capacity	250W
Rated Voltage	230–240 V~50 Hz
Trimming Speed	13,000 min ⁻¹
Trimmer Line Diameter	1.2mm
Trimming Cutting Width	230mm
Protection Rating	II
Guarantee Sound Power Level	LWA 96 dB(A)
Vibration	2.5m/s ² , K=1.5dB
Weight	N.W 1.3kg

Consistent with our policy of continuous improvement, WEBB reserves the right to change the design and configuration of any of its products without notice or obligation. Therefore, please treat the text and images in this manual for illustrative purposes only. They may in no case serve as a basis for any legal claim.

If you require any assistance with regards to the contents or operation of your machine, please call our Customer Service Team on 01793 333212 or email customerservice@webbgardenpower.co.uk (Monday to Friday 8.00am to 5.30pm excl. Bank Holidays)



INSTRUCTION MANUAL



WARNING: Read this instruction manual carefully before operating this machine. Make sure that you are familiar with the controls and properly operate the machine. Following these instructions to reduce the risk of fire, electric shock and personal injury.

IF NOT USED PROPERLY THIS MACHINE CAN BE DANGEROUS!

This machine can cause serious injury to the operator and others, the warning and safety instructions must be followed to ensure reasonable safety and efficiency in using this product. The operator is responsible for following the warning and safety instructions in this manual and on the machine. Never use the product unless the fixing screws or guards are correctly positioned.

DESIGNED FOR DOMESTIC USE ONLY.

For use in private gardens are those with an annual use not generally exceeding 50 hours and that are primarily used for tending GRASS OR LAWN AREAS, but not in public facilities, parks or sports grounds and not for agricultural or forestry use. Compliance with the operating manual supplied by the manufacturer is a prerequisite for the proper usage of the lawn mower. The operating manual contains servicing and maintenance instructions as well as directions for use.

TRAINING

Read the instructions carefully: Be familiar with the controls and the proper use of the equipment.

Never allow children or people unfamiliar with these instructions to use the product. Local regulations can restrict the age of the operator.

Never operate while people, especially children, or pets are nearby.

Keep in mind that the operator or user is responsible for accidents or hazards involving the machine that occur to other people or their property.

GENERAL SAFETY INSTRUCTIONS

It is important that you read and understand the owner's manual and labels affixed to the machine. Learn its application and limitations as well as the specific potential hazards. Retain these instructions for future reference. The operator is responsible for following the warnings & instructions in this manual and on the product.

	Read & understand operator's manual before using the machine. Failure to follow instructions could result in death or serious injury.		DANGER Beware of sharp blades & nylon line, which will continue to move after the motor is switched off. The blades could reciprocate, even after the plug has been removed from the power supply.
	Wear gloves to protect your hands Wear safety shoes.		Check your machine before turning it on. Keep guards in place & in working order. Frequently check to see that foreign objects are removed from the working area before turning it on. Replace damaged, missing or failed parts before using it.
	Whenever the machine is in use, safety glasses must be worn to safeguard against flying objects. Hearing protection must also be used to protect the users hearing. Face masks are also recommended to avoid inhalation of debris.		Before working or undertaking any servicing or cleaning of the machine, ensure the electrical cable is removed from the power source.
	Keep all bystanders & animals at least 15 metres away from the machine during operation. If approached, stop the machine immediately.		Do not expose to rain or damp conditions
	Always disconnect your machine from the electrical supply before clearing, inspecting or adjusting any part of it, or if the supply cable has become damaged or entangled		Safety alert symbol. Used to alert you to potential personal injury hazards. Obey all safety messages that follow this symbol to avoid possible injury.
	Indicates an imminently hazardous situation which, if not avoided, will result in serious injury.		Indicates a potentially hazardous situation which, if not avoided, could result in serious injury.
	Indicates a potentially hazardous situation which, if not avoided, may result in minor or moderate injury.	CAUTION	Used without the safety alert symbol, indicates a potentially hazardous situation which, if not avoided, may result in property damage.
	Class II Protection		Sound Power Level (Image used for illustration purposes only, check machine and Declaration of Conformity for actual reading)
	According to the European directive 2012/19/EU for Waste Electrical & Electronic Equipment and its implementation into national law, electrical and electronic equipment that are no longer usable must be collected separately & disposed of in an environmentally correct manner.		Separate collection of used products and packaging allow materials to be recycled & used again. Reuse of recycled materials helps prevent environmental pollution and reduces the demand for raw material.
	CE marking is a certification mark that indicates conformity with health, safety, and environmental protection standards for products sold within the European Economic Area.		



INSTRUCTION MANUAL

PREPARATION

To operate this device safely, the user must have read and understood these instructions for use before using the device for the first time.

Observe all safety instructions! Failure to do so may cause harm to you and others.

Retain all instructions for use, and safety instructions for future reference.

If you sell or pass the device on, you must also hand over these operating instructions. The device must only be used when it functions properly. If the product or part of the product is defective, it must be taken out of operation and disposed of correctly. Never use the device in a room where there is a danger of explosion or near flammable liquids or gases.

Always ensure that a device which has been switched off cannot be restarted unintentionally.

Do not use devices with an on/off switch that does not function correctly.

Keep children away from the device! Keep the device out of the way of children and other unauthorised persons.

Do not overload the device. Do not use the device for purposes for which it is not intended.

Make sure to always wear the required personal protective equipment.

The clothing of the operator should be close fitting. Avoid wearing loosely fitting clothing. Wear sturdy footwear and long work trousers.

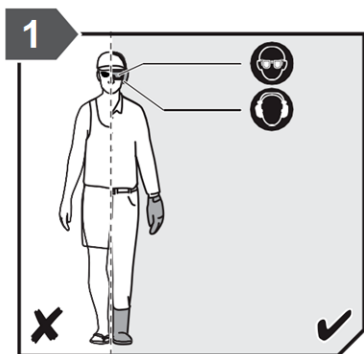

Always wear appropriate footwear, such as work boots, and trousers when operating the mower. Do not operate the equipment

when barefoot or wearing open sandals.

Always wear safety goggles or safety glasses with side shields when operating the machine.

Exercise caution and only work when in good condition: If you are tired, ill, if you have ingested alcohol, medication or illegal drugs, do not use the device, as you are not in a condition to use it safely.

This product is not intended to be used by persons (including children) or who are limited in their physical, sensory or mental capacities or who lack experience and/or knowledge of the product unless they are supervised, or have been instructed on how to use the product, by a person responsible for their safety.

Ensure that children are not able to play with the device.

Always comply with all applicable domestic and international safety, health, and working regulations.

RISKS CAUSED BY VIBRATIONS

The vibration values specified in the technical data represent the main uses of the device. The actual existing vibrations during use may deviate from these because of the following factors:

- Incorrect use of the product;
- Unsuitable tools inserted;
- Unsuitable material;
- Insufficient maintenance.

You can reduce the risks considerably by following the tips below:

- Maintain the device in accordance with the instructions within this manual.
- Avoid working at low temperatures.
- When it is cold, make sure your body and your hands in particular, are kept warm.
- Take regular breaks and move your hands at the same time to promote circulation.

ELECTRICAL SAFETY

The device may only be connected to a socket that is correctly installed and grounded.



The fuse must be a residual current circuit-breaker with a measured residual current of no more than 30 mA.

Make sure that the power supply corresponds with the connection specifications of the device before it is connected.

The tool may only be used within the specified limitations for voltage and power (see type plate).

Do not touch the mains plug with wet hands!

Always pull out the mains plug at the plug and not by the cable.

Do not bend, crush, pull or drive over the power cable, protect from sharp edges, oil and heat.

Do not lift the device using the cable or use the cable for purposes other than intended.

Check the plug and cable before each use.

If the power cable is damaged, immediately disconnect the plug. Never use the device if the power cable is damaged.

If the device is not in use, make sure the plug is pulled out.

Make sure that the device is switched off before plugging in the mains cable.

Make sure that the device is switched off before unplugging it.

Disconnect the power supply before transporting the device.

DEVICE-SPECIFIC SAFETY INSTRUCTIONS

Keep the handle dry and free of grease.

Make sure to always wear personal protective clothing when operating.

Make sure the connection cable is always kept out of the working range of the device.

Make sure that cables always lead away from the rear of the device.

Make sure you are positioned firmly and with a natural stance when working with the device.

Always hold the unit tightly with both hands.

Before starting work, check the area for animal and objects. Remove all objects that may be blown away by the unit, or that the cutting blade/line may become caught on.

Before starting work, check the area and remove all objects which may damage the cutting mechanism.

Always ensure sufficient distance to the cutting mechanism.

In the vicinity of 15m around the cutting area there should be no people or animals, they may be hurt by flying objects.

Only work with good light and visibility.

Do not work above hip height! Do not bend forwards or lean over backwards!

Pay attention when walking backwards.

Danger of stumbling!

The cutting tool will continue to rotate even after the engine has been switched off.

Risk of injury caused by the cutting blade/line!

Always keep the machine in the normal working position before switching on.

Ensure that the ventilation slots are kept free from dirt.

Never mount metal cutting elements.

Children should be supervised to ensure that they do not play with the device.

If the power cable of this device is damaged, it may only be replaced by the manufacturer, their customer service operation, or a similarly qualified person, in order to prevent risks.

Remember that moving parts may also be located behind ventilation and venting slots.

Symbols affixed to your tools may not be removed or covered. Information on the device that is no longer legible must be replaced immediately.

Read the operating manual before using the device

MAINTENANCE AND STORAGE

Keep all nuts, bolts and screws tight to be sure the equipment is in safe working condition.

Replace worn or damaged parts for safety.

Keep the machine free of grass, leaves, or other debris build-up.

Allow the machine to cool before storing.



INSTRUCTION MANUAL

STAY ALERT

Do not operate the machine while under the influence of drugs, alcohol, or any medication that could affect your ability to use it properly. Do not use this machine when you are tired or distracted from the job at hand. Be aware of what you are doing. Use common sense.

AVOID DANGEROUS CONDITIONS

Make sure there is adequate surrounding workspace. Cluttered areas invite injuries. Keep your work area clean with sufficient light. Keep area around the machine clear of obstructions, stones, sticks, wires and other debris or foreign bodies which could cause damage to the machine.

DO NOT SMOKE, whilst using the machine.

INSPECT YOUR MACHINE

Check all bolts, nuts, and screws for tightness before each use, especially those securing guards and drive mechanisms. Vibration during use may cause these to loosen.

Replace damaged, missing or failed parts before using.

Warning labels carry important information. Replace any missing or damaged warning labels.

DRESS PROPERLY

Do not wear loose clothing, gloves, scarfs, neckties or jewellery (rings, wrist watches), which can be caught in moving parts.

ALWAYS wear protective eye and ear wear. Appropriate gloves are also recommended. Wear protective hair covering to contain long hair, preventing it from getting caught in machinery.

DO NOT use whilst barefoot or wearing open toed footwear.

KEEP BYSTANDERS AND CHILDREN AWAY

Keep unauthorised persons or animals a minimum distance of 15 metres away from the mower. Do not allow children to handle, use, or climb on the lawnmower.

DO NOT OVERREACH

Keep proper footing and balance at all times, particularly if using on slopes. The machine should not be used on steep slopes and always be sure of footing.

AVOID INJURY FROM UNEXPECTED ACCIDENT

Keep hands out of the way of moving parts, particularly the engine and rotating cutting tool.

DO NOT FORCE TOOL

Always work within the rated capacity. Do not use the machine for a purpose for which it was not intended. Always use the correct handles provided with the machine.

MAINTAIN YOUR MACHINE WITH CARE

Clean the machine immediately after use. Keep the machine clean to ensure it operates to its full and safest performance. When maintaining this machine, only the manufacturer's original replacement parts should be used. The use of non-original manufacturer parts may invalidate your warranty.

STORE IDLE EQUIPMENT

When not in use, the machine should be stored in a dry location. Keep the machine away from children and others not qualified to use it.



KNOW YOUR MACHINE

1. Trimmer Head	2. Handle Assembly
3. Front Handle	4. On/Off Trigger
5. Electric Cable	6. Locking Screw
7. Lower Body Assembly	8. Guard

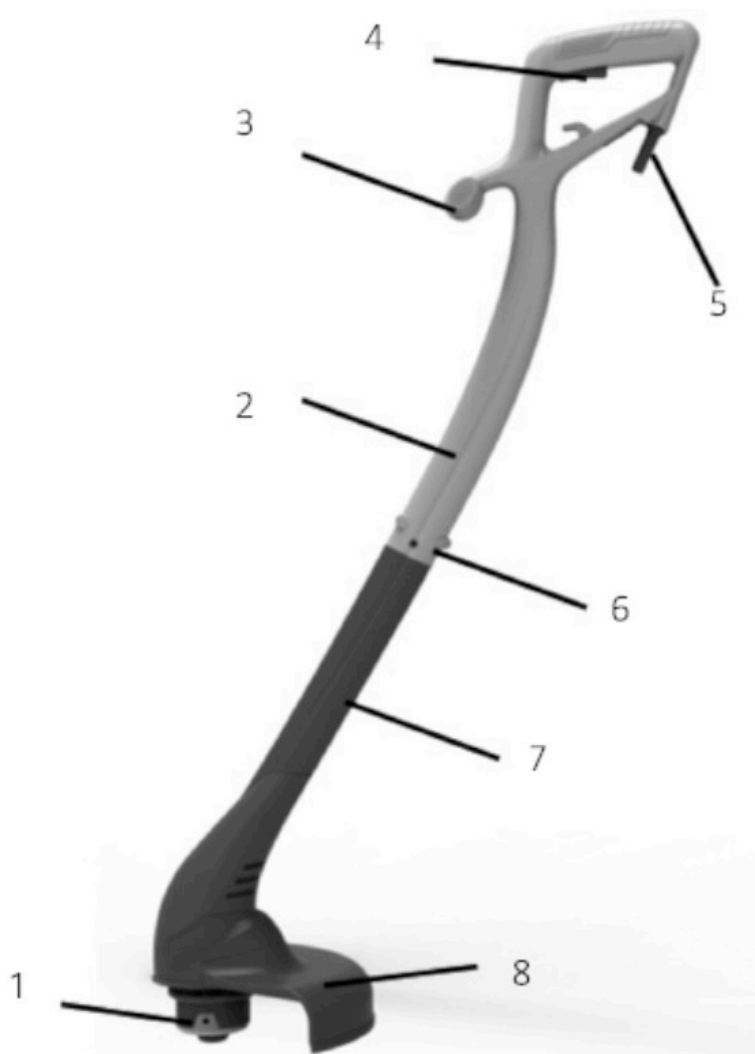



INSTRUCTION MANUAL

ASSEMBLY

Remove the machine and contents from the carton. Be sure the carton is empty before discarding. **If you require any assistance with regards to the contents or operation of your machine, please call our Customer Service Team on 01793 333212 or email customerservice@webbgardenpower.co.uk (Monday to Friday 8.00am to 5.30pm excl. Bank Holidays)**

PROTECTIVE GUARD



CAUTION

Risk of injury! On the under- side of the protective guard there is a sharp blade designed to cut the thread. Remove the transportation protection after mounting.

Fit the protective guard (8) onto the trimmer and line up the fixing holes. Secure with 2x ST4.2x12BT Screws.

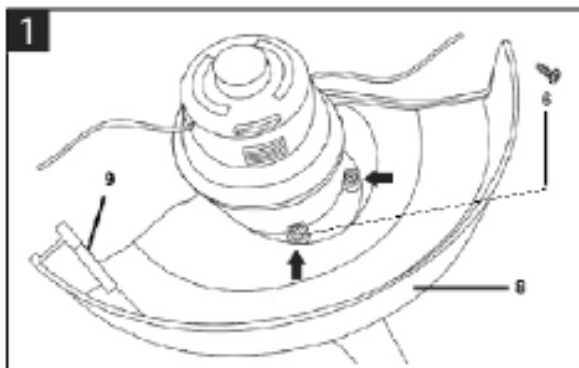

MAIN BODY

Match up the upper and lower body assemblies. Ensure the you line up with both sections facing the correct way.

Insert the Upper Body into the Lower Body until you hear a click.

Insert 2x ST4.2x12BT Screws to secure.

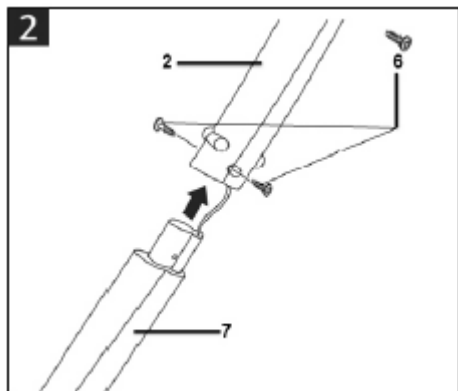



OPERATION



DANGER

Risk of injury! The device may only be put into operation if there are no defects. If a part is defective it must be replaced before the device is used again.



WARNING

Risk of injury! Before starting work check the area and remove all objects which may be kicked up by the unit.

Check to make sure there are no visible defects.

Check to make sure all device components are correctly mounted

INTENDED USE

The trimmer is designed for trimming grass on smaller areas of lawn.

MAINS CONNECTION

Check that the voltage indicated on the tools product/rating label corresponds with the mains voltage and connect the trimmer to an unearthed socket.

Only use extension cables with maximum length of 25 metres and a cross section of at least 1.5mm².

POWER CORD

Note: Avoid the electric cable being pulled out of the mains socket. Always check the electric cable sits firmly on the cable restraint before using the trimmer.

Make a loop in the electric cable and push it through the square hole below the On/Off trigger. Place the end of the loop around the cable restraint and ensure that it is tightened hard enough not to become loose during use.



SWITCHING ON AND OFF

Switching on:

Pull the On/Off trigger upwards (1).

Switching off:

Release the On/Off trigger (1).





INSTRUCTION MANUAL

FEED THE LINE FORWARD

Note: A full spool of trimmer line is included with this trimmer from new.

Feed out new line by pressing the trimmer head firmly on the ground with the trimmer turned on and the trimmer head spinning.

Run the trimmer for a few seconds without trimming to allow the trimmer line to be cut to the correct length.

CUTTING TIPS

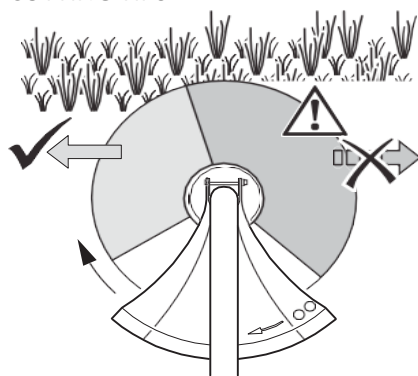

Only cut with the left (shown here as light grey) area of the cutting unit when the unit is being moved from right to left. In the right (dark grey) area, the threads rotate in your direction.

This represents a high level of kickback risk and objects may be thrown in your direction by the rotation of the thread. You may be hurt as a result.

When the unit is moved from left to right, ensure that the nylon line is kept away from the grass to ensure that the grass is not thrown up. Cut long grass from top to bottom to ensure that the grass does not get tangled around the spool. Only use the tip of the nylon line. This way you use less nylon line and avoid grass getting caught up in the spool.

Only take the nylon line as close as necessary to posts, walls, fences etc. Solid objects will wear the nylon line. Tree trunks, young trees and bushes may be damaged by the nylon line.

CLEANING & MAINTENANCE



DANGER

Prior to conducting maintenance or cleaning: Unplug from the power source.

Note: Clean unit immediately after every use. Remains of dried grass is very hard, and are very difficult to remove.

BEFORE EACH USE

What?	How?
Check the power cable and connector for damage.	Conduct a visual inspection and have the cable replaced by an electrician if necessary.

IF NECESSARY

What?	How?
Cleaning the device	Wipe the unit with a damp cloth.
Replace the thread if it is too short.	Replace the spool



REPLACING THE SPOOL

Removing the thread spool

Press together the two locking devices (14) on the spool cap (10) and remove it from the trimmer.

Remove the spool from the cap.

Remove any dirt or grass cuttings.

Guide both ends of the trimmer line (13) on the replacement spool through the holes (15) in the spool cap (one on each side).

Replace the spool firmly into the cap. Check that the trimmer lines are not stuck and pull them out to 9cm in length from the spool.

Put the spool cap over the spot set on the spring (12) and press firmly on it until the spool caps locking devices firmly click into place.

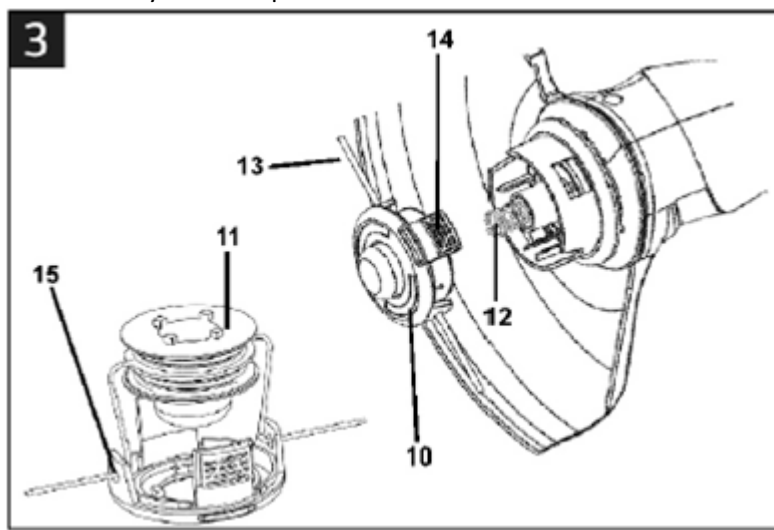

STORAGE & TRANSPORTATION

STORAGE

Store the tool in a dry and well-ventilated place.

TRANSPORTATION

When dispatching, try to use the original packaging, if possible.

TROUBLE SHOOTING

Error/Fault	Cause	Remedy
Motor Not Working	No power supply.	Check the cable, plug and fuse.
	Defective connecting cable	Contact the retailer
Nylon line doesn't unwind	Nylon Line used up	Replace the spool
	Spool blocked	Remove the cause of the blockage.

Please be aware that any improper repairs will also invalidate the manufacturer's warranty.





INSTRUCTION MANUAL

PARTS DIAGRAM

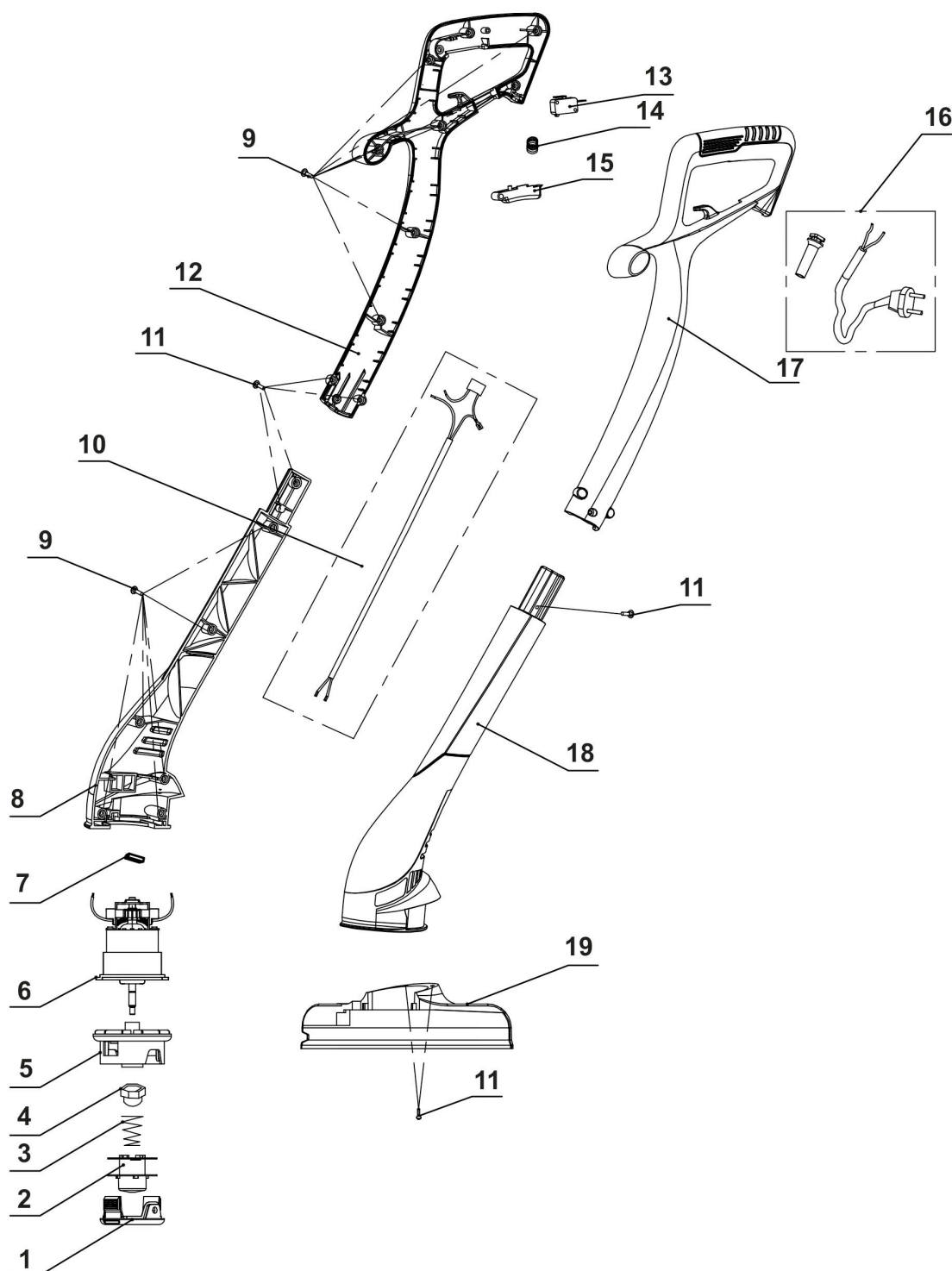



PARTS LIST

Item No	Webb Part No	Webb Description	Qty
1	WE130-301021057A	Cap with Eyelets	1
2	WE130-301100009	Spool Assembly (incl. reel & nylon line 1.2mm)	1
3	WE130-103060069	Spring	1
4	WE130-301992017	Insulating Cap	1
5	WE130-301029347	Fan with inserts	1
6	WE130-4070219	Motor Assembly	1
7	WE130-105020003	Rubber Mat	2
8	WE130-301021122	Right Housing	1
9	WE130-104030136	Screw ST4.2*15 BT	14
10	WE130-102080511	Connecting Line	1
11	WE130-104030135	Screw ST4.2*12 BT	7
12	WE130-301029540	Right Handle	1
13	WE130-102020039	Micro Switch	1
14	WE130-103060034	Trigger Spring	1
15	WE130-301062081	Button	1
16	WE130-102070754	BS Plug & Cable	1
17	WE130-301029541	Left Handle	1
18	WE130-301021125	Left Housing	1
19	WE130-301029497	Guard with ST4 Blade	1



EC DECLARATION OF CONFORMITY

We Handy Distribution Ltd - SN3 5HY (Importer) declare that the product:

Designation: Electric Grass Trimmer

Model(s): WEELT250

Product Number: 1938171001

Type/Serial No. As per rating label on machine

Voltage: 230-240V~50Hz

Rated Power: 250W

Protection: Class II

Max Cutting Speed: 13,000 min⁻¹

Cutting Width: 230mm

This machine conforms to EU Directives, to which this declaration relates & corresponds to the relevant basic safety and health requirements of Directive:

Machinery Directive 2006/42/EC

Noise Directive 2000/14/EC amended by 2005/88/EC, Annex VI

For the relevant implementation of the safety and health requirements mentioned in the Directives, the following standards and/or technical specification(s) have been respected:

EN 60335-1:2012+A11:2014, EN 50636-2-91:2014

Guaranteed Sound Power Level: L_{WA} = 96dB(A)

Vibration Level: 2.5m/s² (Uncertainty – K=1.5m/s²)

Notified Body:

Intertek Testing Services Shanghai

Addresses:

Building No. 86, 1198 Qinzhou Road (North), Caohejing Development Zone, Shanghai 200233, China.

Authorised signatory and technical file holder

Date: 06/11/2017

Name: Mr Simon Belcher

Position: Managing Director

Company: Handy Distribution Ltd

Address: Murdock Rd, Swindon, Wiltshire, SN3 5HY.

Signature:



NOTES

[illegible]



INSTRUCTION MANUAL

This Service Book is provided with your Webb, to help you look after your purchase to our recommendations and enable you to take advantage of the conditional manufacturer domestic warranty*.

Present this service book to your authorised Webb repair dealer, whenever a service or a warranty appraisal is required.

The booklet is applicable to the following products, in the UK only:

Ride On Lawn Tractors
Cylinder Lawnmowers
Petrol Rotary Lawnmowers
Petrol Hand Held Range

Please register your machine using the following pages or at www.webbgardenpower.co.uk. By registering your machine, you agree to maintain the machine in accordance with the service schedules specified in this manual and services duly recorded. (Not applicable for Webb electric handheld machines). You may be asked to produce this booklet as proof of servicing in the event of a claim. Proof of purchase should also be kept as a reference.

Ensure you have the following information available from your machine product label. The two examples below can be found on your machine:



1. Model Number

2. Serial & Product Number

Please complete using BLOCK CAPITALS.
Sections marked* must be completed to validate Warranty.



SERVICE BOOK

1. Users Statement of Warranty

Each new machine is warranted against defective material or assembly of material under normal usage. The warranty applies to the original purchaser, is not transferable and covers faulty parts and the labour involved in replacing and repairing those parts, which are of original manufacture.

2. Period of Warranty

Webb (excludes Electric Handheld) & Webb Pro, 2 year conditional warranty from the original date of sale to the first domestic user.

Webb Electric Handheld 1 year warranty from the original date of sale to the first domestic user.

90 days from the original date of sale to the professional/commercial or for hire user.

Engine warranty as per the engine manufacturer's warranty, which will be supplied with the machine.

90 days from the original date of sale for Replacement Spare Parts

All machines' must be serviced within the first 14 months from the original date of purchase, to qualify for a second year parts & labour warranty, details of the service must be recorded in the service record within this manual.

A reduced warranty period of 90 days applies to those items which are subject to normal wear and tear and in normal use, will need replacement or adjustment.

These items are chargeable after 90 days of ownership.

Filters
Tyres / Wheels
Drive chains and belts
Brake & clutch friction components
Control cable & starter cords
Fluids & lubricants
Spark plugs
Blades (Lawnmowers & Brushcutters)
Cutter bars (Hedgecutters)
Drive & clutch cable surfaces
Nylon Lines (Line Trimmers)
Carburettor cleaning
Bearings
Bushes
Electric cable
Grass collectors

3. Not covered by this warranty

- (a) The warranty policy does not cover any depreciation or damages caused by ordinary wear, rusting or corrosion, lack of correct maintenance or operation, misuse, abuse, lack of transportation or accident.
- (b) The warranty policy does not cover any costs necessary for the standard periodic maintenance services instructed by the operators manual, or service parts replacement which would include oil, filters, tyres, belts, brake linings, fuses, blades, seals and other service parts unless it can be proven that the item has evidence of faulty manufacture.
- (c) The warranty policy will not cover failure or damage caused as a result of parts or accessories being modified without the written approval of GJ Handy & Co Ltd.
- (d) The warranty policy will not cover the unit if non-genuine parts have been fitted and as a result damage has occurred to the unit.
- (e) The warranty policy is non-transferable and is only applicable to the original purchaser.

4. Disclaimer

- (a) This warranty is only a remedy for defect of products. GJ Handy & Co Ltd will never warranty in terms of the merchantability or the fitness for a particular purpose.
- (b) No person is authorised to make any warranties, representations or promises, expressed or implied, on behalf of GJ Handy & Co Ltd, or to modify the terms conditions or limitation of this warranty policy in any way.
- (c) Neither GJ Handy & Co Ltd nor any company affiliated with GJ Handy & Co Ltd shall be liable in any event or manner





INSTRUCTION MANUAL

whatsoever for incidental or consequential damages or injuries, including, but not limited to, loss of crops, loss of profit, out of pocket expenses or profits, rental of substitute equipment or other commercial losses.

5. General

(a) Most warrantable failures show up within the first few weeks of use. These failures are usually straightforward and warranty assessment is relatively easy.

(b) Failures relating to cutter decks and belts need careful investigation, as the cause may not always be straightforward. Look for damage to blades and pulleys especially when the cutter belt or blade boss have snapped or cracked as this could be due to impact damage.

(c) Customers should always refer to the operator/instruction manual when any disputed problem arises, you will find most areas covered within the manual.

Protecting your machine

Maintenance

Regular maintenance of your Webb machine is essential to ensure it operates, safely, efficiently and therefore reducing the environmental impact.

It is the owner's responsibility to ensure that their Webb machine is maintained at specific intervals. Any approved Webb service dealer can undertake a service, which are specialised in our products and will be aware of your particular machine and any technical updates which will save valuable time & money.

If you are using your machine in dry, dusty or high temperatures, you will need to service the machine more regularly.

Fuel (if applicable)

Due to ongoing efforts by fuel companies to reduce emissions, unleaded petrol will oxidize & deteriorate in storage overtime, leaving residue from detergent components.

Fuel deterioration problems may occur when petrol is stored for over 30 days. If you are planning to store fuel for over 30 days, we recommend you add Handy Parts Sure-Start fuel stabilizer to fresh fuel after purchasing. Sure-Start cannot reconstitute stale fuel.

Storage

When storing your machine for an extended period, we do recommend that you follow the instructions of engine instruction manual.

Always store the fuel in a clean, approved and sealed container. If the container is steel, ensure it is not corroded.

If the container is not filled to its recommended capacity, air can accelerate fuel deterioration.

Always store fuel away from direct sunlight, in a dark, cool environment.



SERVICE BOOK

Your servicing Webb approved dealer will stamp & date the below relevant sections, when the correct service actions have been completed.

PLEASE ENSURE THE SERVICE BOOK IS AVAILABLE FOR THE DEALER, DURING SERVICE WORK.

1st Service

This must be stamped by an approved service dealer to qualify for a free second year warranty.

(Excluding the Webb Electric Handheld machines)

12 Months

Date

24 Months

Date

36 Months

Date





INSTRUCTION MANUAL

48 Months

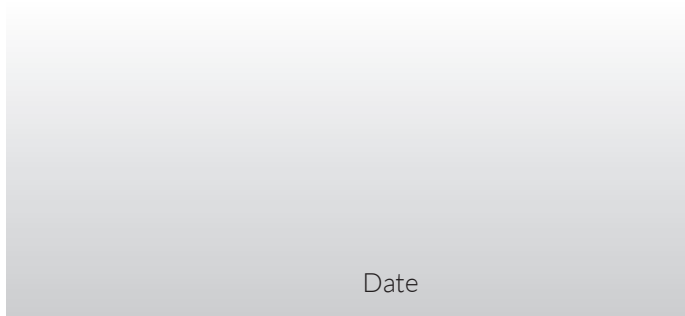

60 Months

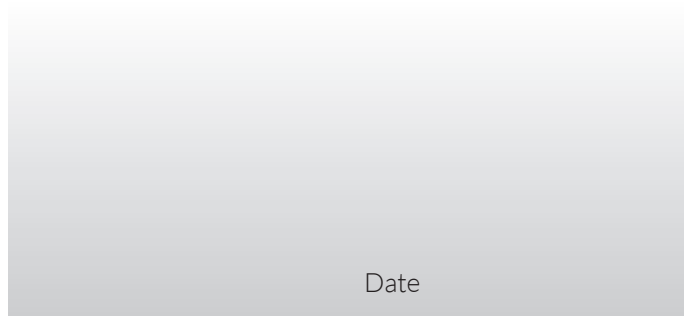

72 Months

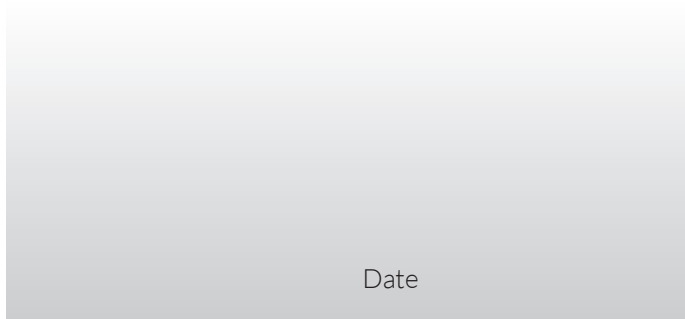

84 Months

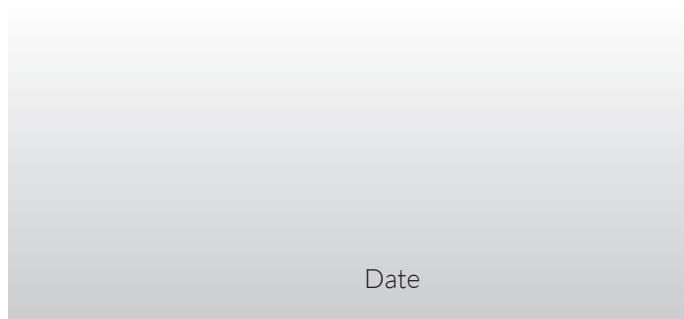

96 Months

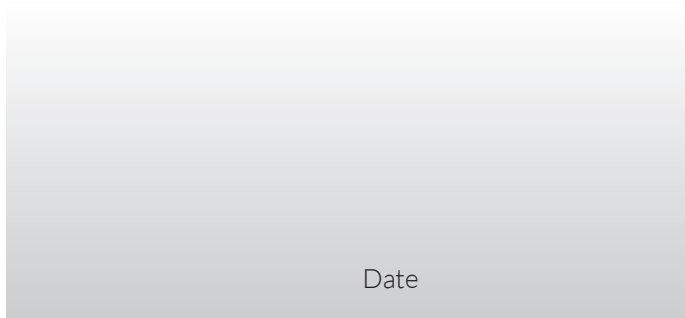

108 Months

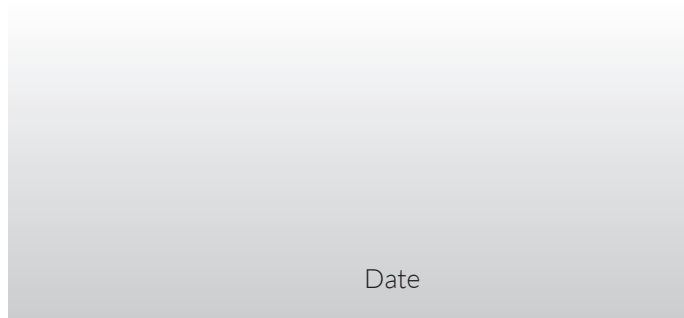

120 Months

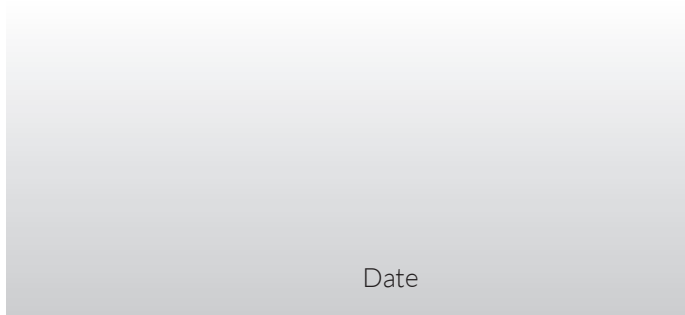

132 Months

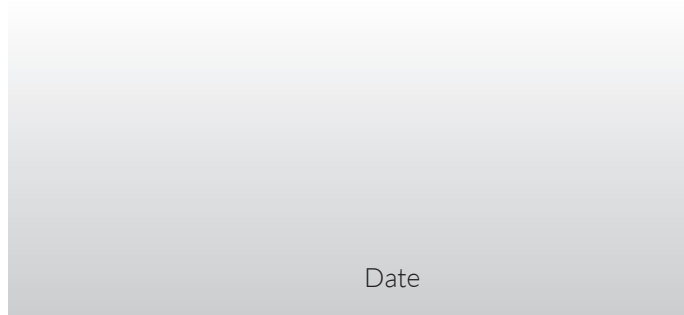

Warranty Registration

If you have registered online, this form is not necessary.
PLEASE POST THIS COPY TO THE ADDRESS OVERLEAF

Product Information (* Compulsory)

*Model No:	
*Product No:	
*Serial No:	
*Date of Purchase:	

Personal Information (* Compulsory)

*Title		*Forename		*Surname								
*House Number		*House Name										
*Address 1												
*Address 2												
*Town												
*County												
*Postcode												
Home Tel				Mobile Tel								
Email												
Age	18 to 25		26 to 35		36 to 45		46 to 60		61 to 80		81 & over	

*Dealer Stamp (Complete Address)

*Selling Retailer (If dealer stamp not available)

*Dealer Name	
*Dealer Address	
*Date of Purchase	

*Usage	Domestic Use		Commercial/Professional/Hire Use	
--------	--------------	--	----------------------------------	--

Webb Lawnmowers' privacy commitment to machine owners: Thank you for completing this form. The information supplied, helps us to improve the products & services we provide, including information that we believe is relevant to your and/or your machine. We value your trust by giving us this information about yourself and we are committed to protecting your privacy. From time to time Webb, its associated companies, authorised dealers or third parties working on our behalf may wish to contact you regarding our products, services, offers, technical improvements or just opinions, which may be used for marketing, research or analysis purposes.

If you DO NOT wish to be contacted by either of the following methods, please tick the relevant box POST ☐ TELEPHONE ☐

If you would like us to contact you by Email, please tick this box ☐

You may give Webb Lawnmowers notice in writing at any time that you no longer wish to receive direct marketing communications



Webb Lawnmowers
Murdock Road
Dorcan
Swindon
Wiltshire
SN3 5HY

